

GENERAL NOTES

1: DRAWING NOTES:
CONTRACTOR TO FURNISH AND INSTALL ALL NOTED LABOR AND MATERIALS UNLESS OTHERWISE NOTED.

2: CODE COMPLIANCE:
ALL WORK SHALL CONFORM TO THE LATEST EDITION OF STATE, LOCAL AND OTHER CODES WHICH APPLY TO THIS PROJECT OR HAVE JURISDICTION.

3: COORDINATION:
IT IS THE RESPONSIBILITY OF THE CONTRACTOR TO COORDINATE ALL DISCIPLINES AND TRADES SO THAT ALL BUILDING SYSTEMS AND COMPONENTS CAN BE ASSEMBLED WITHOUT CONFLICTS. IN THE EVENT THAT THE CONSTRUCTION DOCUMENTS DEFINE CONDITIONS WHICH PROHIBIT, OR MAY PROHIBIT, SUCH ASSEMBLY, THE CONTRACTOR SHALL BRING TO THE ARCHITECTS ATTENTION, IN WRITING AND IN A TIMELY FASHION, SUCH CONDITION. THE CONTRACTOR SHALL NOT PROCEED WITH RELATED WORK WITHOUT A WRITTEN RESOLUTION CLARIFICATION FROM THE ARCHITECT.

4: DISCREPANCIES & CLARIFICATIONS:
IT IS THE RESPONSIBILITY OF THE CONTRACTOR TO BRING TO THE ARCHITECTS ATTENTION, IN WRITING, ANY DISCREPANCIES OR AMBIGUITIES IN THE DRAWINGS AND/OR SPECIFICATIONS. THE CONTRACTOR SHALL NOT PROCEED WITH RELATED WORK WITHOUT A WRITTEN RESOLUTION OR CLARIFICATION FROM THE ARCHITECT.

5: LAYOUT:
UNLESS INDICATED OTHERWISE, CENTER WALL FRAMING AND PARTITION FRAMING ON COLUMN LINES. FLOOR PLAN DIMENSIONS ARE TO CENTER OF FRAMING, FACE OF CONCRETE, FACE OF CMU, OR FROM COLUMN CENTERLINES, UNLESS INDICATED OTHERWISE. DOORS AND WINDOWS ARE DIMENSIONED TO CENTERLINES UNLESS INDICATED OTHERWISE.

6: CENTERING:
UNLESS INDICATED OTHERWISE, CENTER BUILDING ELEMENTS WITHIN OR BETWEEN OTHER BUILDING ELEMENTS WHEN CONDITIONS OR THE DRAWINGS INDICATE OR IMPLY THAT SUCH IS THE INTENT, WHETHER OR NOT DIMENSIONS ARE INCLUDED.

7: SYMMETRY:
WHERE CONDITIONS OR THE DRAWINGS INDICATE OR IMPLY THAT SYMMETRY IS INTENDED, INFORMATION PROVIDED AT ONE SIDE APPLIES EQUALLY TO BOTH SIDES, UNLESS CONDITIONS CLEARLY PRECLUDE SUCH APPLICATION.

8: ACCESSIBILITY:
ALL HANDICAPPED ACCESSIBLE BATHROOMS, GRAB BARS, AND DOOR OPENINGS SHALL MEET THE REQUIREMENTS OF TITLE 94-348, CHAPTER 5 OF THE MAINE HUMAN RIGHTS COMMISSION TITLE LATEST EDITION & THE DEPARTMENT OF JUSTICE ADA STANDARDS FOR ACCESSIBLE DESIGN.

9: DRAWING SCALES:
WORK FROM THE GIVEN DIMENSIONS ONLY. SCALE IS INDICATED ON THE DRAWINGS FOR CONVENIENCE ONLY. IT IS NOT INTENDED THAT INFORMATION BE DETERMINED BY SCALING THE DRAWINGS SINCE SOME ITEMS MAY NOT BE TO SCALE.

10: WATER-RESISTANT GWB:
INSTALL WATER-RESISTANT GYPSUM WALL BOARD IN ALL REST ROOMS & TOILET ROOMS OR AT ANY WALL WITH PLUMBING FIXTURES.

10A: HIGH IMPACT GWB:
INSTALL HIGH IMPACT GYPSUM WALL BOARD IN ALL STAIRWELLS

11: INTERIOR ELEVATIONS:
INTERIOR ELEVATIONS MAY BE REVERSED FROM AND/OR SIMILAR TO ACTUAL CONDITIONS. SEE FLOOR PLANS FOR WINDOW AND DOOR QUANTITIES AND LOCATIONS, FOR CASEWORK LAYOUTS, AND FOR MONITOR LOCATIONS.

12: BUILDING INSULATION:
PROVIDE AS INDICATED IN WALL SECTIONS AND IN ACCORDANCE WITH PARTITION TYPES, WHETHER OR NOT SHOWN IN DETAILS AND OTHER DRAWINGS. FOR CLARITY, INSULATION MAY NOT BE SHOWN IN SOME CASES, EVEN IF IT IS TO BE PROVIDED.

13: BLOCKING:
INSTALL BLOCKING BEHIND ALL SURFACE-APPLIED FIXTURES TRIM, CASEWORK, SHELVES, BRACKETS, TOILET ACCESSORIES, CHAIR RAILS, PICTURE RAILS, GRAB BARS, BASE MOLDINGS, AND AS OTHERWISE REQUIRED, WHEN SUCH ITEMS ARE APPLIED ON STUD WALLS.

14: PENETRATIONS AT STRUCTURAL MEMBERS:
BEFORE PENETRATING JOISTS, BEAMS OR OTHER STRUCTURAL MEMBERS, CONSULT WITH THE ARCHITECT.

15: DAMAGED WORK:
BUILDING OR SITE COMPONENTS WHICH ARE AFFECTED BY NEW WORK, DEMOLITION, OR WHICH MAY BE DAMAGED BY THE GENERAL CONTRACTOR OR ANY SUB-CONTRACTOR SHALL BE REPLACED OR RESTORED TO ORIGINAL CONDITION AND COLOR TO MEET THE APPROVAL OF THE ARCHITECT.

16: UTILITIES:
VERIFY THE SIZE AND LOCATION OF ALL UNDERGROUND UTILITIES AND REPORT ANY DISCREPANCIES TO THE ARCHITECT IN WRITING. DO NOT PROCEED WITH WORK UNTIL THE DISCREPANCY HAS BEEN RESOLVED TO THE SATISFACTION OF THE ARCHITECT.

17: RATED CONSTRUCTION:
PROVIDE RATED CONSTRUCTION AS REQUIRED BY CODE, AS SPECIFIED, AND AS INDICATED ON DRAWINGS. IT IS THE RESPONSIBILITY OF THE CONTRACTOR TO PROVIDE AND INSTALL ALL COMPONENTS REQUIRED TO CREATE SUCH RATED CONSTRUCTION, REGARDLESS OF WHETHER OR NOT SUCH COMPONENTS ARE INDICATED. PROVIDE CONTINUITY OF SUCH RATED CONSTRUCTION AROUND AND BETWEEN SPACES, INCLUDING AT CHASES AND AT FLOORS, TO MAINTAIN COMPLETE SEPARATIONS, EVEN IF NOT SPECIFICALLY INDICATED.

18: SHOP DRAWINGS:
SUBMIT SHOP DRAWINGS TO THE ARCHITECT FOR REVIEW PRIOR TO FABRICATIONS. SUBMITTALS REQUIRED INCLUDE, BUT ARE NOT LIMITED TO, SHOP DRAWINGS FOR ALL PREFABRICATED CONCRETE, STEEL, MILLWORK & SIGNAGE, SAMPLES OF ALL PROPOSED PAINTS, METALS, WALL COVERINGS, LAMINATES, SOLID SURFACE MATERIALS, CERAMIC TILE, AND HARDWARE. SUBMIT MANUFACTURERS' DATA FOR ALL LIGHTING SYSTEMS, AND HARDWARE.

19: PERMITS:
THE GENERAL CONTRACTOR SHALL OBTAIN AND PAY FOR ANY BUILDING PERMITS REQUIRED AND CARRY ANY INSURANCE COVERAGES REQUIRED.

20: INTERIOR FINISHES:
ALL INTERIOR FINISHES AND FURNISHINGS ARE TO BE CLASS 'A' FIRE-RATED AND ARE TO COMPLY WITH SECTION 920.0 BOCA (INTERIOR FLAME SPREAD).

21: ELECTRICAL DESIGN:
REFER TO ELECTRICAL DRAWINGS AND SPECIFICATIONS

22: WASTE REMOVAL:
THE GENERAL CONTRACTOR SHALL DISPOSE OF ALL WASTE AND DEBRIS OFF THE PREMISES.

24: TEMPORARY FACILITIES:
PROVIDE ALL TEMPORARY FACILITIES AND SERVICES, CONSTRUCTION AND SUPPORT FACILITIES, AND SECURITY AND PROTECTION AS NEEDED TO PROTECT NEW AND EXISTING CONSTRUCTION FOR THE DURATION OF A COMPLETE INSTALLATION.

25: FINAL CLEANING:
EMPLOY EXPERIENCED WORKERS FOR FINAL CLEANING. CLEAN EACH SURFACE TO THE CONDITION EXPECTED IN A COMMERCIAL BUILDING CLEANING PROGRAM.

26: MANUFACTURERS INSTRUCTIONS:
ALL MATERIALS & EQUIPMENT SHALL BE INSTALLED ACCORDING TO MANUFACTURER'S SPECIFICATIONS.

27: GUARANTEE:
ALL MATERIALS AND WORKMANSHIP SHALL BE GUARANTEED FOR A PERIOD OF ONE YEAR FROM THE DATE OF FINAL ACCEPTANCE UNLESS OTHERWISE SPECIFIED FOR A LONGER PERIOD OF TIME ON A CERTAIN ITEM.

28: ASBESTOS:
ALL MATERIAL USED FOR THE CONSTRUCTION OF THIS PROJECT, WHETHER BUILDING MATERIALS OR APPURTENANCES, SHALL BE NON-ASBESTOS CONTAINING MATERIAL.

29: HAZARDOUS FUMES:
THE GENERAL CONTRACTOR SHALL CONFIRM THAT ALL MATERIAL AND FINISHES SPREAD AND THEIR FABRICATION OR INSTALLATION WILL NOT RELEASE FUMES OR AROMAS DURING CONSTRUCTION WHICH MAY BE A HAZARD OR NUISANCE TO PERSONNEL.

30: PEST CONTROL:
SEAL AND CAULK AROUND ALL PENETRATIONS, CRACKS AND CREVICES AND ANY OPENINGS CAPABLE OF HARBORING INSECTS/RODENTS.

31: EXPOSED UTILITIES:
ALL EXPOSED UTILITY WIRES AND PIPES (ELECTRICAL, PLUMBING, ETC.) SHALL BE INSTALLED IN A WAY THAT DOES NOT OBSTRUCT OR PREVENT THE CLEANING OF FLOORS, WALLS, AND CEILING AREAS. THEY SHALL BE INSTALLED A MINIMUM OF 6" OFF FLOORS AND 1" OFF WALLS, CEILING AND ADJACENT PIPES.

32. OWNER SUPPLIED EQUIPMENT:
EQUIPMENT SUPPLIED BY THE OWNER AND INSTALLED BY THE GENERAL CONTRACTOR (EQUIPMENT INFORMATION AND SPECIFICATIONS ARE TO BE THE MOST CURRENT AVAILABLE AT THE TIME OF DOCUMENTATION PREPARATION. THE GENERAL CONTRACTOR SHALL BE RESPONSIBLE FOR VERIFYING WITH THE OWNER THE EXACT DIMENSIONS AND EQUIPMENT CONNECTION REQUIREMENTS (INCLUDING ELECTRICAL CIRCUIT REQUIREMENTS) OF EQUIPMENT TO BE SUPPLIED. THE GENERAL CONTRACTOR SHALL MAKE ALL FINAL CONNECTIONS AS NOTED ON THE DRAWINGS, INSTALL THE SET UP IN WORKING ORDER, CHECK WARRANTIES, TEST AND NOT VOID WARRANTIES. THE GENERAL CONTRACTOR SHALL COORDINATE WITH THE OWNER DELIVERY, STORAGE AND INSTALLATION OF ALL OWNER SUPPLIED EQUIPMENT. THE GENERAL CONTRACTOR SHALL STORE EQUIPMENT IF REQUESTED BY THE OWNER UNTIL INSTALLATION. SEE DRAWINGS FOR OTHER OWNER SUPPLIED/GENERAL CONTRACTOR INSTALLED ITEMS.

34: SOILS AT FOOTINGS:
REPORT THE LOCATION OF ALL UNSUITABLE SOILS AND MATERIALS BELOW ANTICIPATED LEVEL OF FOOTING TO THE ARCHITECT PRIOR TO THE SETTING OF FORMS.

35: ACCESS PANELS:
CONTRACTOR IS RESPONSIBLE FOR COORDINATING QUANTITY AND LOCATION OF ALL REQUIRED ACCESS PANELS FOR ALL MEP CONTROLS, CLEANOUTS, DAMPERS, PULL BOXES, ETC.

36: EXISTING HAZARDOUS MATERIALS
ALL HAZARDOUS MATERIALS INCLUDING BUT NOT LIMITED TO ASBESTOS AND LEAD PAINT ARE TO BE HANDLED, ENCAPSULATED, ABATED AND DISPOSED OF IN ACCORDANCE WITH ANY AND ALL FEDERAL, STATE AND LOCAL REQUIREMENTS AND REGULATIONS.

37: INDUSTRY STANDARDS:
ALL WORK SHALL BE PERFORMED IN ACCORDANCE WITH INDUSTRY STANDARDS. STANDARDS INCLUDE BUT ARE NOT LIMITED TO THE FOLLOWING:

AAMA	AMERICAN ARCHITECTURAL MANUFACTURERS ASSOCIATION
ACI	AMERICAN CONCRETE INSTITUTE
ANSI	AMERICAN NATIONAL STANDARDS INSTITUTE
ASTM	AMERICAN SOCIETY FOR TESTS AND MATERIALS
AWI	ARCHITECTURAL WOODWORK INSTITUTE "CUSTOM GRADE"
AWS	AMERICAN WELDING SOCIETY
IGL	INSULATING GLASS MANUFACTURERS ALLIANCE
NAAMM	NATIONAL ASSOCIATION OF ARCHITECTURAL METAL MANUFACTURERS
NRCA	NATIONAL ROOFING CONTRACTORS ASSOCIATION
NTCA	NATIONAL TILE CONTRACTORS ASSOCIATION
SMAACNA	SHEET METAL AND AIR CONDITIONING NATIONAL ASSOCIATION
WDMA	WINDOW AND DOOR MANUFACTURERS ASSOCIATION

ABBREVIATIONS

A	AIR CONDITIONING	L	LABORATORY
AC	ACOUSTICAL CEILING TILE	LAM	LAMINATED
AD	AREA DRAIN	LB	POUND
ADAAG	AMERICANS WITH DISABILITIES ACT	LH	LEFT-HAND
	ACCESSIBILITY'S GUIDELINES	LCC	LEAD COATED COPPER
ADD	ADDITION	M	MACH
AFF	ABOVE FINISHED FLOOR	MAS	MASONRY
AHU	AIR-HANDLING UNIT	MATL	MATERIAL
AL	ALUMINUM	MAX	MAXIMUM
ARCH	ARCHITECTURAL	MD	MEDIUM-DENSITY OVERLAY
AWP	ACOUSTIC WALL PANEL	MECH	MECHANICAL
B	BACK-TO-BACK	MEMB	MEMBRANE
BLS	BASE BUILDING GENERAL CONTRACTOR	MEZ	MEZZANINE
B.B.G.C.	BUILDING LINE	MFR	MANUFACTURER
BLD	BUILDING	MIN	MINIMUM
BLDG	BLOCKING	MISC	MISCELLANEOUS
BLKG	BLOCKING	MO	MASONRY OPENING
BM	BASEMENT	MTD	MOUNTED
BTWN	BETWEEN	MTL	METAL
BO	BY OTHERS	MB	MARKER BOARD
C	COURSE (MASONRY)	N	NORTH
CER	CERAMIC	#	NUMBER
CG	CORNER GUARD	NIC	NOT IN CONTACT
CH	COAT HOOK	NOM	NOMINAL DIMENSION
CJ	CONTROL JOINT	NTS	NOT TO SCALE
CL	CENTER LINE	O	OVER
CLG	CEILING	OC	ON CENTER
CMU	CONCRETE MASONRY UNIT	OD	OUTSIDE DIAMETER/OUTSIDE DIMENSION
CO	CLEAN OUT	OFF	OFFICE
COL	COLUMN	OPNG	OPENING
COND	CONCRETE	OPP	OPPOSITE
CONN	CONNECT/CONNECTION	OPP H	OPPOSITE HAND
CONST	CONSTRUCTION	OSB	ORIENTED STRAND BOARD
CONT	CONTINUOUS	OSB	ORIENTED
CORR	CORRIDOR	P	PURCHASED BY OWNER INSTALLED BY CONTRACTOR
CT	CERAMIC TILE	PB/IBC	PRECAST
CUH	CABINET UNIT HEATER	PC	PLATE
D	DOUBLE	PLAM	PLASTIC LAMINATE
DBL	DRINKING FOUNTAIN	PR	PAIR
DIA	DIAMETER	PREFAB	PREFABRICATE
DIFF	DIFFUSER	PRIV	PRIVACY
DIM	DIMENSION	PRIM	PRIME
DN	DOWN	PSF	POUNDS PER SQUARE FOOT
DR	DOOR	PSI	POUNDS PER SQUARE INCH
DSP	DRY STAND PIPE	PTD	PAINTED
DWVG	DRAINING	PTN	PARTITION
E	EAST	PVC	POLYVINYL CHLORIDE
EA	EACH	PWD	PLYWOOD
EL	ELEVATION	PT	PRESSURE TREATED
ELEC	ELECTRICAL	PERF	PERFORATED
ELEV	ELEVATOR	Q	QUARRY TILE
ENTR	ENTRANCE	QTR	QUARTER
EQ	EQUIPMENT	R	RISER/RADIUS
EXP	EXPANSION	RAD	RADIUS
EXPB	EXPANSION BOLT	RB	RUBBER BASE
EXPJ	EXPANSION JOINT	RCP	REFLECTED CEILING PLAN
EXT	EXTERIOR	RD	ROOF DRAIN
EPDM	ETHYLENE PROPYLENE DIENE MONOMER	REBAR	REINFORCING BAR
ENC	ELECTRIC WATER COOLER	REF	REFRIGERATOR
F	FAHRENHEIT	REQ	REQUIRED
FAB	FABRICATED	RES	RESILIENT
FC	FIRE EXTINGUISHER AND CABINET	REV	REVERSE
FD	FLOOR DRAIN	RM	ROOM
FE	FIRE EXTINGUISHER	RO	ROUGH OPENING
FEC	FIRE EXTINGUISHER CABINET	ROW	RIGHT OF WAY
FTWD	FIRE TREATED WOOD	S	SOUTH
FL	FLOOR	SCHED	SCHEDULE
FOB	FACE OF BRICK	SF	SQUARE FEET
FOC	FACE OF CONCRETE	SIMIL	SIMILAR
FOF	FACE OF FINISH	SPEC	SPECIFICATION
POS	FACE OF STUDS	SQ	SQUARE
FOW	FACE OF WALL	STC	STAINLESS STEEL
FSS	FIRE SUPPRESSION SYSTEM	STD	STANDARD
FTG	FOOTING	STL	STEEL
FRG	FIBER REINFORCED GYPSUM	STD	STANDARD
FTR	FIN TUBE RADIATION	STRUC	STRUCTURE/STRUCTURAL
FH	FUME HOOD	SUSP	SUSPENSION
G	GAUGE	T&G	TONGUE/GROOVE
GALV	GALVANIZED	TEL	TELEPHONE
GB	GRAB BAR	THK	THICK
GC	GENERAL CONTRACTOR	TOD	TOP OF DECK
GFI	GROUND-FAULT INTERRUPTER	TOS	TOP OF STEEL
GLAM	GLUE-LAMINATED WOOD	TYP	TYPICAL
GND	GROUND	TV	TELEVISION
GWB	GYPSUM WALL BOARD	TB	TACK BOARD
H	HANDICAP	TOC	TOP OF CONCRETE
HB	HOSE BIB	U	UNDERWRITERS LABORATORIES, INC.
HND	HANDICAP	UV	UNIT VENTILATOR
HM	HOLLOW METAL	V	VINYL COMPOSITION TILE
HORIZ	HORIZONTAL	VCT	VERTICAL
HP	HOT WATER HEATING POWER/HIGH POINT/HEAT PUMP	VIF	VERIFY IN FIELD
HR	HOUR	VOL	VOLUME
HW	HOT WATER HEATING VENTILATION AIR CONDITIONING	W	WEST
HVAC	HEATING VENTILATION AIR CONDITIONING	W/O	WITHOUT
I	INSIDE DIMENSION/INSIDE DIAMETER	W/	WITH
IN	INCHES	W/O	WOOD
INFO	INFORMATION	WF	WIDE FLANGE
INSUL	INSULATION	WP	WORK POINT
J	JOIST	WT	WEIGHT
JT	JOINT		
K	KILN-DRIED		
KIP	1000 POUNDS		

FIRESTOPPING DETAILS

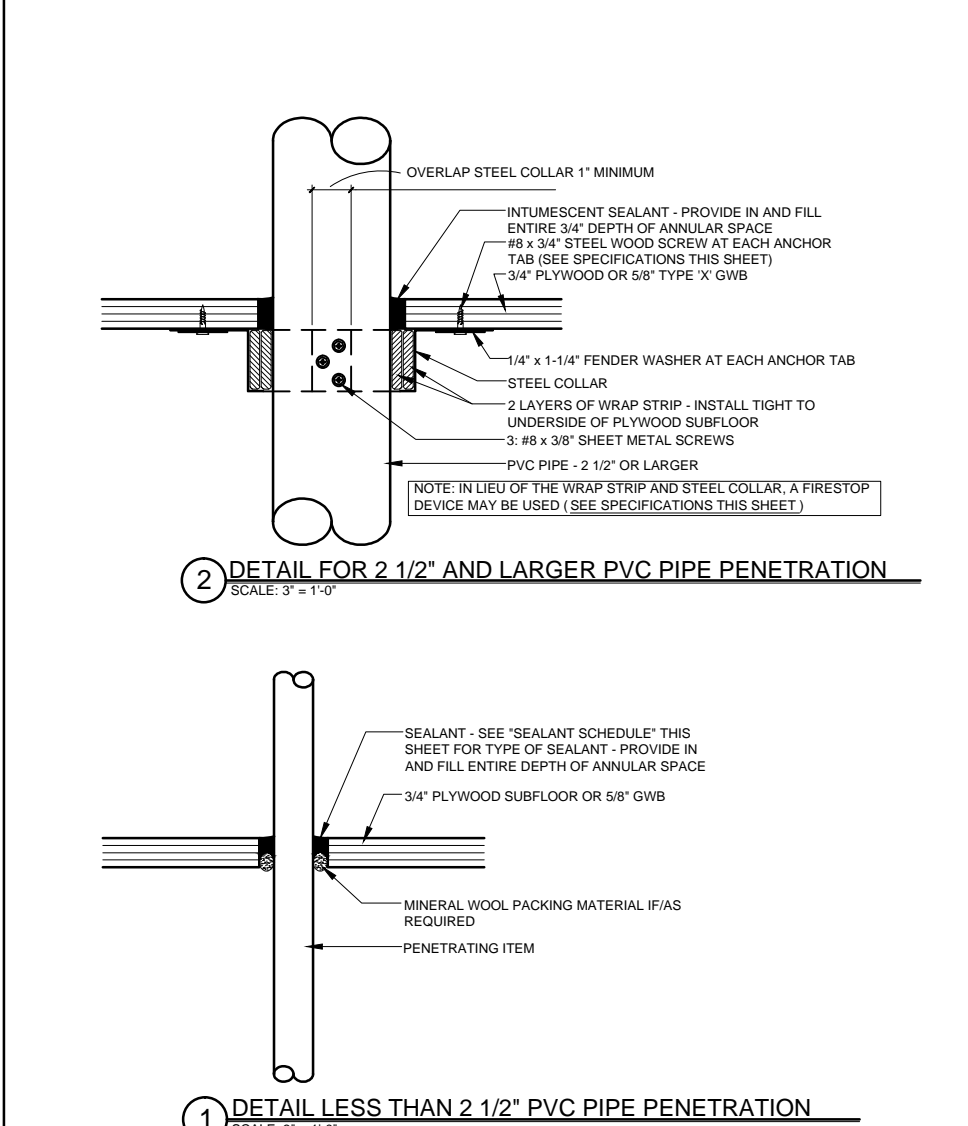

1: DETAIL LESS THAN 2 1/2" PVC PIPE PENETRATION
SCALE: 3/4" = 1'-0"

2: DETAIL FOR 2 1/2" AND LARGER PVC PIPE PENETRATION
SCALE: 3/4" = 1'-0"

SEALANT SCHEDULE:
SEALANT - SEE "SEALANT SCHEDULE" THIS SHEET FOR TYPE OF SEALANT - PROVIDE IN AND FILL ENTIRE DEPTH OF ANNULAR SPACE
1/4" x 1/4" FENDER WASHER AT EACH ANCHOR TAB
STEEL COLLAR
2 LAYERS OF WRAP STRIP - INSTALL TIGHT TO UNDERSIDE OF PLYWOOD SUBFLOOR
3 #4 x 3/8" SHEET METAL SCREWS
1/2" PLYWOOD OR 5/8" TYPE 'X' GIB
NOTE: INCLUDE DEPTH OF WRAP STRIP AND STEEL COLLAR X-FIBRESTOP (DEVICE MAY BE USED - SEE SPECIFICATIONS THIS SHEET)

WRAP STRIP: 1/4" THICK x 1 1/2" MINIMUM WIDTH INTUMESCENT MATERIAL WITH PLASTIC FILM FACING BOTH SIDES. TEMPORARILY SECURE WITH MASKING TAPE. SPECIFIED TECHNOLOGIES INC. (STI) "SpecSeal RED Wrap Strip" OR "SpecSeal BLU Wrap Strip" OR EQUAL.

STEEL COLLAR: WRAP STRIP MANUFACTURER'S STEEL COLLAR, FABRICATED FROM 0.016 INCH THICK GALVANIZED SHEET STEEL, WIDTH TO MATCH WRAP STRIP (1 1/2" MINIMUM), WITH 1 INCH x 2 INCH ANCHOR TABS AND RETAINER TABS. ANCHOR TABS TO BE SYMMETRICALLY OPPOSED AROUND COLLAR. PROVIDE 3 TABS FOR 2 1/2" AND 3" PIPE, PROVIDE 4 TABS FOR 4" PIPE.

INTUMESCENT SEALANT: ONE-PART, INTUMESCENT, LATEX ELASTOMER TESTED TO ASTM E 814. MINIMUM EXPANSION OF 3x AT 1000°F. 3M "FIRE BARRIER SEALANT CP 25WB-4" OR EQUAL.

FIRESTOP SEALANT: SINGLE COMPONENT NONCOMBUSTIBLE FIRE RATED SEALANT TESTED TO ASTM E 814. TESTED TO 3000°F. "BOSS 136 FIRESTOP/DRAFT SEALANT" MANUFACTURED BY ACCUMETRIC, LLC. OR EQUAL.

SEALANT SCHEDULE:
INTUMESCENT SEALANT - PROVIDE AT ALL PENETRATIONS THROUGH RATED CONSTRUCTION FOR PENETRATING ITEMS INCLUDING BUT NOT LIMITED TO: PVC PIPE, ROOF LEADER PIPES, GAS PIPES & LINES, SPRINKLER PIPES, ELECTRICAL & COMMUNICATIONS CABLES & WIRES, AND ALARM SYSTEM WIRES. DO NOT USE INTUMESCENT SEALANT AT DOMESTIC HOT WATER OR HYDRONIC HEATING SYSTEM PIPES.

FIRESTOP SEALANT: PROVIDE AT ALL PENETRATIONS THROUGH RATED CONSTRUCTION FOR PENETRATING ITEMS INCLUDING DOMESTIC HOT AND COLD WATER PIPES AND HYDRONIC HEATING SYSTEM PIPES.

NOTE:
FOR LOCATIONS OF RATED CONSTRUCTION, SEE ARCHITECTURAL FLOOR PLANS AND SECTIONS

DRAWING LEGEND

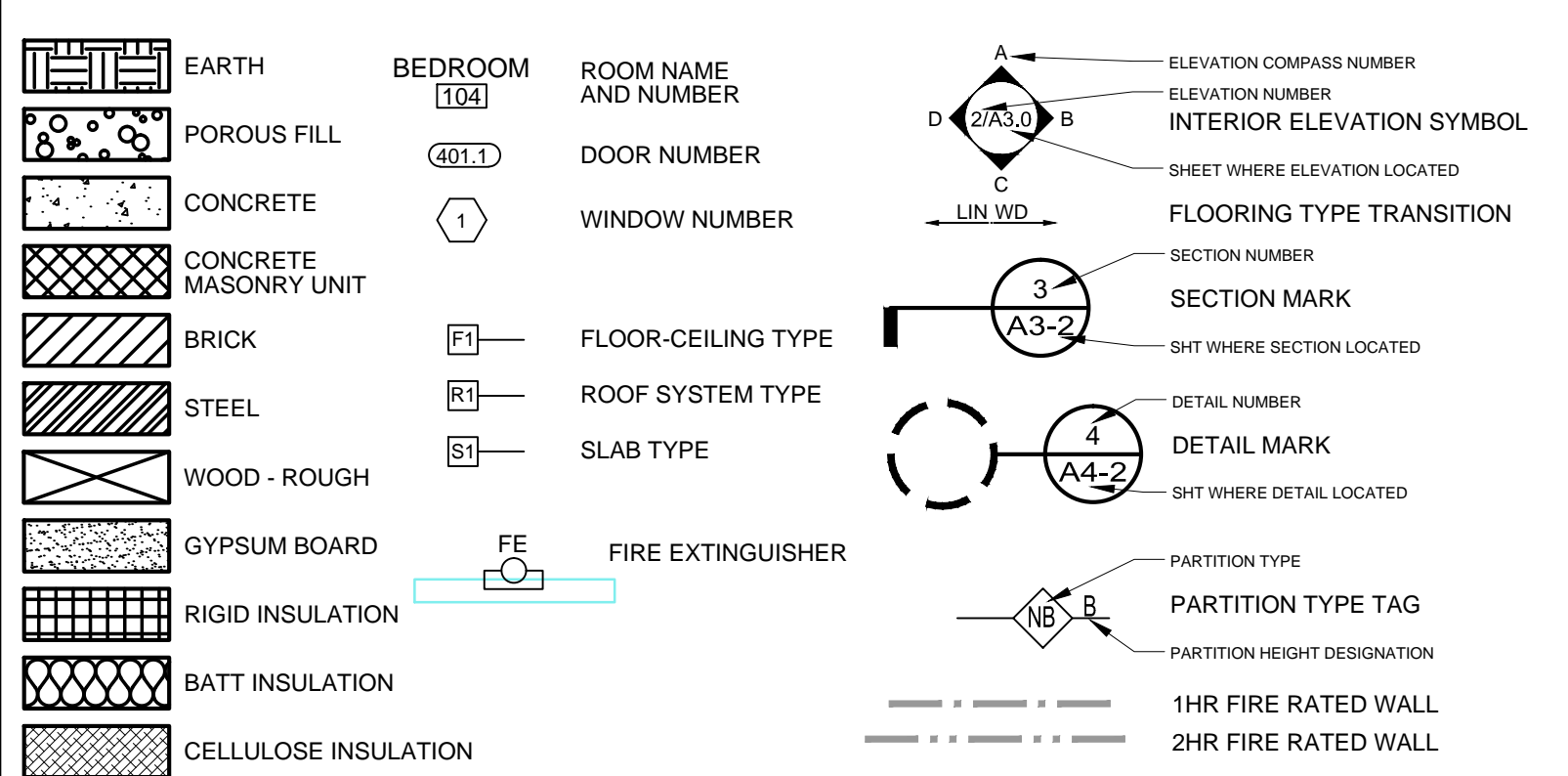

© 2016 RYAN SENATORE ARCHITECTURE

CLOUDPORT OFFICES
63 FEDERAL STREET
PORTLAND, MAINE

RSA
RYAN SENATORE ARCHITECTURE
565 CONGRESS STREET
PORTLAND, MAINE 04101
207-650-6414
rsenatore@rchitecture.com

CONSULTANTS:

REVISIONS:

DATE: 29 MARCH 2016

PROJECT No. 1617

DRAWN BY: RRT

CHECKED BY: RJS

SCALE: AS NOTED

SHEET TITLE:
GENERAL NOTES AND ABBREVIATIONS

G1-1