

**LIGHTING SCHEDULE**

| QTY.   | SYM. | FIXTURE MODEL + MAKE                              | LAMP        | FIXTURE HT.   | POLE        |
|--|------|---|-------------|---------------|-------------|
| 5  | ●    | LIGHT COLUMN BOLLARD 600 SERIES BY FORMS+SURFACES | 17 WATT LED | 50" TOTAL HT. | 6" DIAMETER |
| ILLUMINANCE (FC): AVERAGE = 0.07<br>MAXIMUM = 4.10<br>MINIMUM = 0.00<br>AVE. / MIN. RATIO = 0.00<br>AVE. / MAX. RATIO = 0.00 |      |   |             |               |             |
| PHOTOMETRICS PREPARED BY FORMS+SURFACES - JANUARY 25+27, 2017  |      |   |             |               |             |

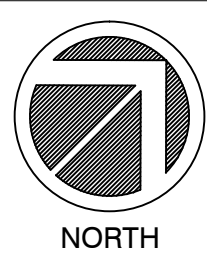

**SCALE**

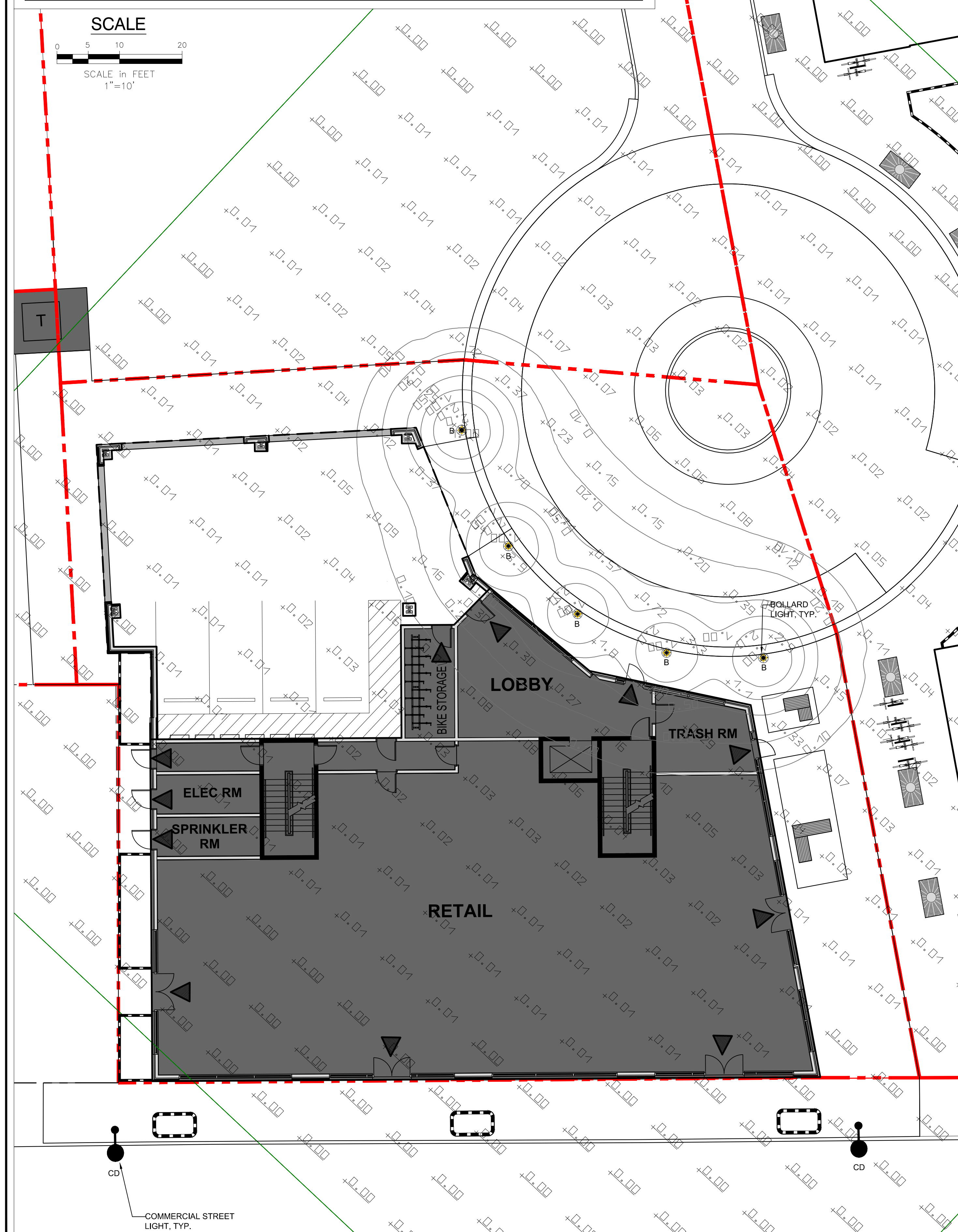
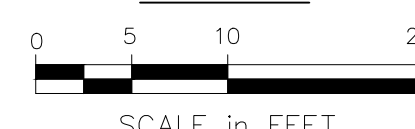

① 20 THAMES STREET INTERNAL PHOTOMETRIC PLAN

**LIGHTING SCHEDULE**

| QTY.   | SYM. | FIXTURE MODEL + MAKE                              | LAMP        | FIXTURE HT.   | POLE        |
|--|------|---|-------------|---------------|-------------|
| 16   | ●    | LIGHT COLUMN BOLLARD 600 SERIES BY FORMS+SURFACES | 17 WATT LED | 50" TOTAL HT. | 6" DIAMETER |
| ILLUMINANCE (FC): AVERAGE = 0.04<br>MAXIMUM = 4.10<br>MINIMUM = 0.00<br>AVE. / MIN. RATIO = 0.00<br>AVE. / MAX. RATIO = 0.00 |      |   |             |               |             |
| PHOTOMETRICS PREPARED BY FORMS+SURFACES - JANUARY 25+27, 2017  |      |   |             |               |             |

**SCALE**

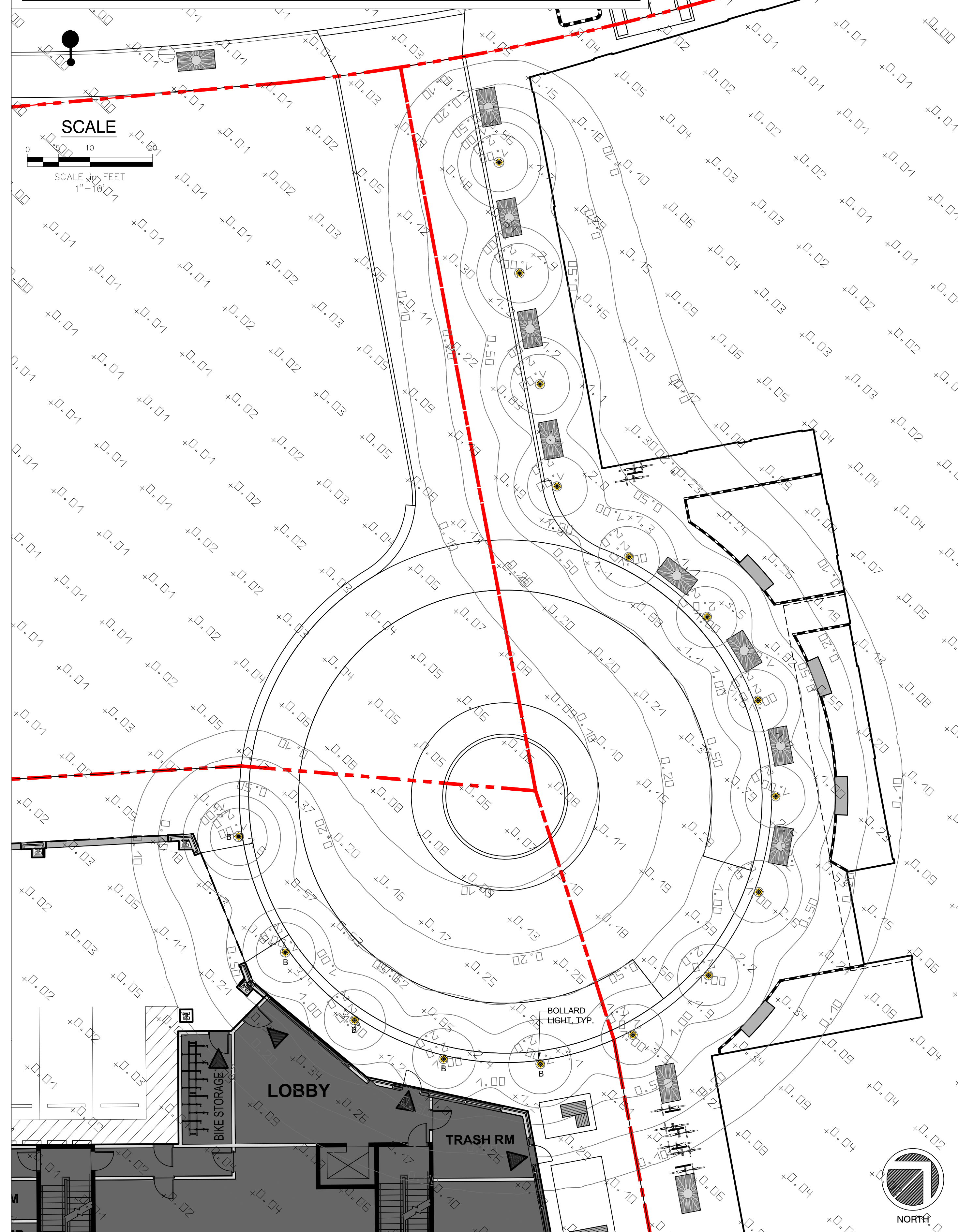
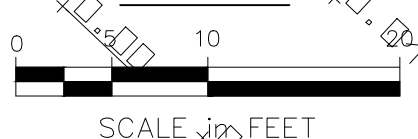

② COMBINED 20 THAMES STREET + AC HOTEL INTERNAL PHOTOMETRIC PLAN

Project:  
**20 THAMES STREET  
RESIDENTIAL  
CONDOMINIUM**  
20 THAMES STREET  
PORTLAND, MAINE

Owner:  
PORTLAND NORWICH  
ACQUISITION, LLC  
P.O. BOX 1383  
SANIBEL, FL 33957

Applicant:  
ESSEXNORTH  
PORTLAND LLC  
P.O. BOX 394  
TOPSFIELD, MA 01983

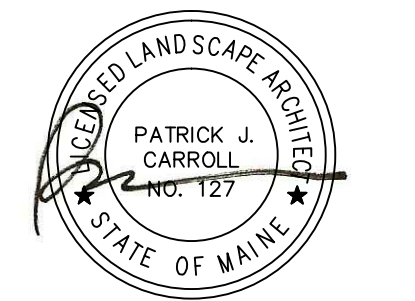

**RANSOM**  
Consulting  
Engineers  
and Scientists  
400 Commercial Street, Suite 404  
Portland, ME 04101  
Tel. (207) 772-2891  
Fax (207) 772-3248  
www.ransomenv.com

**PHOTOMETRIC  
PLAN**

|            |                 |                     |
|------------|-----------------|---------------------|
| 1          | CITY SUBMISSION | 03.09.17            |
| No.        | Revision/Issue  | Date                |
| Design by: | MAP/PC          | Checked by: PC      |
| Drawn by:  | MAP             | Approved by: PC     |
| Project:   |                 | Date: MARCH 1, 2016 |
| Sheet No:  | <b>L3.0</b>     |                     |