

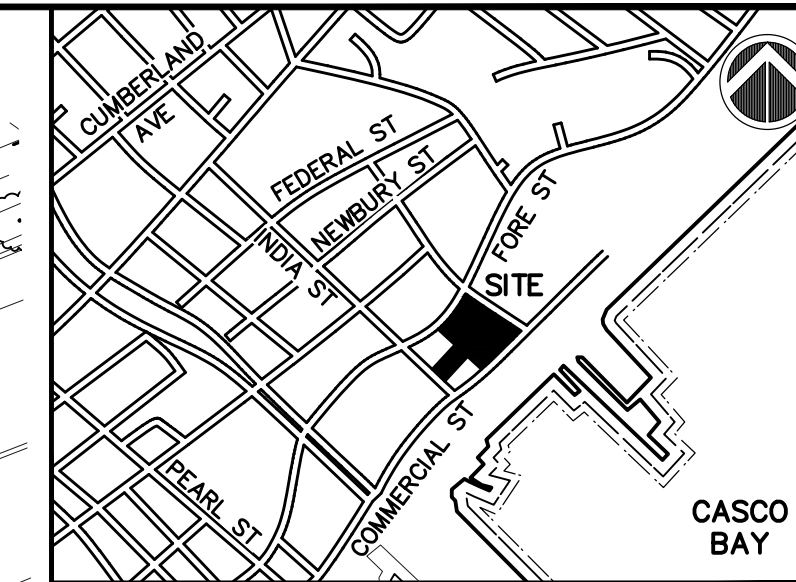

NORTH



PROPOSED AC HOTEL
PORTLAND
FORE STREET /
HANCOCK STREET /
THAMES STREET
PORTLAND, MAINE

Prepared for:
PORTLAND NORWICH GROUP, LLC.
2330 PALM RIDGE ROAD #305
SANIBEL, FLORIDA 33957

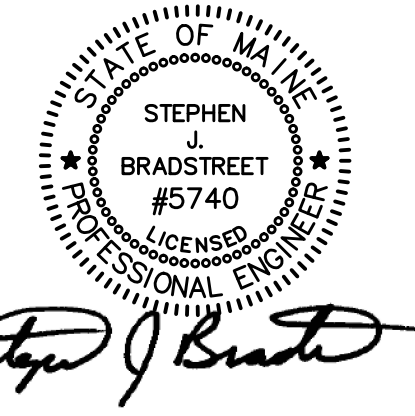

CIVIL ENGINEER:
STEPHEN J. BRADSTREET, PE #5740
400 COMMERCIAL STREET, SUITE 404
PORTLAND, ME 04101
207-772-2891

SPACE AND BULK STANDARDS

	REQUIRED	PROPOSED
MINIMUM LOT SIZE	0 S.F.	28,540 S.F. (LOT 1)
ROAD FRONTAGE	0'	>226'
BUILDING SETBACKS (MIN./MAX.)		
FRONT	0'/10'	
SIDE	0'/10'	
REAR	0'	
BUILDING HEIGHT	65'	65' (6 FLOORS)

GENERAL NOTES

1. ALL NEW (OR RESET) GRANITE CURB WITHIN THE RIGHT-OF-WAY SHALL BE RADIUS CURBING WHEN USED IN AREAS SUBJECT TO PLOWING. CURB LENGTH SHALL BE A MINIMUM OF 4 FEET.
2. COORDINATE FORE STREET IMPROVEMENT PLAN WITH CITY OF PORTLAND TRAFFIC CONSULTANT.
3. COORDINATE PROPOSED HANCOCK STREET LOADING ZONE WITH CITY OF PORTLAND TRAFFIC CONSULTANT.
4. ALL ON-STREET PARKING ON FORE STREET WILL BE DESIGNATED AS 1-HOUR PARKING. COORDINATE WITH CITY AND TRAFFIC CONSULTANT.

LEGEND

	PHASE 1 - LIMIT OF CONSTRUCTION
	PROPERTY LINE
	PERVIOUS BRICK PAVERS
	COBBLE STONE PAVERS
	BRICK SIDEWALK PAVERS
	NEW BITUMINOUS PAVEMENT

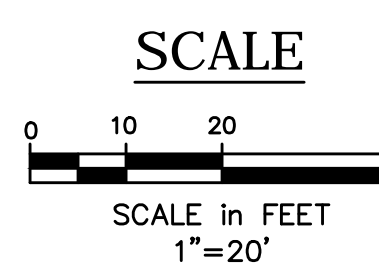
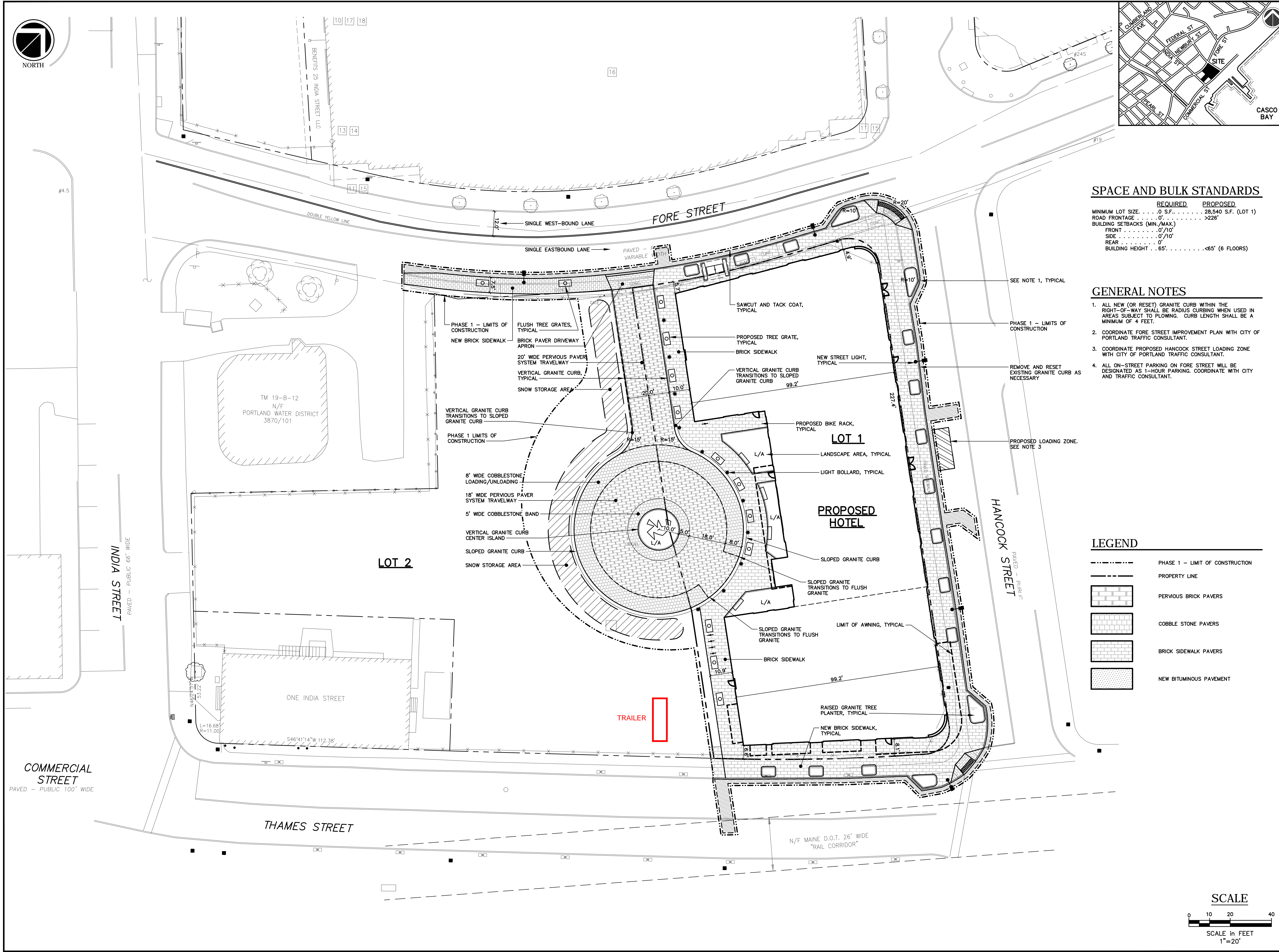

SITE PLAN

E	RESPONSE TO COMMENTS	05/17/16
D	RESPONSE TO COMMENTS	05/10/16
C	FINAL SUBMISSION	03/15/16
B	PRELIMINARY SUBMISSION	09/29/15
A	CLIENT REVIEW	09/15/15
No.	Revision/Issue	Date

Design by:	MPM	Checked by:	SJB
Drawn by:	JAR	Approved by:	SJB
Project:	150.06094	Date:	AUGUST 2015
Sheet No:	C1.0		
	Sheet 4 of 17		