

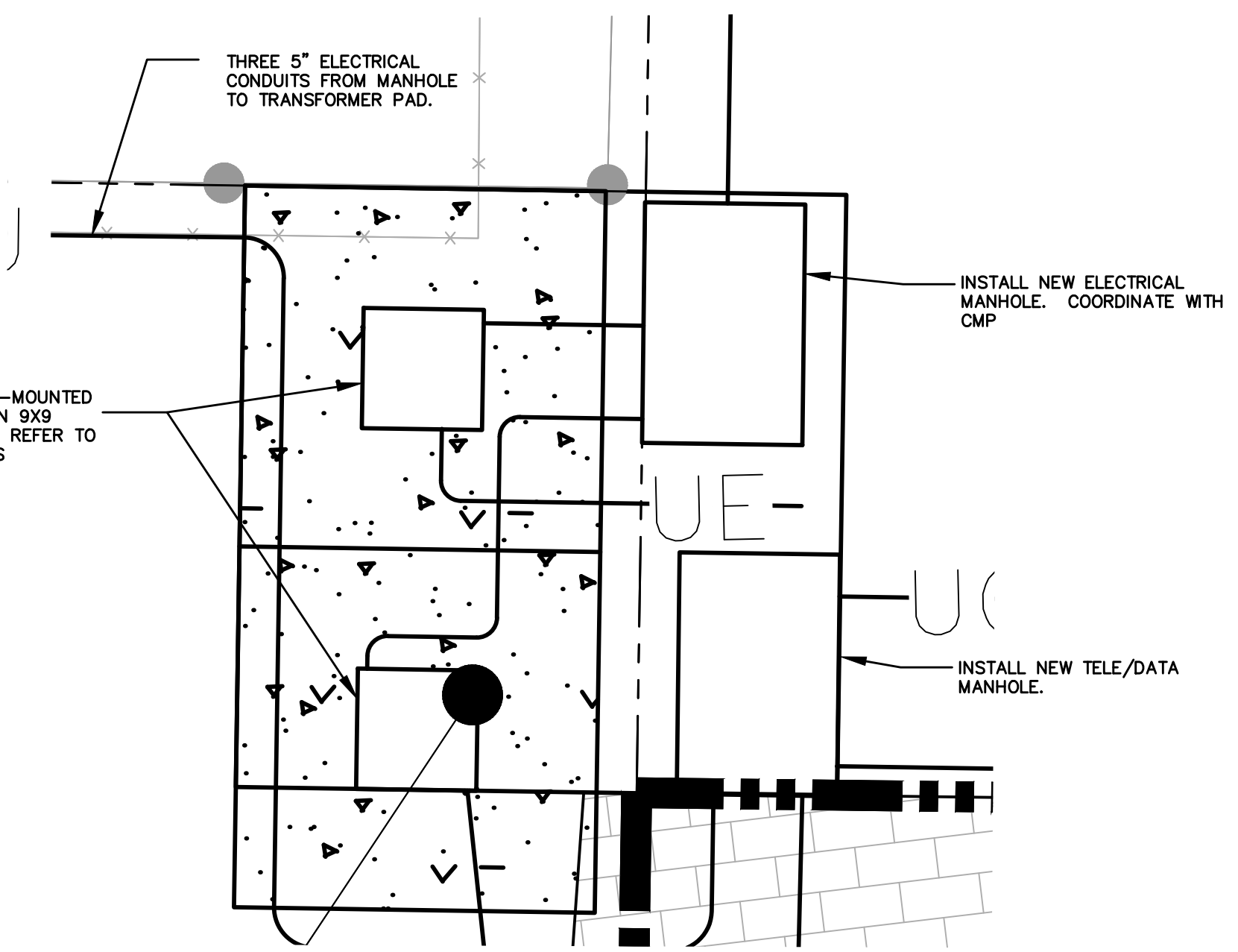

NORTH

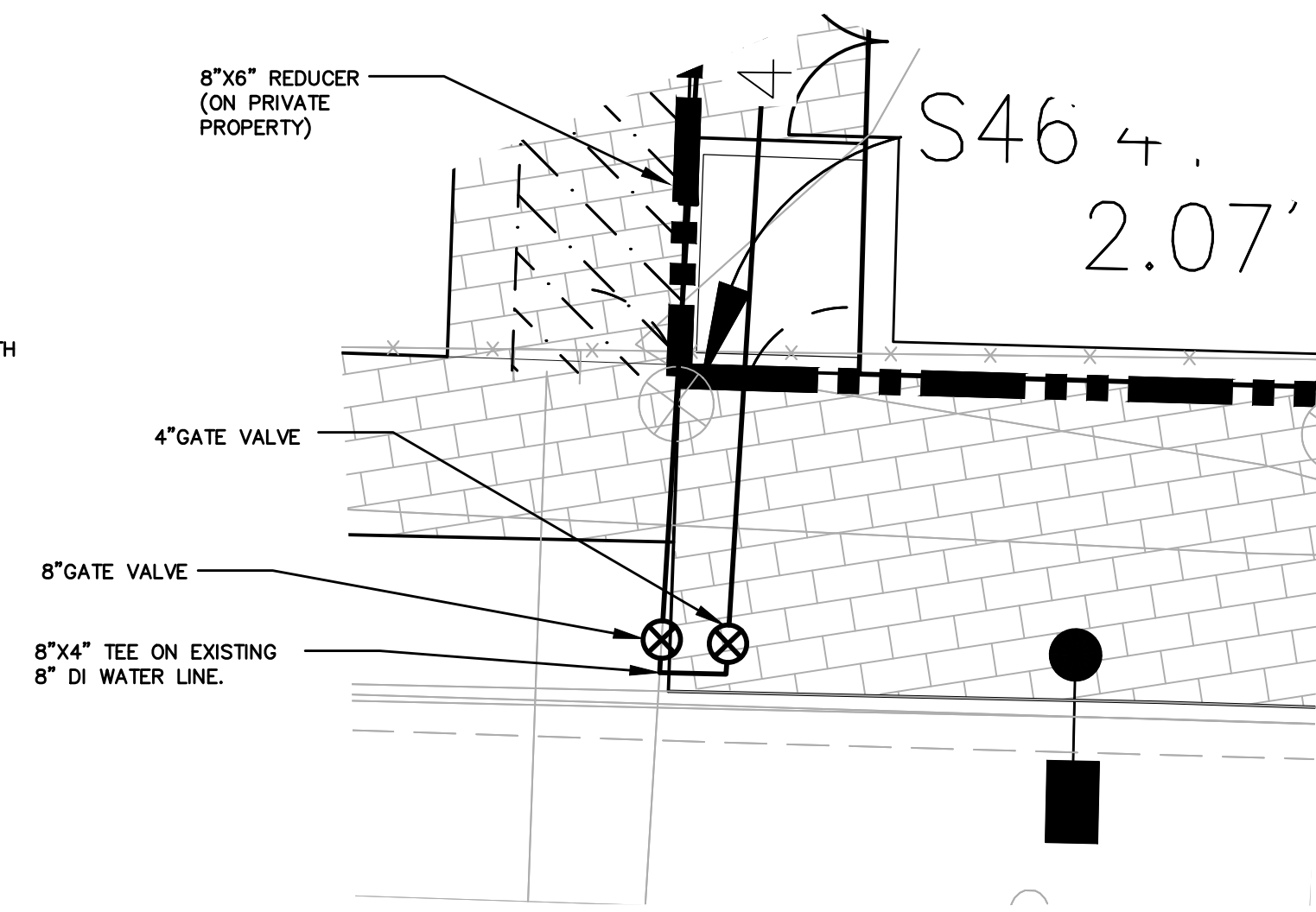

ELECTRIC CONNECTION DETAILS

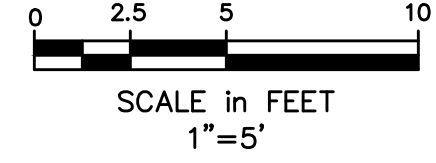

NOTES

1. THE 8" / 6" FIRE LINE AND THE 4" DOMESTIC WATER LINE SHALL BE SEPARATED BY A MINIMUM OF 2 FEET FACE TO FACE.
2. THE SHUTOFF VALVES FOR THE 8" FIRE AND 4" DOMESTIC SHALL BE PLACED A MINIMUM OF 2' FROM THE FACE OF CURB ON FORE STREET.
3. A FULL LENGTH OF DI PIPE (MIN.) SHALL BE PLACED AFTER THE 8" AND 4" SHUTOFF VALVES IN THE SIDEWALK PRIOR TO INSTALLATION OF ADDITIONAL JOINTS (REDUCER, ELBOW).
4. TREES WELLS AND STREET LIGHTS SHALL BE LOCATED A MINIMUM OF 10 FEET FROM THE WATER SERVICE.

WATER CONNECTION DETAIL

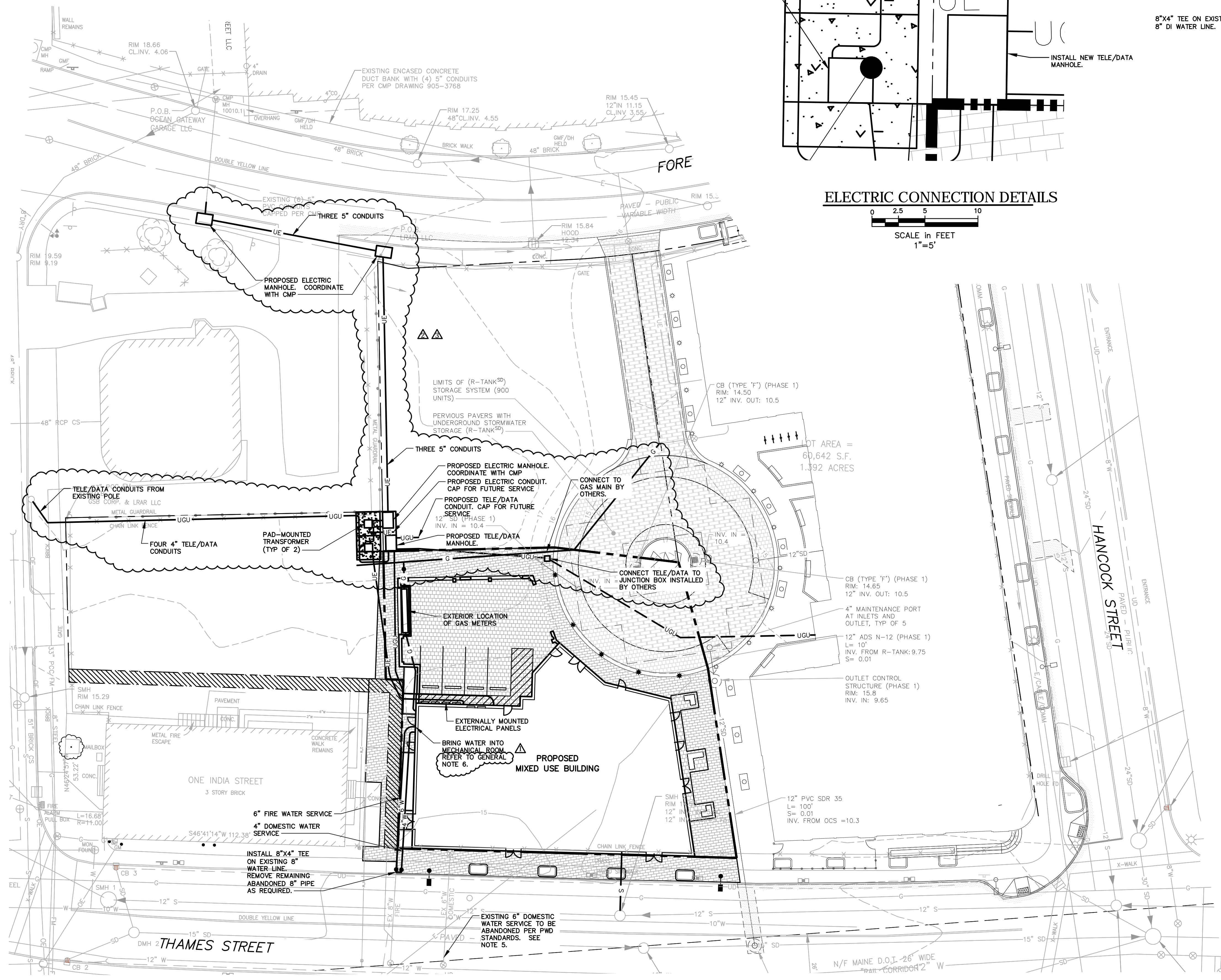
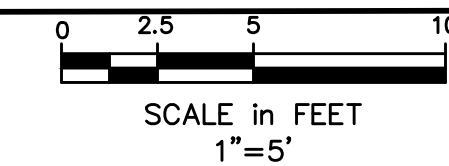

GENERAL NOTES

1. EXISTING UTILITIES SHOWN ARE APPROXIMATE AND SHALL BE FIELD VERIFIED.
2. COORDINATE INSTALLATION OF FIRE SERVICE AND DOMESTIC WATER SERVICE WITH PORTLAND WATER DISTRICT.
3. BACKWATER VALVES (BACKFLOW PREVENTER) SHALL BE INSTALLED ON EACH SANITARY LINE AS IT EXITS THE BUILDING. EACH VALVE SHALL BE PLACED WITHIN AN ACCESS BOX SUPPLIED BY MANUFACTURER.
4. A LICENSE FROM THE CITY OF PORTLAND SHALL BE REQUIRED FOR ANY BACKWATER VALVES WITHIN THE CITY RIGHT-OF-WAY.
5. TO ABANDON EXISTING WATER SERVICE ON THAMES STREET, REMOVE VALVE AND TAPPING SLEEVE AND INSERT REPAIR SLEEVE AND PIPE. SHUT DOWN OF MAIN SHALL BE REQUIRED. CAP FREE END OF SERVICE.
6. DOMESTIC WATER SERVICE LINE TO BE PROTECTED FROM BACKFLOW BY INSTALLATION OF A REDUCED PRESSURE ZONE (RPZ) DEVICE AFTER THE METER, AS REQUIRED BY THE PORTLAND WATER DISTRICT. PROPER DRAINAGE IN THE MECHANICAL ROOM IS RECOMMENDED.

SCALE

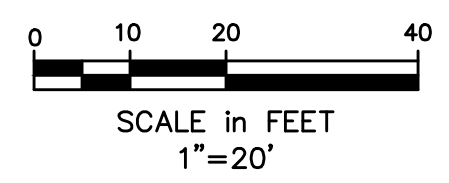

Project:
**20 THAMES STREET
 RESIDENTIAL
 CONDOMINIUM**
 20 THAMES STREET
 PORTLAND, MAINE

Owner:
ESSEXNORTH 20 THAMES LLC
 P.O. Box 1383
 SANIBEL, FL 33957

Applicant:
**ESSEXNORTH
 PORTLAND LLC**
 P.O. BOX 394
 TOPSFIELD, MA 01983

CIVIL ENGINEER:
MAUREEN P. MCGLONE, PE #7705
 400 COMMERCIAL STREET, SUITE 404
 PORTLAND, ME 04101
 207-772-2891

RANSOM
 Consulting
 Engineers
 and Scientists
 400 Commercial Street, Suite 404
 Portland, ME 04101
 Tel. (207) 772-2891
 Fax (207) 772-3248
 www.ransomenv.com

UTILITY PLAN

3	ADDENDUM 3	10/11/17
2	ADDENDUM 2	08/15/17
1	REVISION 1	08/07/17
E	ISSUED FOR BID	07/14/17
D	PER CMP COMMENTS	06/30/17
C	PER REVIEW COMMENTS	06/09/17
B	CONSTRUCTION REVIEW	05/26/17
A	CITY SUBMISSION	03/09/17

Design by:	MPM	Checked by:	SJB
Drawn by:	JAR	Approved by:	SJB

Project:	150.06094	Date:	FEBRUARY 2017
----------	-----------	-------	---------------

Sheet No:
C1.1
 Sheet 5 of 22