

EssexNorth  
Portland LLC

Prepared For:

Consultant:

ARCHETYPE  
a r c h i t e c t s  
48 Union Wharf Portland, Maine 04101  
(207) 772-6022 Fax (207) 772-4056

Architect:

THAMES STREET  
CONDOMINIUM

Project:

20 Thames Street, Portland Maine

Revisions:

7/21/2017 BID SET

Scale:

1 1/2" = 1'-0"

Date:

JULY 21, 2017

INTERIOR WALL TYPES

A4.03

W31A	W31B	NON-RATED, NON-BEARING PARTITION
3 5/8"	6"	SOUND - N/A

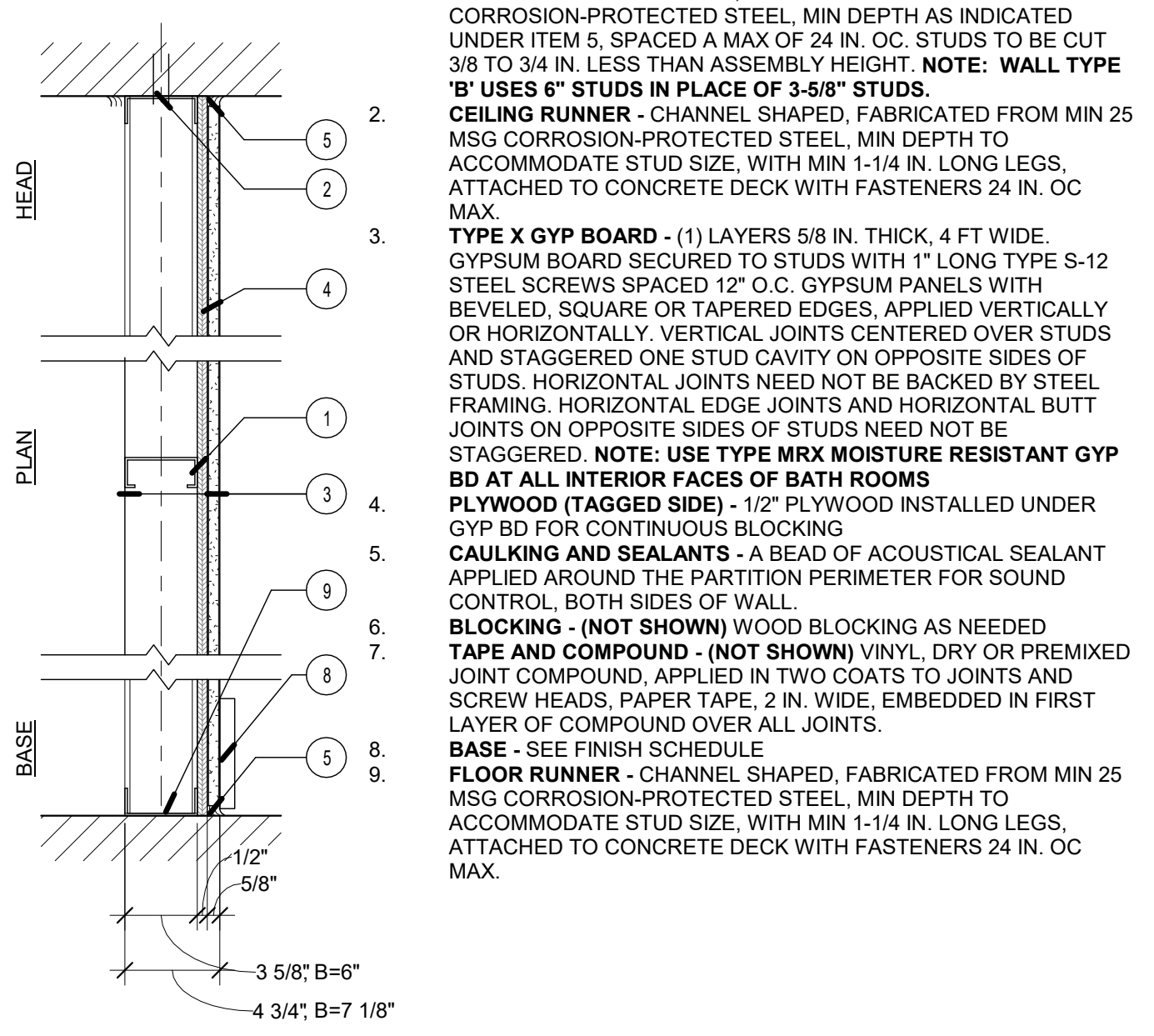

31 | WALL 31A&B - NON-RATED PARTITION  
1 1/2" = 1'-0"

W29A	W29B	NON-RATED, NON-BEARING PARTITION
3 5/8"	6"	SOUND - N/A

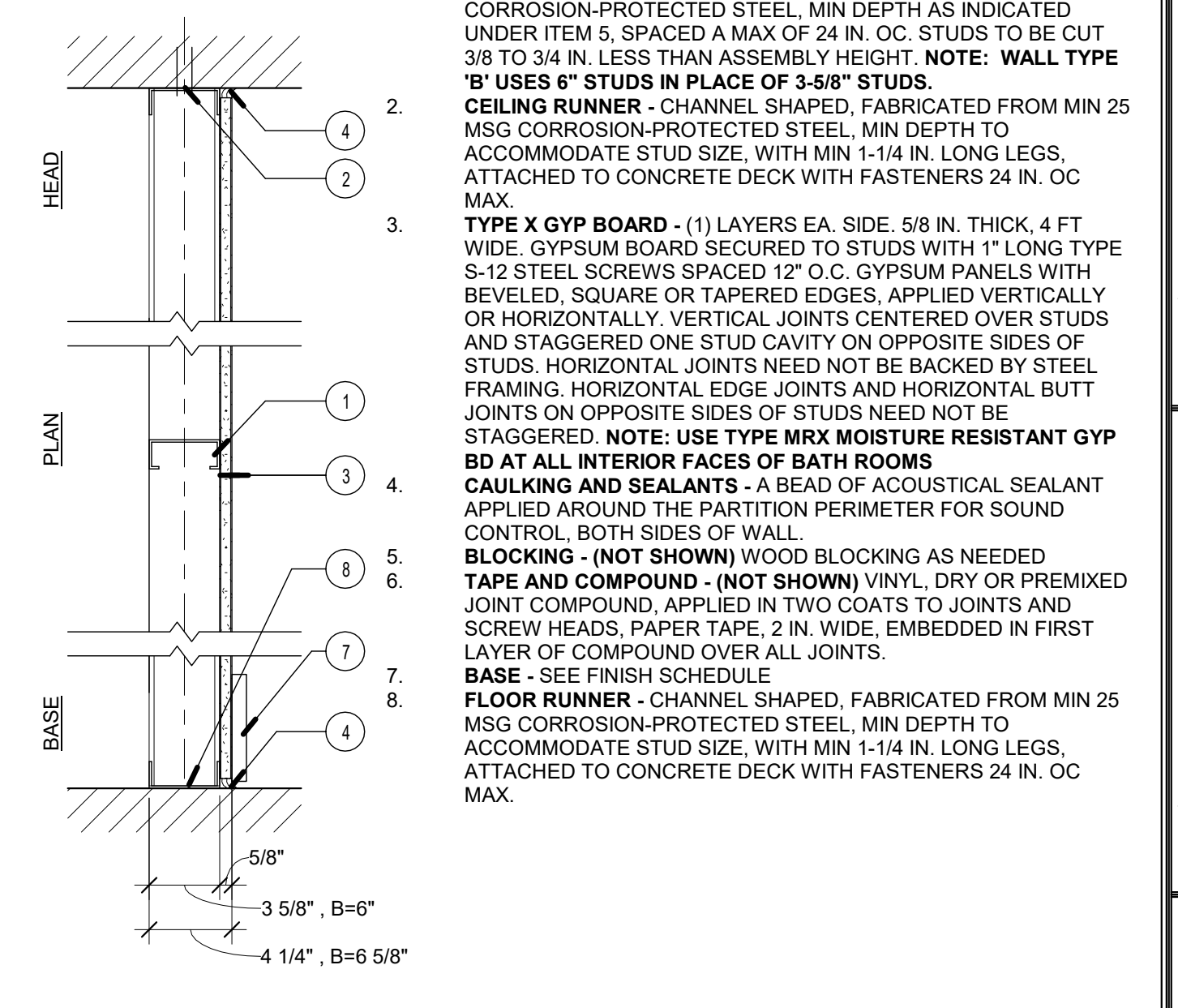

W29 | WALL 29A&B - NON-RATED FURRING WALL  
1 1/2" = 1'-0"

W30A	W30B	NON-RATED, NON-BEARING PARTITION
3 5/8"	6"	SOUND - N/A

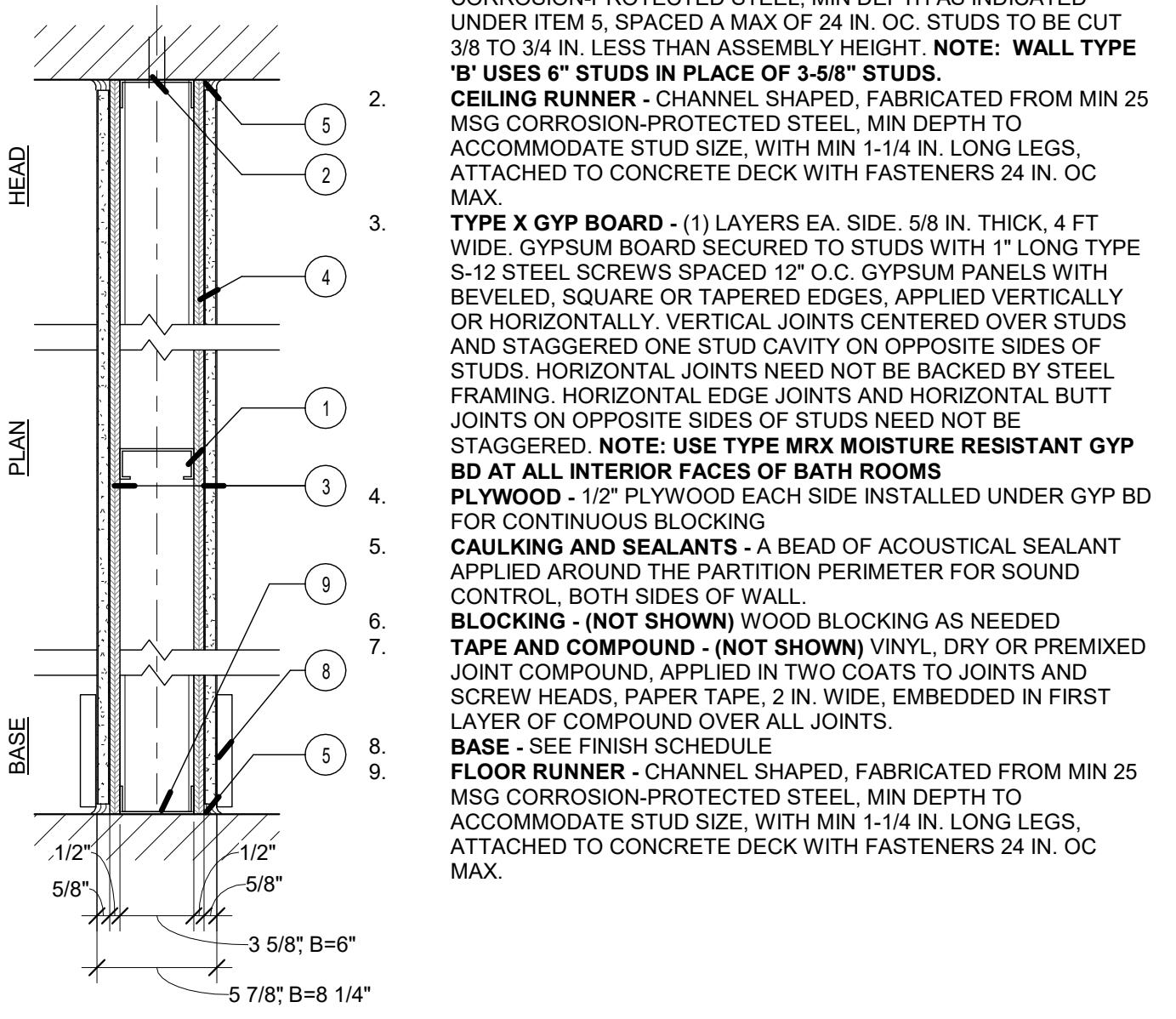

W30 | WALL 30A&B - NON-RATED PARTITION  
1 1/2" = 1'-0"

W28A	W28B	NON-RATED, NON-BEARING PARTITION
3 5/8"	6"	SOUND - N/A

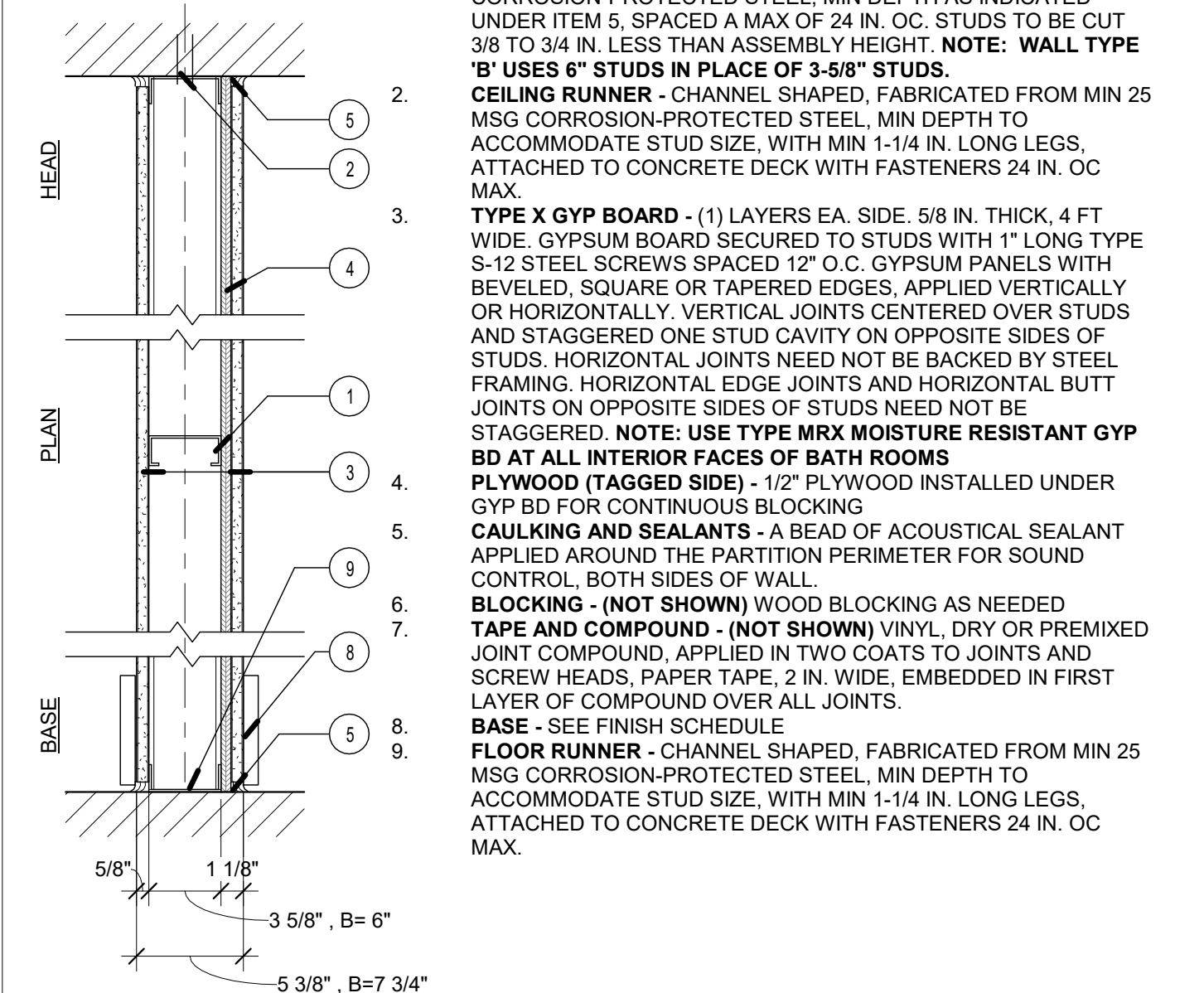

W28 | WALL 28A&B - NON-RATED PARTITION  
1 1/2" = 1'-0"