

SYMBOL LEGEND

⊗	DOOR TAG -REFER TO SHEET A6.04
⊗⊗	FINISH TAG -REFER TO DESIGN GUIDE PROJECT MANUAL MASTER
⊗⊗	ACCESSORY TAG -REFER TO SPEC SECTION 10800
X-000	FURNISHING REFERENCE - REFER TO INTERIOR DESIGN SPECIFICATIONS BOOK
XX-00	M.E.P. COMPONENT REFERENCE - REFER TO IPFS
J	JUNCTION, PULL OR TAP BOX, CEILING, WALL OR FLOOR MOUNTED
∇	TELEPHONE OUTLET
⊕	USB DATA JACK
⊕	TV OUTLET, FLUSH MOUNTED.
⊕	DUPLEX RECEPTACLE, 20A 125V, 3W, WALL MOUNTED NEMA 5-20R.
⊕	RECESSED CEILING LIGHTS.
⊕	USB OUTLET
⊕	MOTION SENSOR
⊕	THERMOSTAT

REFERENCE NOTES

- REFER TO INTERIOR PRODUCT AND FINISH SPECIFICATIONS.
- ELECTRICAL OUTLETS SHOWN ON ELEC-PLUMBING-MECH PLAN AND ON ELEVATIONS ARE FOR DEVICES AND FIXTURES SPECIFIED. ADDITIONAL OUTLETS MAY BE REQUIRED BY LOCAL BUILDING CODES.
- ELECTRICAL OUTLETS ARE MOUNTED AT STANDARD HEIGHT OF 18" UNLESS NOTED OTHERWISE.
- SWITCHES AND THERMOSTATS TO BE LOCATED AT 48" CENTERLINE AFF UNLESS NOTED OTHERWISE.
- REFER TO GUESTROOM ELEVATIONS FOR MOUNTING CONFIGURATIONS OF OUTLETS. COORDINATE FINAL LOCATIONS WITH CASEGOODS.
- SOME PRODUCTS, FIXTURES AND FURNITURE ITEMS ARE HANDED (LEFT OR RIGHT), DESIGNER TO COORDINATE, WHERE APPLICABLE.
- ALL DIMENSIONS ARE FROM FACE OF FINISH TO FACE OF FINISH, U.N.O. HOLD ALL CLEAR IN INTERIOR ROOM DIMENSIONS.
- WATER CLOSET WASTE LINES ARE TO BE LOCATED IN WALL CHASE, NOT IN EXTERIOR WALLS.

CRITERIA NOTES

- PROVIDE CONTINUOUS SOLID WOOD BLOCKING IN CEILING FOR DRAPERY ATTACHMENT AND SLIDING DOOR TRACKS.
- COORDINATE PARTITION DIMENSIONS WITH HVAC EQUIPMENT & CONFIGURATION.
- PROVIDE METAL TRIM TRANSITION (316) AT ALL OUTSIDE CORNERS OF BATHROOM.
- IRONING BOARD MOUNT (316) & IRON RACK MOUNT (328) TO BE COORDINATED WITH CLOSET INSERT.
- PROVIDE ACCENT VINYL (322)
- MASTER SWITCH WITH SIGNAGE TO CONTROL HARDWIRED LIGHTS AND SWITCHED OUTLETS IN GUESTROOM. WITH EXCEPTION OF BATHROOM. WIRE AHEAD OF INDIVIDUAL SWITCHES. SEE E2.02 FOR DETAIL.
- COORDINATION BY HEADBOARD INSTALLER & ELECTRICIAN WILL BE REQUIRED AND MAY REQUIRE NUMEROUS VISITS BY BOTH TRADES.
- WALL OUTLETS SHALL NOT OCCUR IN SAME WALL CAVITY OF ADJACENT GUESTROOMS. SEE "DETAIL AT OFFSET OUTLET LOCATIONS" ON E2.01.
- PROVIDE BLOCKING FOR ACCESSORIES, EQUIPMENT, AND FF&E AS REQUIRED.
- SUPPLY VALVE FOR WATER CLOSET SHALL BE LOCATED OPPOSITE ENTRY.
- AT HEARING IMPAIRED ROOM ONLY.
- NOT USED
- NOT USED
- PAINT EXTERIOR WINDOW WALL (309) WITH MOLD AND MILDEW TEXTURED FINISH.
- SIZE AND LOCATION OF EXTERIOR WINDOW TO BE ACCEPTED BY MARRIOTT.
- ARCHITECT TO REVIEW VANITY SHOP DRAWINGS IN IPFS FOR LATEST INFORMATION (INCLUDING DIMENSIONS & FINISHES), FOR CUSTOM VANITIES. ARCHITECT TO OBTAIN ACCEPTANCE FROM MARRIOTT REVIEW TEAM. ARCHITECT TO PROVIDE VANITY SUPPORT DESIGN. SUPPORT DESIGN SHOULD COMPLY WITH LOCAL CODES.
- 4-WAY/3-WAY SWITCHES AT HEADBOARD AND GUESTROOM ENTRY. WIRED TO LED STRIP LIGHT (L1) TO PLUG INTO OUTLET UNDER BENCH NEAR ENTRY TO BEDROOM.
- 4-WAY/3-WAY SWITCH AT HEADBOARD AND GUESTROOM ENTRY. WIRED TO OVERHEAD ENTRY & CLOSET LIGHTS. SEE E2.02 FOR DETAILS.
- REMOVABLE CEILING PANELS.
- DRAPERY PULL WANDS ARE LOOP TYPE HANDLES AND 48" MAX A.F.F.
- ANY GAP LEFT BETWEEN THE FLOORING MATERIAL AND THE GUESTROOM WALL SHOULD BE NO MORE THAN A 1/2" SO THAT THE BASE WILL COMPLETELY COVER THIS GAP.
- SECURE VANITY BASE TO FLOOR AND WALL. SECURE VANITY MIRROR TO CEILING. PROVIDE BLOCKING AS REQUIRED.
- WRAP DRAINAGE AND SUPPLY PIPES WITH INSULATING MATERIAL.
- PROVIDE (2) GFCI RECEPTACLES (EL-12) ABOVE COUNTER BACKSPLASH. CONNECT TOGETHER TO A DEDICATED SINGLE 120V CIRCUIT.
- ARCHITECT TO REVIEW DOOR & SHOWER ASSEMBLY SHOP DRAWINGS IN IPFS FOR LATEST INFORMATION (INCLUDING DIMENSIONS & FINISHES). FOR MODIFYING SHOWER ASSEMBLIES & DOORS, ARCHITECT TO OBTAIN ACCEPTANCE FROM MARRIOTT REVIEW TEAM.
- RECESSED LIGHTS ABOVE VANITY SHALL BE LOCATED WITHIN 6" OF WALL.
- STANDARD SWITCHED OUTLET SERVING LED STRIP LIGHT (L1) & NIGHT LIGHT (L2), MOUNTED ±16" AFF, ROTATED 90°. COLOR MATCH WC (322). SEE SHEET E2.02 FOR DETAILS.
- NIGHT LIGHT (L2) UNDER BENCH TO BE PLUGGED INTO ADJACENT OUTLET SO THAT PLUG CONTROLLING NIGHTLIGHT (L2) IS CONTROLLED BY SWITCH (EL-15).
- HOLES FOR LIGHTS IN CEILING PANELS TO BE CUT IN FIELD.
- BASE BOARD CAN BE PURCHASED THROUGH MARRIOTT AND IS IN THE ID SPEC MANUAL.
- REFRIGERATOR DOOR TO BE INSTALLED, SUCH THAT, DOOR SWINGS TOWARDS ADJACENT WALL.
- ELECTRICAL DEVICES FOR TV SHOULD NOT BE PROPRIETARY.
- LOW-VOLT, WIRELESS ACCESS POINT

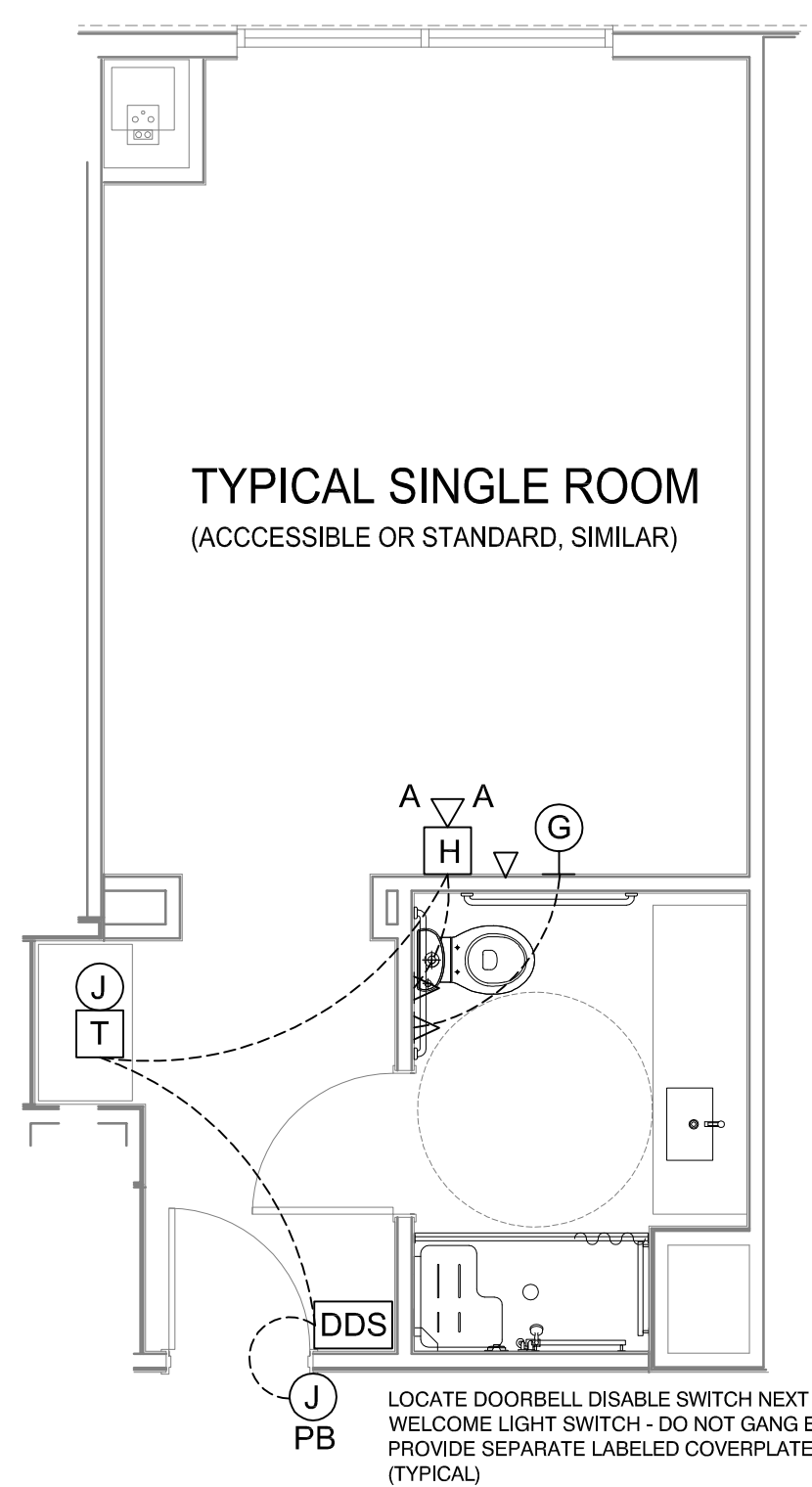
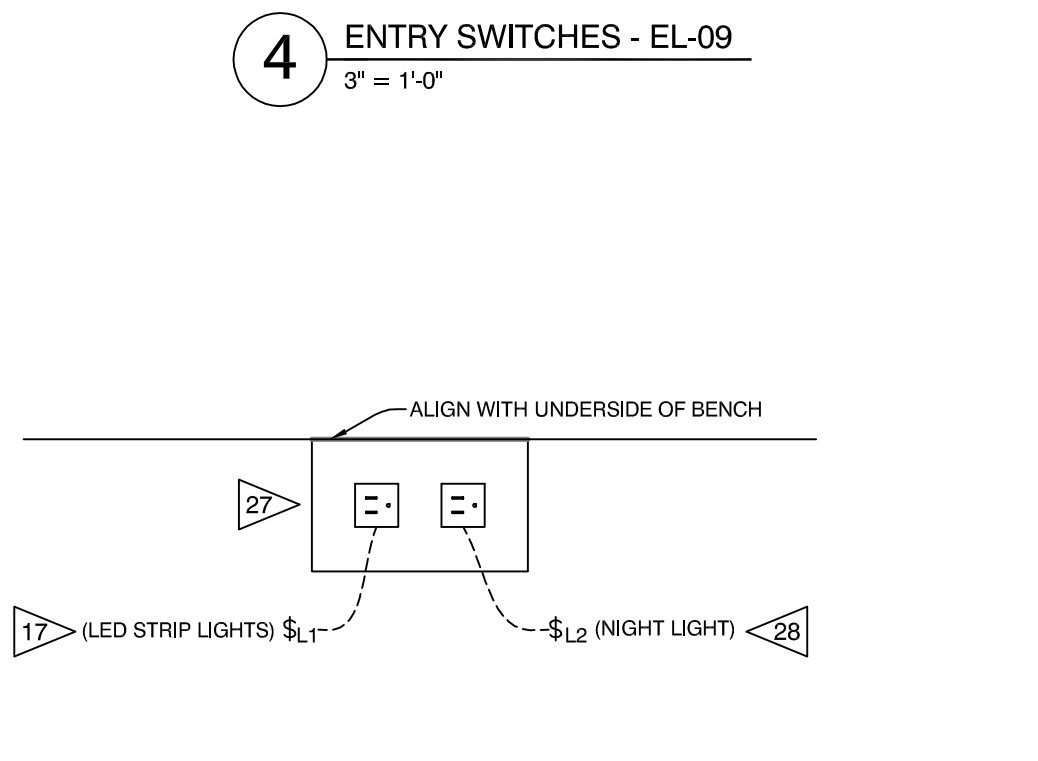
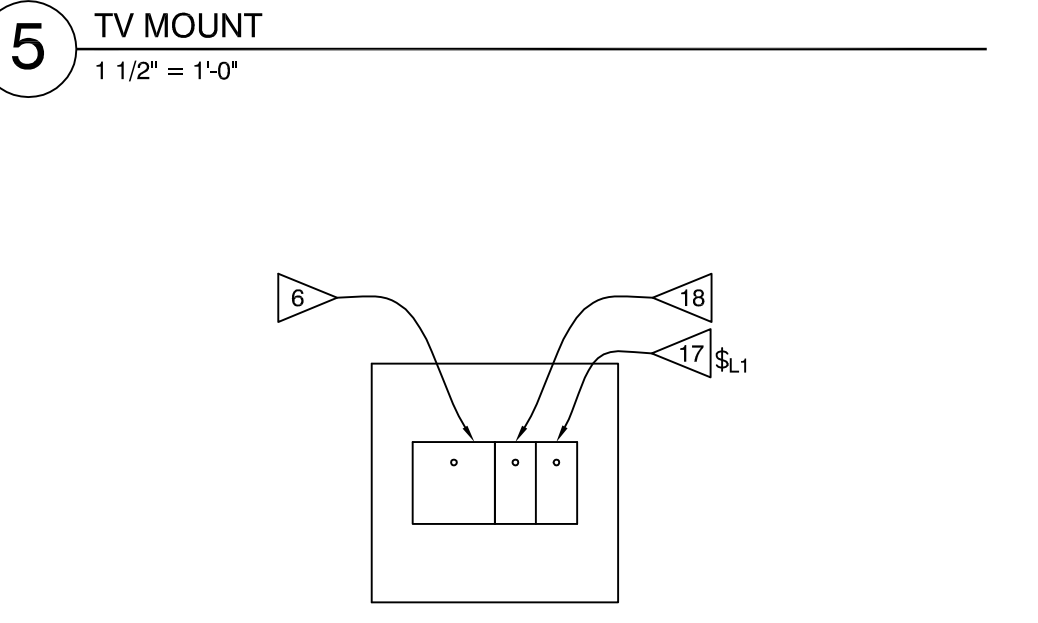
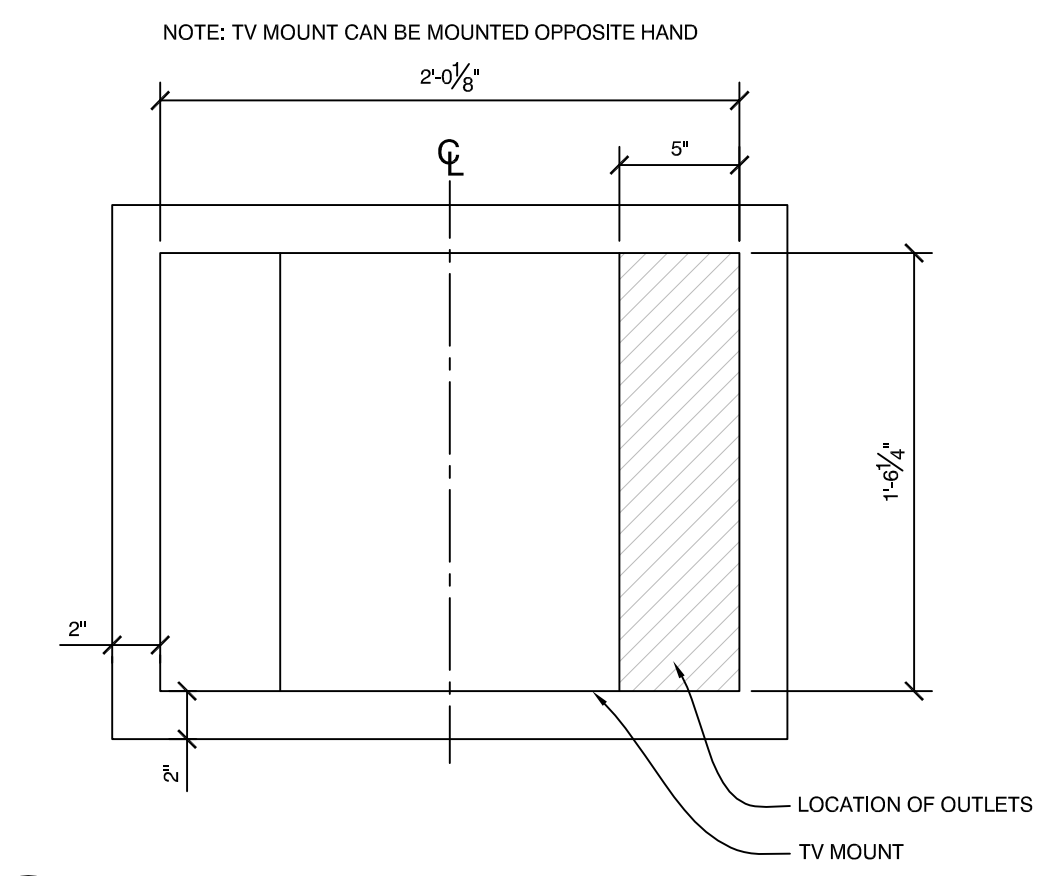
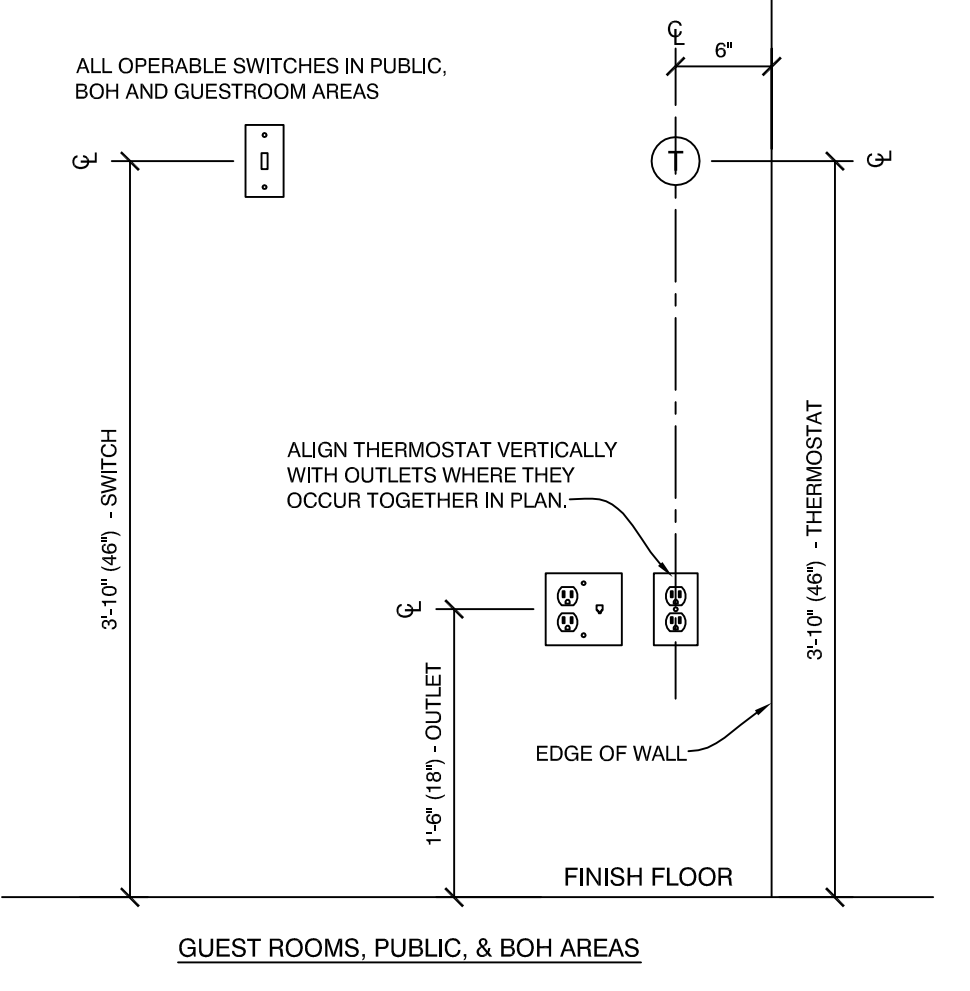
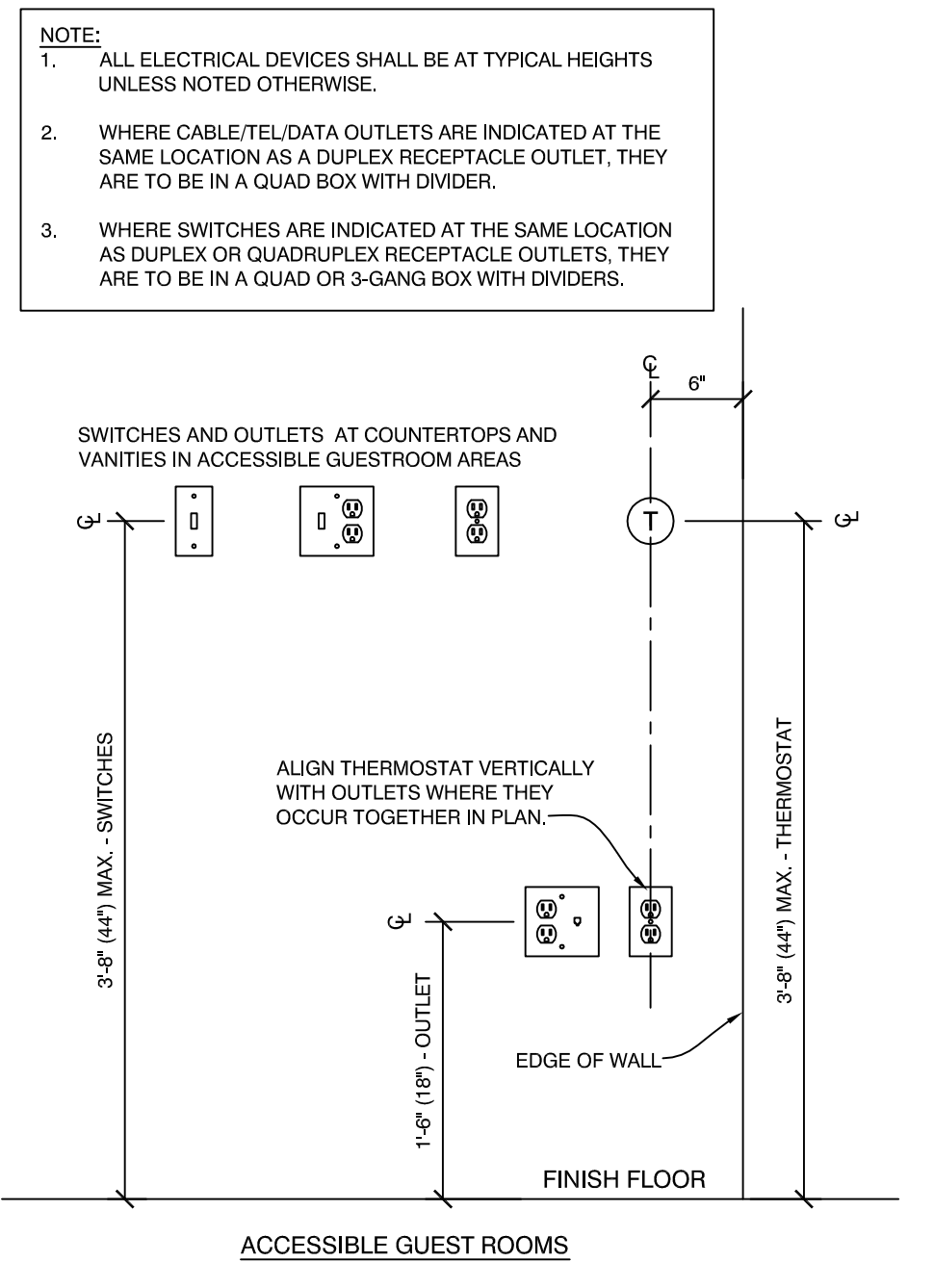
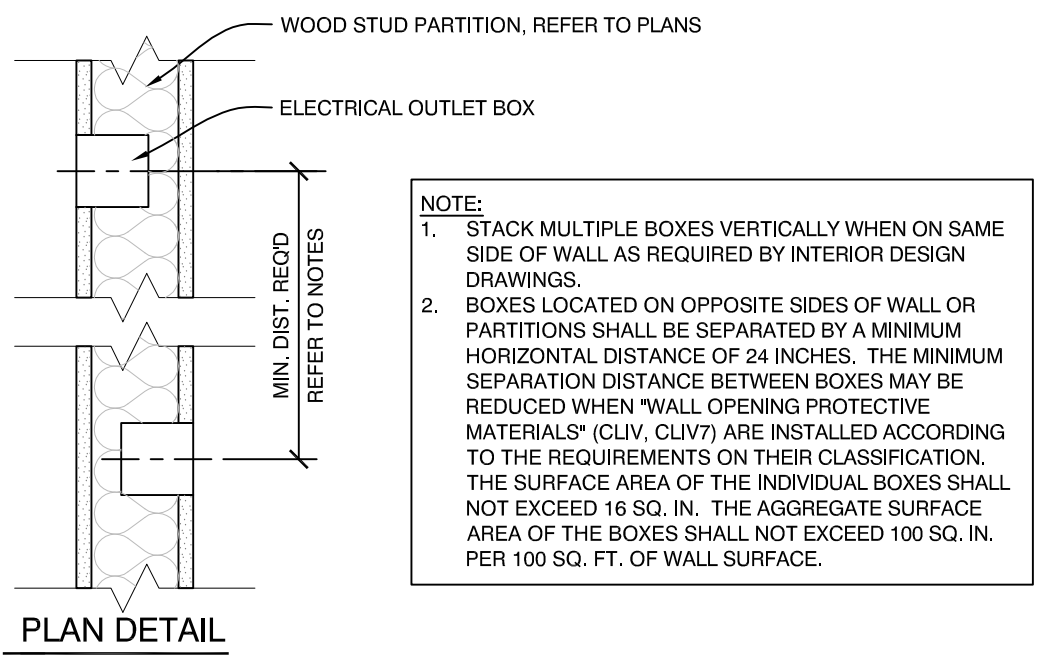

DEVICES FOR THE HEARING IMPAIRED

SYMBOL	DEVICE	NOTES
J PB	BUTTON FOR DOOR SIGNAL	OUTSIDE DOOR ON STRIKE SIDE, 48" AFF, FACTORY LABEL ON COVER PLATE
J T	2-GANG BOX WITH TRANSFORMER FOR DOOR BELL	MOUNT IN SOFFIT OR CABINET - PROVIDE ACCESS
DDS	DOORBELL DISABLE SWITCH	WALL BEHIND ENTRY DOOR, GANG W/ LIGHT SWITCH "DOORBELL DISABLE SWITCH" PLAQUE
H G	POINT ADDRESSIBLE SMOKE DETECTOR W/ SOUNDER BASE	MOUNT 4" - 12" BELOW CEILING "FIRE" LABEL INTEGRAL TO DEVICE.
A A H	HORN STROBE FOR DOOR SIGNAL	MOUNT 80" AFF
∇	REMOTE STROBE FIRE/DOOR SIG	MOUNT 80" AFF

NOTES:
 1. PROVIDE ASSISTIVE LISTENING DEVICES IN THE REQUIRED NUMBER OF ROOMS PER BUILDING CODES AND FEDERAL ACCESSIBILITY REGULATIONS.
 2. DISTRIBUTE HEARING IMPAIRED ROOMS AMONGST ALL CLASSES OF ROOMS INCLUDING SUITES.

6 HEARING IMPAIRED DEVICES
 1/4" = 1'-0"