

- GENERAL NOTES:**
1. BLOCKING TO BE PROVIDED FOR ALL WALL MOUNTED MILLWORK AND FF&E, G.C. TO COORDINATED WITH FF&E SPECIFICATIONS.
  2. ALL DOORS TO BE 1'-10" TO CENTERLINE OF OPENING FROM FINISHED WALL, UNLESS OTHERWISE NOTED.
  3. ALL DIMENSIONS TO BE FROM FACE OF FINISH WALL TO FACE OF FINISH WALL, UNLESS OTHERWISE NOTED.
  4. PROVIDE SEALANT AT ALL DISSIMILAR MATERIALS. TYP. VWC TO STONE, TILE TO STONE, PORCELAIN TO TILE, VWC TO DOOR FRAMES AND CEILINGS, ETC. COLOR TO MATCH ADJACENT FINISH.
  5. FLOORING TO EXTEND UNDER ALL FF&E, MILLWORK & BATHROOM VANITIES.
  6. MOISTURE RESISTANT GYPSUM BOARD TO BE USED AT ALL BATHROOM WALLS AND CEILINGS.
  7. ALL SOFFITS TO BE CONSTRUCTED BELOW RATED ASSEMBLY. SEE ARCHITECTURAL DRAWINGS.
  8. DRAIN, HOT & COLD WATER PIPES TO BE INSULATED AT ACC. VANITIES.
  9. ALL CLEAR DIMENSIONS TO BE COORDINATED WITH FIXTURES & EQUIPMENT.
  10. ALL HOLD DIMENSIONS TO BE ADHERED TO UNLESS PERMISSION IS EXPRESSED BY INTERIOR ARCHITECT IN SKETCH OR WRITING. WHERE HOLD DIMENSIONS CANNOT BE MET IN FIELD, IT MUST BE BROUGHT TO ATTENTION OF INTERIOR ARCHITECT PRIOR TO CONTINUING CONSTRUCTION.
  11. ALL PENETRATIONS THROUGH FIRE RATED WALLS SHALL BE PROTECTED & SEALED TO MAINTAIN WALL RATING. SEE PROJECT MANUAL FOR FIRESTOP ASSEMBLY TYPES
  12. PAINT ELECTRICAL PANELS, ACCESS PANELS, DIFFUSERS AND VENTS TO MATCH WALL/CEILING COLOR, TYPICAL. PAINT TO BE FACTORY FINISH OR ELECTROSTATIC AS REQUIRED TO MATCH FINISH.
  13. SEE SHEETS A7.01-A7.09 FOR INTERIOR ELEVATIONS.
  14. SEE SHEETS A9.01-A9.09 FOR INTERIOR MILLWORK DETAILS.
  15. SEE SHEET ID9.01 FOR ROOM FINISH SCHEDULE AND ID9.10-ID9.11 FOR FINISH DESCRIPTIONS.

- PUBLIC RESTROOM GENERAL NOTES:**
1. ALL PLUMBING FIXTURES ARE TO BE CONTRACTOR SUPPLIED, CONTRACTOR INSTALLED (CSCI) UNLESS OTHERWISE NOTED.
  2. GC TO COORDINATE PLUMBING CONNECTIONS AND ROUGH-IN REQUIREMENTS WITH FINAL OWNER APPROVED FIXTURES. GC TO COORDINATE LEFT AND RIGHT HANDING AS REQUIRED.
  3. MOISTURE RESISTANT GYPSUM BOARD TO BE USED AT ALL BATHROOM WALLS AND CEILINGS.
  4. BLOCKING TO BE PROVIDED FOR ALL WALL MOUNTED FF&E AND TO BE COORDINATED WITH FF&E SPECIFICATIONS.
  5. SEE SHEET ARCHITECTURAL DRAWINGS FOR ALL ACCESSORY MOUNTING HEIGHTS AND SCHEDULES.
  6. ALL DOORS TO BE 1'-10" TO CENTERLINE OF OPENING FROM FINISHED WALLS, UNLESS OTHERWISE NOTED.
  7. SEE PLUMBING DRAWINGS FOR ALL PLUMBING FIXTURE SPECIFICATIONS.
  8. WRAP PIPES AT WALL HUNG SINKS WITH INSULATING MATERIAL.

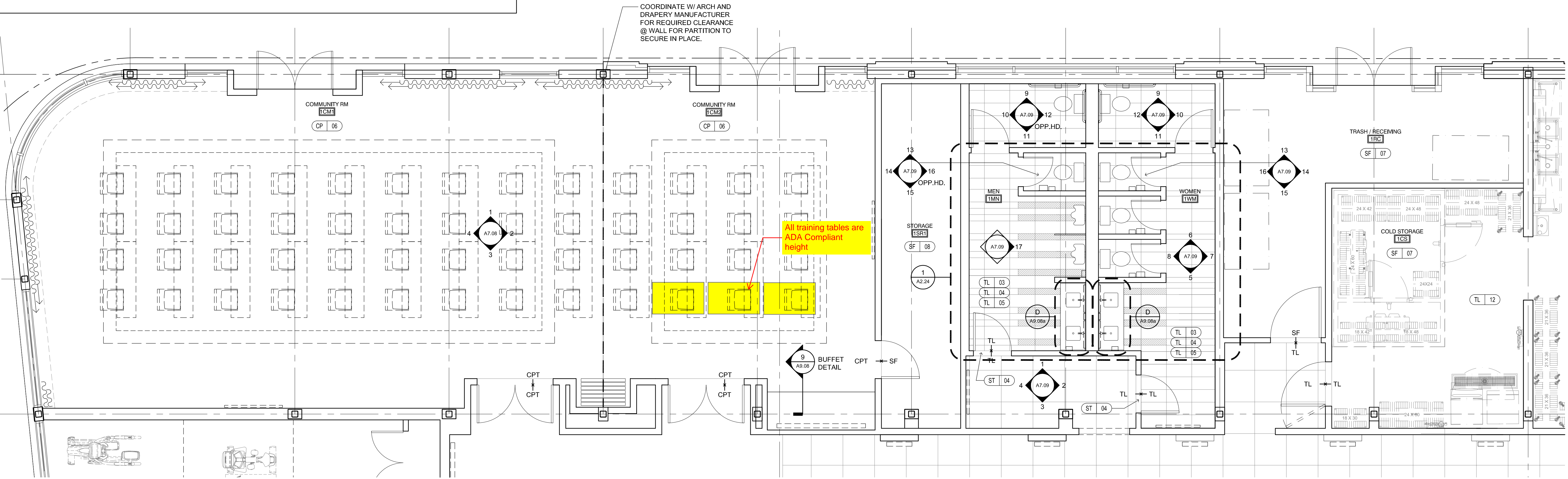
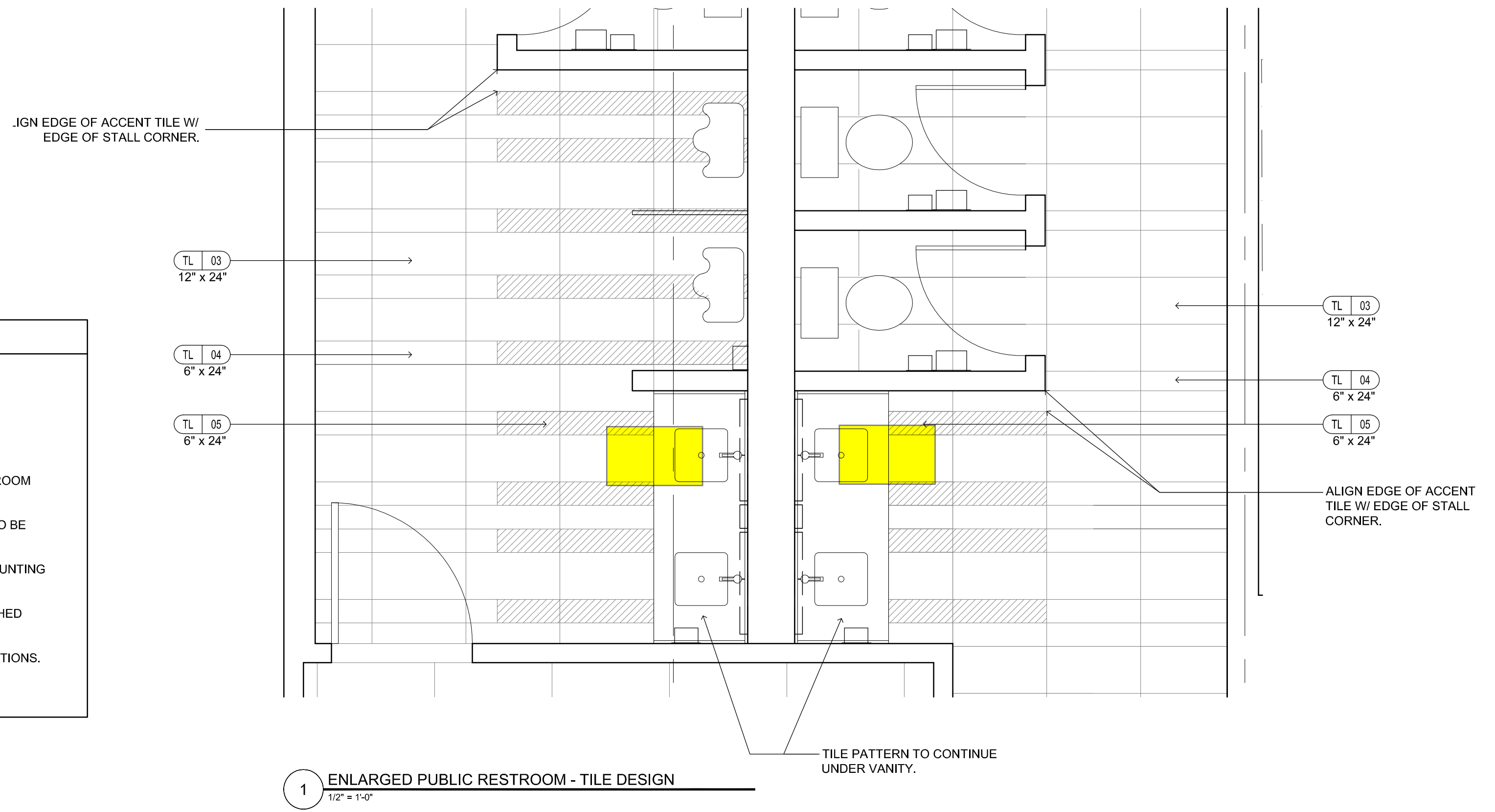

**A ENLARGED FINISH PLAN - PUBLIC RESTROOMS & MEETING ROOMS**  
SCALE: 1/4" = 1'-0"