

AC HOTELS by MARRIOTT
Fore Street / Hancock Street / Thames Street
Portland, Maine

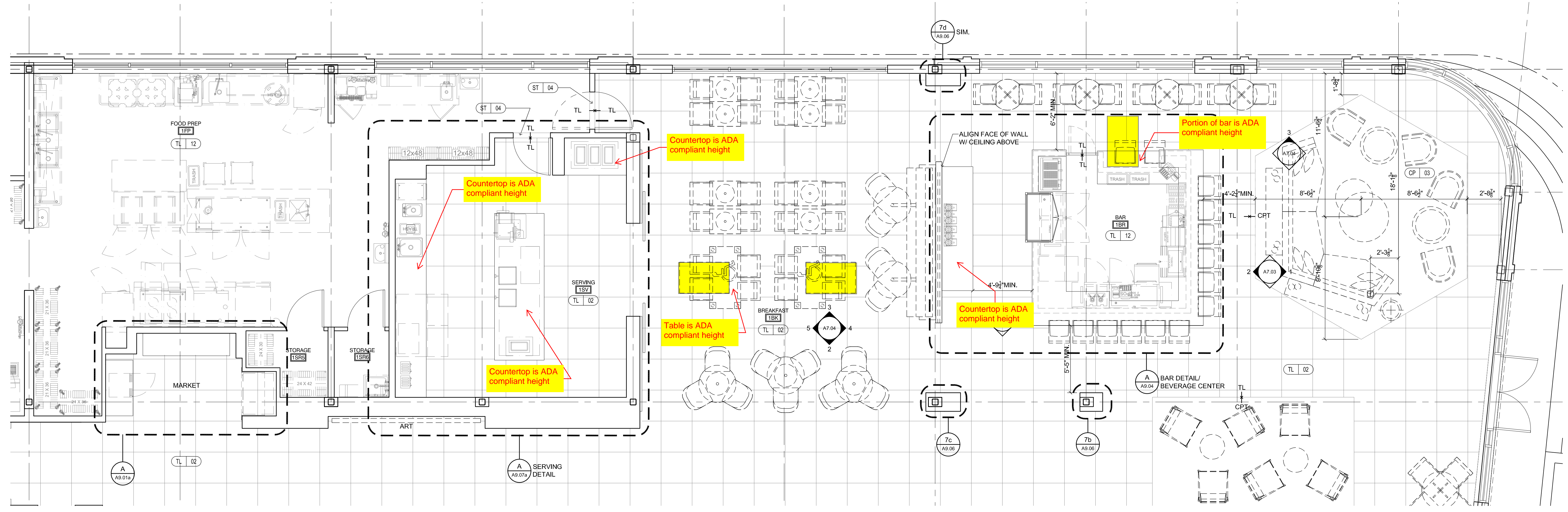

A ENLARGED FINISH PLAN - BREAKFAST & BAR
SCALE: 1/4" = 1'-0"

- GENERAL NOTES:**
1. BLOCKING TO BE PROVIDED FOR ALL WALL MOUNTED MILLWORK AND FF&E, G.C. TO COORDINATED WITH FF&E SPECIFICATIONS.
 2. ALL DOORS TO BE 1'-10" TO CENTERLINE OF OPENING FROM FINISHED WALL, UNLESS OTHERWISE NOTED.
 3. ALL DIMENSIONS TO BE FROM FACE OF FINISH WALL TO FACE OF FINISH WALL, UNLESS OTHERWISE NOTED.
 4. PROVIDE SEALANT AT ALL DISSIMILAR MATERIALS, TYP. VWC TO STONE, TILE TO STONE, PORCELAIN TO TILE, VWC TO DOOR FRAMES AND CEILINGS, ETC. COLOR TO MATCH ADJACENT FINISH.
 5. FLOORING TO EXTEND UNDER ALL FF&E, MILLWORK & BATHROOM VANITIES.
 6. MOISTURE RESISTANT GYPSUM BOARD TO BE USED AT ALL BATHROOM WALLS AND CEILINGS.
 7. ALL SOFFITS TO BE CONSTRUCTED BELOW RATED ASSEMBLY. SEE ARCHITECTURAL DRAWINGS.
 8. DRAIN, HOT & COLD WATER PIPES TO BE INSULATED AT ACC. VANITIES.
 9. ALL CLEAR DIMENSIONS TO BE COORDINATED WITH FIXTURES & EQUIPMENT.
 10. ALL HOLD DIMENSIONS TO BE ADHERED TO UNLESS PERMISSION IS EXPRESSED BY INTERIOR ARCHITECT IN SKETCH OR WRITING. WHERE HOLD DIMENSIONS CANNOT BE MET IN FIELD, IT MUST BE BROUGHT TO ATTENTION OF INTERIOR ARCHITECT PRIOR TO CONTINUING CONSTRUCTION.
 11. ALL PENETRATIONS THROUGH FIRE RATED WALLS SHALL BE PROTECTED & SEALED TO MAINTAIN WALL RATING. SEE PROJECT MANUAL FOR FIRESTOP ASSEMBLY TYPES
 12. PAINT ELECTRICAL PANELS, ACCESS PANELS, DIFFUSERS AND VENTS TO MATCH WALL/CEILING COLOR, TYPICAL. PAINT TO BE FACTORY FINISH OR ELECTROSTATIC AS REQUIRED TO MATCH FINISH.
 13. SEE SHEETS A7.01-A7.09 FOR INTERIOR ELEVATIONS.
 14. SEE SHEETS A9.01-A9.09 FOR INTERIOR MILLWORK DETAILS.
 15. SEE SHEET ID9.01 FOR ROOM FINISH SCHEDULE AND ID9.10-ID9.11 FOR FINISH DESCRIPTIONS.

REVISION:

ISSUED:
08-12-16 FOUNDATION & STEEL PERMIT
10-18-16 60% MARRIOTT REVIEW
05-19-17 90% MARRIOTT REVIEW

project architect: KAK
drawn by: FAC

EN. KEY & FINISH PLANS
BREAKFAST & BAR

sheet number:
A2.22