

Copyright © 2015 Opechee Construction Corporation  
Tuesday, October 18, 2016 3:59:40 PM

# AC Hotel

## Fore, Hancock & Thames Streets Portland, ME



### SYMBOLS LEGEND

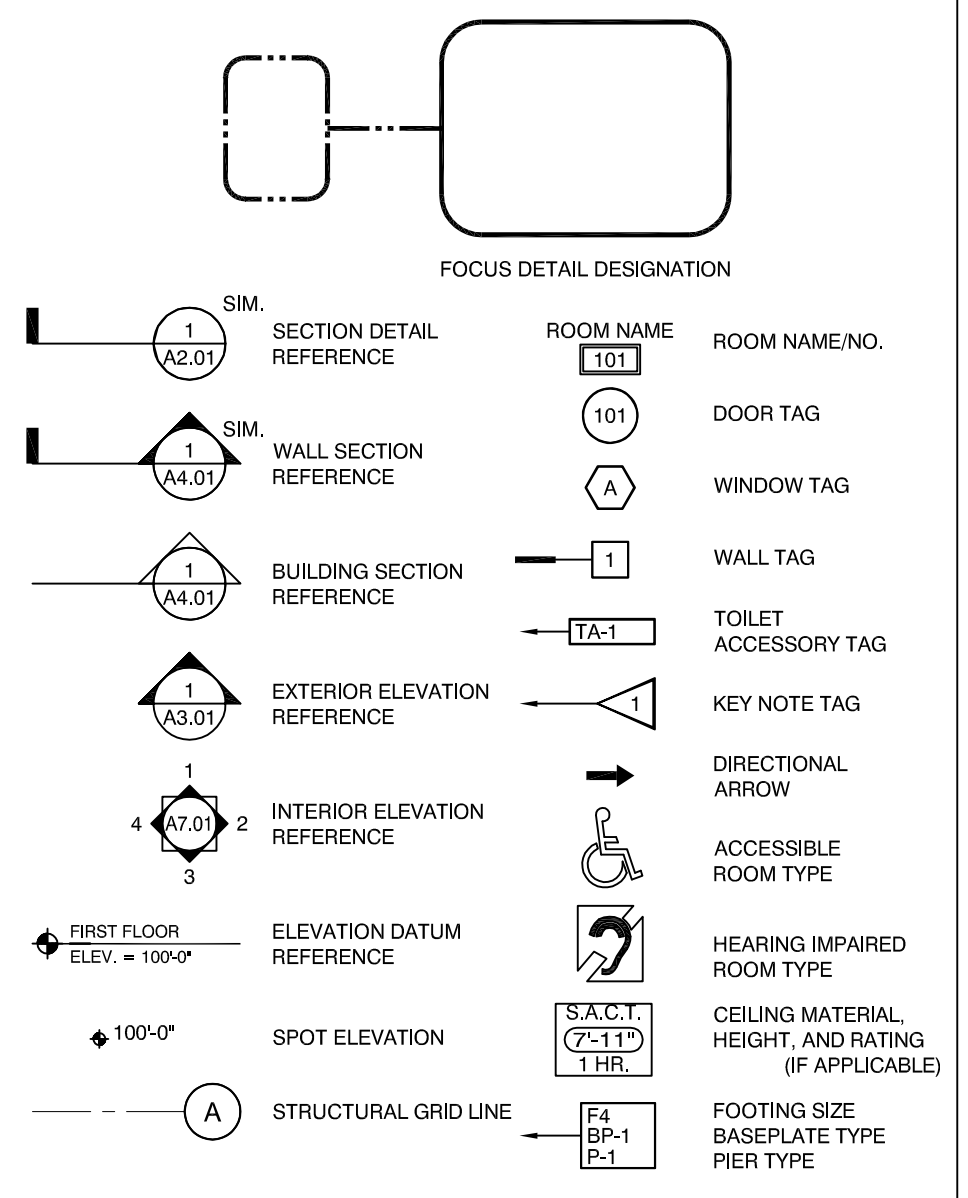

### MATERIALS LEGEND

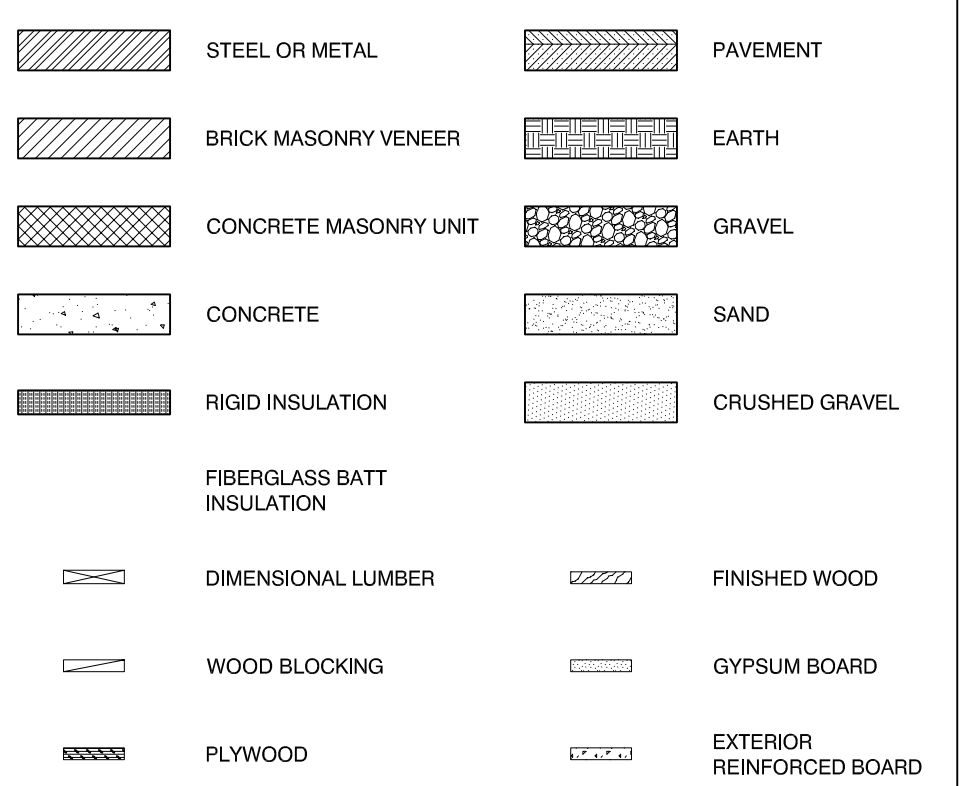

### GENERAL NOTES

- ALL WORK SHALL CONFORM TO ALL LOCAL, STATE, AND FEDERAL STANDARDS, CODES AND REGULATIONS. THIS SHALL INCLUDE, BUT NOT BE LIMITED TO, NFPA, IBC, SMACNA, UL, AND OSHA.
- THE CONTRACT DRAWINGS ARE INTENDED TO BE USED AS A GENERAL GUIDELINE. THEY ARE NOT INTENDED TO ILLUSTRATE PRECISE INSTALLATION DETAILS AND ROUTINGS. IT IS THE RESPONSIBILITY OF THE SUBCONTRACTOR TO DETERMINE EXACT INSTALLATION REQUIREMENTS AS DICTATED BY ON-SITE CONDITIONS. IT IS ALSO THE RESPONSIBILITY OF THE SUBCONTRACTOR TO INSTALL A COMPLETE AND PROPERLY FUNCTIONING SYSTEM. ANY SIGNIFICANT DESIGN ALTERATIONS, ADDITIONS, OR DISCREPANCIES SHALL BE BROUGHT TO THE ATTENTION OF THE DESIGN PROFESSIONAL BEFORE PROCEEDING WITH THE WORK.
- ALL PRODUCTS AND MATERIALS TO BE INSTALLED IN ACCORDANCE WITH THE MANUFACTURER'S WRITTEN RECOMMENDATIONS OR REQUIREMENTS. ANY DISCREPANCY BETWEEN DRAWINGS AND MANUFACTURER'S REQUIREMENTS SHALL BE BROUGHT TO THE ATTENTION OF THE DESIGN PROFESSIONAL BEFORE PROCEEDING WITH THE WORK.
- FASTENING SCHEDULE - ALL BUILDING COMPONENTS SHALL BE SECURED IN ACCORDANCE WITH THE BUILDING CODE REQUIREMENTS.
- FASTENERS IN PRESSURE TREATED AND FIRE RETARDANT WOOD SHALL BE HOT DIPPED ZINC COATED GALVANIZED STEEL, STAINLESS STEEL, SILICON BRONZE OR COPPER.
- PROVIDE ADEQUATE BLOCKING FOR ALL GRAB BARS, COUNTER TOPS, WORK STATION COUNTERS, CABINETS (BASE & WALL), DOOR/WINDOW FRAMING, AND ANY OTHER ATTACHED ACCESSORIES NOT MENTIONED HERE THAT WOULD TYPICALLY REQUIRE ADEQUATE BLOCKING FOR SECURE & REASONABLE INSTALLATION.
- THE BUILDING AND ITS ELEMENTS SHALL COMPLY WITH ICC/ANSI A117.1-2003 AND ALL APPLICABLE FEDERAL, STATE AND LOCAL REQUIREMENTS.

### FINISH NOTES

- G.W.B. SURFACES TO RECEIVE 1 COAT OF PRIMER & 2 COATS OF FINISH PAINT. (APPLIED BY ROLLER)
- SURFACES TO RECEIVE WALLPAPER SHALL BE PRIME PAINTED PRIOR TO WALLPAPER INSTALLATION.
- ALL UNFINISHED WOOD SURFACES TO BE URETHANED SHOULD RECEIVE A MINIMUM OF 3 COATS.
- A MIN. OF 50 S.F. OF EXCESS FINISH MATERIALS IS TO BE LEFT AT THE JOB SITE FOR FUTURE USE BY OWNER. (20 S.F. FOR MATERIALS COSTING IN EXCESS OF \$3.00/S.F.)
- ALL ELEVATOR PIT WALLS TO RECEIVE BITUMINOUS DAMPPROOFING.
- ALL INTERIOR PARTITIONS TO RECEIVE FIBERGLASS BATT SOUND INSULATION.
- USE MOISTURE RESISTANT GWB IN SHOWER ROOMS OR OTHER LOCATIONS SUBJECT TO REPEATED DAMP CONDITIONS AND MOISTURE ACCUMULATION.
- WOMEN'S AND MEN'S TOILET ROOMS SCHEDULED TO RECEIVE FIBERGLASS WALL PANELS SHALL HAVE THE PANELS GLUED TO GYP. BD. SUBSTRATE.

### OWNER:

Portland Norwich Group, LLC  
c/o Norwich Partners of  
Florida, LLC  
25 Foothill Street, Suite 1A  
Lebanon, NH 03766

### ARCHITECTS:

Opechee Construction Corporation  
11 Corporate Drive  
Belmont, NH 03220  
(603) 527-9090  
  
Interior  
Group One Partners  
21 W 3rd St, Boston, MA 02127  
(617) 268-7000

### ENGINEERS:

Structural  
JSN Associates Inc  
1 Autumn Street  
Portsmouth, NH 03801  
(603) 433-8639  
  
Civil  
Ransom Consulting  
Engineers and Scientists  
400 Commercial St, Suite 404  
South Portland, ME 04101  
(207) 772-2891

### MEP

design-build (to be determined)

### CONTRACTOR:

Opechee Construction Corporation  
11 Corporate Drive  
Belmont, NH 03220  
(603) 527-9090  
www.opechee.com

### ADDRESS

### LOCAL MAP

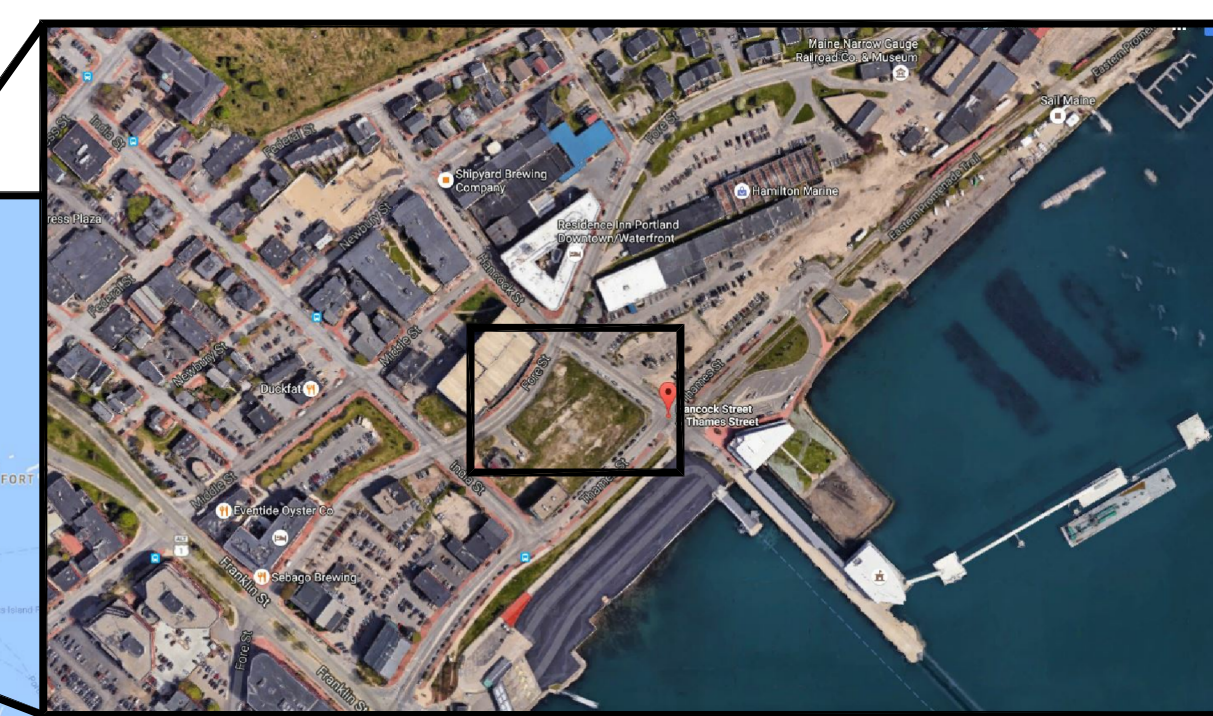

### VICINITY MAP

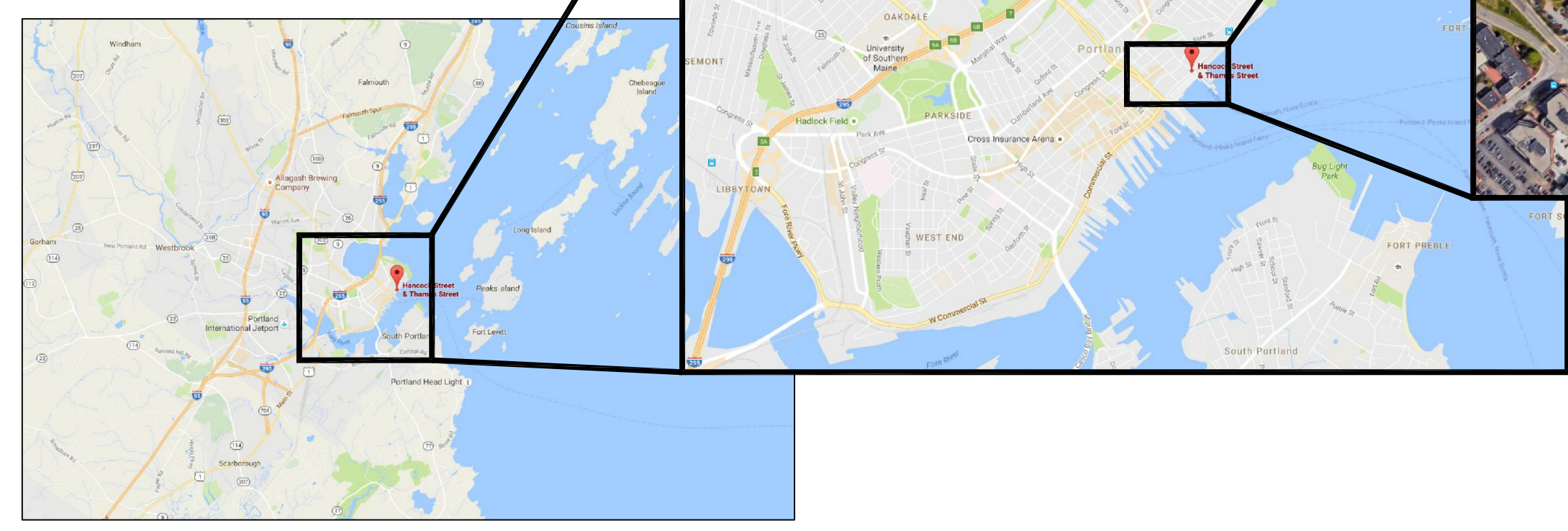

### ABBREVIATIONS

|               |                              |               |                               |
|---------------|------------------------------|---------------|-------------------------------|
| &             | And                          | LLH           | Long Leg Horizontal           |
| @             | At                           | LLV           | Long Leg Vertical             |
| +/-           | Plus/Minus                   | LT. GA. MTL.  | Light Gauge Metal Framing     |
| A/C           | Air Conditioning             | LT. WT.       | Light Weight                  |
| ADJ.          | Adjacent                     | M.S.          | Masonry                       |
| AFF or A.F.F. | Above Finish Floor           | MAX.          | Maximum                       |
| ALUM          | Aluminum                     | MDO           | Medium Density Overlay        |
| APPROX.       | Approximate                  | MECH.         | Mechanical                    |
| ARCH.         | Architectural                | MECH.         | Mechanical                    |
| ASPH.         | Asphalt                      | MFR.          | Manufacturer                  |
| ATTN.         | Attention                    | M.H.          | Man Hole                      |
| BD            | Board                        | MIN.          | Minimum                       |
| BIT.          | Bituminous                   | MISC.         | Miscellaneous                 |
| BLDG.         | Building                     | M.O.          | Masonry Opening               |
| BLK.          | Block                        | M.R.          | Moisture Resistant            |
| BLKG.         | Blocking                     | MTD.          | Mounted                       |
| BM.           | Beam                         | MTG.          | Meeting                       |
| B.O.          | Bottom of                    | MTL.          | Metal                         |
| BOT.          | Bottom                       | MULL.         | Mullion                       |
| BRG.          | Bearing                      | N.            | North                         |
| BRK.          | Brick                        | N.A.          | Not Applicable                |
| BRKMTL.       | Break Metal                  | NECVY         | Necessary                     |
| C or CH.      | Channel                      | N.I.C.        | Not in Contract               |
| CAB.          | Cabinet                      | NO.           | Number                        |
| CB or C.B.    | Cement Board                 | NOM.          | Nominal                       |
| C.C.          | Center to Center             | NGN COMB.     | Non Combustible               |
| CER.          | Ceramic                      | N.T.S.        | Not to Scale                  |
| CFS           | Clear Floor Space            | O.A.          | Overall                       |
| C.J.          | Control Joint                | O.C.          | On Center                     |
| CL or C       | Centerline                   | O.D.          | Outside Diameter              |
| CLG.          | Ceiling                      | OFF.          | Office                        |
| CLR.          | Clear                        | O.H.          | Overhead                      |
| CMU           | Concrete Masonry Unit        | OPNG.         | Opening                       |
| COMM.         | Communication                | OPP.          | Opposite                      |
| COL.          | Column                       | PARTN.        | Partition                     |
| CONC.         | Concrete                     | PL.           | Plas                          |
| CONT.         | Continuous                   | P. LAM.       | Plastic Laminate              |
| CORR.         | Corridor                     | PLBG.         | Plumbing                      |
| CPT           | Carpet                       | PLYWD.        | Plywood                       |
| CT            | Ceramic Tile                 | PNL           | Panel                         |
| C.W.          | Cold Water                   | PORC.         | Porcelain                     |
| DBL.          | Double                       | PR            | Pail                          |
| DEPT.         | Department                   | PSF           | Pounds per Square Foot        |
| DIA.          | Diameter                     | PT            | Porcelain Tile                |
| DIV.          | Division                     | P.T.          | Pressure Treated              |
| DN            | Down                         | FWR.          | Power                         |
| DRN.          | Drain                        | R.A.          | Return Air                    |
| DTL.          | Detail                       | RAD.          | Radius                        |
| DWG.          | Drawing                      | RD.           | Root Drain                    |
| E.            | East                         | REC.          | Recessed                      |
| EA.           | Each                         | RECV or RECYD | Receive or Recycled           |
| E.J.          | Expansion Joint              | REF.          | Refrigerator                  |
| ELEC.         | Electrical                   | REG.          | Regular                       |
| ELEV.         | Elevation                    | REINF.        | Reinforced                    |
| ENCL.         | Enclosure                    | REIN.         | Reinforcement                 |
| ENG.          | Engineer                     | RES.          | Resilient                     |
| EQ.           | Equal                        | RM.           | Room                          |
| EQUIP.        | Equipment                    | R.O.          | Roof Opening                  |
| E.W.          | Each Way                     | S.            | South                         |
| EXP.          | Expansion                    | SACT          | Susp. Acoustical Ceiling Tile |
| EXT.          | Exterior                     | SC            | Sealed Concrete               |
| F.            | Fire Alarm                   | SCHED.        | Schedule                      |
| F.D.          | Floor Drain                  | SECT.         | Section                       |
| F.E.C.        | Fire Extinguisher            | SHT.          | Sheet                         |
| F.E.C.        | Fire Extinguisher Cabinet    | SIM.          | Similar                       |
| FIN.          | Finish                       | S.M.          | Surface Mounted               |
| FLR.          | Floor                        | SPEC.         | Specification                 |
| FND.          | Foundation                   | SO.           | Square                        |
| F.R.          | Fire Resistant               | S.S.          | Stainless Steel               |
| FRM.          | Frame                        | ST.           | Street                        |
| F.R.P.        | Fiber Reinforced Plastic     | STD.          | Standard                      |
| F.R.T.        | Fire Retardant Treated       | STL.          | Steel                         |
| FT.           | Foot (feet)                  | STOR.         | Storage                       |
| FTG.          | Footing                      | STRUC.        | Structural                    |
| GA.           | Gauge                        | SUSP.         | Suspended                     |
| GALV.         | Galvanized                   | SYM.          | Symmetrical                   |
| G.B.          | Gypsum Board                 | T&B           | Top and Bottom                |
| GEN.          | General                      | TEL.          | Telephone                     |
| GL            | Glass/Glazing                | TEMP.         | Temporary                     |
| G.S.M.        | Galvanized Sheet Metal       | T&G           | Tongue and Groove             |
| GYP.          | Gypsum                       | THRU          | Through                       |
| GYP. BD.      | Gypsum Board                 | T.O.          | Top of                        |
| HB            | Hose Bib                     | TR.           | Tread                         |
| HC            | Handicapped                  | T.S.          | Tube Steel                    |
| HDWD.         | Hardwood Floors              | TV            | Television                    |
| HGT.          | Height                       | TYP.          | Typical                       |
| HM            | Hollow Metal                 | U.N.O.        | Unless Noted Otherwise        |
| HORIZ.        | Horizontal                   | VAR.          | Vertical                      |
| HR.           | Hollow Structural Section    | V.B.          | Vertical Bracing              |
| HSS           | Heating, Ventilation and A/C | VCT           | Vinyl Composition Tile        |
| HVAC          | Hot water                    | VERT.         | Vertical                      |
| H.W.          | Inside Diameter              | V.I.F.        | Verify in Field               |
| I.D.          | Inch(es)                     | W.            | West                          |
| IN.           | Information                  | W.            | With                          |
| INFO.         | Insulation                   | W.C.          | Water Closet                  |
| INSUL.        | Interior                     | WO.           | Wood                          |
| INT.          | Invert                       | W.F.          | Wide Flange                   |
| INV.          | Janitor(s)                   | WN.           | Waterproof                    |
| JAN.          | Joint                        | WM.           | Wire Mesh                     |
| JNT.          | Kitchen                      | W/O           | Without                       |
| KIT.          | Knock out                    | W.P.          | Waterproof                    |
| K.O.          | Laboratory                   | W.SCT.        | Waterproof                    |
| LAB.          | Laminate                     | WT.           | Weight                        |
| LAM.          | Laminate                     | W.V.          | Water Valve                   |
| LAV.          | Lavatory                     | W.W.F.        | Welded Wire Fabric            |
| LB. or LBS.   | Pound(s)                     | WWM           | Welded Wire Mesh              |

### INDEX OF DRAWINGS

|                       |  |
|-----------------------|--|
| <b>CIVIL:</b>         | COVER SHEET  |
| 1                     | - BOUNDARY PLAN  |
| C.0.1                 | - EXISTING CONDITIONS PLAN                                   |
| C.1.0                 | - SITE PLAN  |
| C.1.1                 | - UTILITY PLAN   |
| C.1.2                 | - GRADING, DRAINAGE AND EROSION CONTROL PLAN                 |
| C.2.0                 | - CONSTRUCTION DETAILS AND NOTES                             |
| C.2.1                 | - CONSTRUCTION DETAILS                                       |
| C.2.2                 | - CONSTRUCTION DETAILS                                       |
| C.2.3                 | - CONSTRUCTION DETAILS                                       |
| C.2.4                 | - CONSTRUCTION DETAILS                                       |
| C.2.5                 | - CONSTRUCTION DETAILS                                       |
| L.1.0                 | - LANDSCAPE AND LIGHTING PLAN                                |
| L.2.0                 | - LANDSCAPE DETAILS  |
| L.3.0                 | - PHOTOMETRIC PLAN   |
| <b>STRUCTURAL:</b>    | S0.01 - STRUCTURAL NOTES                                     |
|                       | S0.02 - SCHEDULE OF SPECIAL INSPECTIONS                      |
|                       | S1.01 - FOUNDATION PLAN                                      |
|                       | S2.01 - FOUNDATION DETAILS                                   |
|                       | S2.02 - FOUNDATION DETAILS                                   |
|                       | S3.01 - SECOND FLOOR FRAMING PLAN                            |
|                       | S3.02 - THIRD FLOOR FRAMING PLAN                             |
|                       | S3.03 - FOURTH FLOOR FRAMING PLAN                            |
|                       | S3.04 - FIFTH FLOOR FRAMING PLAN                             |
|                       | S3.05 - SIXTH FLOOR FRAMING PLAN                             |
|                       | S3.06 - ROOF FRAMING PLAN                                    |
|                       | S3.07 - ELEVATOR & ROOF SCREENING PLAN                       |
|                       | S4.01 - FRAMING DETAILS                                      |
|                       | S4.02 - FRAMING DETAILS                                      |
|                       | S4.03 - BRACED FRAME ELEVATIONS                              |
|                       | S4.04 - BRACED FRAME ELEVATIONS                              |
| <b>ARCHITECTURAL:</b> | CS1.01 - COVER SHEET   |
|                       | LS1.01 - LIFE SAFETY CODE INFORMATION                        |
|                       | LS1.02 - LIFE SAFETY CODE PLANS                              |
|                       | LS2.01 - WALL TYPE SCHEDULE                                  |
|                       | LS2.02 - WALL TYPE & HORIZONTAL ASSEMBLY SCHEDULE            |
|                       | A1.01 - FIRST FLOOR PLAN                                     |
|                       | A1.02 - SECOND FLOOR PLAN                                    |
|                       | A1.03 - THIRD FLOOR PLAN                                     |
|                       | A1.04 - FOURTH FLOOR PLAN                                    |
|                       | A1.05 - FIFTH FLOOR PLAN                                     |
|                       | A1.06 - SIXTH FLOOR PLAN                                     |
|                       | A1.07 - ROOF PLAN  |
|                       | A2.01 - ENLARGED FLOOR PLAN                                  |
|                       | A2.02 - ENLARGED FLOOR PLAN                                  |
|                       | A2.03 - ENLARGED FLOOR PLAN                                  |
|                       | A2.04 - ENLARGED FLOOR PLAN                                  |
|                       | A2.05 - KING SOFA K18 - RIGHT PLANS & ELEVATIONS             |
|                       | A2.06 - METRO KING K2 - LEFT PLANS & ELEVATIONS              |
|                       | A2.07 - KING SOFA K4 ADA - LEFT PLANS & ELEVATIONS           |
|                       | A2.08 - QUEEN-QUEEN QO1A - RIGHT PLANS & ELEVATIONS          |
|                       | A2.09 - QUEEN-QUEEN QO2 ADA - RIGHT SUITE PLANS & ELEVATIONS |
|                       | A2.10 - 1 BEDROOM KS1 - RIGHT PLANS & ELEVATIONS             |
|                       | A2.11 - 1 BEDROOM KS2 ADA - RIGHT PLANS & ELEVATIONS         |
|                       | A2.12 - 1 BEDROOM BATHROOM PLANS & ELEVATIONS                |
|                       | A2.21 - ENLARGED KEY & FINISH PLAN                           |
|                       | A2.22 - ENLARGED KEY & FINISH PLAN                           |
|                       | A2.23 - ENLARGED KEY & FINISH PLAN                           |
|                       | A2.24 - ENLARGED KEY & FINISH PLAN                           |
|                       | A3.01 - EXTERIOR BUILDING ELEVATIONS                         |
|                       | A3.02 - EXTERIOR BUILDING ELEVATIONS                         |
|                       | A3.03 - EXTERIOR BUILDING ELEVATIONS                         |
|                       | A4.01 - A4-22 WALL SECTIONS WITH DETAILS                     |
|                       | A5.01 - STAIR 1 PLANS & SECTIONS                             |
|                       | A5.02 - STAIR 2 PLANS & SECTIONS                             |
|                       | A5.03 - ELEVATOR PLANS & SECTIONS                            |
|                       | A5.04 - ELEVATOR SECTIONS                                    |
|                       | A5.05 - LINEN CHUTE SECTION                                  |
|                       | A6.01 - WINDOW & DOOR ELEVATIONS                             |
|                       | A6.02 - WINDOW & DOOR ELEVATIONS                             |
|                       | A6.03 - PUBLIC DOOR SCHEDULE & ELEVATIONS                    |
|                       | A6.04 - GUESTROOM DOOR SCHEDULE & ELEVATIONS                 |
|                       | A7.01 - INTERIOR ELEVATIONS                                  |
|                       | A7.02 - INTERIOR ELEVATIONS                                  |
|                       | A7.03 - INTERIOR ELEVATIONS                                  |
|                       | A7.04 - INTERIOR ELEVATIONS                                  |
|                       | A7.05 - INTERIOR ELEVATIONS                                  |
|                       | A7.06 - INTERIOR ELEVATIONS                                  |
|                       | A7.07 - INTERIOR ELEVATIONS                                  |
|                       | A7.08 - INTERIOR ELEVATIONS                                  |
|                       | A7.09 - INTERIOR ELEVATIONS                                  |
|                       | A8.01 - FIRST FLOOR REFLECTED CEILING PLAN                   |
|                       | A8.05 - SECOND FLOOR REFLECTED CEILING PLAN                  |
|                       | A8.06 - THIRD FLOOR REFLECTED CEILING PLAN                   |
|                       | A8.07 - FOURTH FLOOR REFLECTED CEILING PLAN                  |
|                       | A8.08 - FIFTH FLOOR REFLECTED CEILING PLAN                   |
|                       | A8.09 - SIXTH FLOOR REFLECTED CEILING PLAN                   |
|                       | A8.21 - ENLARGED FIRST FLOOR REFLECTED CEILING PLAN          |
|                       | A8.22 - ENLARGED FIRST FLOOR REFLECTED CEILING PLAN          |
|                       | A8.23 - ENLARGED FIRST FLOOR REFLECTED CEILING PLAN          |
|                       | A8.24 - ENLARGED FIRST FLOOR REFLECTED CEILING PLAN          |
|                       | A9.01 - INTERIOR DETAILS                                     |
|                       | A9.02 - INTERIOR DETAILS                                     |
|                       | A9.03 - INTERIOR DETAILS                                     |
|                       | A9.04 - INTERIOR DETAILS                                     |
|                       | A9.05 - INTERIOR DETAILS                                     |
|                       | A9.06 - INTERIOR DETAILS                                     |
|                       | I02.21 - ENLARGED FURNITURE PLANS                            |
|                       | I02.22 - ENLARGED FURNITURE PLANS                            |
|                       | I02.23 - ENLARGED FURNITURE PLANS                            |
|                       | I02.24 - ENLARGED FURNITURE PLANS                            |
|                       | I02.25 - ENLARGED FURNITURE PLANS KING                       |
|                       | I02.26 - ENLARGED FURNITURE PLANS QUEEN QUEEN                |
|                       | I02.27 - ENLARGED FURNITURE PLANS 1 BEDROOM                  |
|                       | I09.01 - FINISH SCHEDULE                                     |
|                       | I09.10 - FINISH DESCRIPTION - GROUND FLOOR                   |
|                       | I09.11 - FINISH DESCRIPTION - GUESTROOM FLOORS               |

### PLAN DIMENSIONING

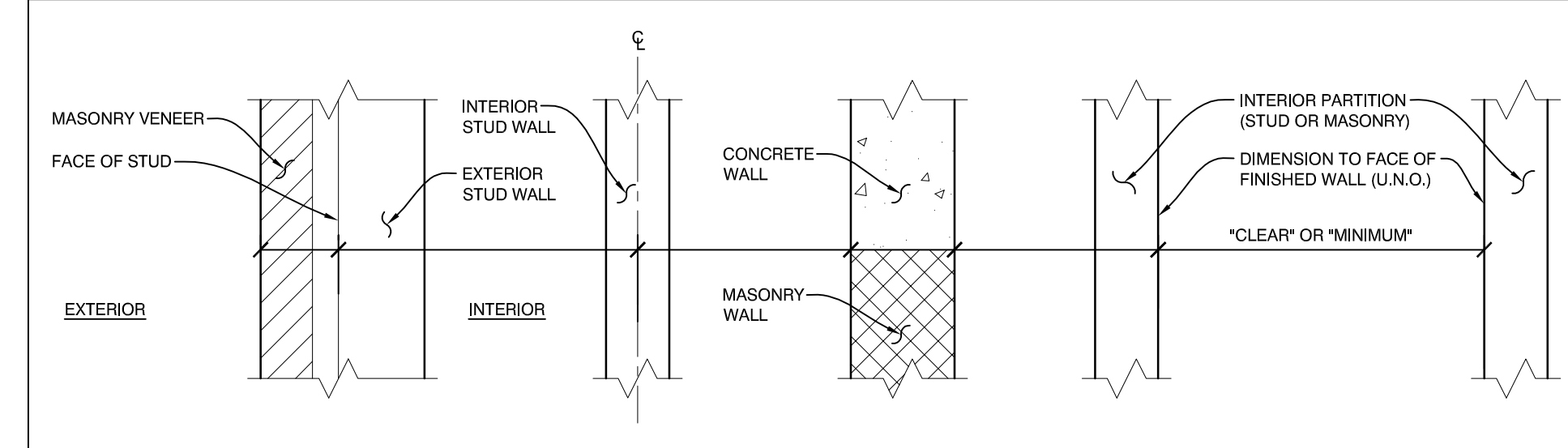

AC HOTELS by MARRIOTT  
Fore Street / Hancock Street / Thames Street  
Portland, Maine

REVISION:

ISSUED:  
08-12-16 FOUNDATION & STEEL PERMIT  
10-18-16 60% MARRIOTT REVIEW

project architect: KAK  
drawn by: DLS

**COVER SHEET**

sheet number:  
**CS1.01**