

Friday, October 21, 2016 9:05:40 AM

Copyright 2015 Opechee Construction Corporation

OPECHEE
CONSTRUCTION CORPORATION
11 CORPORATE DRIVE • BELMONT • NH 03220
PHONE (603) 527-9000 • WWW.OPECHEE.COM

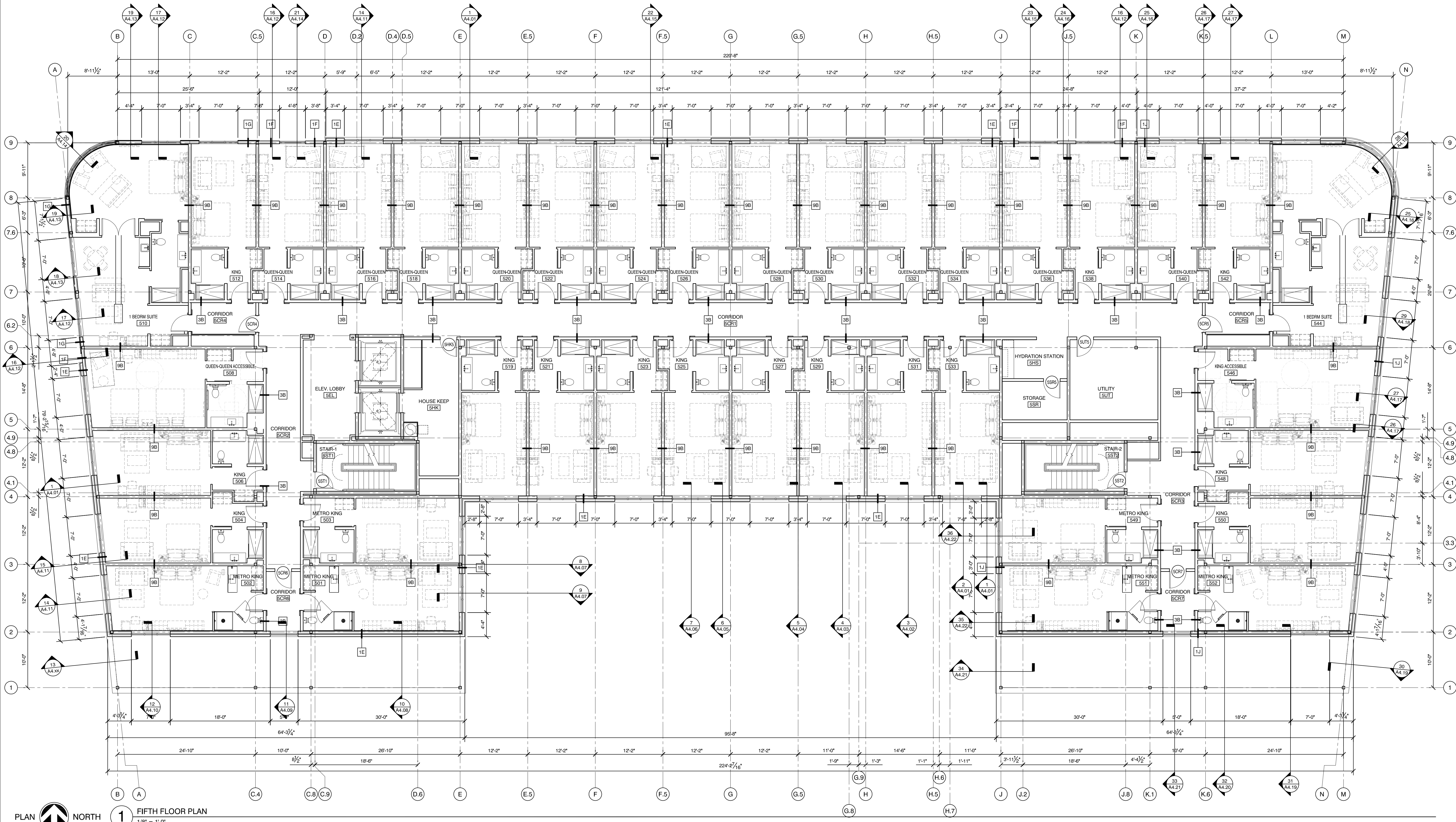

PLAN NORTH
1 FIFTH FLOOR PLAN
1/8" = 1'-0"

AC HOTELS by MARRIOTT
Fore Street / Hancock Street / Thames Street
Portland, Maine

REVISION:

ISSUED:
08-12-16 FOUNDATION & STEEL PERMIT
10-18-16 60% MARRIOTT REVIEW
10-21-16 BUILDING SHELL PERMIT

project architect: KAK
drawn by: AMQ

FIFTH FLOOR PLAN

sheet number:
A1.05