

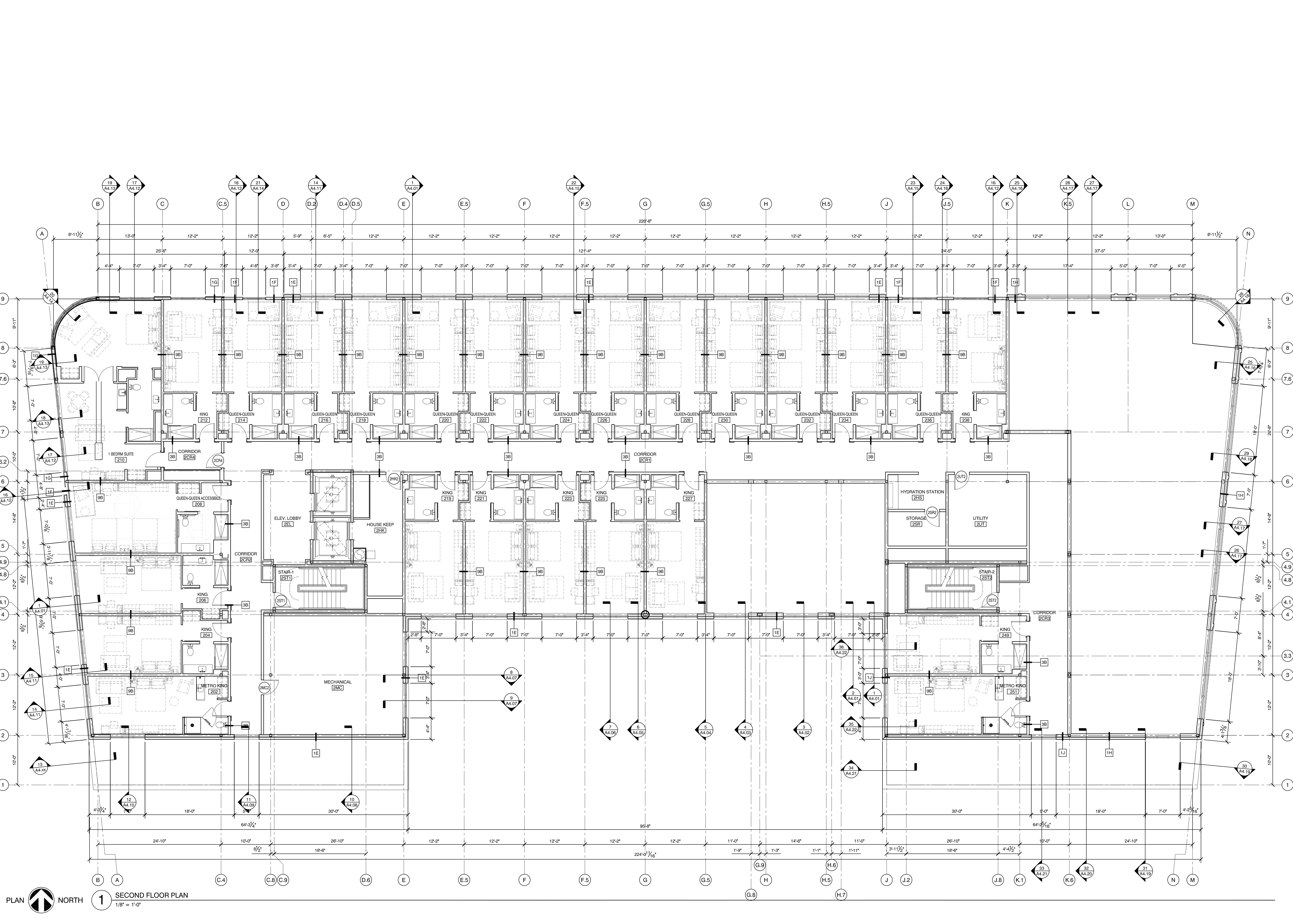

Friday, October 21, 2016 9:00:47 AM

Copyright 2015 Opechee Construction Corporation



PLAN  NORTH
1 SECOND FLOOR PLAN
 1/8" = 1'-0"

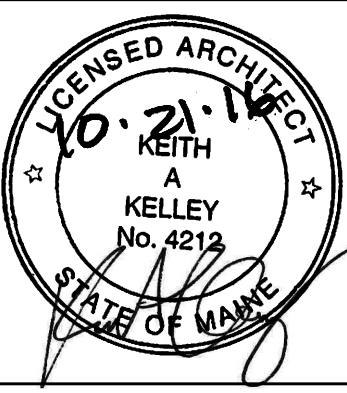

AC HOTELS by MARRIOTT
 Fore Street / Hancock Street / Thames Street
 Portland, Maine

REVISION:

ISSUED:
 08-12-16 FOUNDATION & STEEL PERMIT
 10-18-16 60% MARRIOTT REVIEW
 10-21-16 BUILDING SHELL PERMIT

project architect: KAK
 drawn by: AMQ

SECOND FLOOR PLAN

sheet number:
A1.02