

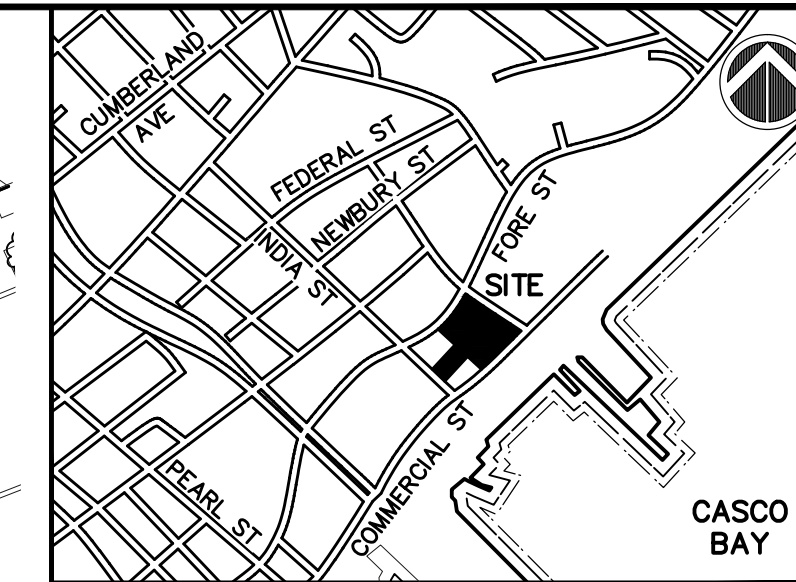

NORTH



CASCO BAY

### PROPOSED AC HOTEL PORTLAND

FORE STREET /  
HANCOCK STREET /  
THAMES STREET  
PORTLAND, MAINE

Prepared for:

PORTLAND NORWICH GROUP, LLC.  
2330 PALM RIDGE ROAD #305  
SANIBEL, FLORIDA 33957

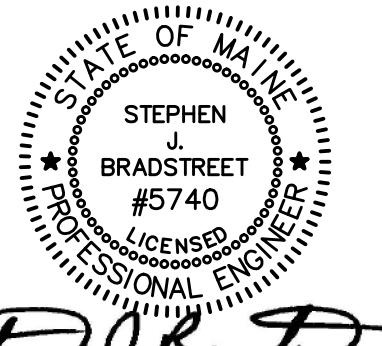

*Stephen J. Bradstreet*

CIVIL ENGINEER:  
STEPHEN J. BRADSTREET, PE #5740  
400 COMMERCIAL STREET, SUITE 404  
PORTLAND, ME 04101  
207-772-2891

### SPACE AND BULK STANDARDS

	REQUIRED	PROPOSED
MINIMUM LOT SIZE	0 S.F.	28,540 S.F. (LOT 1)
ROAD FRONTAGE	0'	>226'
BUILDING SETBACKS (MIN./MAX.)		
FRONT	0'/10'	
SIDE	0'/10'	
REAR	0'	
BUILDING HEIGHT	<.65'	<.65' (6 FLOORS)

### GENERAL NOTES

- ALL NEW (OR RESET) GRANITE CURB WITHIN THE RIGHT-OF-WAY SHALL BE RADIUS CURBING WHEN USED IN AREAS SUBJECT TO FLOWING. CURB LENGTH SHALL BE A MINIMUM OF 4 FEET.
- COORDINATE FORE STREET IMPROVEMENT PLAN WITH CITY OF PORTLAND TRAFFIC CONSULTANT.
- COORDINATE PROPOSED HANCOCK STREET LOADING ZONE WITH CITY OF PORTLAND TRAFFIC CONSULTANT.
- ALL ON-STREET PARKING ON FORE STREET WILL BE DESIGNATED AS 1-HOUR PARKING. COORDINATE WITH CITY AND TRAFFIC CONSULTANT.

### LEGEND

	PHASE 1 - LIMIT OF CONSTRUCTION
	PROPERTY LINE
	PERVIOUS BRICK PAVERS
	COBBLE STONE PAVERS
	BRICK SIDEWALK PAVERS
	NEW BITUMINOUS PAVEMENT

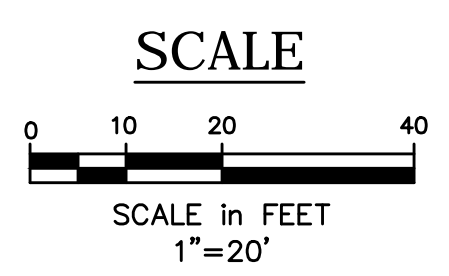
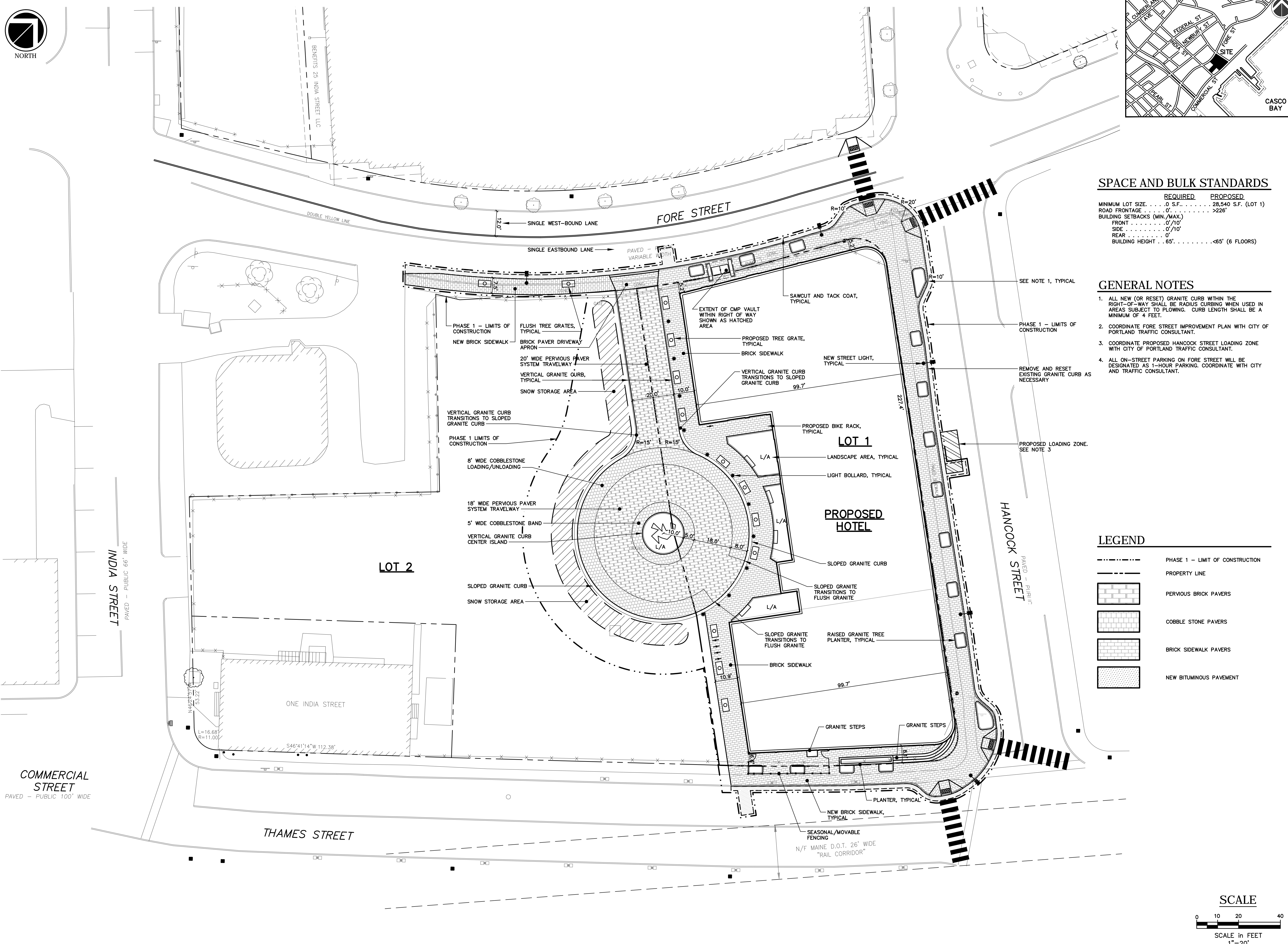

### SITE PLAN

F	APPROVED CITY PLAN	02/15/17
E	RESPONSE TO COMMENTS	05/17/16
D	RESPONSE TO COMMENTS	05/10/16
C	FINAL SUBMISSION	03/15/16
B	PRELIMINARY SUBMISSION	09/29/15

No.	Revision/Issue	Date
Design by:	MPM	Checked by: SJB
Drawn by:	JAR	Approved by: SJB
Project:	150.06094	Date: AUGUST 2015
Sheet No:	<b>C1.0</b>	
	Sheet 4 of 17	