

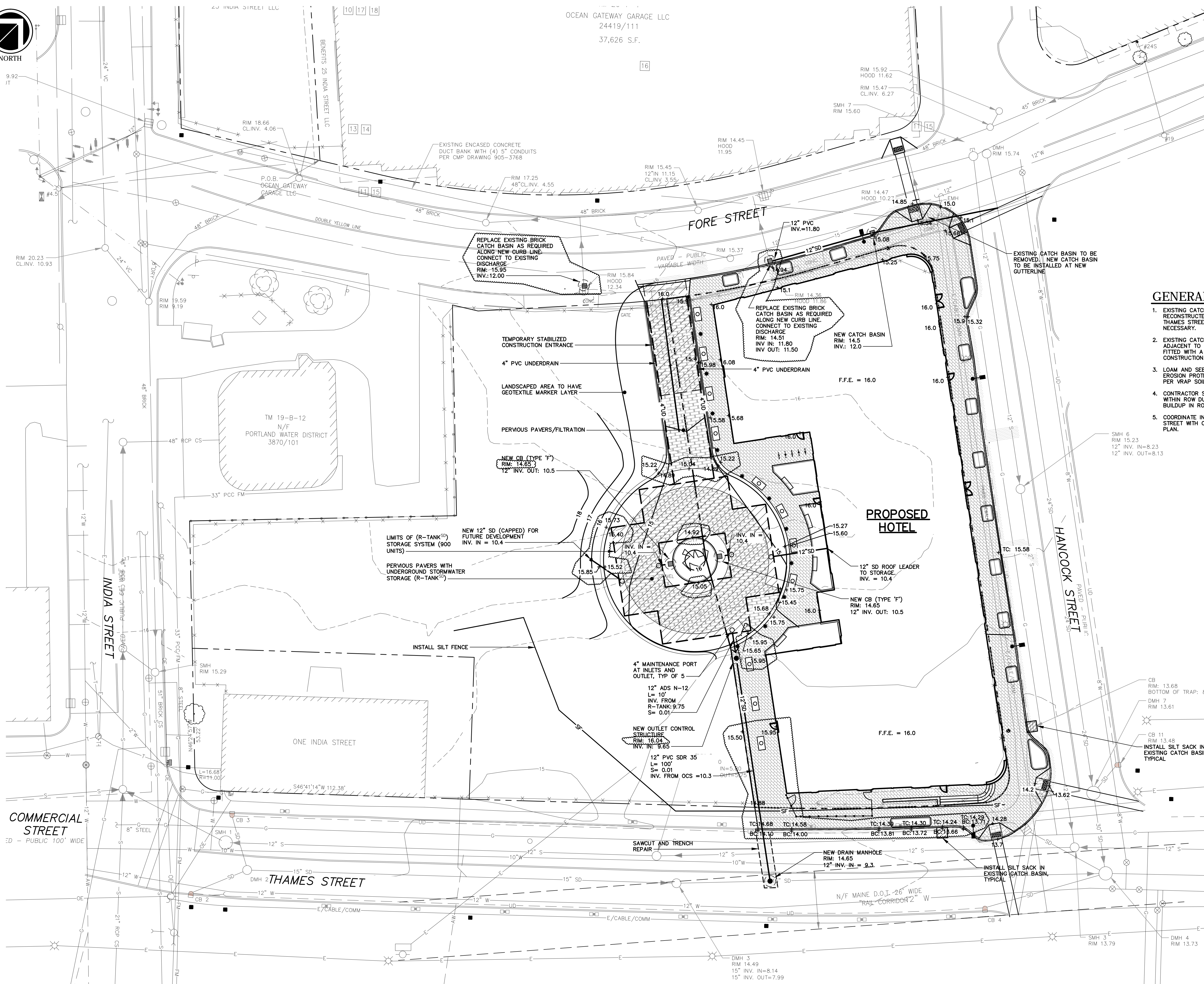

NORTH



**GENERAL NOTES**

- EXISTING CATCH BASIN STRUCTURES ALONG THE RECONSTRUCTED CURB LINE AT FORE, HANCOCK AND THAMES STREETS SHALL BE RECONSTRUCTED AS NECESSARY.
- EXISTING CATCH BASINS WITHIN THE RIGHT-OF-WAY, ADJACENT TO THE LIMITS OF CONSTRUCTION SHALL BE FITTED WITH A SILT SACK FOR THE DURATION OF CONSTRUCTION.
- LOAM AND SEED DISTURBED AREAS OF LOTS 1 & 2 FOR EROSION PROTECTION. INCLUDE GEOTEXTILE MARKER LAYER PER WRAP SOIL MANAGEMENT PLAN.
- CONTRACTOR SHALL PROVIDE FREQUENT STREET SWEEPING WITHIN ROW DURING CONSTRUCTION TO MINIMIZE SEDIMENT BUILDUP IN ROADWAY.
- COORDINATE INSTALLATION OF NEW CATCH BASIN ON FORE STREET WITH CITY DPW AND FUTURE STORM SEPARATION PLAN.

**PROPOSED AC HOTEL  
PORTLAND**

FORE STREET /  
HANCOCK STREET /  
THAMES STREET  
PORTLAND, MAINE

Prepared for:

PORTLAND NORWICH GROUP, LLC.  
2330 PALM RIDGE ROAD #305  
SANIBEL, FLORIDA 33957

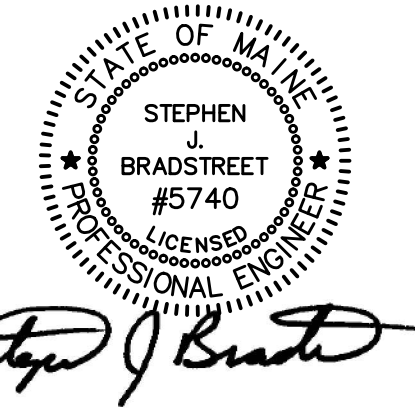

CIVIL ENGINEER:  
STEPHEN J. BRADSTREET, PE #5740  
400 COMMERCIAL STREET, SUITE 404  
PORTLAND, ME 04101  
207-772-2891



400 Commercial Street, Suite 404  
Portland, ME 04101  
Tel. (207) 772-2891  
Fax (207) 772-3248  
www.ransomenv.com

**GRADING, DRAINAGE  
AND EROSION  
CONTROL PLAN**

F	CITY REVS/CONSTRUCTION	06/30/17
E	RESPONSE TO COMMENTS	05/17/16
D	RESPONSE TO COMMENTS	05/10/16
C	FINAL SUBMISSION	03/15/16
B	PRELIMINARY SUBMISSION	09/29/15
A	CLIENT REVIEW	09/15/15

No.	Revision/Issue	Date
Design by:	MPM	Checked by: SJB
Drawn by:	JAR	Approved by: SJB
Project:	150.06094	Date: AUGUST 2015
Sheet No:	<b>C1.2</b>	
	Sheet 6 of 17	

