

FORE STREET

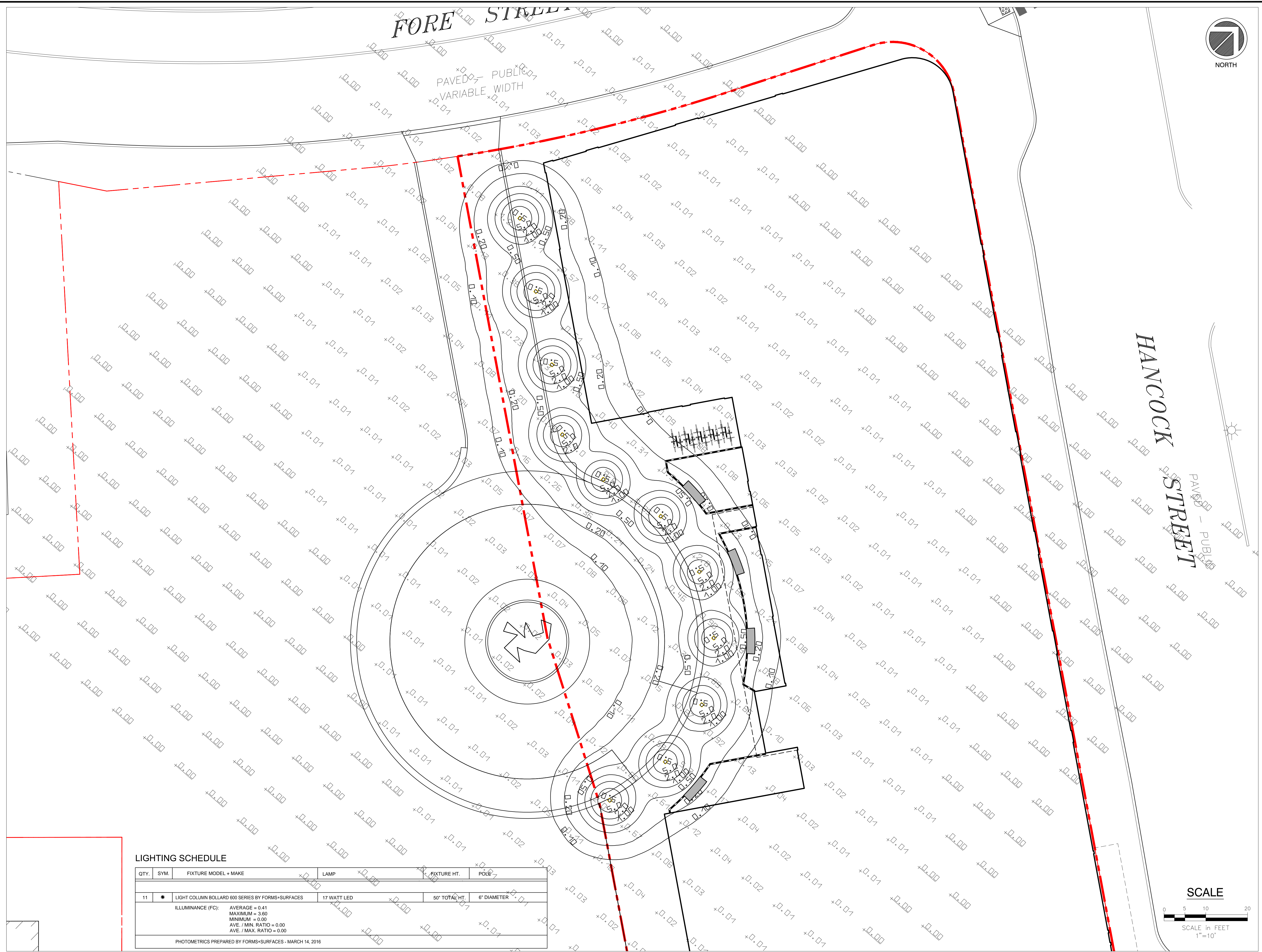

Site: **PROPOSED AC HOTEL PORTLAND**  
 FORE STREET / HANCOCK STREET / THAMES STREET  
 PORTLAND, MAINE

Prepared for:  
**PORTLAND NORWICH GROUP, LLC**  
 2330 PALM RIDGE ROAD #305  
 SANIBEL, FL 33957

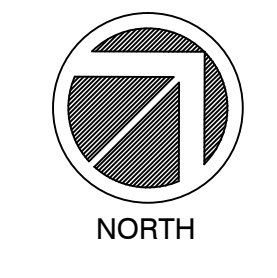
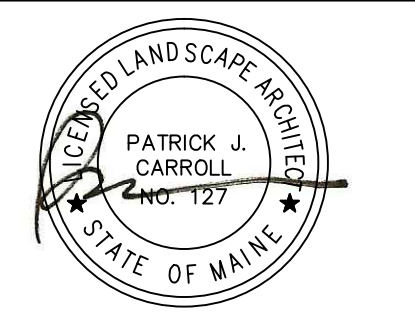

**PHOTOMETRIC PLAN (COURTYARD / DRIVE)**

E	CITY REVS / FOR CONSTRUCTION	6/23/17
D	APPROVED CITY PLANS	02/15/17
C	STAFF REVIEW COMMENTS	05/10/16
B	FINAL SITE PLAN REVIEW	03/15/16
A	PRELIMINARY REVIEW	09/29/15

No.	Revision/Issue	Date
Design by:	MAP/PC	Checked by: PC
Drawn by:	MAP	Approved by: PC
Project:	150.06094	Date: FEBRUARY 2016
Sheet No:	<b>L3.0</b>	

**LIGHTING SCHEDULE**

QTY.	SYM.	FIXTURE MODEL + MAKE	LAMP	FIXTURE HT.	POLE
11	●	LIGHT COLUMN BOLLARD 600 SERIES BY FORMS+SURFACES	17 WATT LED	50" TOTAL HT.	6" DIAMETER
ILLUMINANCE (FC): AVERAGE = 0.41 MAXIMUM = 3.60 MINIMUM = 0.00 AVE. / MIN. RATIO = 0.00 AVE. / MAX. RATIO = 0.00					
PHOTOMETRICS PREPARED BY FORMS+SURFACES - MARCH 14, 2016					

