

PROPOSED AC HOTEL PORTLAND

FORE STREET / HANCOCK STREET / THAMES STREET
PORTLAND, MAINE

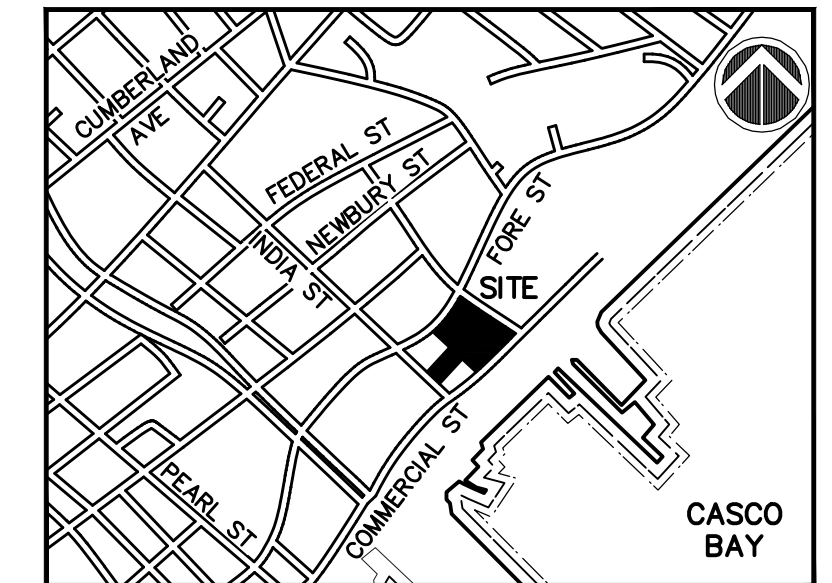

OWNER:
PORTLAND NORWICH GROUP, LLC.
2330 PALM RIDGE ROAD #305
SANIBEL, FLORIDA 33957

ARCHITECT:
Group One Partners, Incorporated
21 West Third Street
Boston, MA 02127
617.268.7000 ph
617.268.0209 f
www.grouponeinc.com

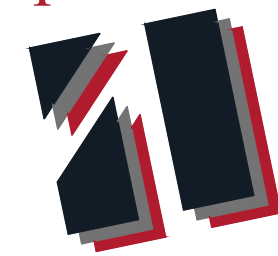

ENGINEER:
RANSOM
Consulting
Engineers
and Scientists
400 Commercial Street, Suite 404
Portland, ME 04101
Tel. (207) 772-2891
Fax (207) 772-3248
www.ransomenv.com

LANDSCAPE ARCHITECT:

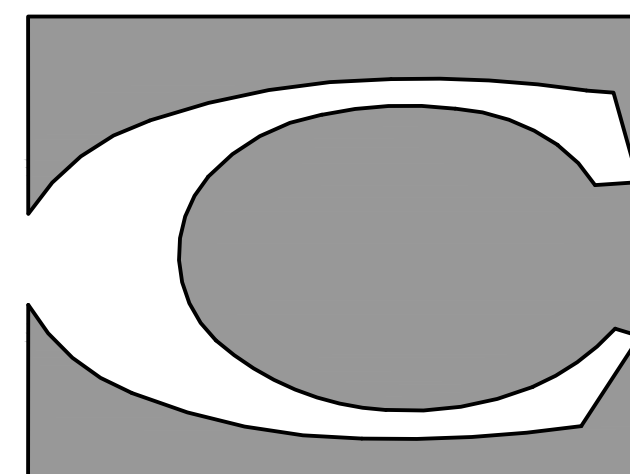

CARROLL ASSOCIATES
LANDSCAPE ARCHITECTS

217 COMMERCIAL STREET, STE 200
PORTLAND, MAINE 04101
207.772.1552

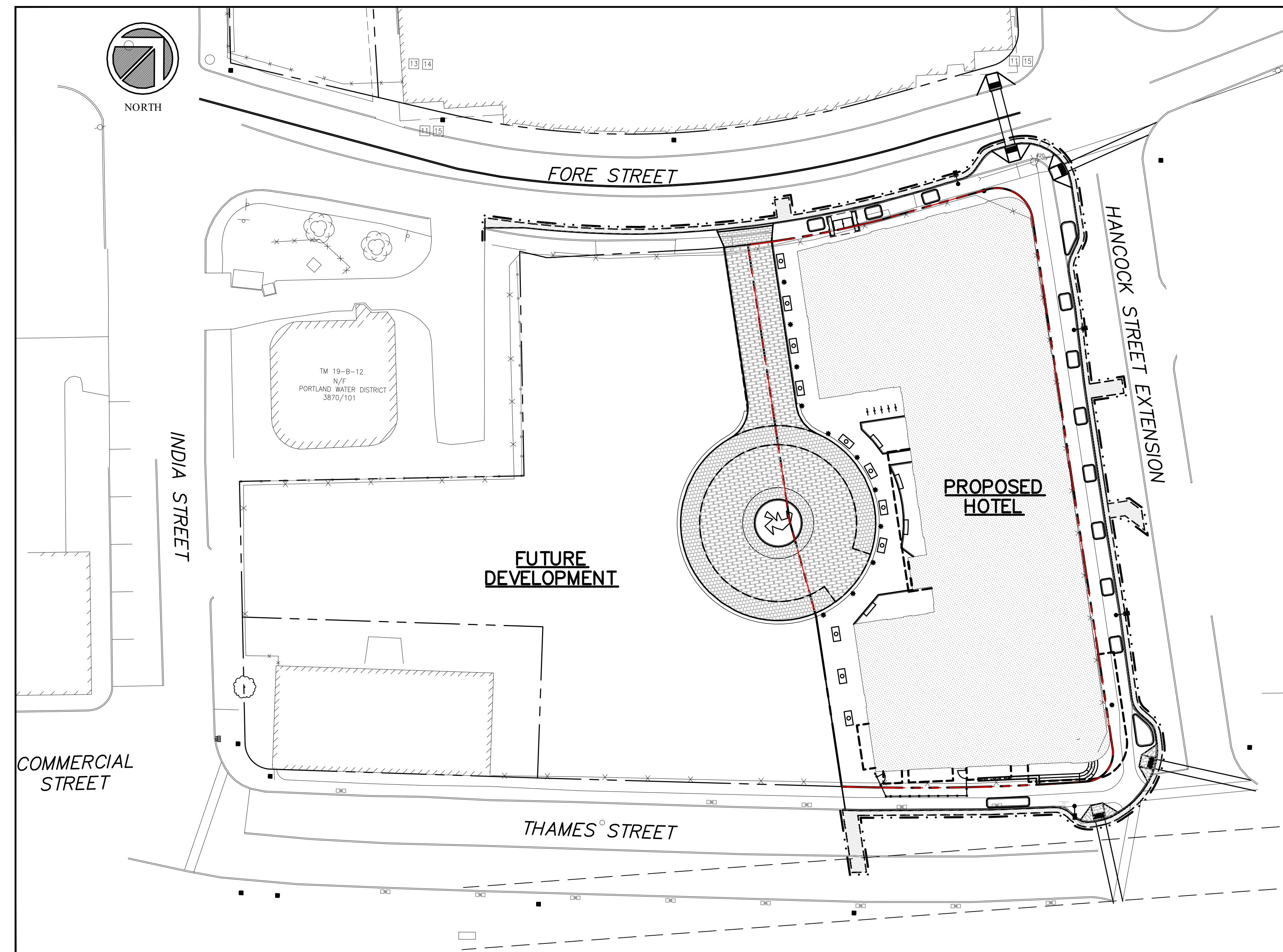

SCALE: 1" = 30'

SHEET INDEX:

| PAGE | SHEET | DESCRIPTION |
|------|-------|--|
| 1 | - | COVER SHEET |
| 2 | 1 | BOUNDARY PLAN |
| 3 | C0.1 | EXISTING CONDITIONS PLAN |
| 4 | C1.0 | SITE PLAN |
| 5 | C1.1 | UTILITY PLAN |
| 6 | C1.2 | GRADING, DRAINAGE AND EROSION CONTROL PLAN |
| 7 | C2.0 | CONSTRUCTION DETAILS AND NOTES |
| 8 | C2.1 | CONSTRUCTION DETAILS |
| 9 | C2.2 | CONSTRUCTION DETAILS |
| 10 | C2.3 | CONSTRUCTION DETAILS |
| 11 | C2.4 | CONSTRUCTION DETAILS |
| 12 | C2.5 | CONSTRUCTION DETAILS |
| 13 | L1.0 | LANDSCAPE AND LIGHTING PLAN |
| 14 | L1.1 | THAMES STREET SEATING AND ENTRY AREA |
| 15 | L2.0 | LANDSCAPE DETAILS |
| 16 | L2.1 | LANDSCAPE DETAILS |
| 17 | L2.2 | LANDSCAPE DETAILS |
| 18 | L2.3 | PAVING PLAN |
| 19 | L3.0 | PHOTOMETRIC PLAN |
| 20 | | STRIPING PLAN |

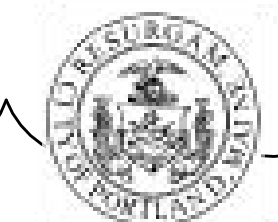

CITY OF PORTLAND
APPROVED SITE PLAN
Subject to Conditions of Approval
and Standard Conditions

DATE of APPROVAL **5/24/16**
PLANNER **Nell Donaldson**
PROJECT NO. **2015-169**