

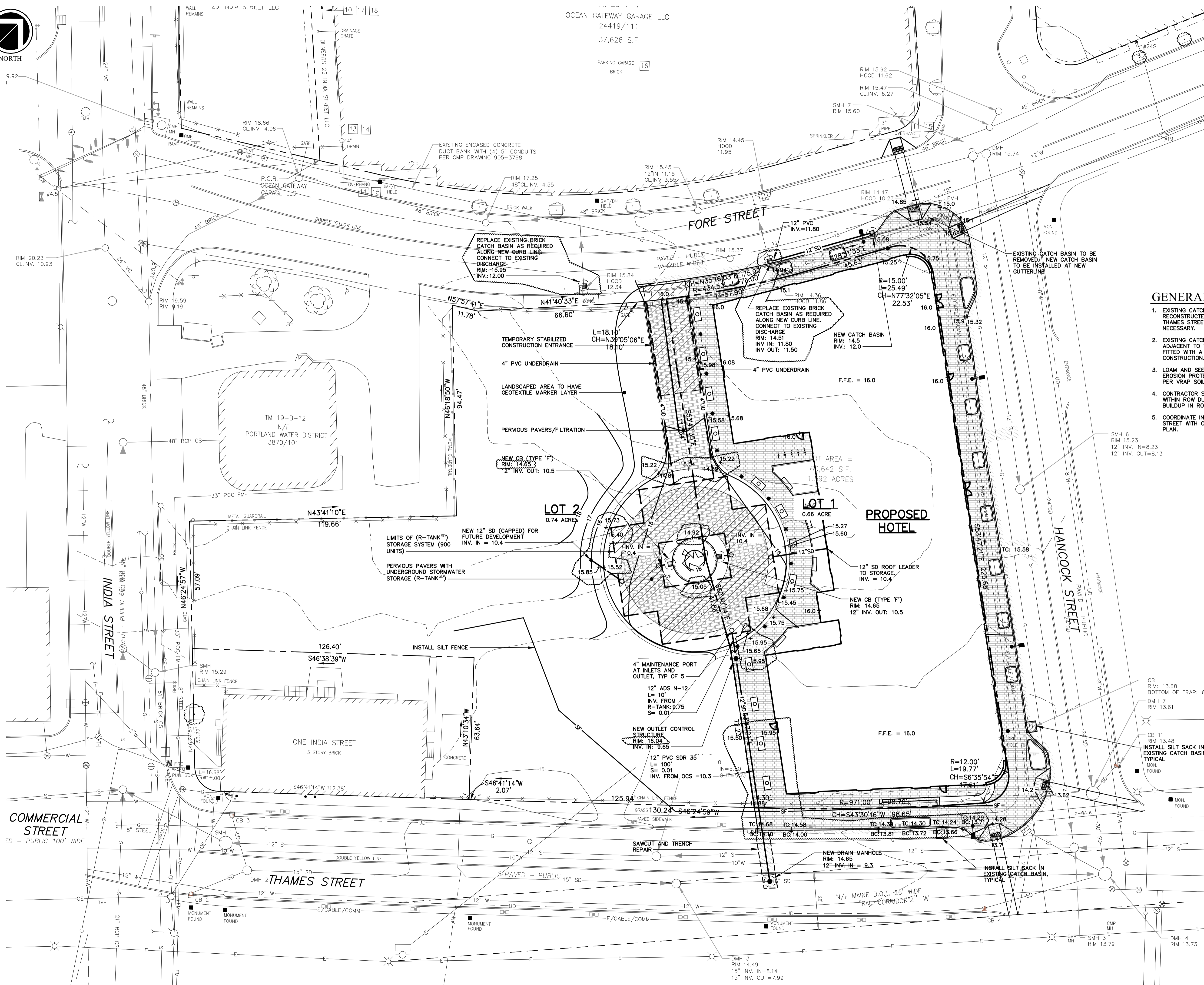

NORTH



OCEAN GATEWAY GARAGE LLC
24419/111
37,626 S.F.

PROPOSED AC HOTEL
PORTLAND
FORE STREET /
HANCOCK STREET /
THAMES STREET
PORTLAND, MAINE

Prepared for:
PORTLAND NORWICH GROUP, LLC.
2330 PALM RIDGE ROAD #305
SANIBEL, FLORIDA 33957

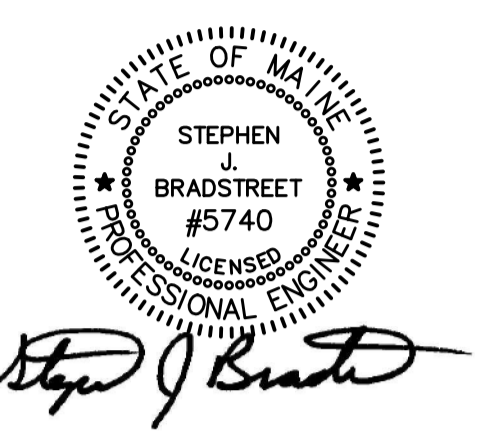

CIVIL ENGINEER:
STEPHEN J. BRADSTREET, PE #5740
400 COMMERCIAL STREET, SUITE 404
PORTLAND, ME 04101
207-772-2891

GENERAL NOTES

- EXISTING CATCH BASIN STRUCTURES ALONG THE RECONSTRUCTED CURB LINE AT FORE, HANCOCK AND THAMES STREETS SHALL BE RECONSTRUCTED AS NECESSARY.
- EXISTING CATCH BASINS WITHIN THE RIGHT-OF-WAY, ADJACENT TO THE LIMITS OF CONSTRUCTION SHALL BE FITTED WITH A SILT SACK FOR THE DURATION OF CONSTRUCTION.
- LOAM AND SEED DISTURBED AREAS OF LOTS 1 & 2 FOR EROSION PROTECTION. INCLUDE GEOTEXTILE MARKER LAYER PER VRAP SOIL MANAGEMENT PLAN.
- CONTRACTOR SHALL PROVIDE FREQUENT STREET SWEEPING WITHIN ROW DURING CONSTRUCTION TO MINIMIZE SEDIMENT BUILDUP IN ROADWAY.
- COORDINATE INSTALLATION OF NEW CATCH BASIN ON FORE STREET WITH CITY DPW AND FUTURE STORM SEPARATION PLAN.



400 Commercial Street, Suite 404
Portland, ME 04101
Tel. (207) 772-2891
Fax (207) 772-3248
www.ransomenv.com

GRADING, DRAINAGE AND EROSION CONTROL PLAN

F	CITY REVS/CONSTRUCTION	06/30/17
E	RESPONSE TO COMMENTS	05/17/16
D	RESPONSE TO COMMENTS	05/10/16
C	FINAL SUBMISSION	03/15/16
B	PRELIMINARY SUBMISSION	09/29/15
A	CLIENT REVIEW	09/15/15
No.	Revision/Issue	Date

Design by: **MPV** Checked by: **SJB**
Drawn by: **MPV** Approved by: **SJB**
CITY OF PORTLAND
APPROVED SITE PLAN
Subject to Conditions of Approval
150.06094 AUGUST 2015

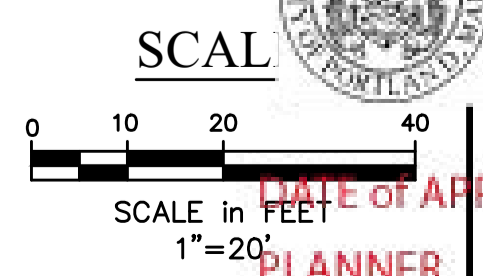

DATE OF APPROVAL: **04/2**
Planner
Nell Donaldson