

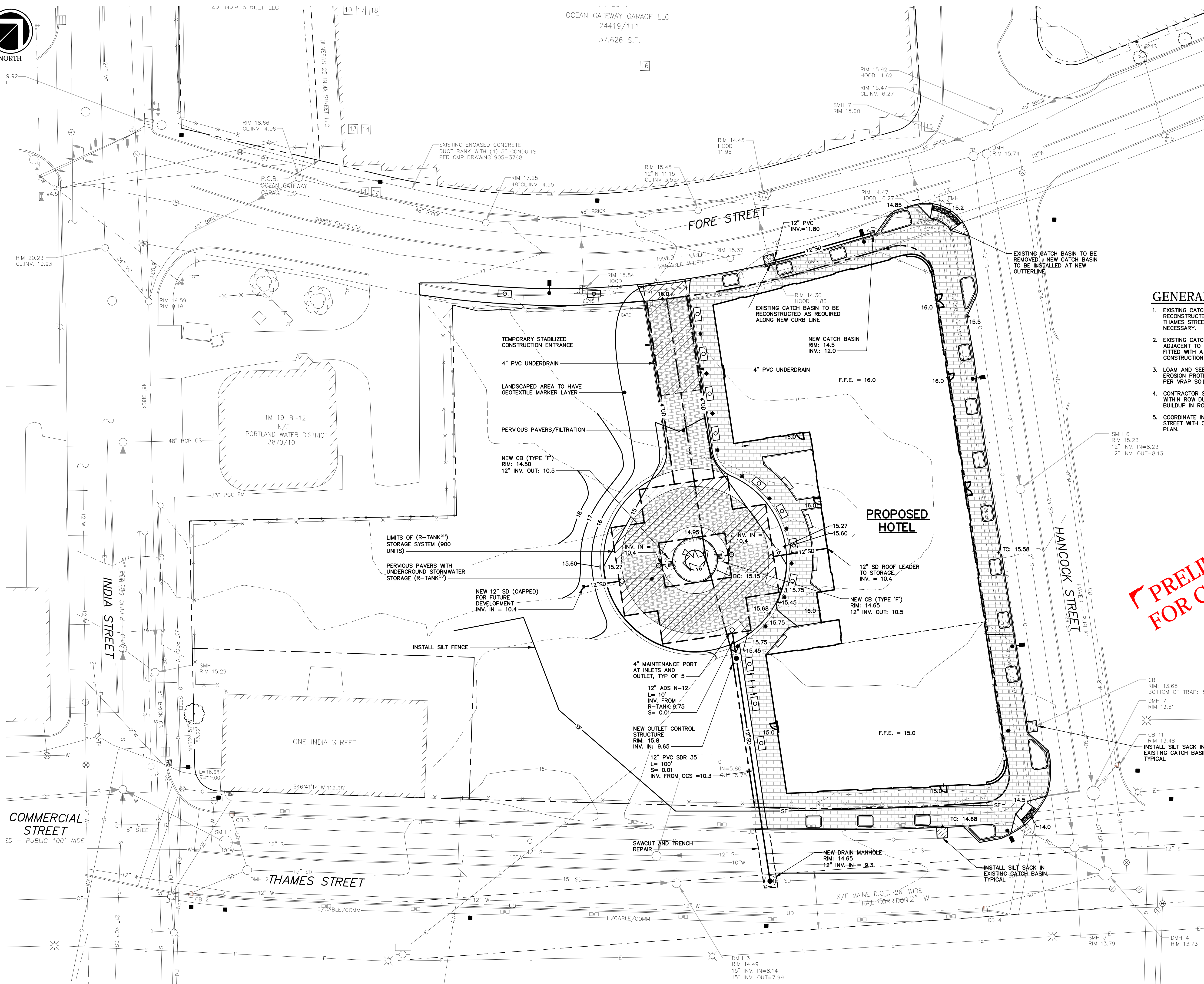

NORTH



- GENERAL NOTES**
- EXISTING CATCH BASIN STRUCTURES ALONG THE RECONSTRUCTED CURB LINE AT FORE, HANCOCK AND THAMES STREETS SHALL BE RECONSTRUCTED AS NECESSARY.
 - EXISTING CATCH BASINS WITHIN THE RIGHT-OF-WAY, ADJACENT TO THE LIMITS OF CONSTRUCTION SHALL BE FITTED WITH A SILT SACK FOR THE DURATION OF CONSTRUCTION.
 - LOAM AND SEED DISTURBED AREAS OF LOTS 1 & 2 FOR EROSION PROTECTION. INCLUDE GEOTEXTILE MARKER LAYER PER WRAP SOIL MANAGEMENT PLAN.
 - CONTRACTOR SHALL PROVIDE FREQUENT STREET SWEEPING WITHIN ROW DURING CONSTRUCTION TO MINIMIZE SEDIMENT BUILDUP IN ROADWAY.
 - COORDINATE INSTALLATION OF NEW CATCH BASIN ON FORE STREET WITH CITY DPW AND FUTURE STORM SEPARATION PLAN.

PRELIMINARY NOT FOR CONSTRUCTION

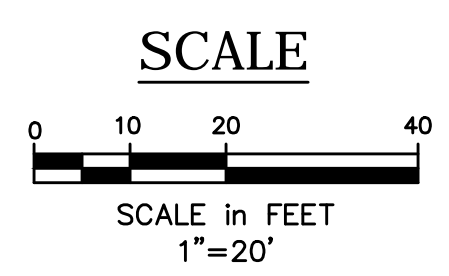

Site: **PROPOSED AC HOTEL PORTLAND**
FORE STREET / HANCOCK STREET / THAMES STREET
PORTLAND, MAINE

Prepared for:
PORTLAND NORWICH GROUP, LLC.
2330 PALM RIDGE ROAD #305
SANIBEL, FLORIDA 33957

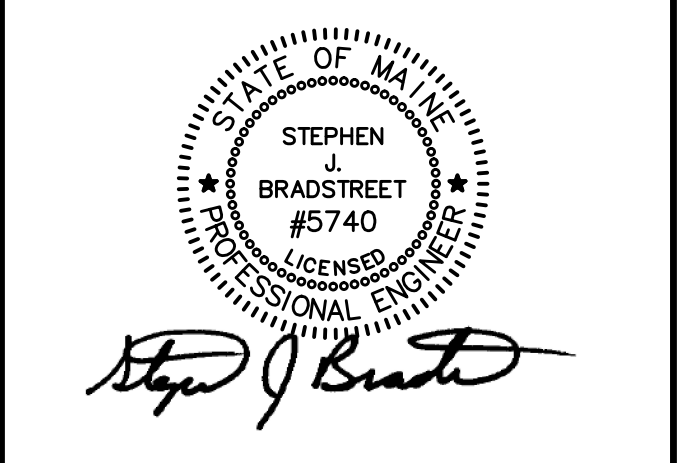

CIVIL ENGINEER:
STEPHEN J. BRADSTREET, PE #5740
400 COMMERCIAL STREET, SUITE 404
PORTLAND, ME 04101
207-772-2891

RANSOM
Consulting Engineers and Scientists
400 Commercial Street, Suite 404
Portland, ME 04101
Tel. (207) 772-2891
Fax (207) 772-3248
www.ransomenv.com

GRADING, DRAINAGE AND EROSION CONTROL PLAN

E	RESPONSE TO COMMENTS	05/17/16
D	RESPONSE TO COMMENTS	05/10/16
C	FINAL SUBMISSION	03/15/16
B	PRELIMINARY SUBMISSION	09/29/15
A	CLIENT REVIEW	09/15/15

No.	Revision/Issue	Date
Design by:	MPM	Checked by: SJB
Drawn by:	JAR	Approved by: SJB
Project:	150.06094	Date: AUGUST 2015
Sheet No:	C1.2	
	Sheet 6 of 17	