

PROPOSED AC HOTEL

FORE STREET /
HANCOCK STREET /
THAMES STREET
PORTLAND, MAINE

Prepared for:
**PORTLAND NORWICH
GROUP, LLC**
2330 PALM RIDGE ROAD
#305
SANIBEL, FL 33957

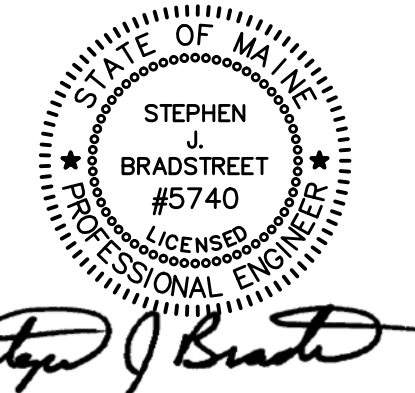

CIVIL ENGINEER:
STEPHEN J. BRADSTREET, PE #5740
400 COMMERCIAL STREET, SUITE 404
PORTLAND, ME 04101
207-772-2891

SPACE AND BULK STANDARDS

	REQUIRED	PROPOSED
HOTEL ROOMS	150	150
MINIMUM LOT SIZE	0 S.F.	28,632 S.F.
ROAD FRONTAGE	0'	>226'
BUILDING SETBACKS (MIN./MAX.)		
FRONT	0'/10'	<1
SIDE	0'/10'	<10
REAR	0'	--
BUILDING HEIGHT	65'	<65' (6 FLOORS)

ZONE: B-6 EASTERN WATERFRONT MIXED ZONE

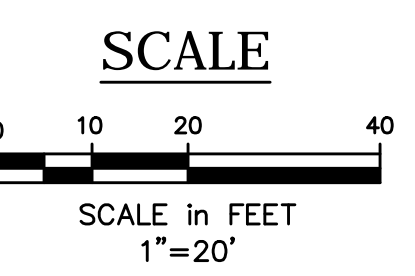
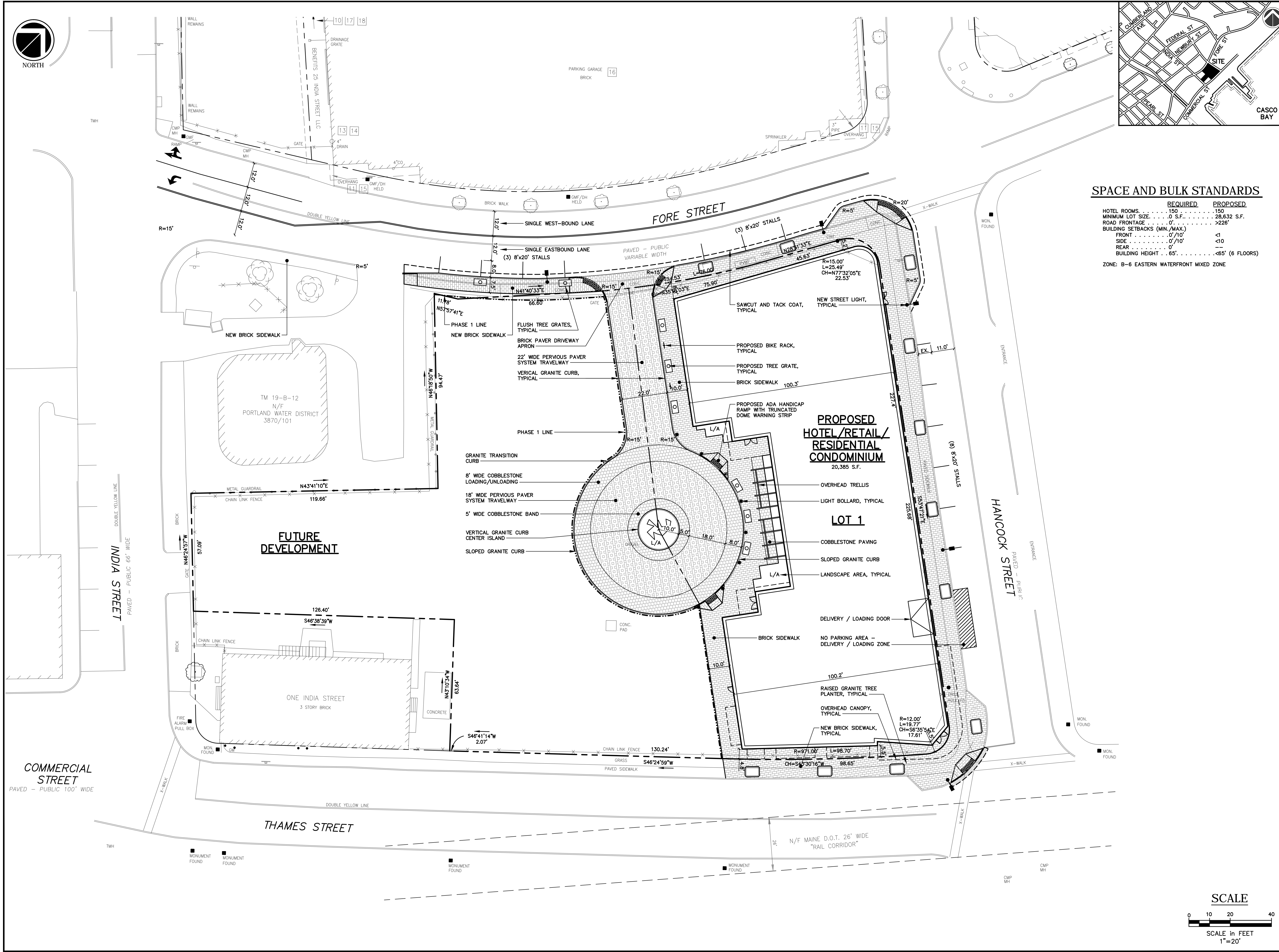

RANSOM
Consulting
Engineers
and Scientists

400 Commercial Street, Suite 404
Portland, ME 04101
Tel. (207) 772-2891
Fax (207) 772-3248
www.ransomenv.com

SITE PLAN

No.	Revision/Issue	Date
B	PRELIMINARY SUBMISSION	09/29/15
A	CLIENT REVIEW	09/15/15

Design by:	MPM	Checked by:	SJB
Drawn by:	JAR	Approved by:	SJB
Project:	150.06094	Date:	AUGUST 2015
Sheet No:	C1.0		
	Sheet 5 of 13		