

**PROPOSED AC HOTEL
PORTLAND**
FORE STREET /
HANCOCK STREET /
THAMES STREET
PORTLAND, MAINE

Prepared for:
PORTLAND NORWICH GROUP, LLC.
2330 PALM RIDGE ROAD #305
SANIBEL, FLORIDA 33957

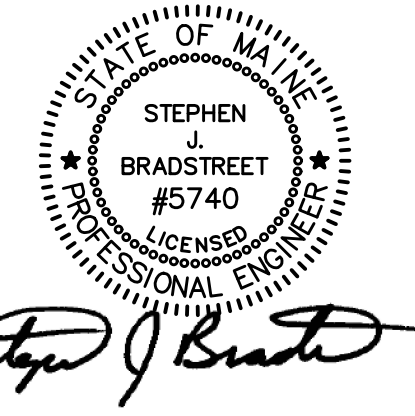

CIVIL ENGINEER:
STEPHEN J. BRADSTREET, PE #5740
400 COMMERCIAL STREET, SUITE 404
PORTLAND, ME 04101
207-772-2891

SPACE AND BULK STANDARDS

	REQUIRED	PROPOSED
MINIMUM LOT SIZE	0 S.F.	28,540 S.F. (LOT 1)
ROAD FRONTAGE	0'	>226'
BUILDING SETBACKS (MIN./MAX.)		
FRONT	0'/10'	
SIDE	0'/10'	
REAR	0'	
BUILDING HEIGHT	65'	65' (6 FLOORS)

GENERAL NOTES

- ALL NEW (OR RESET) GRANITE CURB WITHIN THE RIGHT-OF-WAY SHALL BE RADIUS CURBING WHEN USED IN AREAS SUBJECT TO PLOWING. CURB LENGTH SHALL BE A MINIMUM OF 4 FEET.

LEGEND

- PHASE 1 - LIMIT OF CONSTRUCTION
- PROPERTY LINE
- PERVIOUS BRICK PAVERS
- COBBLE STONE PAVERS
- BRICK SIDEWALK PAVERS
- NEW BITUMINOUS PAVEMENT

PRELIMINARY NOT FOR CONSTRUCTION

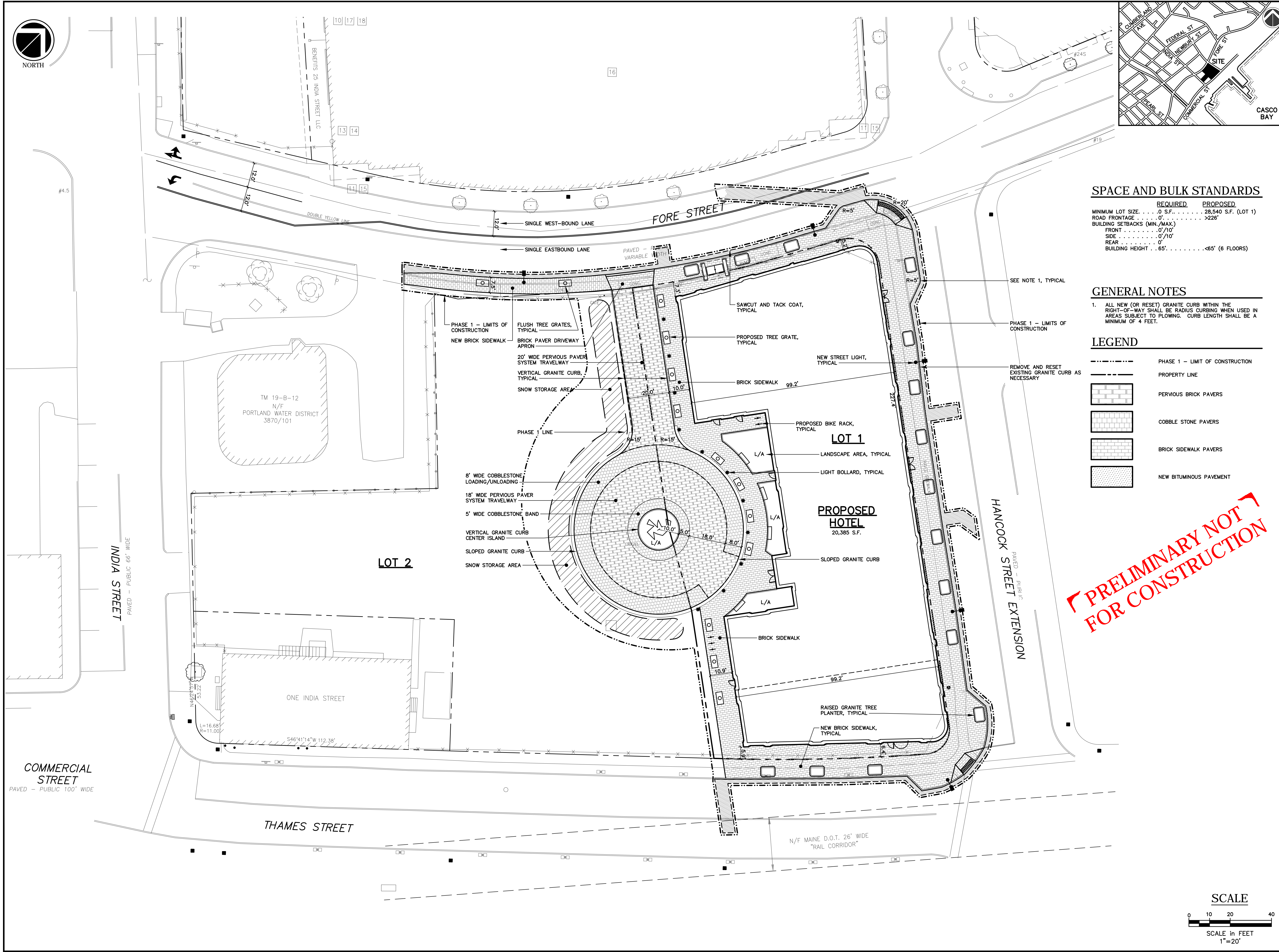

SCALE

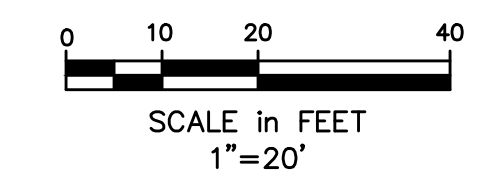

K: \Image\RNSM NEW.JPG

400 Commercial Street, Suite 404
Portland, ME 04101
Tel. (207) 772-2891
Fax (207) 772-3248
www.ransomenv.com

SITE PLAN

No.	Revision/Issue	Date
C	FINAL SUBMISSION	03/15/16
B	PRELIMINARY SUBMISSION	09/29/15
A	CLIENT REVIEW	09/15/15

Design by:	MPM	Checked by:	SJB
Drawn by:	JAR	Approved by:	SJB
Project:	150.06094	Date:	AUGUST 2015
Sheet No:	C1.0		
	Sheet 4 of 17		