

1ST FLOOR PLAN - EXISTING CORE & SHELL PLAN H3
1/16" = 1'-0"

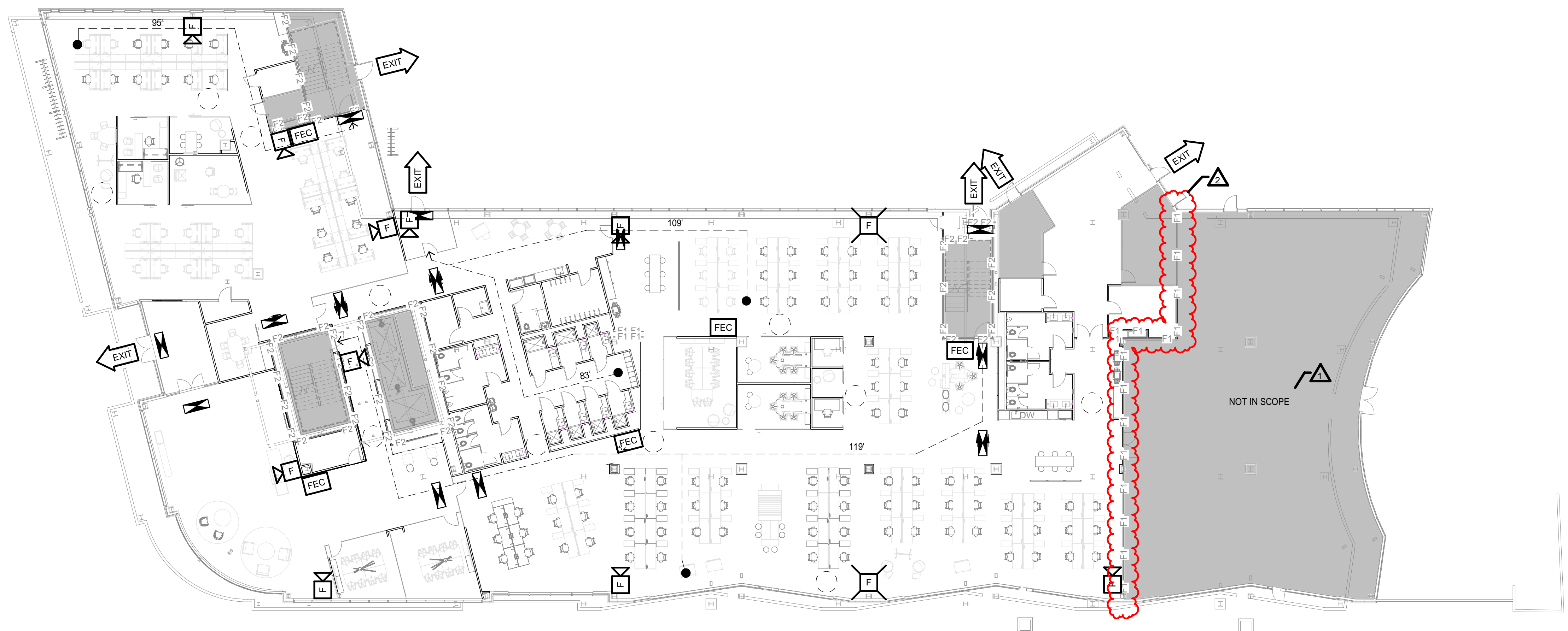

1ST FLOOR PLAN - LIFE SAFETY - PROPOSED B3
1/16" = 1'-0"

LIFE SAFETY LEGEND

- H2 — 2 HOUR RATED HORIZONTAL EXIT & SMOKE BARRIER
- O2 — 2 HOUR RATED OCCUPANCY SEPARATION & SMOKE BARRIER
- F2 — 2 HOUR RATED FIRE BARRIER
- F1 — 1 HOUR RATED FIRE BARRIER
- S2 — 2 HOUR RATED SMOKE BARRIER
- S1 — 1 HOUR RATED SMOKE BARRIER
- S0 — SMOKE PARTITION
- EXIT DISCHARGE
- ⊙ SMOKE CONTAINMENT BARRIER
- ⊛ STANDPIPE OR HOSE VALVE CABINET
- ⊙ FIRE DEPT. CONNECTION
- 172 — TRAVEL DISTANCE
- ⊞ FEC — FIRE EXTINGUISHER CABINET
- FE — FIRE EXTINGUISHER WALL HUNG
- ➡ EXIT — EGRESS DOOR
- ⊞ F — FIRE ALARM VISIBLE ONLY NOTIFICATION INDICATOR
- ⊞ FK — FIRE ALARM AUDIBLE/VISIBLE NOTIFICATION INDICATOR
- ⊞ — EXIT SIGN
- NOT IN SCOPE
- 5'-0" CLEARANCE
- ⊞ ASSEMBLY OCCUPANCY

REV	DESCRIPTION	DATE
2	PERMITTING ADDENDUM NO. 2	03-28-18
1	PERMITTING ADDENDUM NO. 1	03-15-18

PERMITTING ADDENDUM NO. 2
03-27-2018

CURRENT ISSUE STATUS:

SMRT Architects and Engineers
144 Fore Street/P.O. Box 618
Portland, Maine 04104

ARCHITECTURE | ENGINEERING | PLANNING | INTERIORS | ENERGY **SMRT**

WEX
CORPORATE HEADQUARTERS
PORTLAND, ME
LEVEL ONE LIFE SAFETY PLAN

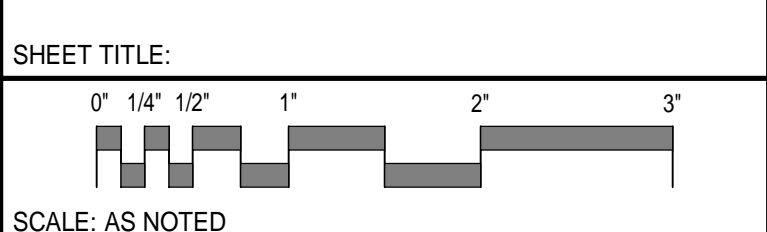

PROJECT MANAGER: GWV	PROJECT NO: 17120-01
A/E OF RECORD: GWV	
JOB CAPTAIN: CBM	
DRAWN BY: CBM	
SMRT FILE: A-002-17120-01	SHEET NO. A-002

NOT FOR CONSTRUCTION