

Prepared For:
**0 Hancock Street
LLC**

Consultant:
ENVELOPE
ARCHITECTURE & CONSULTING
BUILDING ENVELOPE DESIGN
COMMERCIAL • RESIDENTIAL • INDUSTRIAL • ME
207-807-6661

Architect:
ARCHETYPE
architects
48 Union Wharf Portland, Maine 04101
(207) 773-6022 ARCHETYPE@ARCHETYPEPA.COM

Project:
**WEX
BUILDING**
1 Hancock St. Portland Maine

Revisions:
Issued for Permit

Date: OCT 23, 2017
Scale: As indicated

DETAILS

A5.11

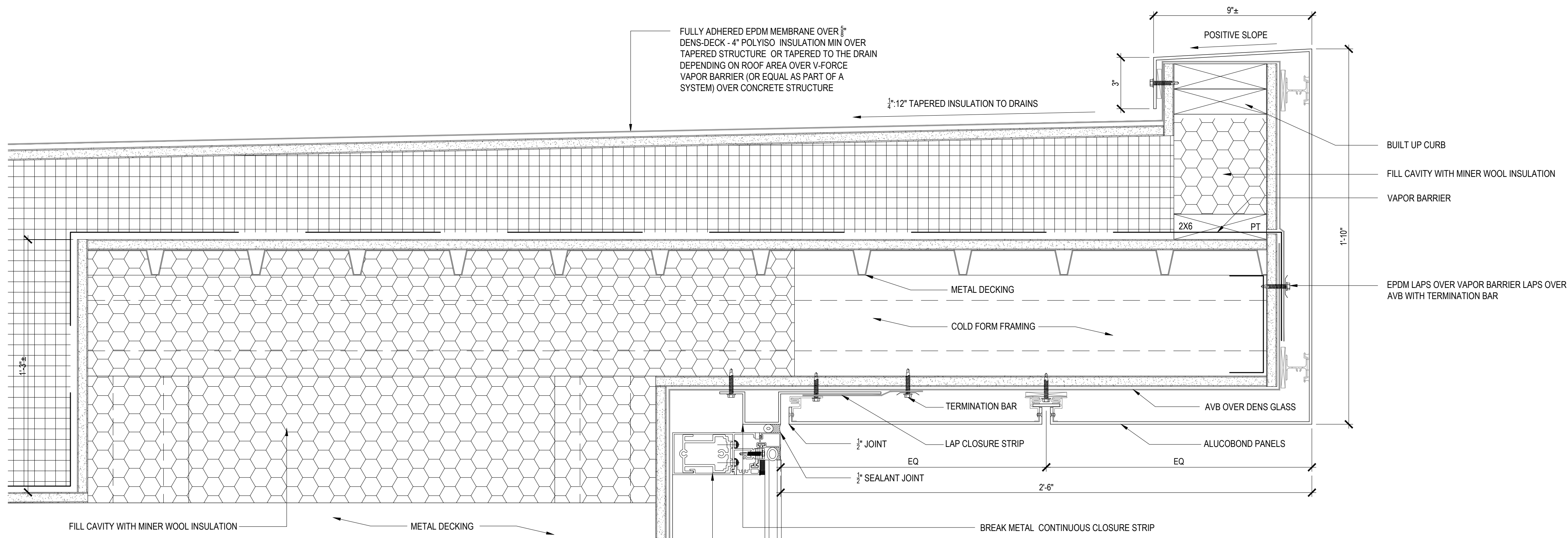

FIREPROOFING NOT SHOWN FOR CLARITY OF DETAILS - TYPICAL

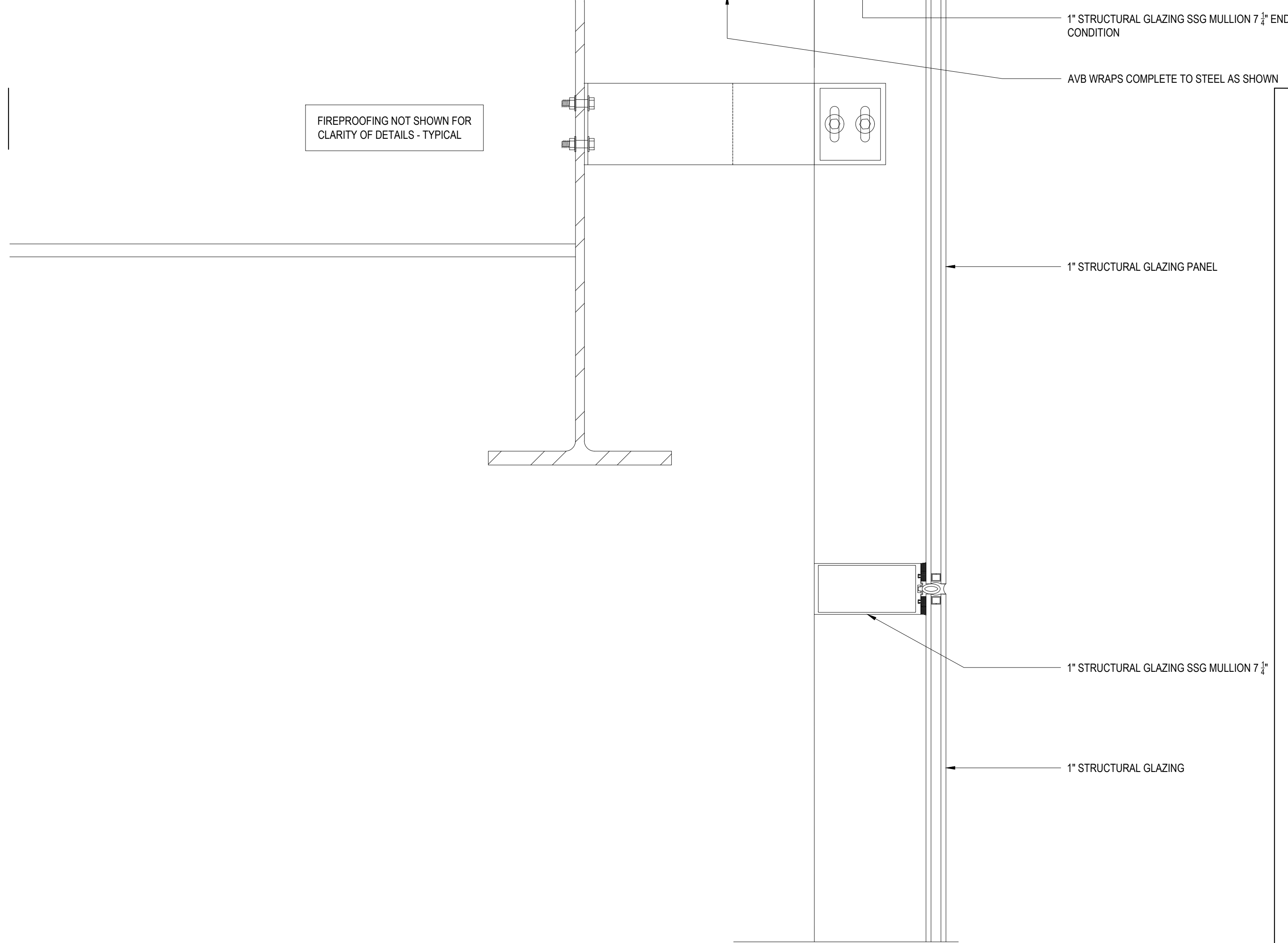

2

MAIN ROOF EDGE DETAIL - ALUCOBOND

SCALE: 6"=1'-0"

1

FIFTH FLOOR BASE OF WALL AT PEDESTAL SYSTEM

WALL DETAIL

SCALE: 3"=1'-0"