

2 ENTRY CANOPY PLAN

SCALE: 1/4"=1'-0"

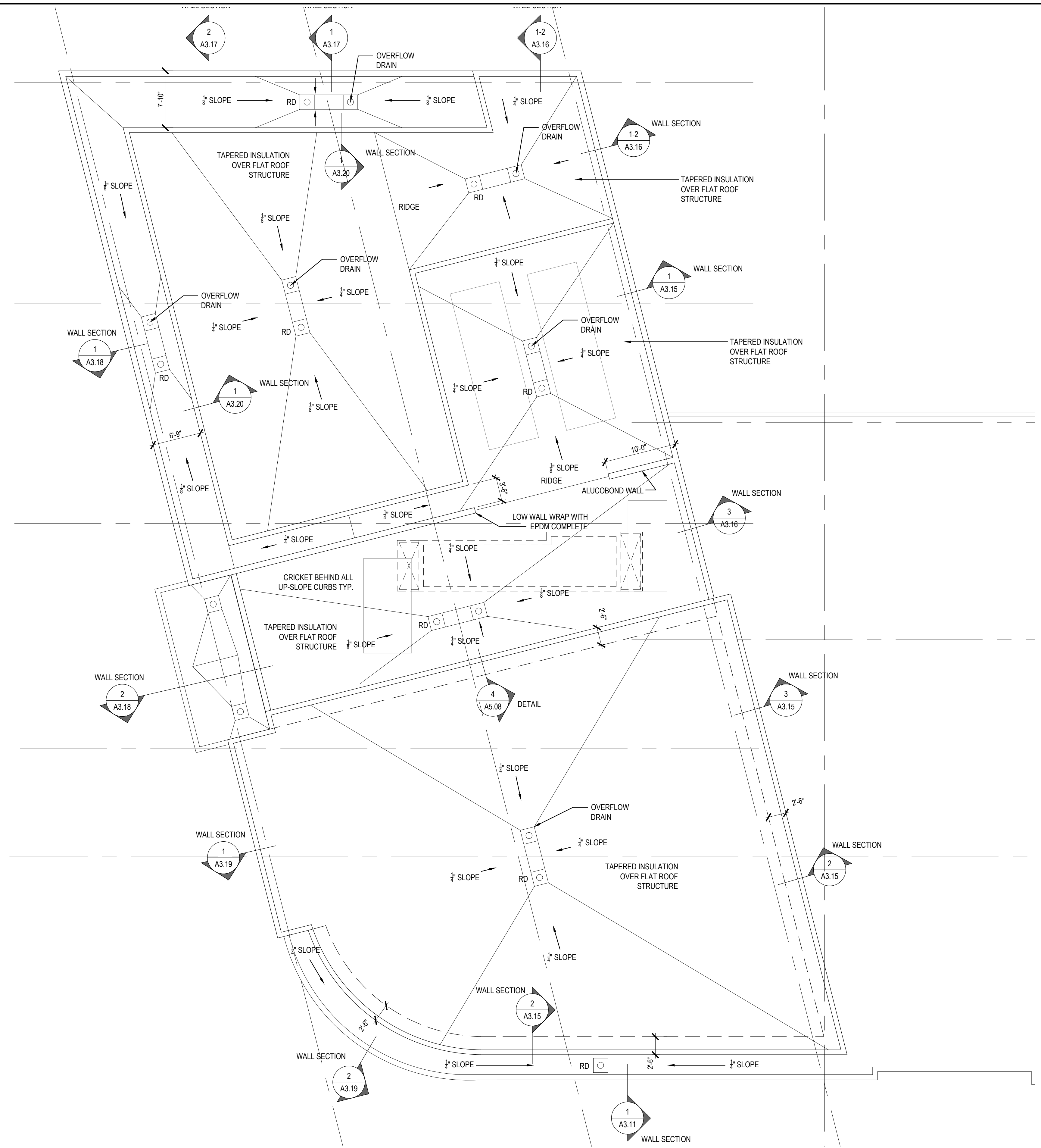

THIRD FLOOR ROOF NOTES

1. REFERENCE STRUCTURAL DRAWINGS FOR ROOF DECK CONSTRUCTION AND SLOPE
2. FIELD OF 3RD FLOOR ROOF SLOPED ROOF STRUCTURE TO HAVE 8" TYPICAL POLYISOCYANURATE FULLY ADHERED INSULATION.
3. ALL ROOF DECKS TO HAVE A FULLY ADHERED VAPOR BARRIER (VB) AS PART OF THE PROPRIETARY SYSTEM INSTALLED. ALL VB WILL BE PROPERLY TERMINATED PRIOR TO INSULATION AND MEMBRANE INSTALLATION.
4. ADDITIONAL PROTECTION WILL BE ADDED TO AREAS OF ROOFTOP GARDENS AND PLANTINGS. THIS INSTALLATION AND THE INSTALLATION OF PLANTINGS ARE BY OTHERS BUT WILL BE COORDINATED AND WITH ROOF SHELL INSTALLATION.
5. ROOF DECK PLATFORM AND PEDESTALS ARE BY OTHERS. THE DECK INSTALLATION WILL NEED TO BE COORDINATED WITH THESE DRAWINGS SO THE FINISH FLOOR ELEVATION IS SET TO THE DOOR THRESHOLDS AND GUARDRAILS. ALL PEDESTALS WILL BE INSTALLED TO IN A WAY AS TO NOT VOID THE WARRANTY OF THE ROOF INSTALLED.
6. STAIR TOWER ROOF AND MECHANICAL ROOF TO BE MIN 4" DEPTH POLYISOCYANURATE TAPERED TO DRAINS AND SCUPPERS - SET SCUPPERS MAX 4" ABOVE ROOF DRAIN ELEVATION.

1 ENLARGED ROOF PLAN

SCALE: 1/8"=1'-0"

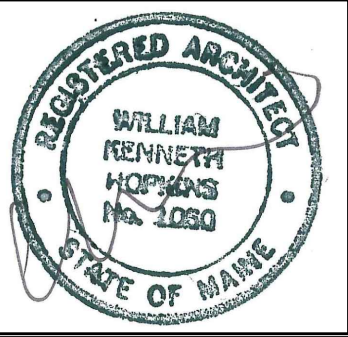

Prepared For:
**0 Hancock Street
 LLC**

Consultant:
ENVELOPE
 ARCHITECTURE & CONSULTING
 BUILDING ENVELOPE DESIGN
 ARCHITECTURE, INTERIOR DESIGN AND
 CONSULTING, INC. 100 WILSON ST. #100
 PORTLAND, ME 04101
 207-807-6661

Architect:
ARCHETYPE
 architects
 48 Union Wharf Portland, Maine 04101
 (207) 772-0022 ARCHETYPE@ARCHETYPEPA.COM

Project:
**WEX
 BUILDING**
 1 Hancock St., Portland Maine

Revisions:
 Issued for Permit

Date: OCT 23, 2017
 Scale: As indicated
**ENLARGED ROOF
 PLAN**

A1.05