



Prepared For:
0 Hancock Street LLC

Consultant:
ARCHETYPE architects
 48 Union Wharf Portland, Maine 04101
 (207) 772-6022 ARCHETYPE@ARCHETYPEPEA.COM

Project:
0 Hancock Street

Revisions:
 Issued For Permit - 10/23/2017

Date: August 2017
 Scale: As indicated
First Floor Plan

A1.01

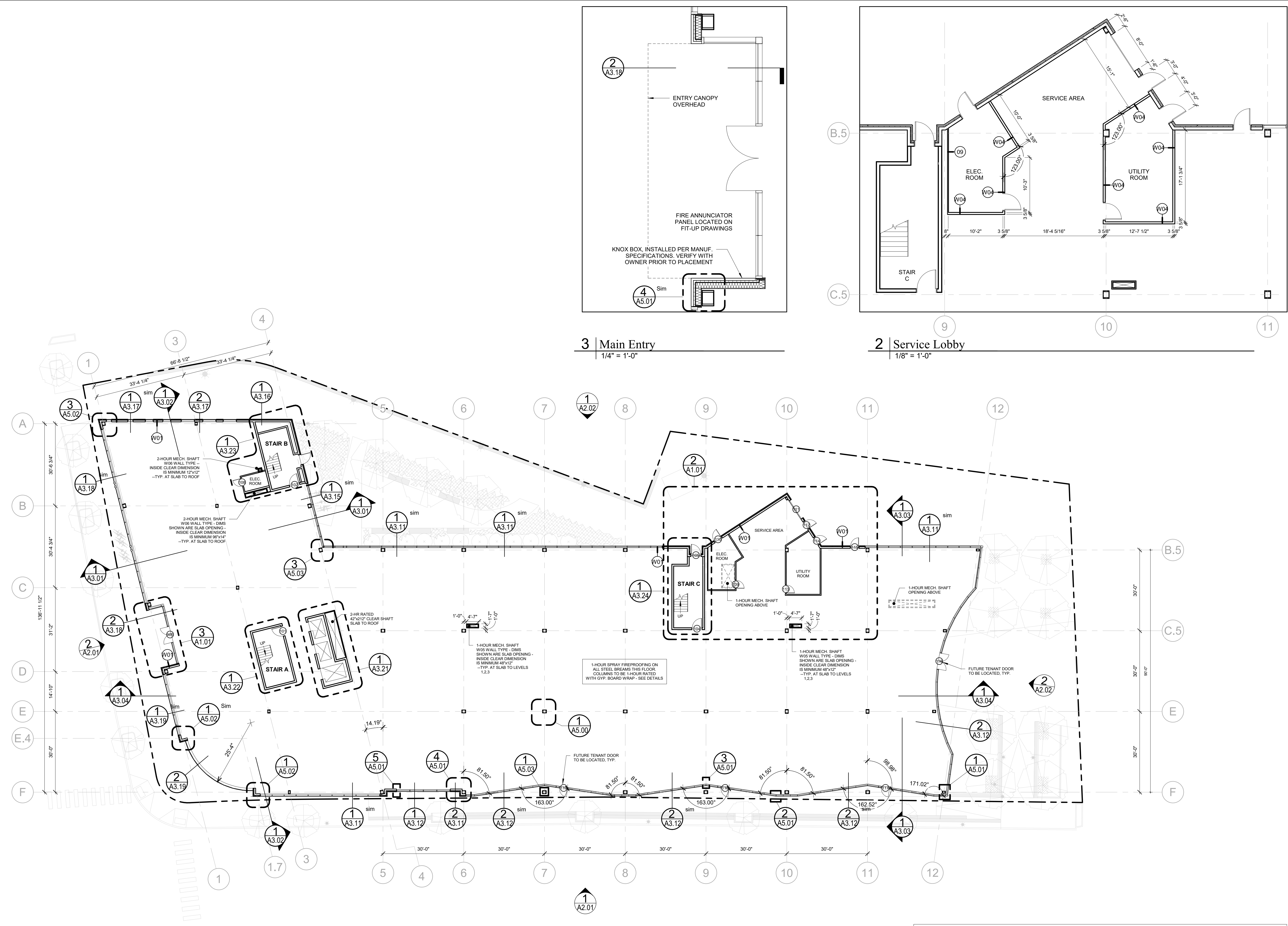

3 Main Entry
 1/4" = 1'-0"

2 Service Lobby
 1/8" = 1'-0"

1 1ST FLOOR
 1/16" = 1'-0"

- GENERAL NOTES:**
1. OFFSET STUDS WHERE REQUIRED TO ACCOMMODATE STRAIGHT RUNS OF WALLS WITH 1 AND 2 LAYERS OF GYP. BOARD. FINISHED GYP. BOARD SHALL BE A CONTINUOUS PLANE.
 2. ALL DIMENSIONS ARE TO FACE OF ROUGH FRAMING OR COLUMN CENTERLINE, U.N.O.
 3. SEE A4.00 SERIES FOR WALL TYPE ASSEMBLIES
 4. SEE A8.01 FOR DOOR SCHEDULE