

- NOTES:
 1) HOSPITAL GRADE WIRING AND DEVICES IN EXAM AREAS.
 2) WIRING TO BE HOSPITAL GRADE MC IN ALL AREAS.
 3) SECURITY PANEL AND DEVICES ARE FURNISHED AND WIRING BY OTHERS.
 4) MOTIONS DETECTOR IN MEDICATION AND COMM. ROOMS WILL BE SUPPLIED AND WIRED BACK TO PANEL IN ELECTRIC ROOM

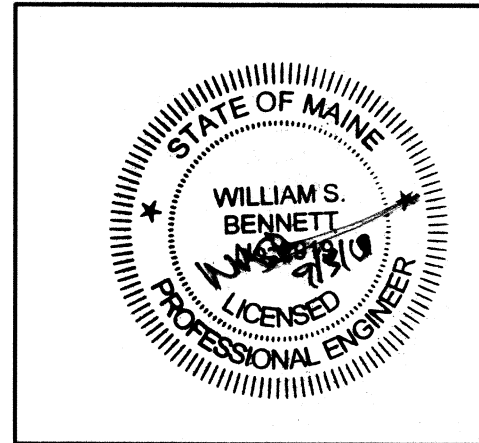
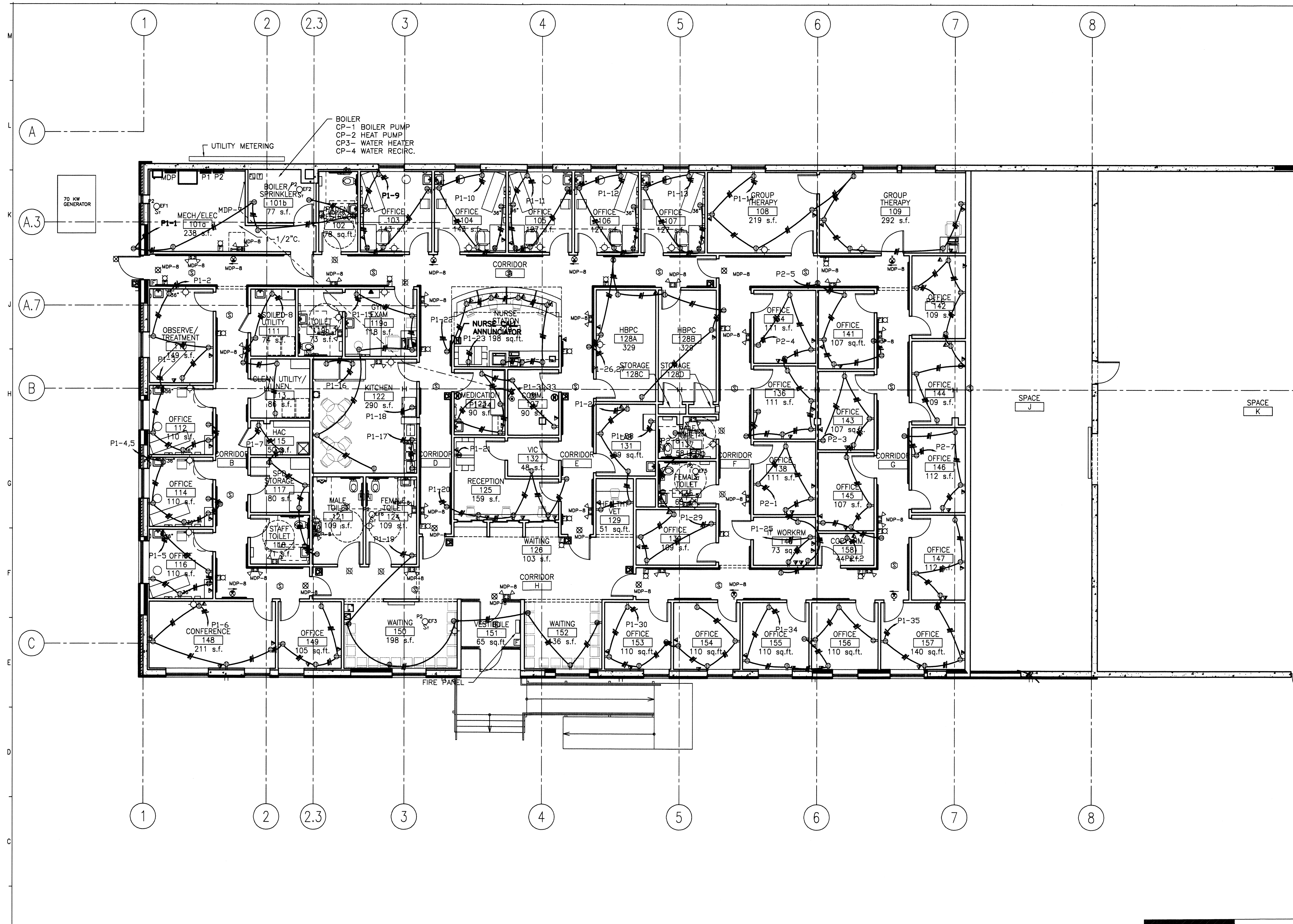

B.H. Milliken
 ELECTRICAL CONTRACTORS

175 ANDERSON STREET
 PORTLAND, MAINE 04101
 PHONE 879-1877
 FAX: 774-1492

THESE ELECTRICAL DRAWINGS ARE THE PROPERTY
 OF B.H. MILLIKEN ELECTRICAL CONTRACTORS INC.
 AND FOR THEIR USE ONLY.

PORTLAND DEPARTMENT OF VETERANS
 AFFAIRS
 FORE STREET
 PORTLAND, MAINE

TITLE	
POWER	
SCALE:	1/8"=1'
DATE:	9-1-10
SHEET	
E400	