

- REMOVALS LEGEND**
- (A) SAWCUT & REMOVE EXISTING PAVEMENT
  - (B) REMOVE EXISTING CONCRETE & BOLLARDS
  - (C) REMOVE EXISTING STEPS & EXTERNAL STRUCTURES COMPLETE
  - (D) REMOVE & STOCKPILE EXISTING SHRUBS; RELOCATE AS DIRECTED
  - (E) REMOVE EXISTING TIMBER WALL

144 Fore Street/P.O. Box 618  
 Portland, Maine 04104  
 tel. (207) 772-3846  
 fax. (207) 772-1070  
 www.smrinc.com

ARCHITECTURE  
 ENGINEERING  
 PLANNING  
 INTERIOR DESIGN  
 COMMISSIONING

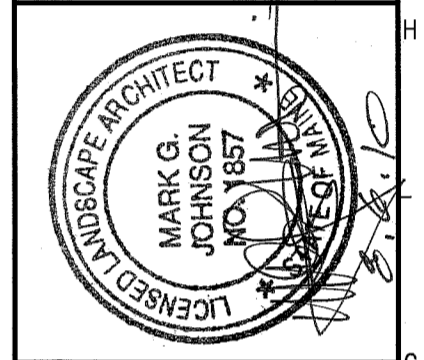
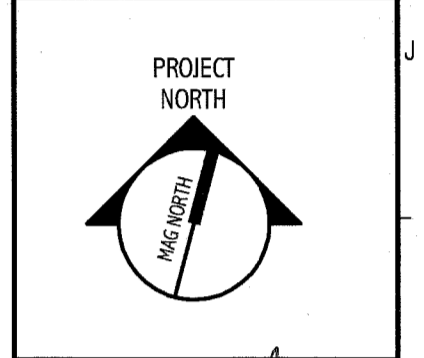
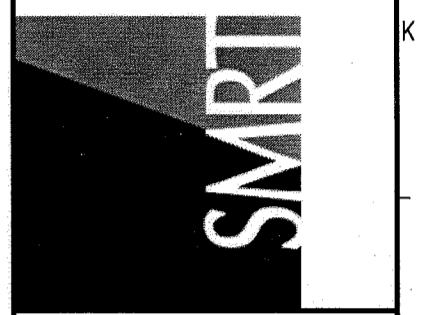

**PORTLAND DEPARTMENT OF VETERAN AFFAIRS**  
 PORTLAND, MAINE

**ISSUED FOR CONSTRUCTION**  
 8-09-10

CURRENT ISSUE STATUS:

REV	DESCRIPTION	DATE
0	ISSUED FOR CONSTRUCTION	8-09-10

GRAPHIC SCALE:  
 0" 1"

SCALE: 1" = 30'

PROJECT MANAGER: DRL  
 JC/DRAWN BY: TCM/WSM  
 A/E OF RECORD: MGI  
 CAD FILE: CS101-10022  
 PROJECT NO: 10022  
 DATE: 8-09-10

SHEET TITLE:  
**EXISTING CONDITIONS & REMOVALS PLAN**

SHEET No. **CS101**  
 © COPYRIGHT 2009 SMRI INC.