

DISPLAY THIS CARD ON PRINCIPAL FRONTAGE OF WORK  
**CITY OF PORTLAND**

BU **INSPECTION**

**PERMIT**

Permit Number: 100320  
**PERMIT ISSUED**

Please Read Application And Notes, if Any, Attached

This is to certify that DOWE PAUL JAMES JR./C/O Portland M... / Jon Curti  
has permission to install a 8' x 12' Shed APR - 2 2010  
AT 28 WATERVILLE ST 017 E034001

provided that the person or persons, firm or corporation accepting this permit shall comply with all of the provisions of the Statutes of Maine and of the Ordinances of the City of Portland regulating the construction, maintenance and use of buildings and structures, and of the application on file in this department.

Apply to Public Works for street line and grade if nature of work requires such information.

Notification of inspection must be given and written permission procured before this building or part thereof is lath... or other... used-in. 2...  
**HO... NOTICE IS REQUIRED.**

A certificate of occupancy must be procured by owner before this building or part thereof is occupied.

**OTHER REQUIRED APPROVALS**

Fire Dept. \_\_\_\_\_  
Health Dept. \_\_\_\_\_  
Appeal Board \_\_\_\_\_  
Other \_\_\_\_\_  
Department Name

*James Bank* 4/2/10  
Director - Building & Inspection Services

**PENALTY FOR REMOVING THIS CARD**

**City of Portland, Maine - Building or Use Permit Application**

389 Congress Street, 04101 Tel: (207) 874-8703, Fax: (207) 874-8716

Permit No: 10-0320	Issue Date:	CBL: 017 E034001
-----------------------	-------------	---------------------

Location of Construction: 28 WATERVILLE ST	Owner Name: DOWE PAUL JAMES JR	Owner Address: 28 WATERVILLE ST	Phone:
Business Name:	Contractor Name: Cumberland Mill Joinery/ Jon Curtis	Contractor Address: 358 Lisbon Street Lewiston	Phone:
Lessee/Buyer's Name	Phone:	Permit Type: Sheds	Zone: R-6

Past Use: Single Family Home	Proposed Use: Single Family Home - install a 8' x 12' Shed	Permit Fee: \$60.00	Cost of Work: \$3,500.00	CEO District: 1
Proposed Project Description: install a 8' x 12' Shed		FIRE DEPT: <input type="checkbox"/> Approved <input type="checkbox"/> Denied	INSPECTION: Use Group: U Type: R3  Signature: <i>AMB 4/2/10</i>	
		PEDESTRIAN ACTIVITIES DISTRICT (P.A.D.) Action: <input type="checkbox"/> Approved <input type="checkbox"/> Approved w/Conditions <input type="checkbox"/> Denied Signature: _____ Date: _____		

Permit Taken By: Idobson	Date Applied For: 04/02/2010	<b>Zoning Approval</b>		
-----------------------------	---------------------------------	------------------------	--	--

<p>1. This permit application does not preclude the Applicant(s) from meeting applicable State and Federal Rules.</p> <p>2. Building permits do not include plumbing, septic or electrical work.</p> <p>3. Building permits are void if work is not started within six (6) months of the date of issuance. False information may invalidate a building permit and stop all work..</p>	<p>Special Zone or Reviews</p> <input type="checkbox"/> Shoreland <input type="checkbox"/> Wetland <input type="checkbox"/> Flood Zone <input type="checkbox"/> Subdivision <input type="checkbox"/> Site Plan <i>OK w/conditions</i> Maj <input type="checkbox"/> Minor <input type="checkbox"/> MM <input type="checkbox"/> Date: <i>AMB 4/2/10</i>	<p>Zoning Appeal</p> <input type="checkbox"/> Variance <input type="checkbox"/> Miscellaneous <input type="checkbox"/> Conditional Use <input type="checkbox"/> Interpretation <input type="checkbox"/> Approved <input type="checkbox"/> Denied Date: _____	<p>Historic Preservation</p> <input checked="" type="checkbox"/> Not in District or Landmark <input type="checkbox"/> Does Not Require Review <input type="checkbox"/> Requires Review <input type="checkbox"/> Approved <input type="checkbox"/> Approved w/Conditions <input type="checkbox"/> Denied Date: _____
---	---	--	---

**PERMIT ISSUED**

APR - 2 2010

City of Portland

**CERTIFICATION**

I hereby certify that I am the owner of record of the named property, or that the proposed work is authorized by the owner of record and that I have been authorized by the owner to make this application as his authorized agent and I agree to conform to all applicable laws of this jurisdiction. In addition, if a permit for work described in the application is issued, I certify that the code official's authorized representative shall have the authority to enter all areas covered by such permit at any reasonable hour to enforce the provision of the code(s) applicable to such permit.

SIGNATURE OF APPLICANT	ADDRESS	DATE	PHONE
RESPONSIBLE PERSON IN CHARGE OF WORK, TITLE		DATE	PHONE



# CITY OF PORTLAND, MAINE

Department of Building Inspections

## Original Receipt

4-2-20 10

Received from

Paul Dowe

Location of Work

28 Waterville St

Cost of Construction \$ \_\_\_\_\_

Building Fee: \_\_\_\_\_

Permit Fee \$ \_\_\_\_\_

Site Fee: \_\_\_\_\_

Certificate of Occupancy Fee: \_\_\_\_\_

Total: 60

Building (I1) \_\_\_\_\_

Plumbing (I5) \_\_\_\_\_

Electrical (I2) \_\_\_\_\_

Site Plan (U2) \_\_\_\_\_

Other \_\_\_\_\_

CBL: \_\_\_\_\_

Check #: 1221

Total Collected \$ 60

**No work is to be started until permit issued.  
Please keep original receipt for your records.**

Taken by: [Signature]

WHITE - Applicant's Copy

YELLOW - Office Copy

PINK - Permit Copy



# General Building Permit Application

If you or the property owner owes real estate or personal property taxes or user charges on any property within the City, payment arrangements must be made before permits of any kind are accepted.

Location/Address of Construction: <u>28 Waterville St.</u>		
Total Square Footage of Proposed Structure/Area <u>96 SF</u>	Square Footage of Lot	Number of Stories <u>1</u>
Tax Assessor's Chart, Block & Lot Chart# <u>MAP 17</u> Block# <u>LOTS E 34, 401</u> Lot# <u>41</u>	Applicant * <u>must</u> be owner, Lessee or Buyer* Name <u>Paul Dowe Jr.</u> Address <u>28 Waterville St.</u> City, State & Zip <u>Portland, ME 04101</u>	Telephone: <u>207 478 3631</u> <u>207 899. 2279</u>
Lessee/DBA (If Applicable)	Owner (if different from Applicant) Name Address City, State & Zip	Cost Of Work: \$ <u>3500</u> C of O Fee: \$ _____ Total Fee: \$ <u>60</u>
Current legal use (i.e. single family) <u>single family</u>	Number of Residential Units <u>1</u>	<div style="font-size: 2em; font-weight: bold; transform: rotate(-15deg);">RECEIVED</div> <div style="font-size: 1.2em; font-weight: bold; transform: rotate(-15deg);">APR - 2 2010</div> <div style="font-size: 0.8em; font-weight: bold; transform: rotate(-15deg);">Dept. of Building Inspections City of Portland Maine</div>
If vacant, what was the previous use? _____	Proposed Specific use: <u>shed</u>	
Is property part of a subdivision? <u>no</u>	If yes, please name _____	
Project description: <u>8x12 shed -</u>		
Contractor's name: <u>Jon Curtis Cumberland Mill Joinery</u>		
Address: <u>358 Lisbon St.</u>		
City, State & Zip: <u>Leiston, ME 04240</u>		Telephone: _____
Who should we contact when the permit is ready: <u>Paul Dowe</u>		Telephone: <u>207 478 3631</u>
Mailing address: <u>28 Waterville St. Portland, ME 04101</u>		

Please submit all of the information outlined on the applicable Checklist. Failure to do so will result in the automatic denial of your permit.

In order to be sure the City fully understands the full scope of the project, the Planning and Development Department may request additional information prior to the issuance of a permit. For further information or to download copies of this form and other applications visit the Inspections Division on-line at [www.portlandmaine.gov](http://www.portlandmaine.gov), or stop by the Inspections Division office, room 315 City Hall or call 874-8703.

I hereby certify that I am the Owner of record of the named property, or that the owner of record authorizes the proposed work and that I have been authorized by the owner to make this application as his/her authorized agent. I agree to conform to all applicable laws of this jurisdiction. In addition, if a permit for work described in this application is issued, I certify that the Code Official's authorized representative shall have the authority to enter all areas covered by this permit at any reasonable hour to enforce the provisions of the codes applicable to this permit.

Signature: Paul Dowe Date: 4.2.10

This is not a permit; you may not commence ANY work until the permit is issued

**City of Portland, Maine - Building or Use Permit Application** 389 Congress Street, 04101, Tel: (207) 874-8703, FAX: 874-8716

Location of Construction: ** 28 Waterville St		Owner: Johanna Pulkkinen		Phone: 773-2641		Permit No: <b>990095</b>
Owner Address: SAA Ptld 04101		Lessee/Buyer's Name:		Phone:		
Contractor Name: Jos. Daniels, 18 Paige Dr		Address: Gorham ME 04038		Phone:		Zone: <i>R-1</i> CBL: 017-E-034 Zoning Approval: <i>to remain in unit</i> Special Zone or Reviews: <input type="checkbox"/> Shoreland <i>2/9/99</i> <input type="checkbox"/> Wetland <input type="checkbox"/> Flood Zone <input type="checkbox"/> Subdivision <input type="checkbox"/> Site Plan maj <input type="checkbox"/> minor <input type="checkbox"/> mm
Past Use: 1-family		Proposed Use: same		COST OF WORK: \$ 3000 PERMIT FEE: \$ 35.00 FIRE DEPT. <input type="checkbox"/> Approved <input type="checkbox"/> Denied INSPECTION: Use Group: <i>R-3</i> Type: <i>5B</i> <i>COCA 96</i> Signature: <i>[Signature]</i>		
Proposed Project Description:  Construct deck off slider				Permit Taken By: <i>SP</i> Date Applied For: <b>January 27, 1999</b>		

- This permit application does not preclude the Applicant(s) from meeting applicable State and Federal rules.
- Building permits do not include plumbing, septic or electrical work.
- Building permits are void if work is not started within six (6) months of the date of issuance. False information may invalidate a building permit and stop all work..

**CERTIFICATION**

I hereby certify that I am the owner of record of the named property, or that the proposed work is authorized by the owner of record and that I have been authorized by the owner to make this application as his authorized agent and I agree to conform to all applicable laws of this jurisdiction. In addition, if a permit for work described in the application is issued, I certify that the code official's authorized representative shall have the authority to enter all areas covered by such permit at any reasonable hour to enforce the provisions of the code(s) applicable to such permit

January 27, 1999

SIGNATURE OF APPLICANT \_\_\_\_\_ ADDRESS: \_\_\_\_\_ DATE: \_\_\_\_\_ PHONE: \_\_\_\_\_

RESPONSIBLE PERSON IN CHARGE OF WORK, TITLE \_\_\_\_\_ PHONE: \_\_\_\_\_

White-Permit Desk Green-Assessor's Canary-D.P.W. Pink-Public File Ivory Card-Inspector

**Zoning Appeal**

Variance  
 Miscellaneous  
 Conditional Use  
 Interpretation  
 Approved  
 Denied

Historic Preservation  
 Not in District or Landmark  
 Does Not Require Review  
 Requires Review

Action:  
 Approved  
 Approved with Conditions  
 Denied

Date: *[Signature]*

CEO DISTRICT AR/DC

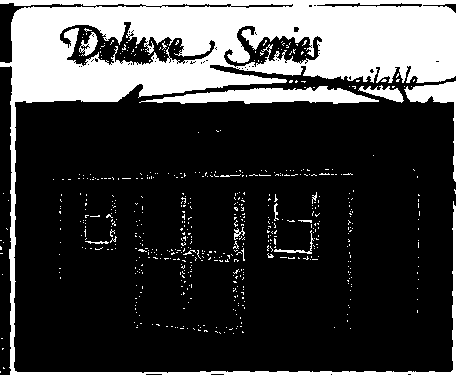
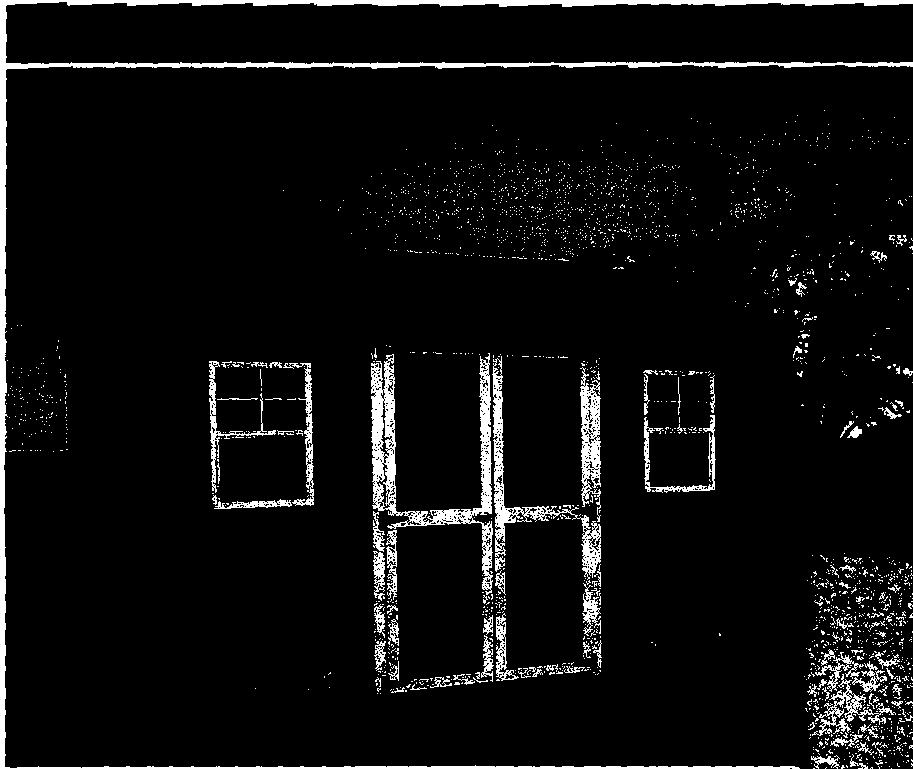

*The* **WORKSHOP**

*Deluxe Series*  
*also available*

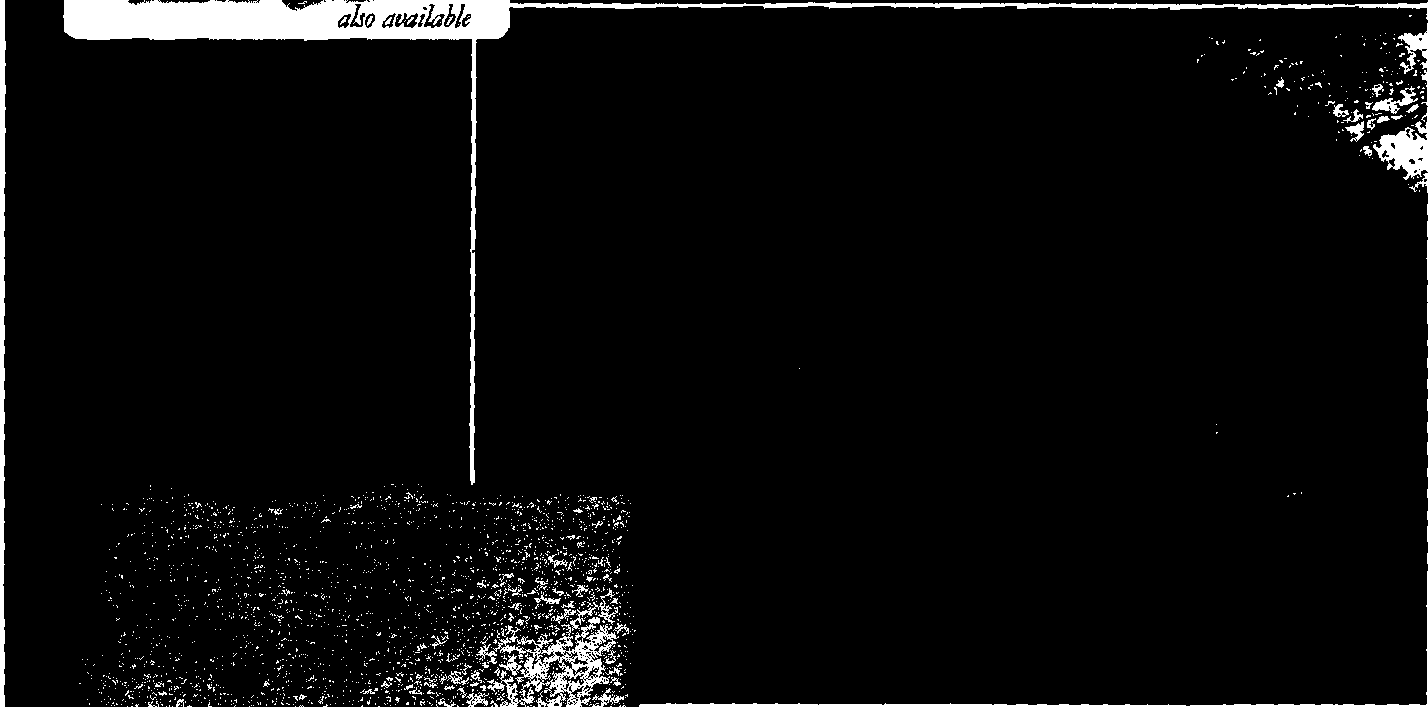

*The* **CARRIAGE**

Assessor's Office | 389 Congress Street | Portland, Maine 04101 | Room 115 | (207) 874-8486

City Home Departments City Council E-Services Calendar Jobs

This page contains a detailed description of the Parcel ID you selected. Press the **New Search** button at the bottom of the screen to submit a new query.

**Current Owner Information:**

<b>Services</b>	<b>CBL</b>	017 E034001
	<b>Land Use Type</b>	SINGLE FAMILY
	<b>Property Location</b>	28 WATERVILLE ST
<b>Applications</b>	<b>Owner Information</b>	DOWE PAUL JAMES JR 28 WATERVILLE ST PORTLAND ME 04101
<b>Doing Business</b>	<b>Book and Page</b>	27127/292
<b>Maps</b>	<b>Legal Description</b>	17-E-34 WATERVILLE ST 28
<b>Tax Relief</b>		1678 SF
<b>Tax Roll</b>	<b>Acres</b>	0.039

*Min Lot Size 4,500  
 L 144 SF = 5' setback  
 50% Lot coverage  
 1678 x .50 =  
 839 SF*

**Current Assessed Valuation:**

<b>Q &amp; A</b>	<b>TAX ACCT NO.</b>	2850	<b>OWNER OF RECORD AS OF APRIL 2009</b> PULKKINEN JOHANNA
<b>browse city services a-z</b>	<b>LAND VALUE</b>	\$152,900.00	28 WATERVILLE ST PORTLAND ME 04101
	<b>BUILDING VALUE</b>	\$73,300.00	
	<b>HOMESTEAD EXEMPTION</b>	(\$12,350.00)	
<b>browse facts and files a-z</b>	<b>NET TAXABLE - REAL ESTATE</b>	\$214,450.00	
	<b>TAX AMOUNT</b>	\$3,804.34	

Any information concerning tax payments should be directed to the Treasury office at 874-8490 or e-mailed.



**Building Information:**

Card 1 of 1

Best viewed at 800x600, with Internet Explorer

<b>Year Built</b>	1859
<b>Style/Structure Type</b>	OLD STYLE
<b># Stories</b>	1
<b>Bedrooms</b>	3
<b>Full Baths</b>	1
<b>Total Rooms</b>	7
<b>Attic</b>	FULL FINISH
<b>Basement</b>	FULL
<b>Square Feet</b>	762
<b>View Sketch</b>	<a href="#">View Map</a> <a href="#">View Picture</a>



**Sales Information:**

Sale Date	Type	Price	Book/Page
7/28/2009	LAND + BUILDING	\$285,000.00	27127/292
9/1/1995	LAND + BUILDING	\$0.00	12116/208
9/1/1995	LAND + BUILDING	\$48,000.00	12116/210

**New Search**

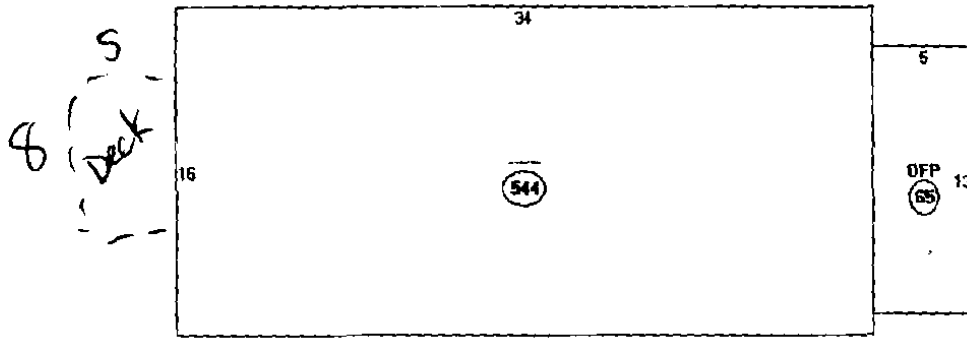

Descriptor/Area

A: 544 sqft  
B: OFP 65 sqft

> 609  
Shed 96  

---

705 SF  
Deck 40  

---

745  

---

839 allowed