

1 FIRST FLOOR PLAN
A1.1 1/4" = 1'-0"

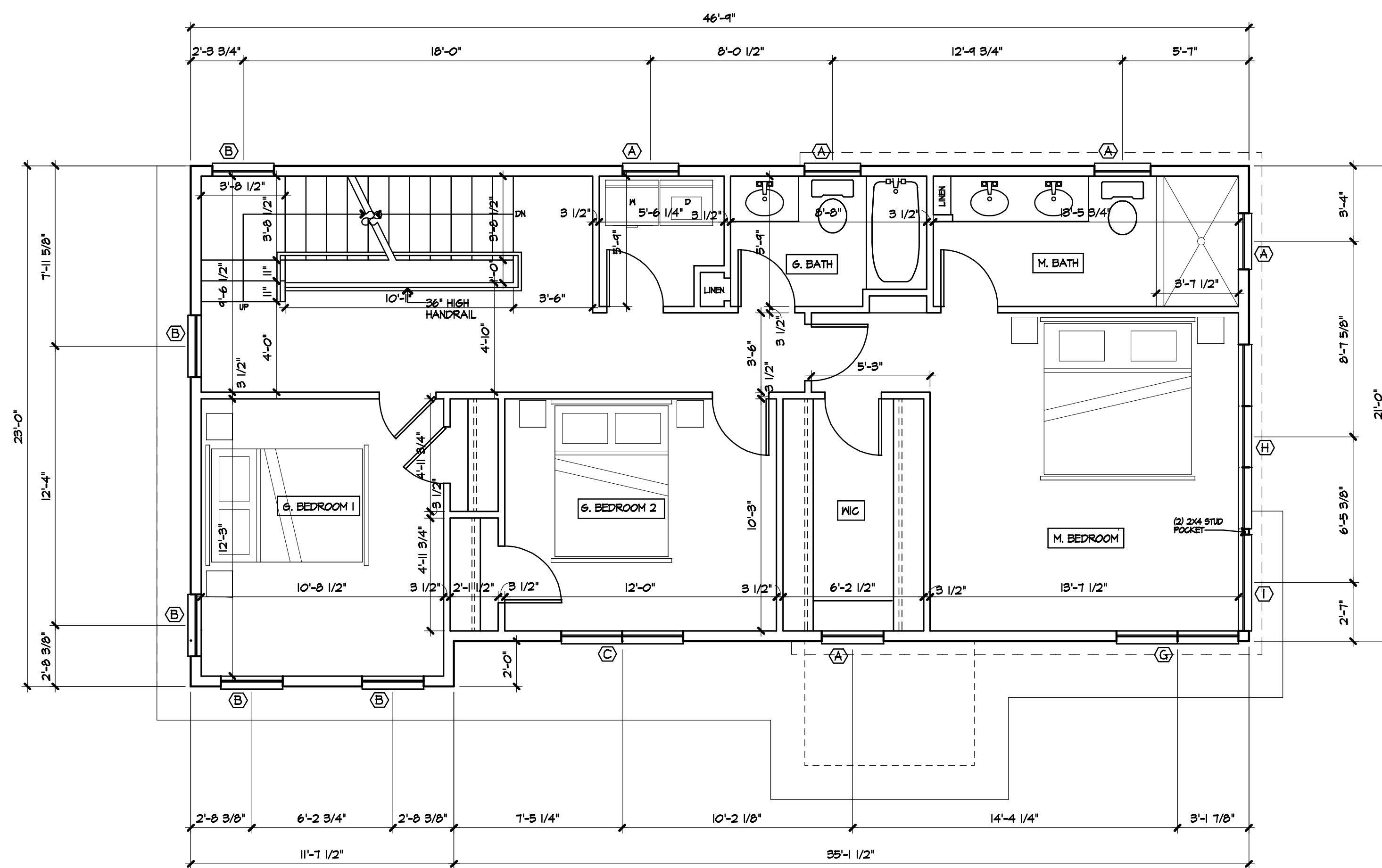

2 SECOND FLOOR PLAN
A1.1 1/4" = 1'-0"

CONTRACTOR SHALL MEASURE AND VERIFY ALL DIMENSIONS AT THE WORK.
THIS DRAWING IS A PART OF A FULL SET OF DRAWINGS COMPRISING THE CONTRACT DOCUMENTS.
FOR THE WORK OF THIS PROJECT, THE ARCHITECTURE ACCEPTS NO RESPONSIBILITY FOR THE
CONTRACTOR'S ERRORS OR OMISSIONS IF EACH TRADE DOES NOT HAVE THE FULL SET OF
DRAWINGS AND SPECIFICATIONS.

COPYRIGHT 2015 ©
THE MATERIAL CONTAINED IN THESE DRAWINGS AND THE DESIGN THEY ARE INTENDED TO CONVEY ARE THE
EXCLUSIVE PROPERTY OF KEVIN BROWNE ARCHITECTURE LLC. POSSESSION AND USE HEREOF IS GRANTED ONLY
CONFIDENTIALLY IN CONNECTION WITH CONSTRUCTION OF THE BUILDING DEPICTED HEREIN AS AUTHORIZED
BY KEVIN BROWNE ARCHITECTURE LLC. THE RECIPIENT AGREES TO ABIDE BY THESE RESTRICTIONS. ANY USE,
REPRODUCTION OR DISCLOSURE OF ANY INFORMATION, IN WHOLE OR IN PART, CONTAINED HEREIN WITHOUT
WRITTEN PERMISSION OF KEVIN BROWNE ARCHITECTURE LLC IS EXPRESSLY PROHIBITED.

REVISIONS:
5-4-15 ISSUE FOR PERMIT
7-20-15 REISSUE FOR PERMIT
8-6-15 REISSUE FOR PERMIT

CONSULTANTS:

JUDKINS RESIDENCE
CLIENT: TYLER & KATE JUDKINS
ADDRESS: 107 MONUMENT ST.
PORTLAND, ME

FIRST & SECOND FLOOR PLAN
DATE: 8/3/2015 DRAWN: KWB SCALE: 1/4" = 1'-0"
PROJECT NO.: 2015-03