

PERMIT ISSUED

City of Portland, Maine - Building or Use Permit Application

389 Congress Street, 04101 Tel: (207) 874-8703, Fax: (207) 874-8716

Permit No: 06-0.71	Issue Date: FEB - 9 2006	CBL: 06 J020001
-----------------------	------------------------------------	--------------------

Location of Construction: 23 WATERVILLE ST	Owner Name: PETIT MICHAEL R	Owner Address: 25 WATERVILLE ST CITY OF PORTLAND	Phone:
Business Name:	Contractor Name: A J Ricci	Contractor Address: 22 Olympia St Portland 12079395975	
Lessee/Buyer's Name	Phone:	Permit Type: Alterations - <u>Duplex</u>	Zone: R6

Past Use: Residential 2 unit	Proposed Use: Residential 2 unit interior renovations to small apt.	Permit Fee: \$291.00	Cost of Work: \$30,000.00	CEO District: 1
Proposed Project Description: Interior renovations to small apt.		FIRE DEPT: <input type="checkbox"/> Approved <input type="checkbox"/> Denied	INSPECTION: Use Group: <u>R3</u> Type: <u>IRC-2003</u> Signature: <u>AMB 2/9/06</u>	
		Signature	Signature	

Permit Taken By: dmartin	Date Applied For: 02/03/2006	Zoning Approval	
------------------------------------	--	------------------------	--

1. This permit application does not preclude the Applicant(s) from meeting applicable State and Federal Rules. 2. Building permits do not include plumbing, septic or electrical work. 3. Building permits are void if work is not started within six (6) months of the date of issuance. False information may invalidate a building permit and stop all work..	Special Zone or Reviews <input type="checkbox"/> Shoreland <input type="checkbox"/> Wetland <input type="checkbox"/> Flood Zone <input type="checkbox"/> Subdivision\$ <input type="checkbox"/> Site Plan Maj <input type="checkbox"/> Minor <input type="checkbox"/> MM <input type="checkbox"/> Date: <u>JMB 2/9/06</u>	Zoning Appeal <input type="checkbox"/> Variance <input type="checkbox"/> Miscellaneous <input type="checkbox"/> Conditional Use <input type="checkbox"/> Interpretation <input type="checkbox"/> Approved <input type="checkbox"/> Denied Date:	Historic Preservation <input checked="" type="checkbox"/> Not in District or Landmark <input type="checkbox"/> Does Not Require Review <input type="checkbox"/> Requires Review <input type="checkbox"/> Approved <input type="checkbox"/> Approved w/Conditions <input type="checkbox"/> Denied Date: <u>JMB</u>
--	---	---	---

CERTIFICATION

I hereby certify that I am the owner of record of the named property, or that the proposed work is authorized by the owner of record and that I have been authorized by the owner to make this application as his authorized agent and I agree to conform to all applicable laws of this jurisdiction. In addition, if a permit for work described in the application is issued, I certify that the code official's authorized representative shall have the authority to enter all areas covered by such permit at any reasonable hour to enforce the provision of the code(s) applicable to such permit.

SIGNATURE OF APPLICANT ADDRESS DATE PHONE

RESPONSIBLE PERSON IN CHARGE OF WORK, TITLE DATE PHONE

City of Portland, Maine - Building or Use Permit

389 Congress Street, 04101 Tel: (207) 874-8703, Fax: (207) 874-8716

Permit No: 06-0171	Date Applied For: 02/03/2006	CBL: 016 5020001
------------------------------	--	----------------------------

Location of Construction: 23 WATERVILLE ST	Owner Name: PETIT MICHAEL R	Owner Address: 25 WATERVILLE ST	Phone:
Business Name:	Contractor Name: A J Ricci	Contractor Address: 22 Olympia St Portland	Phone (207) 939-5975
Lessee/Buyer's Name	Phone:	Permit Type: Alterations - Duplex	

Proposed Use: Residential 2 unit interior renovations to small apt.	Proposed Project Description: Interior renovations to small apt.
---	--

Dept: Zoning Status: Approved with Conditions Reviewer: Jeanine Bourke Approval Date: 02/09/2006

Note: **Ok to Issue:**

- 1) This property shall remain a two family dwelling. Any change of use shall require a separate permit application for review and approval.

Dept: Building Status: Approved with Conditions Reviewer: Jeanine Bourke Approval Date: 02/09/2006

Note: **Ok to Issue:**

- 1) Separate permits are required for any electrical, plumbing, or heating.
- 2) The design load spec sheets for any engineered beam(s) must be submitted to this office.
- 3) Permit approved based on the plans submitted and reviewed w/owner/contractor, with additional information as agreed on and as noted on plans.

Comments :

02/09/2006-jmb: scheduled for a same day review



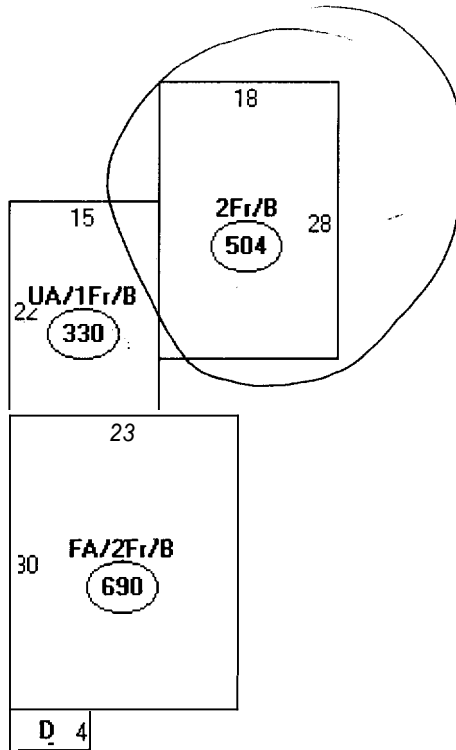

Descriptor/Area
A: FA/2Fr/B
690 sqft
E: UA/1Fr/B
330 sqft
C: 2Fr/B
504 sqft
D: DFP
32 sqft

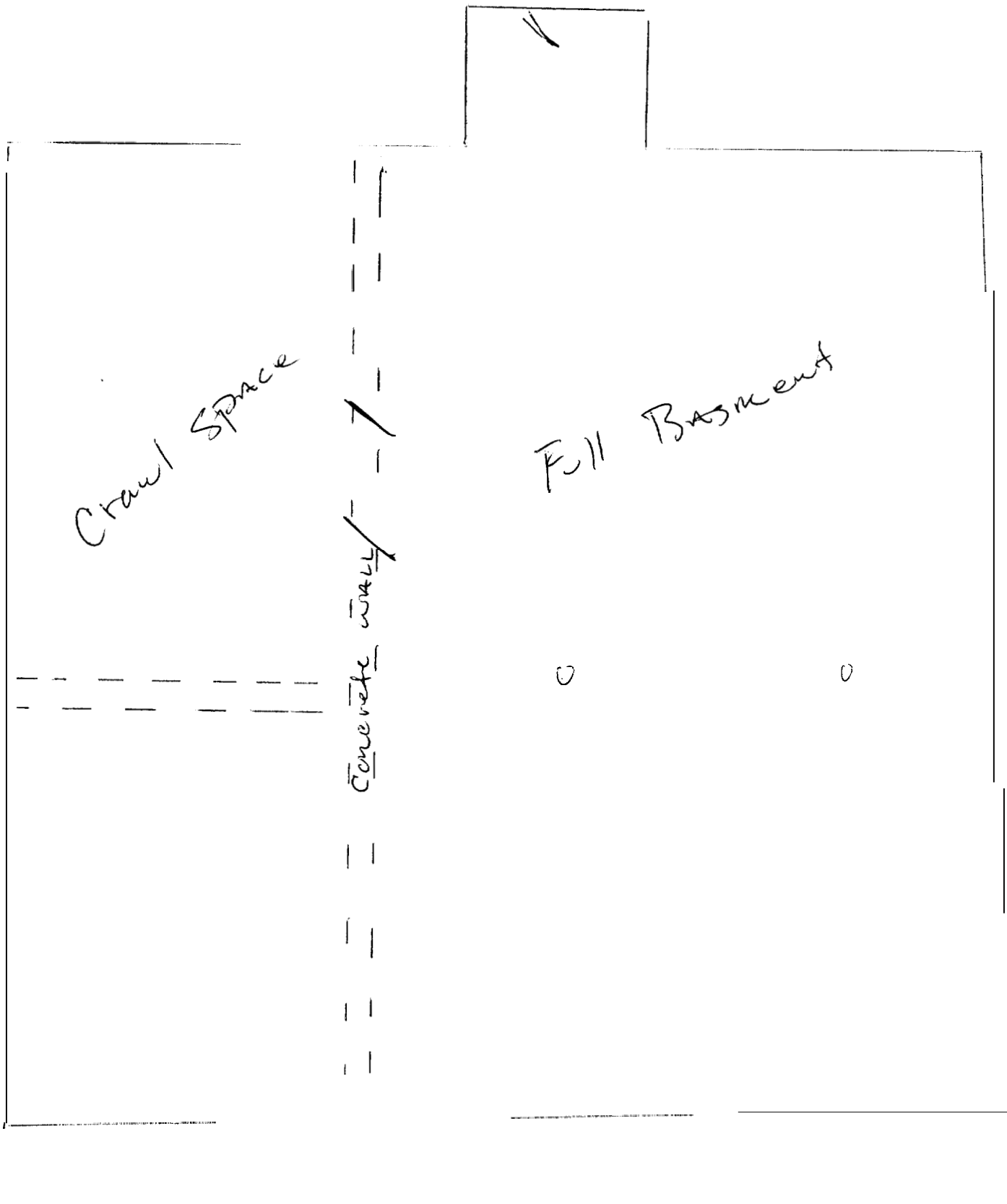

Crawl Space

Full Basement

Concrete wall

o

o

Demolition

First Floor:

- Kitchen**
- 1) Remove 14' wall in kitchen (seperated kitchen and hallway)
 - 2) Remove kitchen window
 - 3) Remove kitchen finished floor
 - 4) Remove kitchen cabinets, sink, and stove
 - 5) Remove all plumbing
 - 6) Remove all electrical
 - ✓7) Remove plaster walls and ceiling
 - 8) Grind chimney

- Living Room**
- 1j Demo 8' of ll (sheetrock)
 - 2) Demo 13' x 6' ceiling

- Second Floor:**
- 1) Remove half of plaster wall in stariway
 - 2) Remove section of plaster wall in upstairs hallway
 - 3) Remove bathroom wall and ceiling and all trim
 - 4) Remove bedroom window

Installation

First Floor:

- Kitchen**
- 1) Pluming
 - 2) Electrical
 - 3) Kitchen window (4 x 3 slider)
 - 4) Insilate walls
 - 5) 1/2" plywood behind incoming cabinets
 - 6) Sheetrock ceiling and walls
 - 7) Kitchen cabinets and countertops
 - 8) 9' long header made of 2 x 8 and 1/2" plywood
 - 9) Point and seal cheming (to be exposed)
 - 10) Framed closet under stair (2 x 4 16" o.c.)
 - 11) Instal closet door
 - 12) Sofet above cabinets for pluming pipe - *Installing plywood first*
 - 13) Instal mutal corner for pluming pipe
- Living Room**
- 1) Install 8' of sheatrock on back wall /for removal wall
 - 2) Install sheatrock ceiling

Second Floor:

- 1) Install closet in bedroom (2 x 4 16" o.c. - 2'6"-5'6")
- 2) Install closet in master bedroom (2 x 4 16" o.c. - 2'6"-5'6")
- 3) Bathroom wall for shower 2 x 4 16" o.c.

BUILDING PERMIT INSPECTION PROCEDURES

Please call 874-8703 or 874-8693 to schedule your inspections as agreed upon

Permits expire in 6 months, if the project is not started or ceases for 6 months.

The Owner or their designee is required to notify the inspections office for the following inspections and provide adequate notice. Notice must be called in 48-72 hours in advance in order to schedule an inspection:

By initializing at each inspection time, you are agreeing that you understand the inspection procedure and additional fees from a "Stop Work Order" and "Stop Work Order Release" will be incurred if the procedure is not followed as stated below.

A Pre-construction Meeting will take place upon receipt of your building permit.

- NA Footing/Building Location Inspection: Prior to pouring concrete
- NA Re-Bar Schedule Inspection: Prior to pouring concrete
- NA Foundation Inspection: Prior to placing ANY backfill
- Framing/Rough Plumbing/Electrical: Prior to any insulating or drywalling
- ~~Final/Certificate of Occupancy~~: Prior to any occupancy of the structure or use. NOTE: ~~There is a \$75.00 fee per inspection at this point.~~

Certificate of Occupancy is not required for certain projects. Your inspector can advise you if your project requires a Certificate of Occupancy. All projects DO require a final inspection

If any of the inspections do not occur, the project cannot go on to the next phase, REGARDLESS OF THE NOTICE OR CIRCUMSTANCES.

NA **CERIFICATE OF OCCUPANICES MUST BE ISSUED AND PAID FOR, BEFORE THE SPACE MAY BE OCCUPIED**

Anthony Ricci
Signature of Applicant/Designee

Date

James Bourke
Signature of Inspections Official

2/9/06
Date

CBL: 16-J-20

Building Permit #: 06-0171

DISPLAY THIS CARD ON PRINCIPAL FRONTAGE OF WORK

CITY OF PORTLAND

BUILDING INSPECTION

PERMIT

Please Read Application And Notes, If Any, Attached

This is to certify that PETT MICHAEL R / A.I.R.

has permission to Interior renovations to small

at 23 WATERVILLE ST.

provided that the person or persons performing or accepting this permit shall comply with all of the provisions of the Statutes of the State of Oregon and of the Ordinances of the City of Portland regulating the construction, maintenance and use of buildings and structures, and of the application on file in this department.

Apply to Public Works for street line and grade if nature of work requires such information.

Notification of inspection must be given and when permit is in process before this building or structure is occupied or closed-in. HOUR NOTICES REQUIRED.

A certificate of occupancy must be procured by owner before this building or part thereof is occupied.

OTHER REQUIRED APPROVALS

Fire Dept. _____

Health Dept. _____

Appeal Board _____

Other _____

Department Name _____

PENALTY FOR REMOVING THIS CARD

Director - Building & Inspection Services

Deanne Bouke 2/9/06

CITY OF PORTLAND

PERMIT ISSUED

Permit Number: 060712006 FEB - 9 2006