

ALTERATIONS TO
52 MONUMENT STREET
PORTLAND, MAINE

TITLE
SITE PLAN

DATE
ORIGINAL: 11/5/13
REVISION 1:
REVISION 2:
REVISION 3:
ISSUED FOR:
BUILDING PERMIT SET

DRAWING NO:
1

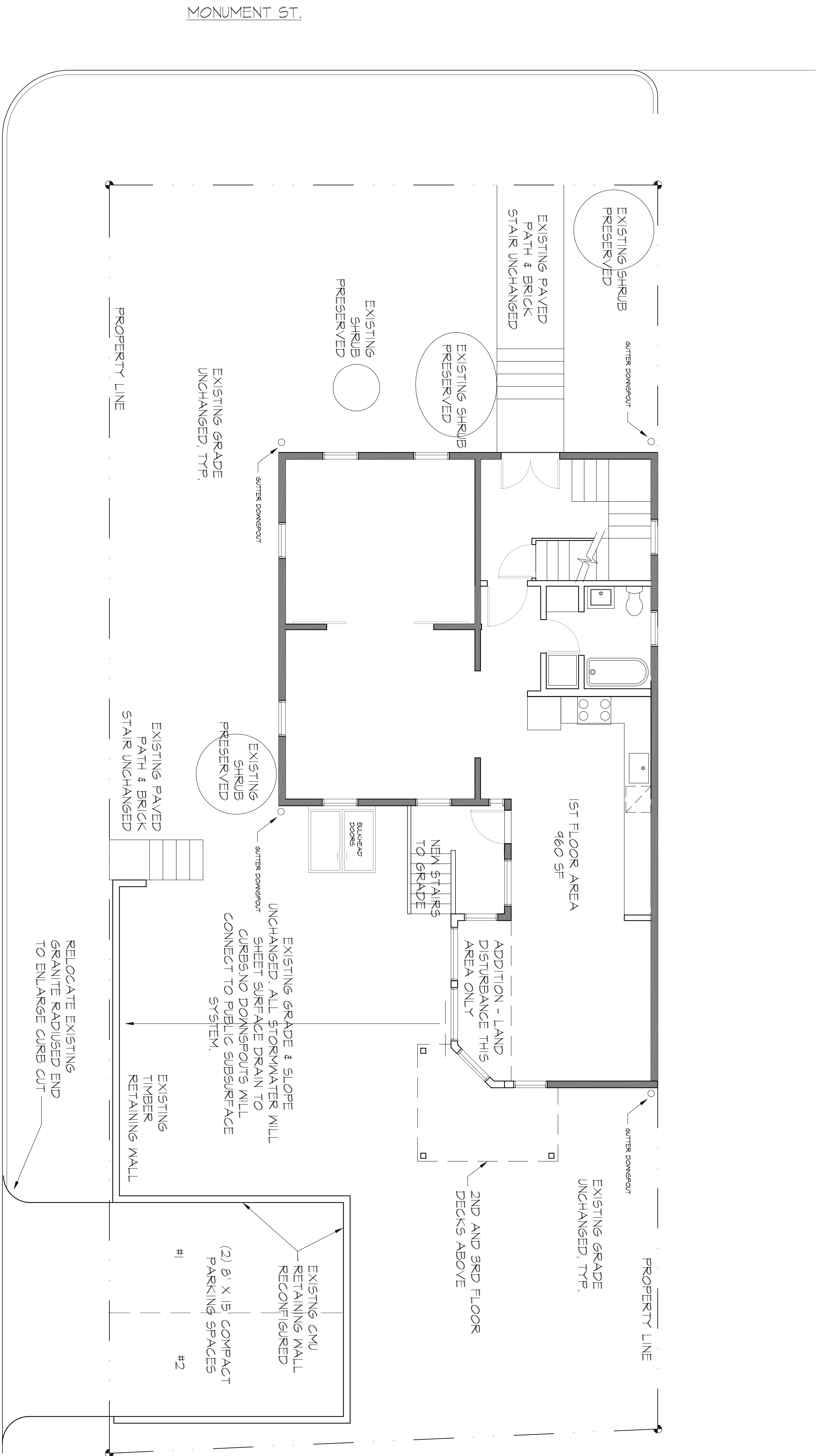

ZONING - B1b

SETBACKS

- FRONT YARD - 10' MAX (14-165.c.1)
- SIDE YARD - 10' MIN (14-165.c.3.d)
- STREET SIDE - 10' MAX (14-165.c.3.c)
- REAR - 20' MIN (14-165.c.3.b)

WATERVILLE ST.

MONUMENT ST.

1 SITE PLAN
SCALE = 1/4" = 1'-0"

