

# DISPLAY THIS CARD ON PRINCIPAL FRONTAGE OF WORK CITY OF PORTLAND

Please Read  
Application And  
Notes, If Any,  
Attached

## BUILDING DEPARTMENT PERMIT

Permit Number: 031245

This is to certify that Reynolds Joseph W /no contractor / self  
has permission to build 3 story 18' x 18' addition  
AT 48 Monument St 016 H002001

provided that the person or persons, firm or corporation accepting this permit shall comply with all of the provisions of the Statutes of Maine and of the Ordinances of the City of Portland regulating the construction, maintenance and use of buildings and structures, and of the application on file in this department.

Apply to Public Works for street line and grade if nature of work requires such information.

Notification of inspection must be given and written permission procured before this building or part thereof is laid or otherwise closed-in. 24 HOUR NOTICE IS REQUIRED.

A certificate of occupancy must be procured by owner before this building or part thereof is occupied.

### OTHER REQUIRED APPROVALS

Fire Dept. \_\_\_\_\_  
Health Dept. \_\_\_\_\_  
Appeal Board \_\_\_\_\_  
Other \_\_\_\_\_  
Department Name

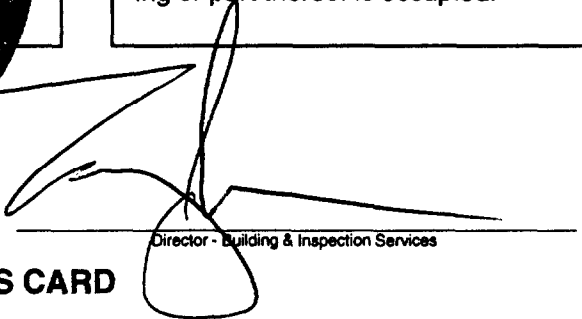
  
Director - Building & Inspection Services

31 MAY 2003

**PENALTY FOR REMOVING THIS CARD**

**City of Portland, Maine - Building or Use Permit Application**  
 389 Congress Street, 04101 Tel: (207) 874-8703, Fax: (207) 874-8716

Permit No: 03-1245	Issue Date: DEC 21 2003	CBL: 016 H002001
-----------------------	----------------------------	---------------------

Location of Construction: 48 Monument St	Owner Name: Reynolds Joseph W	Owner Address: 48 Monument St	Phone:
Business Name:	Contractor Name: no contractor / self	Contractor Address: Portland	Phone:
Lessee/Buyer's Name	Phone:	Permit Type: Alterations - Dwellings	Zone: R-L

Past Use:	Proposed Use: build 3 story 18' x 18' addition	Permit Fee: 336 <del>\$400.00</del>	Cost of Work: 37,000 <del>\$42,000.00</del>	CEO District: 1
Proposed Project Description: build 3 story 18' x 18' addition		FIRE DEPT: <input type="checkbox"/> Approved <input type="checkbox"/> Denied Signature: <i>[Signature]</i>		INSPECTION: Use Group: R Type: SA BOA 99 Signature: <i>[Signature]</i>

PEDESTRIAN ACTIVITIES DISTRICT (P.A.D.)	
Action: <input type="checkbox"/> Approved <input type="checkbox"/> Approved w/Conditions <input type="checkbox"/> Denied	Signature: _____ Date: _____

Permit Taken By: tmm	Date Applied For: 10/15/2003	<b>Zoning Approval</b>	
-------------------------	---------------------------------	------------------------	--

1. This permit application does not preclude the Applicant(s) from meeting applicable State and Federal Rules.  2. Building permits do not include plumbing, septic or electrical work.  3. Building permits are void if work is not started within six (6) months of the date of issuance. False information may invalidate a building permit and stop all work..	Special Zone or Reviews <input type="checkbox"/> Shoreland <input type="checkbox"/> Wetland <input type="checkbox"/> Flood Zone <input type="checkbox"/> Subdivision <input type="checkbox"/> Site Plan Maj <input type="checkbox"/> Minor <input type="checkbox"/> MM <input type="checkbox"/> Date: 12/21/03	Zoning Appeal <input type="checkbox"/> Variance <input type="checkbox"/> Miscellaneous <input type="checkbox"/> Conditional Use <input type="checkbox"/> Interpretation <input type="checkbox"/> Approved <input type="checkbox"/> Denied Date:	Historic Preservation <input checked="" type="checkbox"/> Not in District or Landmark <input type="checkbox"/> Does Not Require Review <input type="checkbox"/> Requires Review <input type="checkbox"/> Approved <input type="checkbox"/> Approved w/Conditions <input type="checkbox"/> Denied Date: 12/21/03
--	---	--	--

**CERTIFICATION**

I hereby certify that I am the owner of record of the named property, or that the proposed work is authorized by the owner of record and that I have been authorized by the owner to make this application as his authorized agent and I agree to conform to all applicable laws of this jurisdiction. In addition, if a permit for work described in the application is issued, I certify that the code official's authorized representative shall have the authority to enter all areas covered by such permit at any reasonable hour to enforce the provision of the code(s) applicable to such permit.

SIGNATURE OF APPLICANT	ADDRESS	DATE	PHONE
------------------------	---------	------	-------

RESPONSIBLE PERSON IN CHARGE OF WORK, TITLE	DATE	PHONE
---	------	-------

# All Purpose Building Permit Application

If you or the property owner owes real estate or personal property taxes or user charges on any property within the City, payment arrangements must be made before permits of any kind are accepted.

Location/Address of Construction: <u>48 Monument Street Portland, ME</u>		
Total Square Footage of Proposed Structure <u>324 (x 4 stories = 1,296)</u>	Square Footage of Lot <u>4,735 (deed)</u>	
Tax Assessor's Chart, Block & Lot Chart# <u>016</u> Block# <u>H</u> Lot# <u>002 (001)</u>	Owner: <u>Joseph W. Reynolds</u>	Telephone: <u>761-1970</u>
Lessee/Buyer's Name (If Applicable) <u>N/A</u>	Applicant name, address & telephone: <u>Joseph W. Reynolds</u> <u>48 Monument Street</u> <u>Portland, ME 04101</u>	Cost Of Work: \$ <u>35,000</u> Fee: \$
Current use: <u>Single family / two family</u>		
If the location is currently vacant, what was prior use: _____		
Approximately how long has it been vacant: _____		
Proposed use: <u>Single family - addition for family room, bedroom &amp; lookout</u>		
Project description: <u>to existing dwelling; also new footing for garage</u>		
Contractor's name, address & telephone: <u>owner</u>		
Who should we contact when the permit is ready: <u>owner</u>		
Mailing address: <u>same</u>		
We will contact you by phone when the permit is ready. You must come in and pick up the permit and review the requirements before starting any work, with a Plan Reviewer. A stop work order will be issued and a \$100.00 fee if any work starts before the permit is picked up.      PHONE: <u>761-1970</u>		

**IF THE REQUIRED INFORMATION IS NOT INCLUDED IN THE SUBMISSIONS THE PERMIT WILL BE AUTOMATICALLY DENIED AT THE DISCRETION OF THE BUILDING/PLANNING DEPARTMENT, WE MAY REQUIRE ADDITIONAL INFORMATION IN ORDER TO APPROVE THIS PERMIT.**

*I hereby certify that I am the Owner of record of the named property, or that the owner of record authorizes the proposed work and that I have been authorized by the owner to make this application as his/her authorized agent. I agree to conform to all applicable laws of this jurisdiction. In addition, if a permit for work described in this application is issued, I certify that the Code Official's authorized representative shall have the authority to enter all areas covered by this permit at any reasonable hour to enforce the provisions of the codes applicable to this permit.*

Signature of applicant: <u>Joseph W Reynolds</u>	Date: <u>10/2/03</u>
--	----------------------

**This is NOT a permit, you may not commence ANY work until the permit is issued.  
If you are in a Historic District you may be subject to additional permitting and fees with the  
Planning Department on the 4<sup>th</sup> floor of City Hall**

# BUILDING PERMIT INSPECTION PROCEDURES

Please call 874-8703 or 874-8693 to schedule your inspections as agreed upon

Permits expire in 6 months, if the project is not started or ceases for 6 months.

The Owner or their designee is required to notify the inspections office for the following inspections and provide adequate notice. Notice must be called in 48-72 hours in advance in order to schedule an inspection:

By initializing at each inspection time, you are agreeing that you understand the inspection procedure and additional fees from a "Stop Work Order" and "Stop Work Order Release" will be incurred if the procedure is not followed as stated below.

N/A **Pre-construction Meeting:** Must be scheduled with your inspection team upon receipt of this permit. Jay Reynolds, Development Review Coordinator at 874-8632 must also be contacted at this time, before any site work begins on any project other than single family additions or alterations.

N/A **Footing/Building Location Inspection:** Prior to pouring concrete

N/A **Re-Bar Schedule Inspection:** Prior to pouring concrete

N/A **Foundation Inspection:** Prior to placing ANY backfill

**Framing/Rough Plumbing/Electrical:** Prior to any insulating or drywalling

**Final/Certificate of Occupancy:** Prior to any occupancy of the structure or use. NOTE: There is a \$75.00 fee per inspection at this point.

Certificate of Occupancy is not required for certain projects. Your inspector can advise you if your project requires a Certificate of Occupancy. All projects DO require a final inspection

       If any of the inspections do not occur, the project cannot go on to the next phase, **REGARDLESS OF THE NOTICE OR CIRCUMSTANCES.**

       **CERIFICATE OF OCCUPANICES MUST BE ISSUED AND PAID FOR, BEFORE THE SPACE MAY BE OCCUPIED**

X [Signature]  
Signature of applicant/designee

12/12/03  
Date

[Signature]  
Signature of Inspections Official

12/12/03  
Date

CBL: 16-H-2 Building Permit #: 03-1245

GA FILE NO. WP 8103

PROPRIETARY

1 HOUR FIRE

**GYPSUM WALLBOARD, GLASS MAT GYPSUM SUBSTRATE, STEEL STUDS**

**EXTERIOR SIDE:** One layer 5/8" proprietary type X glass mat gypsum substrate (sheathing) applied parallel or at right angles to 3 5/8" steel studs 24" o.c. with 1" Type S corrosion resistant screws 8" o.c. at vertical studs and 12" o.c. at perimeter runners. Joints caulked with flexible, non-hardening building sealant or covered with weather exposed cladding or finish system.

**INTERIOR SIDE:** One layer 5/8" proprietary type X glass mat gypsum substrate, glass mat water-resistant gypsum backing board, gypsum wallboard, water-resistant gypsum backing board, or gypsum veneer base applied parallel or at right angles to studs with 1" Type S drywall screws 8" o.c. at studs and 12" o.c. at floor and ceiling runners. (NLB)

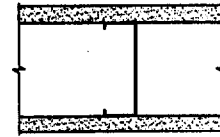

Thickness: 4 7/8"  
Limiting Height: Subject to design  
Approx. Weight: 6 psf  
Fire Test: CTC 2171-3996, 7-12-90

**PROPRIETARY GYPSUM BOARD**

G-P Gypsum - 5/8" Dens-Glass® Gold Fireguard®

GA FILE NO. WP 8104

PROPRIETARY

1 HOUR FIRE

**GYPSUM WALLBOARD, FIBER-CEMENT BOARD, WOOD STUDS**

**EXTERIOR SIDE:** Base layer 1/2" proprietary type X gypsum wallboard or sheathing applied parallel to 2 x 4 wood studs 24" o.c. with 1 3/4" galvanized roofing nails 4" o.c. at vertical joints and top and bottom plates and 7" o.c. at intermediate studs. Face layer 5/16" x 12" wide maximum proprietary fiber-cement plank lap-applied at right angles to studs with 6d corrosion-resistant nails to each stud.

**INTERIOR SIDE:** One layer 5/8" proprietary type X gypsum wallboard applied parallel to studs with 1 7/8" smooth round shank nails, 0.088" shank, 0.275" heads, 7" o.c.

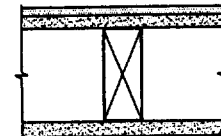

Thickness: 5 1/2"  
Approx. Weight: 6 psf  
Fire Test: OPL 11710-98414, 5-1-95

Joints staggered 24" on opposite sides. (LOAD BEARING)

**PROPRIETARY GYPSUM BOARD**

James Hardie Gypsum - 1/2" Hardirock® Brand Max "C"™ Gypsum Panels  
- 5/8" Hardirock® Brand Fire X™ Gypsum Panels

GA FILE NO. WP 8105

GENERIC

1 HOUR FIRE

**GYPSUM WALLBOARD, GYPSUM SHEATHING, WOOD STUDS**

**EXTERIOR SIDE:** One layer 48" wide 5/8" type X gypsum sheathing applied parallel to 2 x 4 wood studs with 1 3/4" galvanized roofing nails, 0.120" shank, 7/16" or 1/2" heads, 4" o.c. at vertical joints and 7" o.c. at intermediate studs and top and bottom plates. Joints of gypsum sheathing may be left untreated. Exterior cladding to be attached through sheathing to studs.

**INTERIOR SIDE:** One layer 5/8" type X gypsum wallboard, water-resistant gypsum backing board, or gypsum veneer base applied parallel or at right angles to studs with 6d coated nails, 1 7/8" long, 0.0915" shank, 1/4" heads, 7" o.c. (LOAD-BEARING)

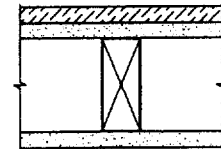

Thickness: Varies  
Approx. Weight: 7 psf  
Fire Test: See WP 3510 (UL R3501-47, -48, 9-17-65, UL Design U309; UL R1319-129, 7-22-70, UL Design U314)



This Space Left Blank