

PERMIT ISSUED

City of Portland, Maine - Building or Use Permit Application
389 Congress Street, 04101 Tel: (207) 874-8703, Fax: (207) 874-8716

Permit No: 03-1251	Issue Date: OCT 15 2003	CBL: 016 G004001
-----------------------	-----------------------------------	---------------------

Location of Construction: 90 St Lawrence St	Owner Name: Cook David O &	Owner Address: 92 St Lawrence St	Phone: 874-1069
Business Name:	Contractor Name: M & M Industries	Contractor Address: 90 Pearl St. #1 So. Portland	Phone: 2073294875
Lessee/Buyer's Name	Phone:	Permit Type: Alterations - Duplex	Zone: R6

Past Use: Two Family	Proposed Use: Two Family w/doghouse dormer/roof top deck	Permit Fee: \$30.00	Cost of Work: \$6,500.00	CEO District: 1
Proposed Project Description: Build 6x8 doghouse dormer & 10x10 rooftop deck		FIRE DEPT: <input type="checkbox"/> Approved <input type="checkbox"/> Denied	INSPECTION: Use Group: R3 Type: 5B SOLA 1999	
		Signature: <i>JMB</i> 10/15/03		Signature: <i>JMB</i> 10/15/03
PEDESTRIAN ACTIVITIES DISTRICT (P.A.D.)				
Action: <input type="checkbox"/> Approved <input type="checkbox"/> Approved w/Conditions <input type="checkbox"/> Denied				
Signature: _____ Date: _____				

Permit Taken By: jmb	Date Applied For: 10/15/2003	Zoning Approval	
-------------------------	---------------------------------	------------------------	--

1. This permit application does not preclude the Applicant(s) from meeting applicable State and Federal Rules. 2. Building permits do not include plumbing, septic or electrical work. 3. Building permits are void if work is not started within six (6) months of the date of issuance. False information may invalidate a building permit and stop all work..	Special Zone or Reviews <input type="checkbox"/> Shoreland <input type="checkbox"/> Wetland <input type="checkbox"/> Flood Zone <input type="checkbox"/> Subdivision <input type="checkbox"/> Site Plan Maj <input type="checkbox"/> Minor <input type="checkbox"/> MM <input type="checkbox"/> Date: <i>10/15/03</i> <i>JMB</i>	Zoning Appeal <input type="checkbox"/> Variance <input type="checkbox"/> Miscellaneous <input type="checkbox"/> Conditional Use <input type="checkbox"/> Interpretation <input type="checkbox"/> Approved <input type="checkbox"/> Denied Date: _____	Historic Preservation <input checked="" type="checkbox"/> Not in District or Landmark <input type="checkbox"/> Does Not Require Review <input type="checkbox"/> Requires Review <input type="checkbox"/> Approved <input type="checkbox"/> Approved w/Conditions <input type="checkbox"/> Denied Date: <i>JMB</i>
	<i>Approved w/conditions</i> <i>Sec. 14-43b</i> <i>50% expansion</i>		

CERTIFICATION

I hereby certify that I am the owner of record of the named property, or that the proposed work is authorized by the owner of record and that I have been authorized by the owner to make this application as his authorized agent and I agree to conform to all applicable laws of this jurisdiction. In addition, if a permit for work described in the application is issued, I certify that the code official's authorized representative shall have the authority to enter all areas covered by such permit at any reasonable hour to enforce the provision of the code(s) applicable to such permit.

SIGNATURE OF APPLICANT	ADDRESS	DATE	PHONE
------------------------	---------	------	-------

RESPONSIBLE PERSON IN CHARGE OF WORK, TITLE	DATE	PHONE
---	------	-------

Location of Construction: 90 St Lawrence St	Owner Name: Cook David O &	Owner Address: 92 St Lawrence St	Phone: () 874-1069
Business Name:	Contractor Name: M & M Industries	Contractor Address: 90 Pearl St. #1 So. Portland	Phone: (207) 329-4875
Lessee/Buyer's Name	Phone:	Permit Type: Alterations - Duplex	

Proposed Use: Two Family w/doghouse dormer/roof top deck	Proposed Project Description: Build 6x8 doghouse dormer & 10x10 rooftop deck
--	--

Dept: Zoning **Status:** Approved **Reviewer:** Jeanine Bourke **Approval Date:** 10/15/2003

Note: **Ok to Issue:**

- 1) This property shall remain a two family dwelling. Any change of use shall require a separate permit application for review and approval.
- 2) This approval considers Sec. 14-436 for 50% expansion of the 1st floor footprint. A combination of this permit and permit #02-0796 shows an expansion of 350 SF which is less than 33% of the 1350 SF first floor.
- 3) This structure is limited to a maximum height of 45' from grade

Dept: Building **Status:** Approved **Reviewer:** Jeanine Bourke **Approval Date:** 10/15/2003

Note: **Ok to Issue:**

- 1) Specs on the spiral stairway must be submitted to this office
- 2) Application approval based upon information provided by applicant. Any deviation from approved plans requires separate review and approval prior to work.

All Purpose Building Permit Application

If you or the property owner owes real estate or personal property taxes or user charges on any property within the City, payment arrangements must be made before permits of any kind are accepted.

Location/Address of Construction: <u>90-92 ST. LAWRENCE STREET</u>		
Total Square Footage of Proposed Structure <u>184 SQ. FT.</u>	Square Footage of Lot <u>2,546 SQ. FT.</u>	
Tax Assessor's Chart, Block & Lot Chart# <u>10</u> Block# <u>G</u> Lot# <u>3</u>	Owner: <u>DAVID COOK</u> <u>JOSEPH MORGAN</u> <u>123 LAWRENCE STREET</u> <u>PORTLAND, ME 04101</u>	Telephone: <u>874-0419</u>
Lessee/Buyer's Name (If Applicable)	Applicant name, address & telephone: <u>MSM INDUSTRIES</u> <u>33 CHADW ST #1</u> <u>SOUTH PORTLAND ME 04106</u>	Cost Of Work: <u>\$65,000⁰⁰-</u> Fee: \$ <u>84.00</u>
Current use: <u>2 FAMILY</u>		
If the location is currently vacant, what was prior use: _____		
Approximately how long has it been vacant: _____		
Proposed use: <u>DECK SPACE</u>		
Project description: <u>ADD DOGHOUSE & DECK ON 4TH FLOOR</u>		
Contractor's name, address & telephone: <u>SAME AS ABOVE</u>		
Who should we contact when the permit is ready: _____		
Mailing address: _____		
We will contact you by phone when the permit is ready. You must come in and pick up the permit and review the requirements before starting any work, with a Plan Reviewer. A stop work order will be issued and a \$100.00 fee if any work starts before the permit is picked up. PHONE: _____		

IF THE REQUIRED INFORMATION IS NOT INCLUDED IN THE SUBMISSIONS THE PERMIT WILL BE AUTOMATICALLY DENIED AT THE DISCRETION OF THE BUILDING/PLANNING DEPARTMENT, WE MAY REQUIRE ADDITIONAL INFORMATION IN ORDER TO APPROVE THIS PERMIT.

I hereby certify that I am the Owner of record of the named property, or that the owner of record authorizes the proposed work and that I have been authorized by the owner to make this application as his/her authorized agent. I agree to conform to all applicable laws of this jurisdiction. In addition, if a permit for work described in this application is issued, I certify that the Code Official's authorized representative shall have the authority to enter all areas covered by this permit at any reasonable hour to enforce the provisions of the codes applicable to this permit.

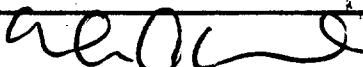
Signature of applicant: 	Date: <u>10/15/03</u>
---	-----------------------

**This is NOT a permit, you may not commence ANY work until the permit is issued.
If you are in a Historic District you may be subject to additional permitting and fees with the
Planning Department on the 4th floor of City Hall**

This page contains a detailed description of the Parcel ID you selected. Press the **New Search** button at the bottom of the screen to submit a new query.

19/15
2PM
mark

Current Owner Information

Card Number 1 of 1
Parcel ID 016 0004001
Location 90 ST LAWRENCE ST
Land Use TWO FAMILY

Owner Address COOK DAVID O & JOSEPH H MORGAN
 92 ST LAWRENCE ST
 PORTLAND ME 04101

Book/Page 13256/270
Legal 16-6-4
 ST LAWRENCE ST 90
 2546 SF *MIN 4500*

R6

Valuation Information

Land	Building	Total
\$31,290	\$118,970	\$150,260

Property Information

Year Built 1850	Style Old Style	Story Height 2	Sq. Ft. 3460	Total Acres 0.058		
Bedrooms 4	Full Baths 2	Half Baths 1	Total Rooms 11	Attic Full Fin./wh	Basement Full	

Outbuildings

Type	Quantity	Year Built	Size	Grade	Condition
-------------	-----------------	-------------------	-------------	--------------	------------------

Sales Information

Date	Type	Price	Book/Page
08/01/1997	LAND + BLDING	\$32,000	13256-270
05/01/1996	LAND + BLDING	\$72,000	12511-251

Picture and Sketch

Picture Sketch

[Click here to view Tax Roll Information.](#)

Any information concerning tax payments should be directed to the Treasury office at 874-8490 or e-mailed.



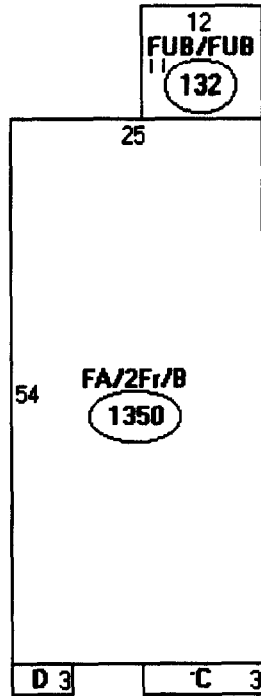

Descriptor/Area

A: FA/2Fr/B
1350 sqft

B: FUB/FUB
132 sqft

C: OFF
36 sqft

D: FBAY/B
18 sqft



DISPLAY THIS CARD ON PRINCIPAL FRONTAGE OF WORK CITY OF PORTLAND

Please Read Application And Notes, If Any, Attached

BUILDING INSPECTION

PERMIT ISSUED

Permit Number: 031251

OCT 15 2003

This is to certify that Cook David O &/M & M Industries
has permission to Build 6x8 doghouse dormer 10x10 roof over
AT 90 St Lawrence St 016 G004001

CITY OF PORTLAND

provided that the person or persons, firm or corporation accepting this permit shall comply with all of the provisions of the Statutes of Maine and of the Ordinances of the City of Portland regulating the construction, maintenance and use of buildings and structures, and of the application on file in this department.

Apply to Public Works for street line and grade if nature of work requires such information.

Notification of inspection must be given and work on permit must be completed before this building or part thereof is leased or occupied. **HOURLY NOTICES REQUIRED.**

A certificate of occupancy must be procured by owner before this building or part thereof is occupied.

OTHER REQUIRED APPROVALS

Fire Dept. _____
Health Dept. _____
Appeal Board _____
Other _____
Department Name _____

David Bank 10/15/03
Director - Building & Inspection Services

PENALTY FOR REMOVING THIS CARD

