

PERMIT ISSUED

City of Portland, Maine - Building or Use Permit Application

389 Congress Street, 04101 Tel: (207) 874-8703, Fax: (207) 874-8716

Permit No: 03-0581	Issue Date: MAY 29 2003	CBL: 016 E006001
-----------------------	-----------------------------------	---------------------

Location of Construction: 58 Atlantic St	Owner Name: Paolino Grace	Owner Address: 58 Atlantic St CITY OF PORTLAND	Phone: 207-773-2430
Business Name:	Contractor Name: Sheds, U.S.A.	Contractor Address: P.O.Box 6622 Porthsmouth	Phone: 6038681300
Lessee/Buyer's Name	Phone:	Permit Type: Sheds	Zone: R-6

Past Use: single family	Proposed Use: single family - add 8' x 12' shed	Permit Fee: \$37.00	Cost of Work: \$1,599.00	CEO District: 1	4000 SF
		FIRE DEPT: <input type="checkbox"/> Approved <input checked="" type="checkbox"/> Denied <i>N/A</i>	INSPECTION: Use Group: U Type: SB BOCA 99		

Proposed Project Description: add 8' x 12' shed	Signature: <i>[Signature]</i>	Signature: <i>[Signature]</i>
PEDESTRIAN ACTIVITIES DISTRICT (P.A.D.)		
Action: <input type="checkbox"/> Approved <input type="checkbox"/> Approved w/Conditions <input type="checkbox"/> Denied		
Signature:	Date:	

Permit Taken By: gg	Date Applied For: 05/29/2003	Zoning Approval
-------------------------------	--	------------------------

<ol style="list-style-type: none"> This permit application does not preclude the Applicant(s) from meeting applicable State and Federal Rules. Building permits do not include plumbing, septic or electrical work. Building permits are void if work is not started within six (6) months of the date of issuance. False information may invalidate a building permit and stop all work.. 	Special Zone or Reviews <input type="checkbox"/> Shoreland <input type="checkbox"/> Wetland <input type="checkbox"/> Flood Zone <input type="checkbox"/> S... <input type="checkbox"/> Site Plan Maj <input type="checkbox"/> Minor <input type="checkbox"/> MM <input type="checkbox"/> Date: 5/29/03	Zoning Appeal <input type="checkbox"/> Variance <input type="checkbox"/> Miscellaneous <input type="checkbox"/> Conditional Use <input type="checkbox"/> Interpretation <input type="checkbox"/> Approved <input type="checkbox"/> Denied Date:	Historic Preservation <input checked="" type="checkbox"/> Not in District or Landmark <input type="checkbox"/> Does Not Require Review <input type="checkbox"/> Requires Review <input type="checkbox"/> Approved <input type="checkbox"/> Approved w/Conditions <input type="checkbox"/> Denied Date: 5/29/03
	OK		

CERTIFICATION

I hereby certify that I am the owner of record of the named property, or that the proposed work is authorized by the owner of record and that I have been authorized by the owner to make this application as his authorized agent and I agree to conform to all applicable laws of this jurisdiction. In addition, if a permit for work described in the application is issued, I certify that the code official's authorized representative shall have the authority to enter all areas covered by such permit at any reasonable hour to enforce the provision of the code(s) applicable to such permit.

SIGNATURE OF APPLICANT ADDRESS DATE PHONE

RESPONSIBLE PERSON IN CHARGE OF WORK, TITLE DATE PHONE

BUILDING PERMIT INSPECTION PROCEDURES

Please call 874-8703 or 874-8693 to schedule your inspections as agreed upon

Permits expire in 6 months, if the project is not started or ceases for 6 months.

The Owner or their designee is required to notify the inspections office for the following inspections and provide adequate notice. Notice must be called in 48-72 hours in advance in order to schedule an inspection:

By initializing at each inspection time, you are agreeing that you understand the inspection procedure and additional fees from a "Stop Work Order" and "Stop Work Order Release" will be incurred if the procedure is not followed as stated below.

_____ **Pre-construction Meeting:** Must be scheduled with your inspection team upon receipt of this permit. Jay Reynolds, Development Review Coordinator at 874-8632 must also be contacted at this time, before any site work begins on any project other than single family additions or alterations.

- Footing/Building Location Inspection:** Prior to pouring concrete
- _____ **Re-Bar Schedule Inspection:** Prior to pouring concrete
- _____ **Foundation Inspection:** Prior to placing ANY backfill
- Framing/Rough Plumbing/Electrical:** Prior to any insulating or drywalling
- Final/Certificate of Occupancy:** Prior to any occupancy of the structure or use. NOTE: There is a \$75.00 fee per inspection at this point.

Certificate of Occupancy is not required for certain projects. Your inspector can advise you if your project requires a Certificate of Occupancy. All projects DO require a final inspection

_____ **If any of the inspections do not occur, the project cannot go on to the next phase, REGARDLESS OF THE NOTICE OR CIRCUMSTANCES.**

_____ **CERIFICATE OF OCCUPANICES MUST BE ISSUED AND PAID FOR, BEFORE THE SPACE MAY BE OCCPIED**

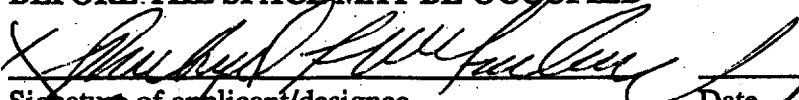

Signature of applicant/designee Date 5/29/03



Signature of Inspections Official Date

CBL: 16-E-6 Building Permit #: 03-0581

DISPLAY THIS CARD ON PRINCIPAL FRONTAGE OF WORK CITY OF PORTLAND

Please Read Application And Notes, If Any, Attached

BUILDING INSPECTION

PERMIT

Permit Number: 030581

This is to certify that Paolino Grace /Sheds, U.S.A

has permission to add 8' x 12' shed

AT 58 Atlantic St 016 E006001

provided that the person or persons, firm or corporation accepting this permit shall comply with all of the provisions of the Statutes of Maine and of the ordinances of the City of Portland regulating the construction, maintenance and use of buildings and structures, and of the application on file in this department.

Apply to Public Works for street line and grade if nature of work requires such information.

Notification of inspection must be given and work on permit must be completed before this building or part thereof is leased or occupied. **HEAVY NOTICE IS REQUIRED.**

A certificate of occupancy must be procured by owner before this building or part thereof is occupied.

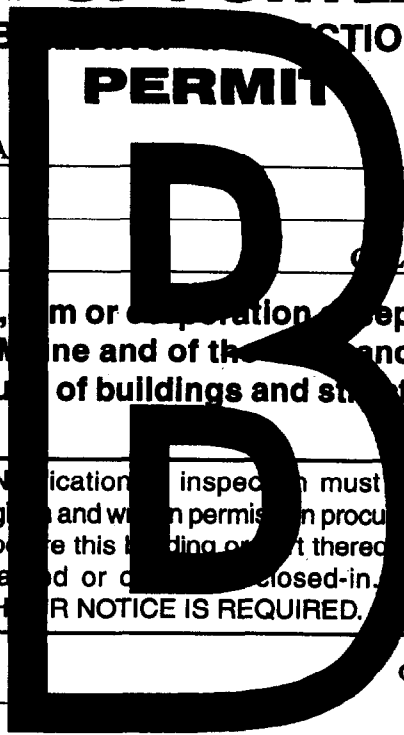

[Handwritten Signature]
Director - Building & Inspection Services

OTHER REQUIRED APPROVALS
Fire Dept. PERMIT ISSUED
Health Dept. _____
Appeal Board _____
Other MAY 29 2003
Department Name

CITY OF PORTLAND

PENALTY FOR REMOVING THIS CARD

03-581

All Purpose Building Permit Application

If you or the property owner owes real estate or personal property taxes or user charges on any property within the City, payment arrangements must be made before permits of any kind are accepted.

Location/Address of Construction: <u>58 ATLANTIC ST. PORTLAND, ME 04101</u>		
Total Square Footage of Proposed Structure <u>8'x12' = (96 SF)</u>	Square Footage of Lot	
Tax Assessor's Chart, Block & Lot Chart# <u>16</u> Block# <u>E</u> Lot# <u>6</u>	Owner: <u>GRACE S. PAOLINO</u>	Telephone: <u>(207)-773-2430</u>
Lessee/Buyer's Name (if Applicable)	Applicant name, address & telephone: <u>RICHARD L. MCFARLAND 58 ATLANTIC</u>	Cost Of Work: <u>\$ 1,599.00</u> Fee: <u>\$ 57.00</u>
Current use: <u>Residential</u>		
If the location is currently vacant, what was prior use: _____		
Approximately how long has it been vacant: _____		
Proposed use: <u>STORAGE - YARD TOOLS & ACCESSORIES</u> Project description: <u>8'x12' WOOD FRAMED STORAGE SHED.</u>		
Contractor's name, address & telephone: <u>HOME DEPOT. / Sheds USA</u>		
Who should we contact when the permit is ready: <u>GRACE S. PAOLINO</u> Mailing address: <u>58 ATLANTIC ST PORTLAND, MAINE 773-2430</u>		
We will contact you by phone when the permit is ready. You must come in and pick up the permit and review the requirements before starting any work, with a Plan Reviewer. A stop work order will be issued and a \$100.00 fee if any work starts before the permit is picked up. PHONE:		

IF THE REQUIRED INFORMATION IS NOT INCLUDED IN THE SUBMISSIONS THE PERMIT WILL BE AUTOMATICALLY DENIED AT THE DISCRETION OF THE BUILDING/PLANNING DEPARTMENT, WE MAY REQUIRE ADDITIONAL INFORMATION IN ORDER TO APPROVE THIS PERMIT.

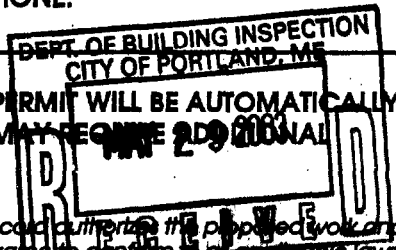

I hereby certify that I am the Owner of record of the named property, or that the owner of record has authorized the proposed work and that I have been authorized by the owner to make this application as his/her authorized agent. I agree to conform to all applicable laws of this jurisdiction. In addition, if a permit for work described in this application is issued, I certify that the Code Official's authorized representative shall have the authority to enter all areas covered by this permit at any reasonable hour to enforce the provisions of the codes applicable to this permit.

Signature of applicant: <u>[Signature]</u>	Date: <u>05/29/03</u>
--	-----------------------

This is NOT a permit, you may not commence ANY work until the permit is issued. If you are in a Historic District you may be subject to additional permitting and fees with the Planning Department on the 4th floor of City Hall



AT-HOME SERVICES
SM

THE BOSTONIAN

\$38/mo*

Vinyl Colors

white

cream

Available in year-round colors:

SMART PANEL II

PINE

CEDAR*

VINYL*

ROOF STYLES

SHINGLE COLORS

SIZES

Size	SMART PANEL II	PINE	CEDAR*	VINYL*
8x14		\$1,879 OR ONLY \$48/mo*		\$2,299 OR ONLY \$63/mo*
10x12		\$1,999 OR ONLY \$50/mo*		\$2,399 OR ONLY \$63/mo*
BEST BUY 10x14	\$2,199 OR ONLY \$57/mo*	\$2,299 OR ONLY \$63/mo*	\$2,499 OR ONLY \$63/mo*	\$2,789 OR ONLY \$75/mo*
BEST BUY 10x16	\$2,399 OR ONLY \$63/mo*	\$2,499 OR ONLY \$63/mo*	\$2,849 OR ONLY \$75/mo*	\$2,999 OR ONLY \$75/mo*
12x14		\$2,599 OR ONLY \$69/mo*		\$3,099 OR ONLY \$82/mo*
BEST BUY 12x16	\$2,679 OR ONLY \$69/mo*	\$2,779 OR ONLY \$75/mo*	\$3,299 OR ONLY \$88/mo*	\$3,399 OR ONLY \$88/mo*
BEST BUY 12x20	\$3,399 OR ONLY \$88/mo*	\$3,499 OR ONLY \$88/mo*	\$3,899 OR ONLY \$100/mo*	\$4,099 OR ONLY \$100/mo*

DELIVERED

BUILT ON SITE,

**NO PAYMENTS
NO INTEREST
for 6 months***



For more details, visit Sheds.com or call 1-800-451-1000. *See store for details. ©2014 Home Depot. #666666

***Key Credit Terms: 6-Month Credit Offer:** Payments are not required for 6 months on any approved purchase of \$299 or more charged to your Home Depot® Consumer Credit Card account. Offer subject to credit approval. Valid at all U.S. Home Depot® stores. Ask an Associate for details. **Minimum Monthly Payments:** The payments shown are an estimate of your required minimum monthly payments, and assume that you have no existing balance, make no additional purchases, that you pay the minimum payment by the payment due date each month, and that you do not incur any additional fees. Actual minimum monthly payments may vary. These payments apply only to the Home Depot Consumer Card.

Options & Upgrades for All Sheds

Note: Options and upgrades are an additional cost to the standard pricing.

	INCLUDED
PT floor joist	
4 x 4 PT Runners" (8x12, 10x12, 12x12)	\$35.00
4 x 4 PT Runners" (8x14, 8x16, 10x14, 10x16, 12x14, 12x16, 12x20)	\$59.00
2" x 6" PT floor joists upgrade for 6' or 8' wide sheds (10' & 12' sheds come standard with this option)	\$92 sq ft
PT 5/8" plywood floor	\$1.20 sq ft
4' storage loft for 8' wide sheds	\$65.00
4' storage loft for 10' wide sheds	\$80.00
4' storage loft for 12' wide sheds	\$95.00
<i>(Loft storage space will vary with roof style, loft for 6' wide sheds is not available)</i>	
Shelf	\$45.00
Enlarge Standard 40" Door to 54" Door	\$60.00
Enlarge Standard 40" Door to 66" Door	\$90.00
Enlarge Standard 40" Door to 78" Door	\$120.00
Ramp (pressure-treated)	\$50.00
VINYL SHED ONLY - functional window upgrade (each)	\$49.00
<i>(standard vinyl shed window does not open—optional "functional window upgrade" window does open)</i>	
Window screen (each)	\$15.00
Anchor Kit" (hurricane clips & anchors)	\$120.00

Note: 54" double doors not available on any 6' wide or 8x8 New Yorker. 66" & 78" double door not available on any New Yorker or any of the following Bostonian sizes - 8x12, 10x12 or 12x12 due to space restrictions.

Product Warranty

Sheds USA warrants the structural soundness of all its sheds for a period of 10 years from the date of delivery with proper maintenance. A detailed warranty and registration will be sent by mail to all new customers.

Please note: Some town/county building codes may require customers to purchase an "Anchor kit and/or 4x4 PT Runners" in order to meet town/county specific requirements/codes. Although Sheds USA builds one of the highest quality shed products available, some towns have very stringent building codes and Sheds USA cannot guarantee that all of our sheds will meet these codes. Any additional cost necessary to meet code requirements will be the customer's responsibility.

Cedar sheds may be built with Cedar or Cypress depending on availability. Cypress and Cedar have very similar appearances & characteristics, all bulleted items under the Cedar header apply to both wood types. Sheds USA reserves the right to substitute materials with the understanding that any substitutions will be of comparable quality and appearance to that being specified.

VINYL	CEDAR	PINE	SMART PANEL II
<ul style="list-style-type: none"> • 100% maintenance free • Variety of colors available • Beautiful • Long-term durability • Preferred choice 		<ul style="list-style-type: none"> • Most popular material • Withstands all types of weather • Classic tongue-and-groove construction • Affordably priced 	

SKU #471-897 (SKU represents Sheds USA's Bostonian, Portsmouth and New Yorker sheds only)

THE BOSTONIAN

Shed Siding Material

Shed Size

Roof Style

Roof Shingle Color

Options & Upgrades

Site Requirements

- **Clearance** around the shed site must be at least 3' from any fences, trees, etc. Please remove tree branches, brush or other obstacles 3' around perimeter of shed and 12' above ground.
- **Land grade** must be less than a 6" slope from the highest to lowest point, with no protruding rocks or stumps in the area.
- **Access** to the site must be clear; sheds are delivered in prefab panels—stairs, narrow walkways, fences, gates, shrubs, carports, awnings, arbors, etc. may present difficulties and should be brought to Sheds USA's attention prior to delivery.
- **Land quality** is important. When choosing your site, consider all factors including: proper drainage, firmness of earth, etc.
- **Permits** are the responsibility of the homeowner. Please contact your local town office prior to purchasing/ordering your shed to determine town/county restrictions, if any.
- **Shed site** must be 150' or less from where large tractor trailer can park. Sheds sites located further than 150' from truck parking area will incur a minimum \$50.00 fee payable to Sheds USA at time of scheduling. Please inform/contact our office if this applies to your site (toll free 866.616.2685).

If any of the SITE REQUIREMENTS are not fulfilled, your shed may not be built and a fee of \$150.00 will be charged for our crews to return and construct your shed once conditions are met. If this occurs, delivery of your shed materials must be accepted and placed on your property in a location accessible to the final shed site to avoid a \$300 re-delivery fee. It is the customer's responsibility to cover the materials with a non-transparent, waterproof material to prevent any unnecessary weathering and/or discoloration. All fees are assessed by Sheds USA at time of notification.

Delivery

- **Sheds USA** will acknowledge the receipt of your order by phone or by mail. Please provide a daytime phone number at time of purchase.
- **Delivery schedule** will be established by Sheds USA. You will be contacted by phone 1 to 2 weeks in advance.
- **Delivery time** will fluctuate based on seasonal volume, weather conditions and other uncontrollable events. Please note our crews deliver/install multiple sheds per day; therefore the status of one order may effect many others. We ask our customers to be understanding if an unforeseen event affects their delivery/installation date.
- **Delivery date** and installation date may differ.
- **Site requirements** must be fulfilled prior to scheduling (please refer to the "Site Requirements" section to ensure understanding).
- **Cancellation** of any product already in production or manufactured will incur a 20% cancellation fee. Please contact us immediately if your order needs to be cancelled.

For more detailed information, visit www.ShedsUSA.com/homedepot

Standard Features & Materials

- 7/16" OSB
- 2" x 4" construction, 24" on center
- Self-sealing shingles with 25 year warranty - available in black, brown or white/gray

	Peak	Ext. Peak	Gambrel
8' wide	8' 3"	8' 6"	9' 0"
12' wide	9' 6"	9' 9"	9' 10"

- 2"x4" construction, 24" on center
- Smart Panel II: pre-primed surface (vertical)
(all trim boards come unfinished and will require painting or staining)
- Pine: 6" tongue & groove (horizontal)
- Cedar: 6" or 8" tongue & groove (horizontal)
- Wall height = 71"; Extended front gable, front wall = 75"
- Maintenance free vinyl siding applied over 1/2" plywood

- 5/8" OSB tongue and groove
- Pressure treated floor joists standard
- *Optional* pressure treated 5/8" plywood available
- 2" x 4" construction, 16" on center for 6' & 8' wide units
- *Optional* 2" x 6" floor joists available for 6' & 8' wide units
- 2" x 6" construction, 16" on center for 10' & 12' wide units
- Concrete block supports—4 corners, front & back center of outside frame
- *Optional* 4" x 4" PT Runners
- Pressure treated 4x4 center beam on all 12' wide sheds

If preparing your own foundation/footing, please call Sheds USA for the exact outside floor dimensions — 866.616.2685

- All windows come with flower boxes and shutters
- Wooden sheds come standard with functional windows
- Vinyl sheds come standard with non-functional windows
(functional windows available as an option)

- 40" double door standard
(6x6 sheds come with 26" single door standard)
- *Optional* 54", 66" & 78" doors size available

Note: All shed dimensions are approximate - door & window locations cannot be changed.

ATLANTIC ST.

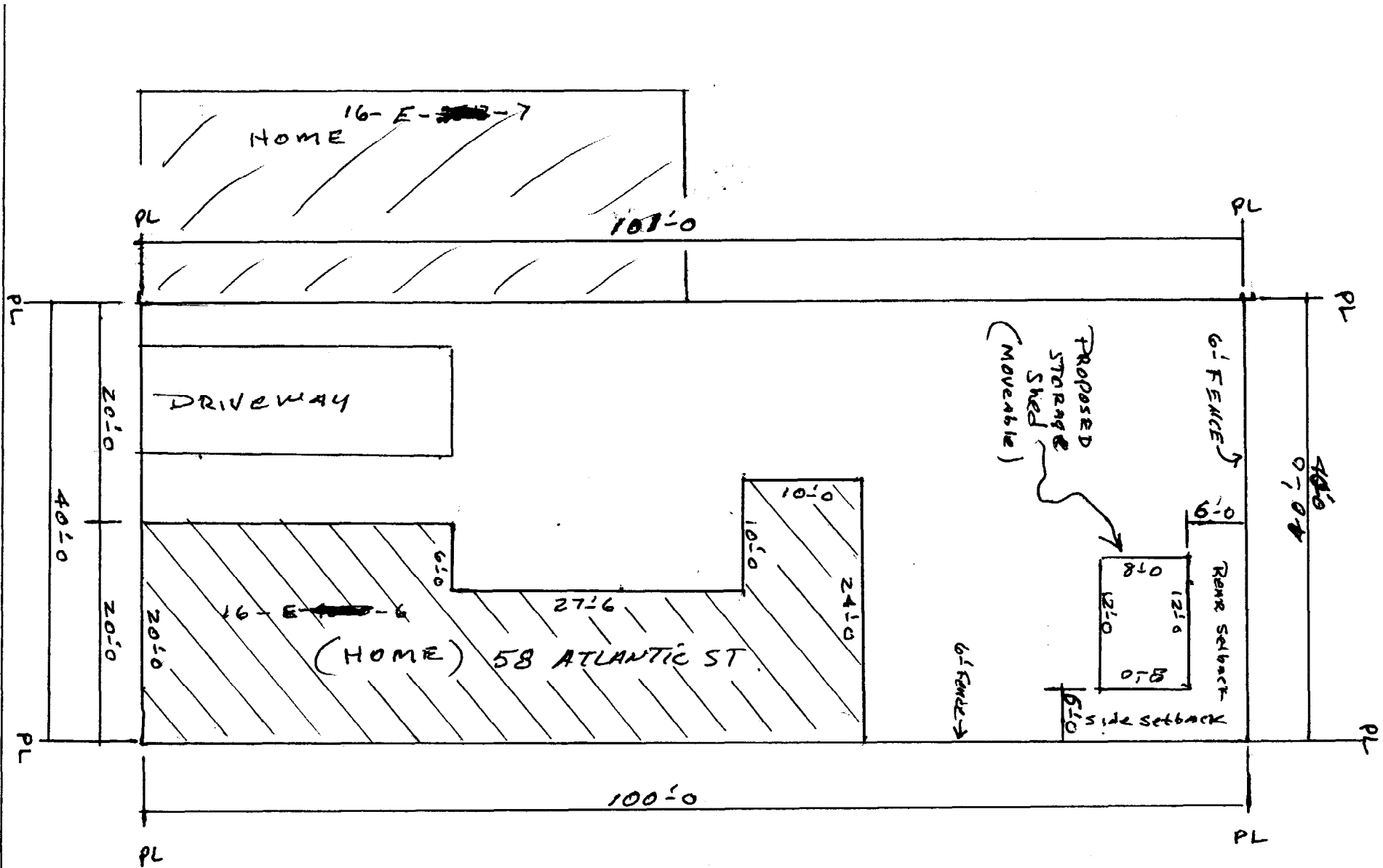

SITE PLAN

PROPERTY: LOCATED AT 58 ATLANTIC ST, PORTLAND, MAINE
ASSESSORS MAP # 16 - SECTION/BLOCK E - LOT # 6
- PROPOSED STORAGE SHED. - DATE: 5-29-03

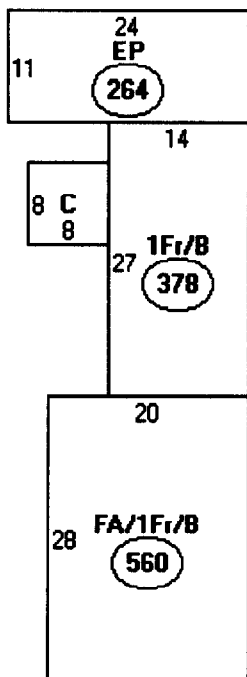

Descriptor/Area

A: FA/1Fr/B
560 sqft

B: 1Fr/B
378 sqft

C: WD
64 sqft

D: EP
264 sqft

96 shed
1362 SF - OK
4000 SF

Lot cov. -
50% -
2000 SF.