

**SITE AND UTILITY PLAN**

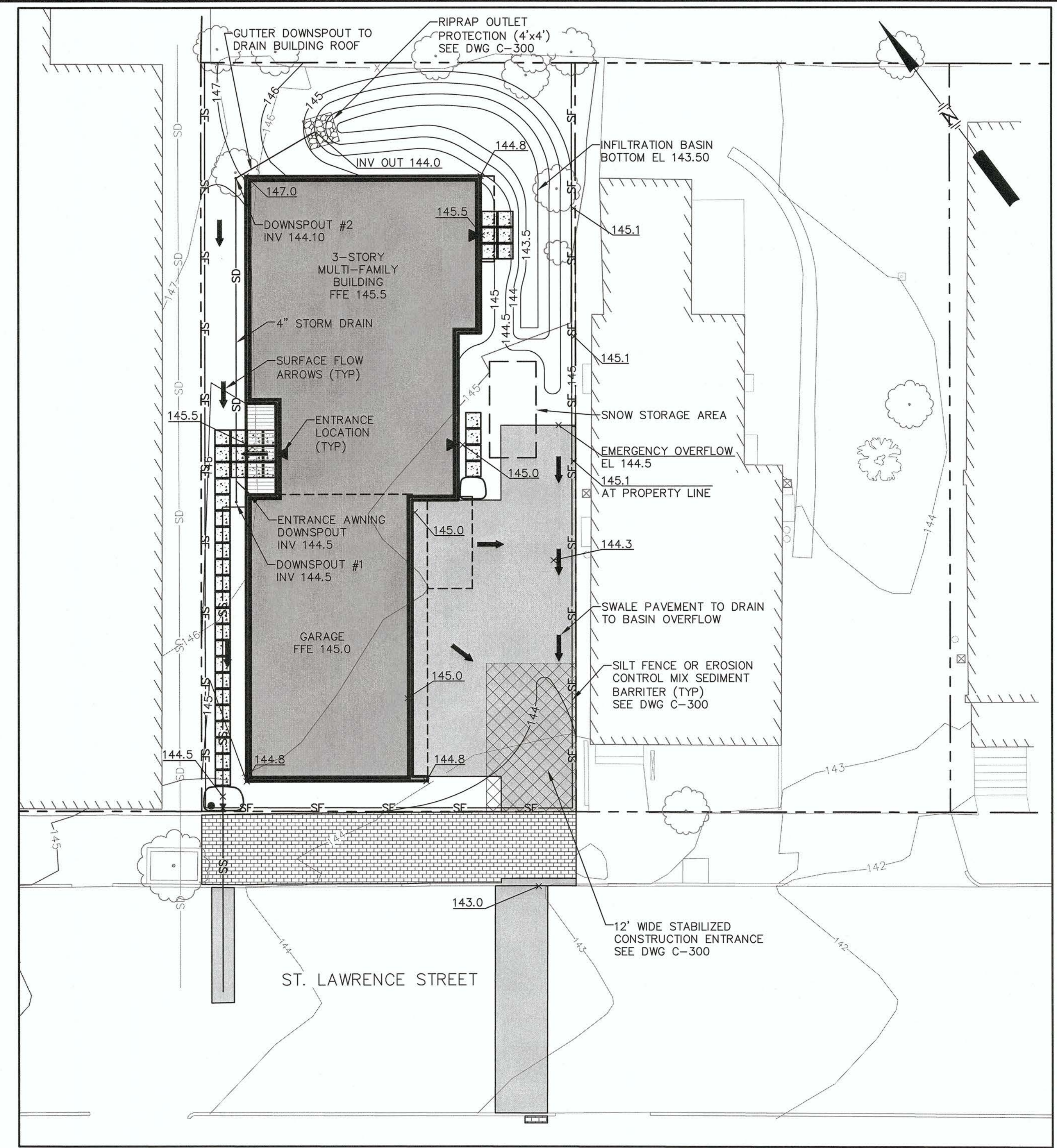

**GRADING AND EROSION CONTROL PLAN**

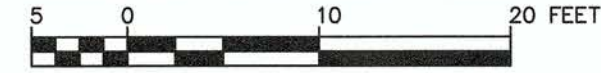

**NOTES:**

1. BASE MAP ADAPTED FROM PLAN ENTITLED "BOUNDARY & TOPOGRAPHIC SURVEY" BY OWEN HASKELL, INC., FALMOUTH, MAINE, DATED JUNE 11, 2014 AND PLAN ENTITLED "GRADING AND UTILITIES PLAN" BY PINKHAM & GREER CONSULTING ENGINEERS, DATED FEBRUARY 26, 2014.

**4 UNIT APARTMENT BUILDING**  
**93 ST. LAWRENCE STREET**  
**LARRY GROSS AND BARBARA COLBY**  
**PORTLAND, MAINE**

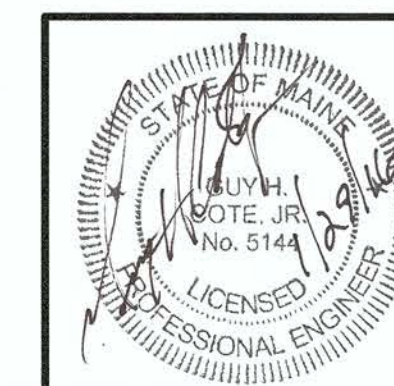

**SITE PLAN**

**SME**

Sevee & Maher Engineers, Inc.

ENVIRONMENTAL • CIVIL • GEOTECHNICAL • WATER • COMPLIANCE  
 4 Blanchard Road, PO Box 85A, Cumberland Center, Maine 04021  
 Phone 207.829.5016 • Fax 207.829.5692 • www.smemaine.com

DESIGN BY: DPD  
 DRAWN BY: JRL  
 DATE: 4/27/2015  
 CHECKED BY: [Signature]  
 LMN: SITE/GRADING  
 CTB: SME-STD

JOB NO. 15086.00 DWG FILE BASE

C-101

REV.	BY	DATE	STATUS
DPD	1/16		ISSUED FOR CONSTRUCTION
DPD	11/15		BID DOCUMENT
DPD	10/15		ISSUED FOR BID
DPD	9/15		REVISED PER CITY OF PORTLAND COMMENTS
DPD	7/15		SUBMITTED TO CITY OF PORTLAND FOR SITE PLAN REVIEW