

**BENNETT  
ENGINEERING**  
MECHANICAL  
207.865.9405

Owner/Applicant

**Barbara Colby and  
Laurence Gross**  
PO Box 10152  
Portland Maine, 04104

Structural Engineering  
Structural Integrity  
Address

Mechanical and Electrical Engineering  
**Bennett Engineering**  
PO Box 297, Presport, ME 04032

Architect:

**ARCHETYPE**  
Architects  
48 Union Wharf Portland, Maine 04101  
(207) 772-6022 Fax (207) 772-4056

Project:

**4 Unit Apartment Building**  
93 St. Lawrence Street  
Portland Maine, 04101

CBL: 016 D010001 B&P 17303/310

ISSUED FOR CONSTRUCTION

Date:  
4 March 2016

Scale:  
As Noted

MEZZANINE/ROOF  
MECHANICAL PLAN

**M1.04**

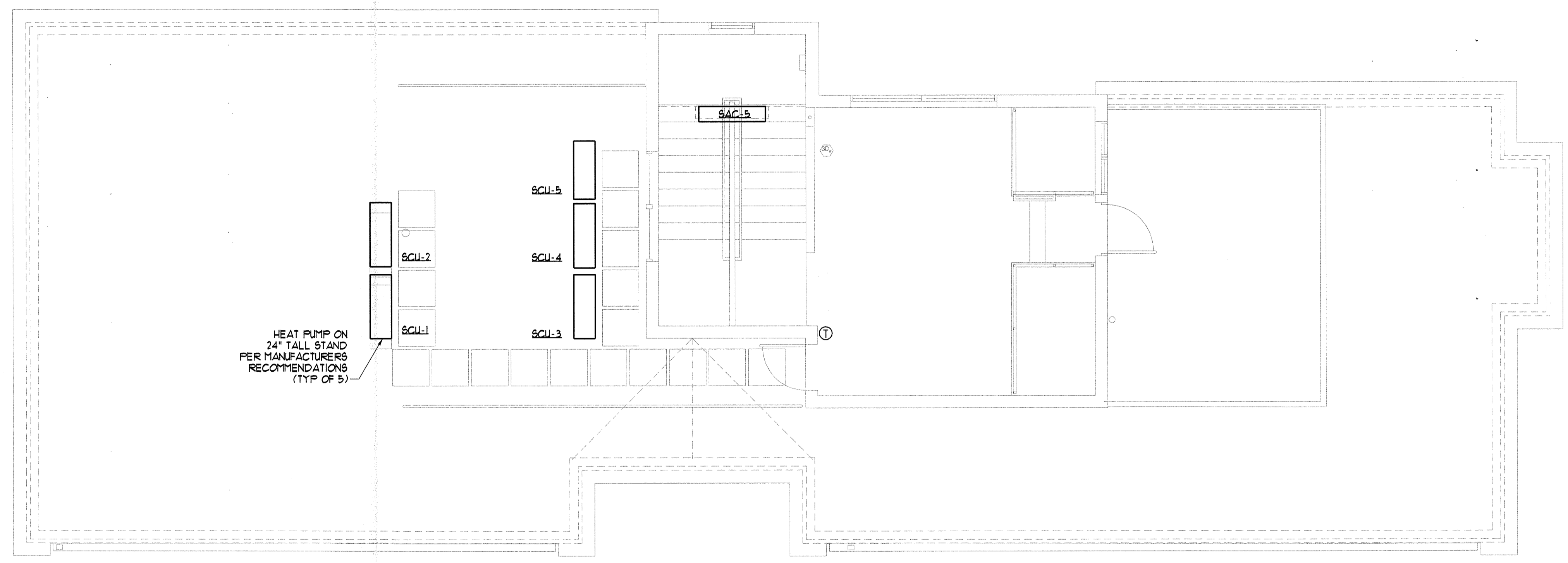

**ROOF / MEZZANINE MECHANICAL PLAN**  
SCALE - 1/4" = 1'-0"