

third level

second level

first level

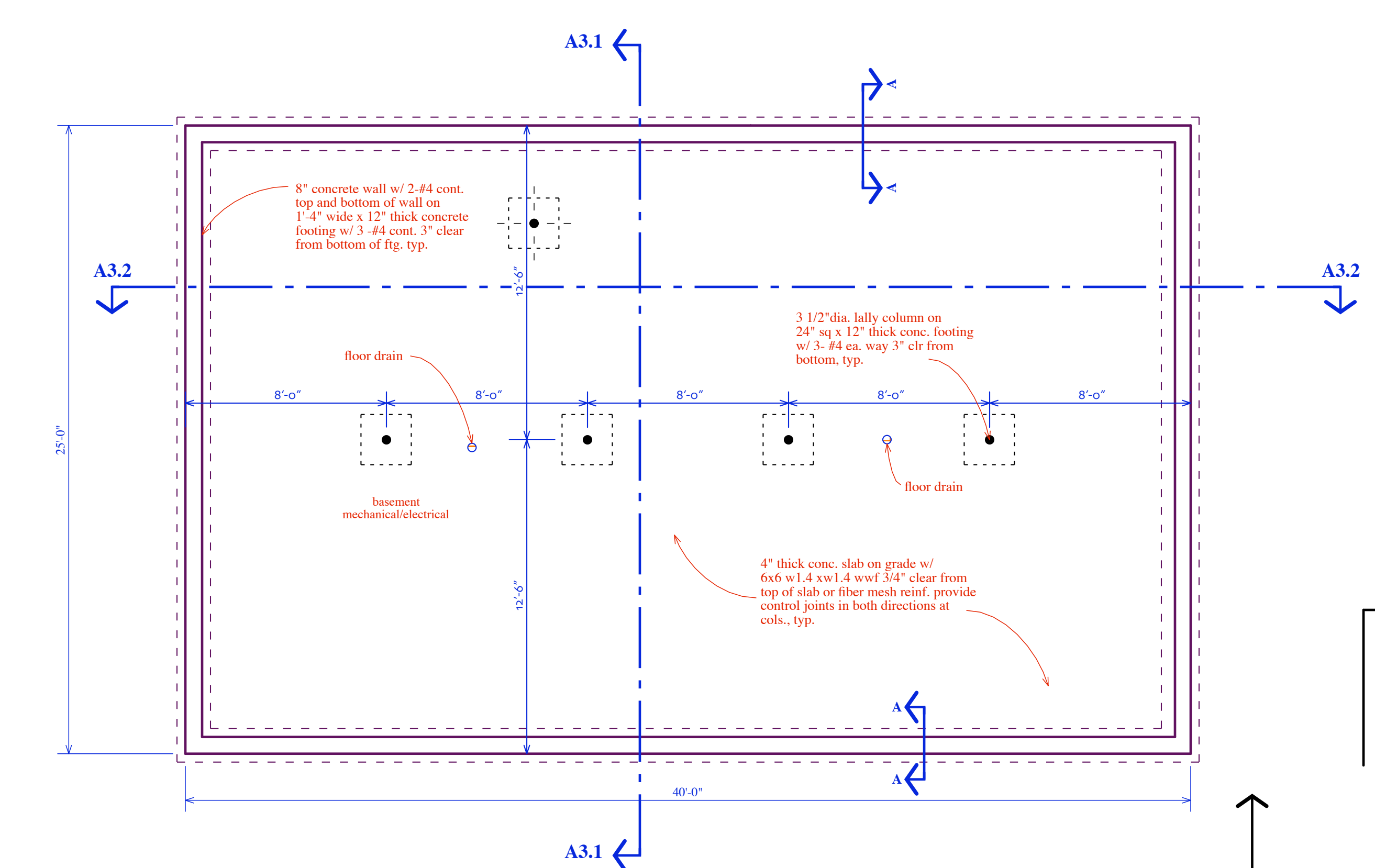

foundation plan

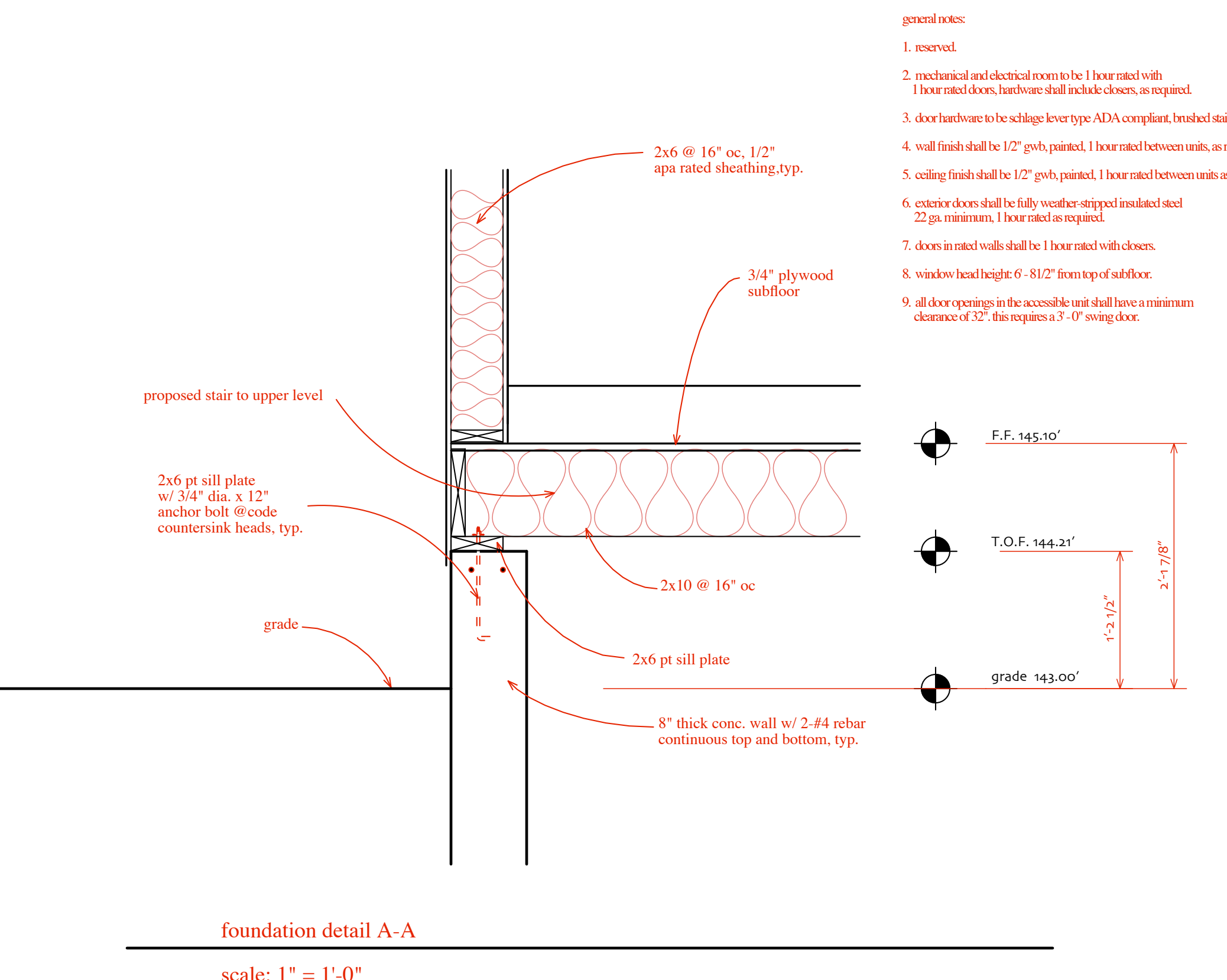

foundation detail A-A
scale: 1" = 1'-0"

general notes:

1. reserved.
2. mechanical and electrical room to be 1 hour rated with 1 hour rated doors, hardware shall include closers, as required.
3. door hardware to be schlage level type ADA compliant, brushed stainless.
4. wall finish shall be 1/2" gvs, painted, 1 hour rated between units, as required.
5. ceiling finish shall be 1/2" gvs, painted, 1 hour rated between units as required.
6. exterior doors shall be fully weather-stripped insulated steel 22 ga minimum, 1 hour rated as required.
7. doors in rated walls shall be 1 hour rated with closers.
8. window head height 6'-8 1/2" from top of subfloor.
9. all door openings in the accessible unit shall have a minimum clearance of 32" - this requires a 7'-0" swing door.

finish notes:

1. first floor unit:
kitchen, laundry: resilient flooring - Armstrong imperial texture standard or equal, standard 12"x12"x1/8" vinyl base: phosoxide or equal with color to match 4"x18" cove base, inside finish.
bedrooms: 1/4" ceramic tile, no: floor drain adjacent to shower, living room, hallway, bedrooms: hardwood 21 or better, direct glued (no pad).
2. A and B units:
kitchen, bathroom, laundry: manning Vopall sheet vinyl, living room, hallway, bedrooms, stairs: hardwood 21 or better, with pad, stairway: painted risers, oak treads polyurethane or kam mat, entry hall 303 kam mat (rustic, etc.)

window notes:

1. windows shall be certified white vinyl windows with insulating glass and screens.
2. all bedrooms shall have an egress window (if required).

electrical notes:

1. all electrical work is to comply with state and local codes.
2. hard wired smoke detectors shall be provided in all units on per rfp.
3. range hoods and dryers shall be vented to the exterior.
4. the exit stair from the A and B level shall be provide with emergency light with battery back up.
5. all receptacles in wet areas shall be GFI type as per code.
6. all lighting in public areas shall be on timers.

plumbing notes:

1. all plumbing is to comply with state and local codes.
2. provide floor drains in the laundry rooms, first level unit bathroom and a minimum of 2 in the basement.

atlantic street apartments
atlantic street
portland, maine

floor plans
07 march 2005

A 1.1
1/4" = 1' - 0"

james sterling architect
142 high street
portland, maine

revision:
3/7/05 11:23 AM