

LOCATION PLAN
SCALE: 1" = 250'

**CITY OF PORTLAND
SITE PLAN AND SUBDIVISION NOTES**

- LANDSCAPING SHALL MEET THE "ARBORICULTURAL SPECIFICATIONS AND STANDARDS OF PRACTICE AND LANDSCAPE GUIDELINES" OF THE CITY OF PORTLAND TECHNICAL AND DESIGN STANDARDS AND GUIDELINES.
- THE ENTIRE SITE SHALL BE DEVELOPED AND/OR MAINTAINED AS DEPICTED ON THE SITE PLAN. APPROVAL OF THE PLANNING AUTHORITY OR PLANNING BOARD SHALL BE REQUIRED FOR ANY ALTERATION TO OR DEVIATION FROM THE APPROVED SITE PLAN, INCLUDING, WITHOUT LIMITATION: TOPOGRAPHY, DRAINAGE, LANDSCAPING, RETENTION OF WOODED OR LAWN AREAS, ACCESS, SIZE, LOCATION, AND SURFACING OF PARKING AREAS AND LOCATION AND SIZE OF BUILDINGS.
- ALL POWERLINE UTILITIES SHALL BE UNDERGROUND.
- SIDEWALKS AND CURBING SHALL BE DESIGNED AND BUILT WITH TIP-DOWN RAMPS AT ALL STREET CORNERS, CROSSWALKS AND DRIVEWAYS IN CONFORMANCE WITH THE CITY OF PORTLAND TECHNICAL AND DESIGN STANDARDS AND GUIDELINES.
- ALL EROSION CONTROL MEASURES SHALL BE CONSTRUCTED AND MAINTAINED IN ACCORDANCE WITH THE MAINE EROSION AND SEDIMENT CONTROL BMPs PUBLISHED BY THE BUREAU OF LAND AND QUALITY, MAINE DEPARTMENT OF ENVIRONMENTAL PROTECTION, MARCH 2003.
- ALL EROSION CONTROL MEASURES SHALL BE INSTALLED PRIOR TO ANY SITE EXCAVATION OR REGRADING.
- ALL DISTURBED AREAS ON THE SITE NOT COVERED BY BUILDINGS OR PAVED AREAS SHALL BE STABILIZED WITH LOAM AND SEED OR OTHER METHODS AS REQUIRED BY BEST MANAGEMENT PRACTICES (SEE ABOVE).
- PRIOR TO CONSTRUCTION, A PRECONSTRUCTION MEETING SHALL BE HELD AT THE PROJECT SITE WITH THE CONTRACTOR, DEVELOPMENT REVIEW COORDINATOR, PUBLIC WORKS REPRESENTATIVE AND OWNER TO REVIEW THE CONSTRUCTION SCHEDULE AND CRITICAL ASPECTS OF THE SITE WORK. AT THAT TIME, THE SITE/BUILDING CONTRACTOR SHALL PROVIDE THREE (3) COPIES OF A DETAILED CONSTRUCTION SCHEDULE TO THE ATTENDING CITY REPRESENTATIVE. IT SHALL BE THE CONTRACTOR'S RESPONSIBILITY TO ARRANGE A MUTUALLY AGREEABLE TIME FOR THE PRECONSTRUCTION MEETING.
- EXISTING VEGETATION SHALL BE CONSERVED IN AREAS SHOWN ON THIS SITE. FENCING OR OTHER PROTECTIVE BARRIERS SHALL BE ERECTED OUTSIDE THE DRIP-LINE OF INDIVIDUAL GROUPINGS OF TREES DESIGNATED FOR PRESERVATION PRIOR TO THE ONSET OF CONSTRUCTION. REGRADING SHALL NOT TAKE PLACE WITHIN THE DRIP-LINE OF TREES DESIGNATED FOR PRESERVATION. NO STORAGE OR CONSTRUCTION MATERIALS SHALL BE PERMITTED WITHIN THE DRIP-LINE OF TREES TO BE PRESERVED.
- SUBDIVISION AT THE TIME OF APPROVAL IS DEFINED AS "SUBDIVISION SHALL MEAN THE DIVISION OF A LOT, TRACT OR PARCEL OF LAND INTO THREE (3) OR MORE LOTS, INCLUDING LOTS OF FORTY (40) ACRES OR MORE, WITHIN ANY FIVE-YEAR PERIOD WHETHER ACCOMPLISHED BY SALE, LEASE, DEVELOPMENT, BUILDINGS OR OTHERWISE AND AS FURTHER DEFINED IN 30-A M.R.S.A. SECTION 4401. THE TERM SUBDIVISION SHALL ALSO INCLUDE THE DIVISION OF A NEW STRUCTURE OR STRUCTURES ON A TRACT OR PARCEL OF LAND INTO THREE (3) OR MORE DWELLING UNITS WITHIN A FIVE-YEAR PERIOD AND THE DIVISION OF AN EXISTING STRUCTURE OR STRUCTURES PREVIOUSLY USED FOR COMMERCIAL OR INDUSTRIAL USE INTO THREE (3) OR MORE DWELLING UNITS WITHIN A FIVE-YEAR PERIOD. THE AREA INCLUDED IN THE EXPANSION OF AN EXISTING STRUCTURE IS DEEMED TO BE A NEW STRUCTURE FOR THE PURPOSE OF THIS PARAGRAPH. A DWELLING UNIT SHALL INCLUDE ANY PART OF A STRUCTURE WHICH, THROUGH SALE OR LEASE, IS INTENDED FOR HUMAN HABITATION, INCLUDING SINGLE-FAMILY AND MULTIFAMILY HOUSING CONDOMINIUMS, TIME-SHARE UNITS AND APARTMENTS."

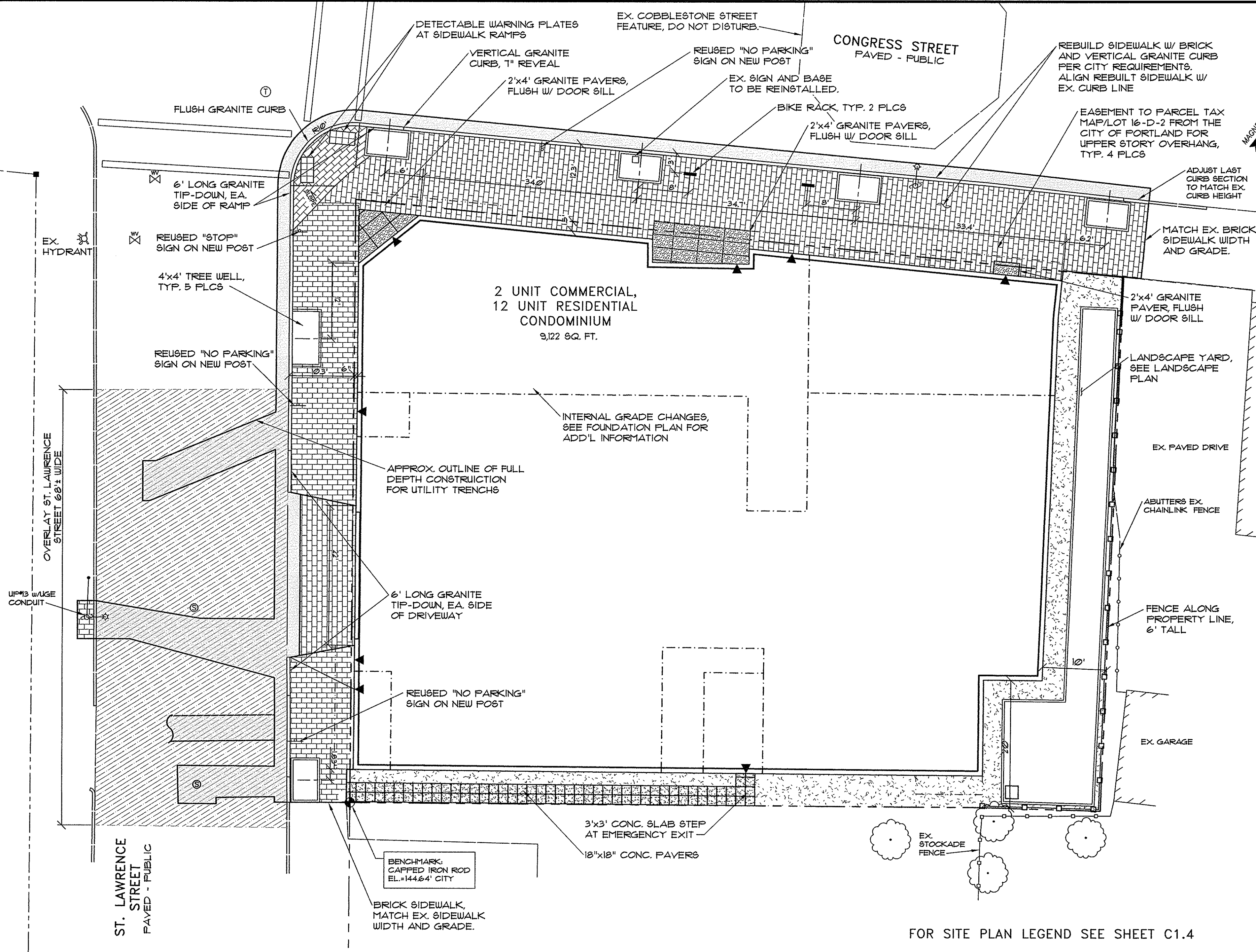

- GENERAL NOTES**
- OWNER: EMT, LLC, 118 CONGRESS STREET, PORTLAND MAINE 04101. DEED RECORDED IN THE CUMBERLAND COUNTY REGISTRY OF DEEDS BK. 14136, PG. 214, DATE SEPTEMBER 10, 1998.
 - DEVELOPER: 118 CONDOMINIUMS, LLC, 118 CONGRESS STREET, PORTLAND, MAINE 04101.
 - ENGINEER: PINKHAM & GREER CONSULTING ENGINEERS, 28 VANNAH AVENUE, PORTLAND, MAINE, 04103.
 - ARCHITECT: ARCHETYPE ARCHITECTS, 48 UNION WHARF, PORTLAND, MAINE, 04101
 - TOPOGRAPHIC AND BOUNDARY INFORMATION: OWEN HASKELL, INC. 390 US ROUTE ONE, FALMOUTH, MAINE. BENCHMARK: CITY DATUM, BASED ON MON. AT NORTHEAST CORNER OF NORTH AND CONGRESS STREETS, ELEV. 146.63'.
 - SOILS MAPPING TAKEN FROM SOIL CONSERVATION STUDY OF CUMBERLAND COUNTY AND CLASSIFIED AS HINCKLEY (H1B), GRAVELLY SANDY LOAM, 3-8% SLOPES, HYDROLOGICAL GROUP "A".
 - TAX MAP REFERENCE: MAP 16 / BLOCK D / LOT 2.
 - TOTAL PARCEL = 0.25 acres
 - CALL DIG-SAFE PRIOR TO COMMENCING WORK, 1-800-DIG-SAFE.
 - LOT TO BE SERVICED BY PUBLIC WATER AND SEWER.
 - ALL WORK WITHIN THE RIGHT OF WAY IS TO MEET CITY OF PORTLAND STANDARDS.

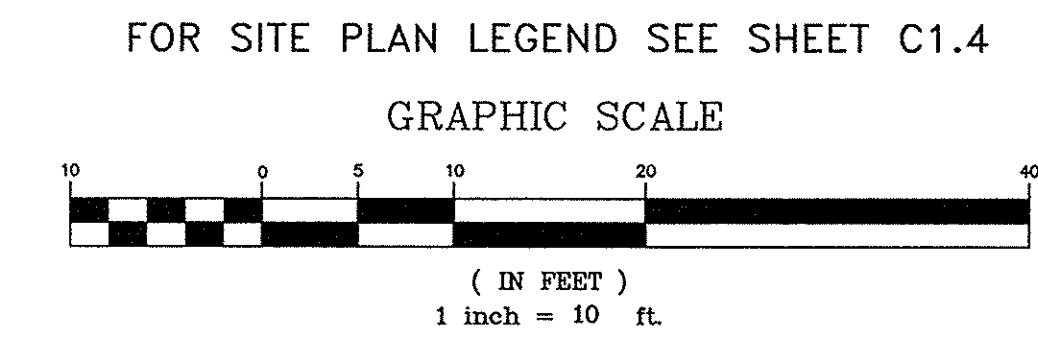

ZONE INFORMATION

EXISTING ZONE: B-1, NEIGHBORHOOD BUSINESS ZONE
PROPOSED ZONE: B-1 WITH A ZONING AMENDMENT REQUEST
PROPOSED USE: COMMERCIAL SPACE AND MULTIFAMILY DWELLINGS

SPACE STANDARDS	REQUIRED	PROVIDED
MINIMUM LOT SIZE	NONE	0.25 AC.
MINIMUM STREET FRONTAGE	50 FEET	121.9 FEET
MINIMUM FRONT YARD	10 FEET MAX.	0.5 FEET
MINIMUM REAR YARD	NONE	5.3 FEET
MINIMUM SIDE YARD	NONE ①	10.1 FEET
MINIMUM SIDE YARD ON A SIDE STREET	10 FEET MAX.	0.5 FEET
MINIMUM LOT WIDTH	NONE	118.5 FEET
MAXIMUM BUILDING HEIGHT	45 FEET ②	50 FEET ②
MAXIMUM IMPERVIOUS SURFACE RATIO	90%	89%
FLOOR AREA	10,000 SQ. FT. MAX.	9,122 SQ. FT.
MINIMUM AREA PER DWELLING UNIT	435 SQ. FT.	894 SQ. FT.
OFF STREET PARKING	1 SPACE PER UNIT	18 SPACES

① EXCEPT THAT WHERE A SIDE YARD ABUTS A RESIDENTIAL ZONE OR A FIRST FLOOR RESIDENTIAL USE, A MINIMUM OF TEN (10) FEET IS REQUIRED.
② A ZONING TEXT AMENDMENT IS REQUESTED ALLOWING 50 FEET.

DRAWINGS INCLUDED IN THIS SUBMITTAL

C10	SUBDIVISION PLAN	1	STANDARD BOUNDARY SURVEY
C11	CONDOMINIUM PLAT		
C12	SITE PLAN		
C13	EXISTING CONDITIONS AND DEMOLITION PLAN	A101	FLOOR PLAN - PARKING LEVEL
C14	GRADING AND UTILITIES PLAN	A104	FOURTH FLOOR PLAN
C15	EROSION CONTROL PLAN, NOTES AND DETAILS	A105	ROOF PLAN
C16	DETAILS	A201	BUILDING ELEVATIONS
C17	DETAILS		
L10	LANDSCAPE IMPROVEMENTS PLAN	E01	ELECTRICAL & PHOTOMETRIC SITE PLAN
L20	LANDSCAPE DETAILS		

SITE PLAN AND SUBDIVISION PLAN, APPROVED BY THE CITY OF PORTLAND PLANNING BOARD

DATE _____

THESE TWELVE (12) RESIDENTIAL UNITS AND TWO (2) COMMERCIAL SPACE CREATE A SUBDIVISION. THE CITY REVIEW IS FOR SITE AND SUBDIVISION APPROVAL.

118 CONDOMINIUMS, LLC
118 CONGRESS STREET, PORTLAND ME

118 on MUNJOY HILL
118 CONGRESS STREET, PORTLAND, ME

PINKHAM & GREER
CONSULTING ENGINEERS
28 VANNAH AVENUE
PORTLAND, MAINE

SITE PLAN MAP 16/BLOCK D/LOT 2

REV.	DATE	DESCRIPTION
1	01/02/14	REVISED LAYOUT, ADDED GARDEN

SCALE: AS SHOWN DRN BY: JDC
DATE: NOVEMBER 13, 2013 DESG BY: TSG
PROJECT: 13143 CHK BY: TSG

