

LOCATION PLAN
SCALE: 1"=250'

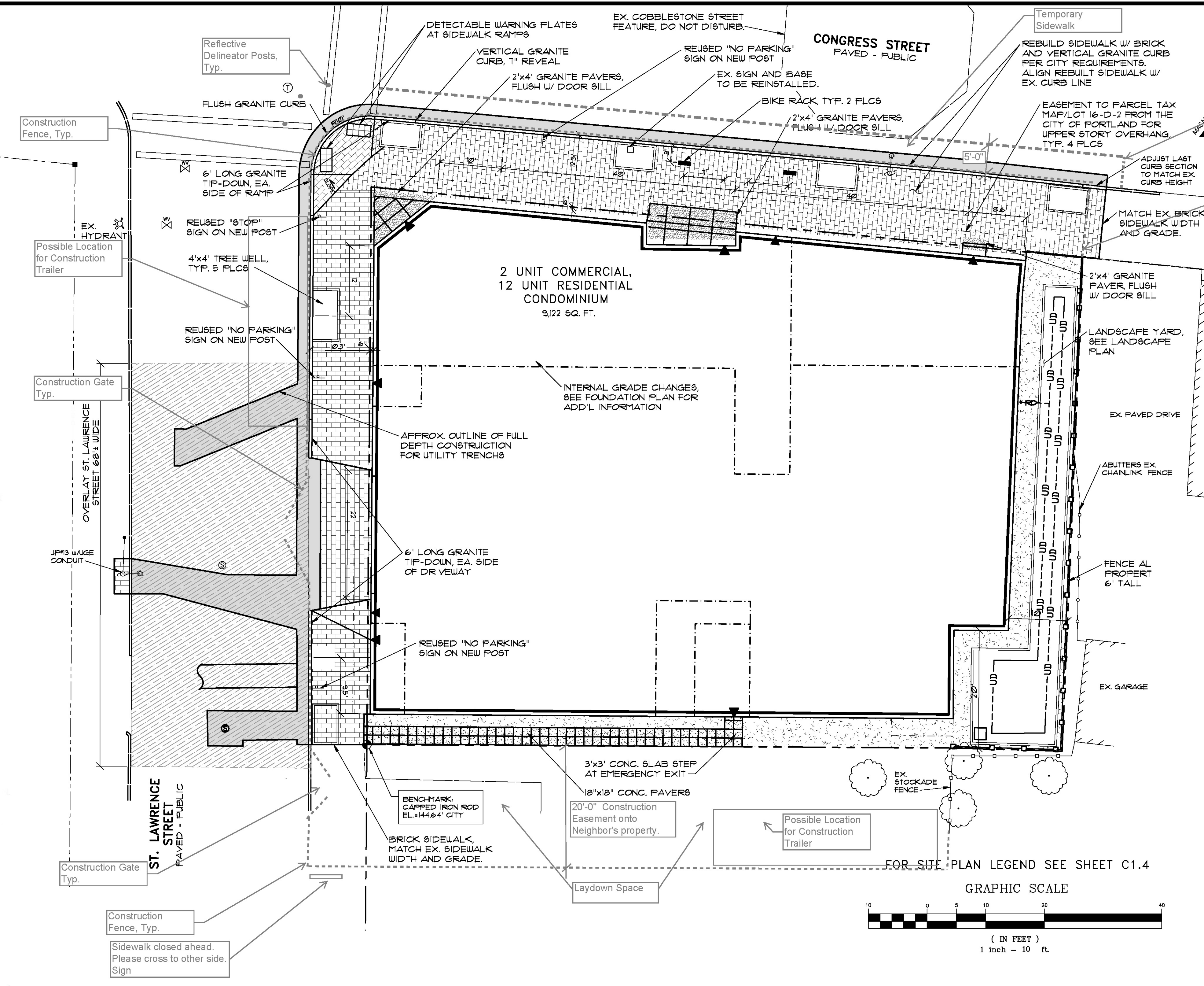

GENERAL NOTES

1. OWNER: EMT, LLC, 118 CONGRESS STREET, PORTLAND MAINE 04101. DEED RECORDED IN THE CUMBERLAND COUNTY REGISTRY OF DEEDS BK. 14136, PG. 214, DATE SEPTEMBER 10, 1998.
 2. DEVELOPER: 118 CONDOMINIUMS, LLC, 118 CONGRESS STREET, PORTLAND, MAINE 04101.
 3. ENGINEER: PINKHAM & GREER CONSULTING ENGINEERS, 28 VANNAH AVENUE, PORTLAND, MAINE, 04103.
 4. ARCHITECT: ARCHETYPE ARCHITECTS, 48 UNION WHARF, PORTLAND, MAINE, 04101
 5. TOPOGRAPHIC AND BOUNDARY INFORMATION: OWEN HASKELL, INC. 390 US ROUTE ONE, FALMOUTH, MAINE. BENCHMARK: CITY DATUM, BASED ON MON. AT NORTHEAST CORNER OF NORTH AND CONGRESS STREETS, ELEV. 146.69'.
 6. SOILS MAPPING TAKEN FROM SOIL CONSERVATION STUDY OF CUMBERLAND COUNTY AND CLASSIFIED AS HINCKLEY (H1B), GRAVELLY SANDY LOAM, 3-8% SLOPES, HYDROLOGICAL GROUP "A".
 7. TAX MAP REFERENCE: MAP 16 / BLOCK D / LOT 2.
 8. TOTAL PARCEL = 0.25 acres
 9. CALL DIG-SAFE PRIOR TO COMMENCING WORK, 1-800-DIG-SAFE.
 10. LOT TO BE SERVICED BY PUBLIC WATER AND SEWER.
- ALL WORK WITHIN THE RIGHT OF WAY IS TO MEET CITY OF PORTLAND STANDARDS.

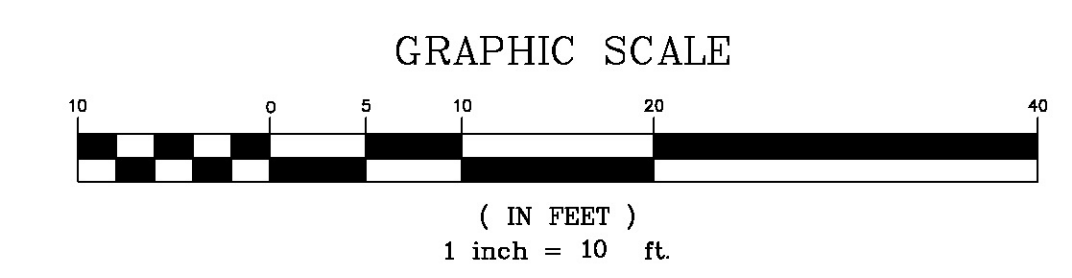

THIS PLAN PREPARED BY WRIGHT-RYAN

REV.	DATE	DESCRIPTION

118 CONDOMINIUMS, LLC
118 CONGRESS STREET, PORTLAND ME

118 on MUNJOY HILL
118 CONGRESS STREET, PORTLAND, ME

PINKHAM & GREER
CONSULTING ENGINEERS
28 VANNAH AVENUE
PORTLAND, MAINE

Construction Management Plan

SCALE: AS SHOWN	DRN BY: JDC	CM1.0
DATE: NOVEMBER 13, 2013	DESIGN BY: TSG	
PROJECT: 13143	CHK BY:	