

drop w18 below roof joists. provide 2x6 hardwood plate on top of beam. fasten plate to top of beam with (2) 0.177" dia. paf @ 6" oc. fasten joists to plate with (2) 16d toe nails and provide 2x12 solid blocking over beam, typ.

hold steel beam back 1" from ext. face of wall (for 1" rigid insulation) bear 4 1/2" on 2x6 hardwood plate on top of col. fasten beam to plate with (2) 1/2" dia x 4" long lag bolts at beam ga. at 1 1/2" from end of beam (both sides of beam, typ.)

plumbing chase
casement c1836 window head beyond 4-2x6 post
extended wood sill both sides of chase

provide 2x4 web stiffeners on both sides of floor joists at bearing (both ends, typ.) fasten per manuf. requirements, typ.

provide 'versa-rim 98' rim board at perimeter of floor. fasten web stiffener in joists w/ 4-16d nails in ea stiffener, typ.

4-2x6 col

3 1/2x16 VL header

5.25 x 16 VL beyond see A4.1 framing plan

3 1/2x16 VL header

3.5 x 16 VL beyond see A4.1 framing plan

1 hour rated walls, ceiling and doors in entry stair hall

6-8" typ. window hgt.

1 hour rated ceiling under stair only

laundry

provide blocking to receive VL's

51/4x16 VL header

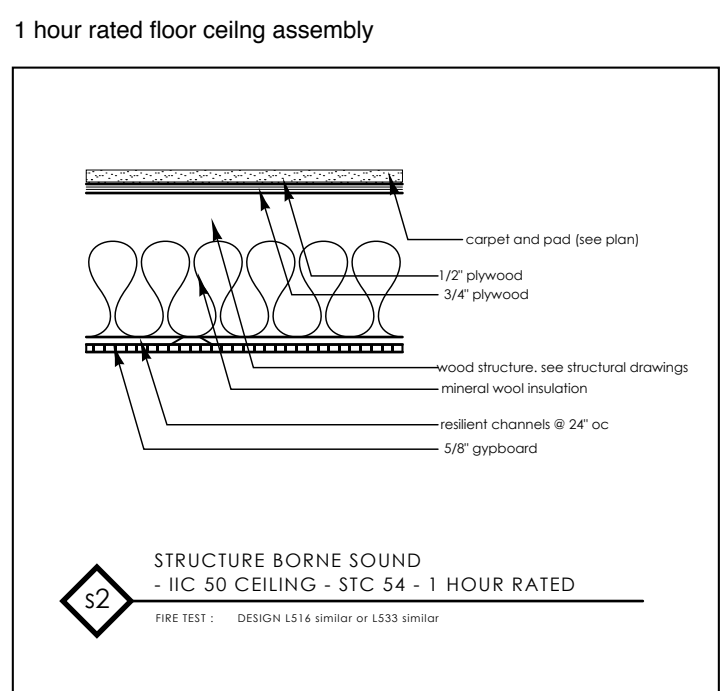

FF: 145'-10"

GRADE: 143'-00"

backfill with permeable soils
provide 4" rigid footing drain, both sides of the footing, cover with filter fabric and crushed stone
undisturbed soil or clean, solid ledge

footing drain - both sides, typ.
6 mil reinforced vapor barrier
3" sand
8" compacted stone

section
07 march 2005
revised: 12 Sept 05
atlantic street apartments
atlantic street
portland maine
A 3.1
1/2" = 1' - 0"

james sterling architect
142 high street
portland, maine