

Legend of Symbols

-  New gyp. bd. or masonry wall
-  Existing wall / door to remain

General Electrical and Plumbing Notes:

1. Coordinate and install all electrical outlets and other requirements for Owner-provided equipment as per manufacturers' recommendations.
2. Coordinate and install all electrical and gas requirements for new HVAC and new exhaust hood equipment.
3. Coordinate and install all plumbing supply and drain lines as required for new fixtures and/or as required per manufacturers' recommendations.
4. See manufacturers cut sheets as provided by Architect and/or HVAC contractor, and notify Architect if any installation information is missing.

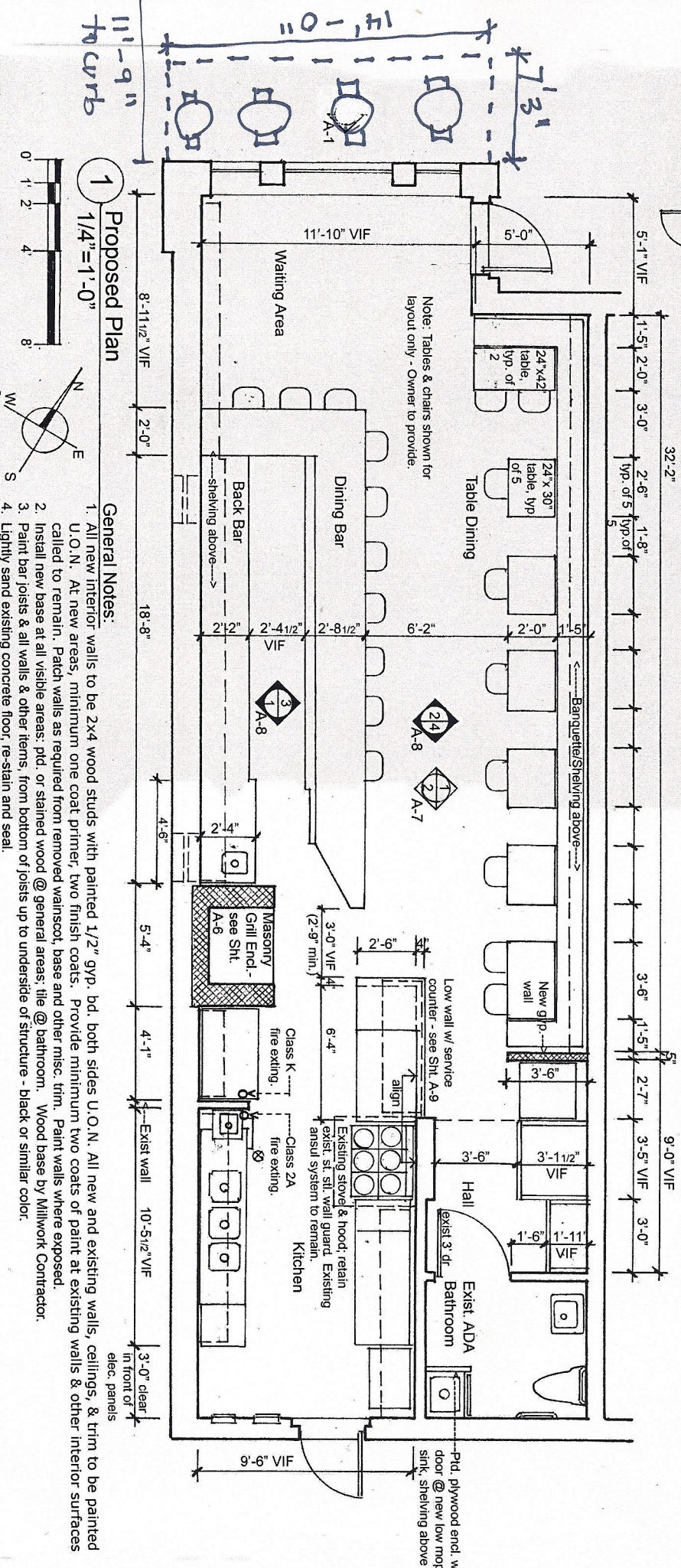

1
Proposed Plan
1/4" = 1'-0"

General Notes:

1. All new interior walls to be 2x4 wood studs with painted 1/2" gyp. bd. both sides U.O.N. All new and existing walls, ceilings, & trim to be painted U.O.N. At new areas, minimum one coat primer, two finish coats. Provide minimum two coats of paint at existing walls & other interior surfaces called to remain. Patch walls as required from removed wainscot, base and other misc. trim. Paint walls where exposed.
2. Install new base at all visible areas: pld. or stained wood @ general areas; tile @ bathroom. Wood base by Millwork Contractor.
3. Paint bar joists & all walls & other items, from bottom of joists up to underside of structure - black or similar color.
4. Lightly sand existing concrete floor, re-stain and seal.
5. Wood blocking as req'd for new millwork to be provided by Millwork Contractor, including removal and replacement of exist. gyp. bd. as required.

90 CONGRESS STREET RESTAURANT / Proposed Plan
 90 Congress Street, Portland, Maine 04101 December 16, 2013
 Reier Architecture & Design / PO Box 275 / Brooklin ME 04616 / 207-359-2300 / laurenreier@yahoo.com



A-4