

ROOF DECK FRAMING PLAN

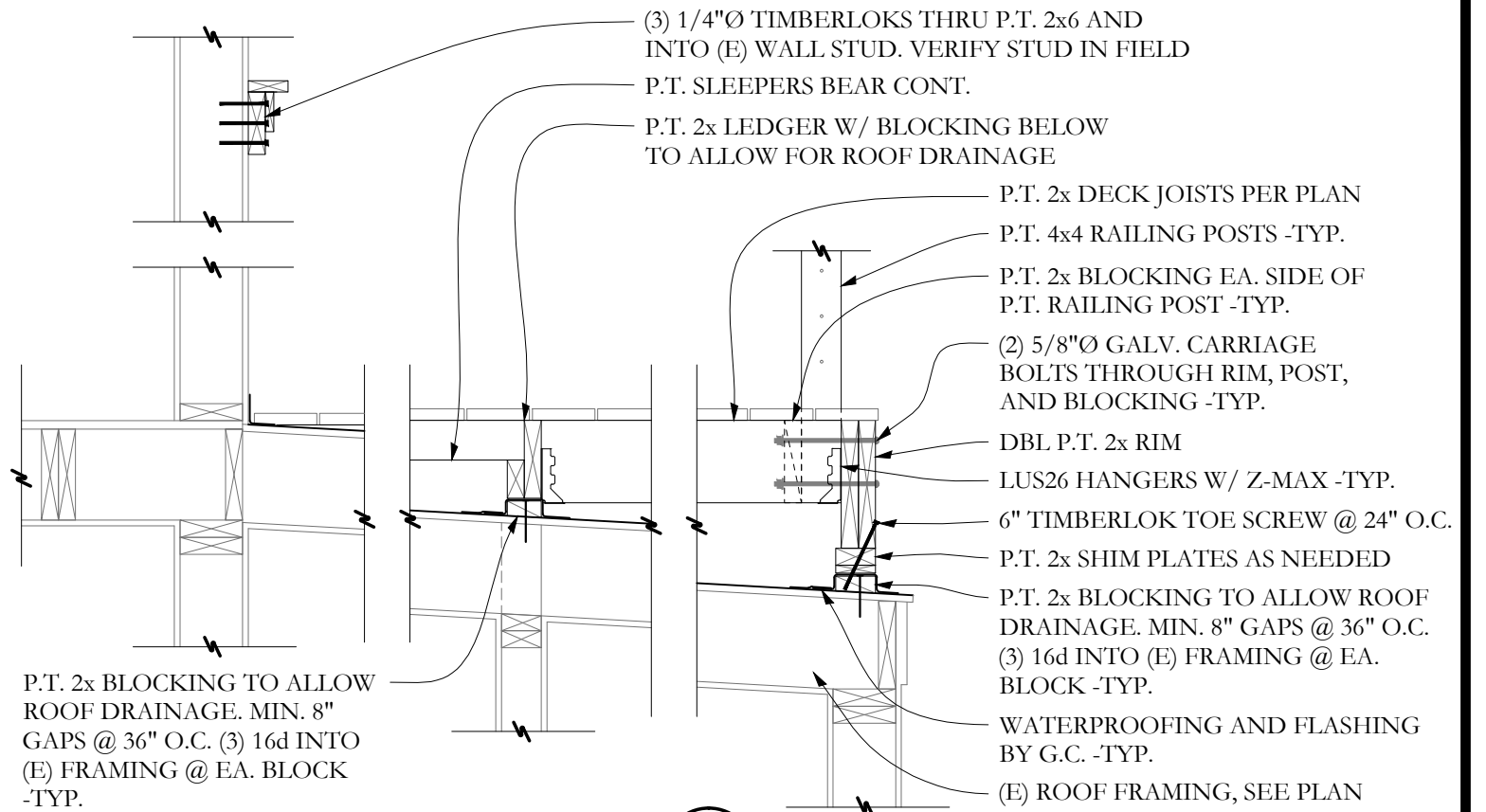

SECTION **B/S1** 3/4"=1'-0

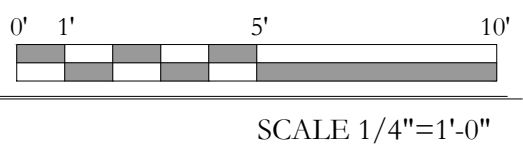
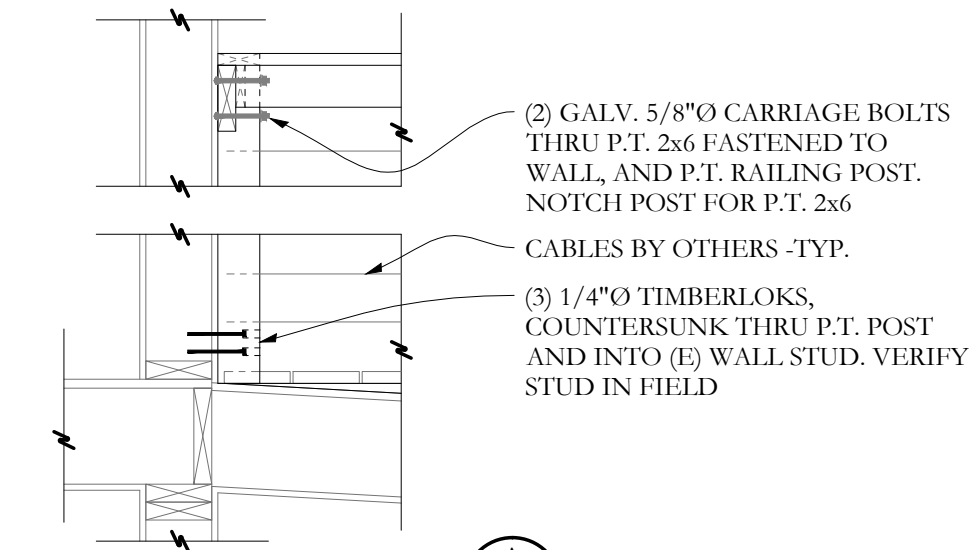

SECTION **A/S1** 3/4"=1'-0

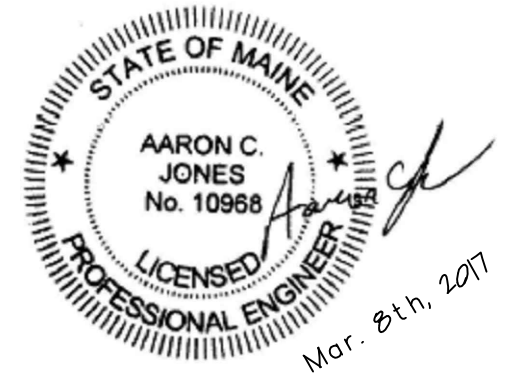

Rooftop Deck Framing

73 Melbourne St.

Portland, ME

Scale: AS NOTED

Date: 03/08/2017

S1

Structural Integrity
Consulting Engineers, Inc.

77 Oak Street
Portland, ME, 04101
p. 207-774-4614
f. 866-793-7835
www.structuralinteg.com

BUILD WITH CONFIDENCE
© 2017 Structural Integrity Consulting Engineers, Inc.

SI JOB# 17-0052