

ALL DRAWINGS, PLANS, SKETCHES ETC. ARE PROVIDED TO OUR CLIENTS BASED UPON INFORMATION PROVIDED BY THE CLIENT AND DRAWN IN ACCORDANCE WITH COMMON BUILDING PRACTICES. NONE OF THE EMPLOYEES OR LAND DRAFTING ARE REGISTERED ARCHITECTS, STRUCTURAL ENGINEERS OR LAND SURVEYORS. CODES SHALL BE REVIEWED AND APPROVED BY APPROPRIATE REGISTERED PROFESSIONALS, IF NOT, SHALL BE RESPONSIBILITY OF CONTRACTOR OR OWNER. ALL NOTING, SPECIFICATION AND DIMENSIONS SHALL BE REVIEWED BY CLIENT/CONTRACTOR BEFORE WORK BEGINS. ALL OMISSIONS SHALL BE BROUGHT TO THE ATTENTION OF MORIN DRAFTING. IF PLANS ARE NOT VERIFIED BY CLIENT AND/OR CONTRACTOR BEFORE CONSTRUCTION BEGINS MORIN DRAFTING SHALL BE HELD HARMLESS. IN ALL EVENTS DAMAGES SHALL BE LIMITED TO COST OF THE PLANS. MORIN DRAFTING ASSUMES NO LIABILITY FOR CONSTRUCTION DEFECTS, CHANGES AND/OR REVISIONS TO PLANS.

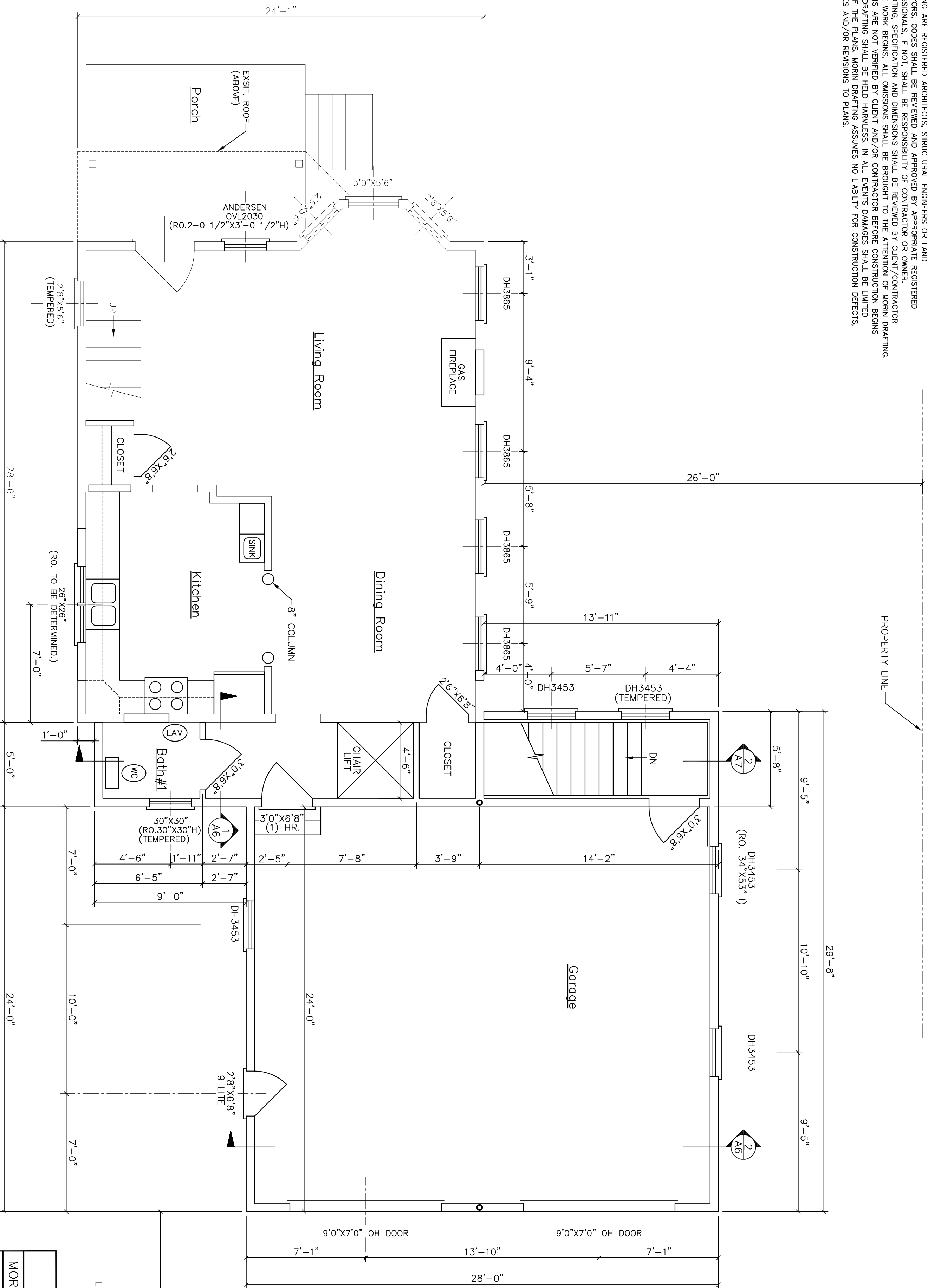

FLOOR PLAN—FIRST FLOOR

FLOOR PLAN—1ST FLOOR

MORIN DRAFTING GORHAM, ME. 893-2462
 RENOVATION PROJECT
 214 EASTERN PROMENADE
 DRAWN: J. MORIN
 SCALE: 1/4"=1'-0"
 DATE: 10-19-06

A4