

NOTES:

Character of Brick Walk: Brick is laid in Running Bond pattern with edges being full-sized brick (where possible) moving into adjacent beds. Preparation should include a 5" base with a 2" stone dust setting bed.

An alternative to all-brick is to blend brick with Oak Hill 'Field Stone' set at landings, steps and nodes. Another alternative is to use Oak Hill exclusively.

Fountain- The basin floor should be covered with rounded stones and perhaps shells and colored glass pieces.

See **Image Collection** for a sense of character aimed for as construction and planting continue.

LEGEND:

- PROPERTY LINE- Information taken from survey provided by client.
- GRAVEL STRIP
- DIRECTION OF SURFACE FLOW
- STEP DOWN
- PERENNIALS OR ANNUALS
- GROUND COVER
- DRAIN INLET with Top of Frame shown TF

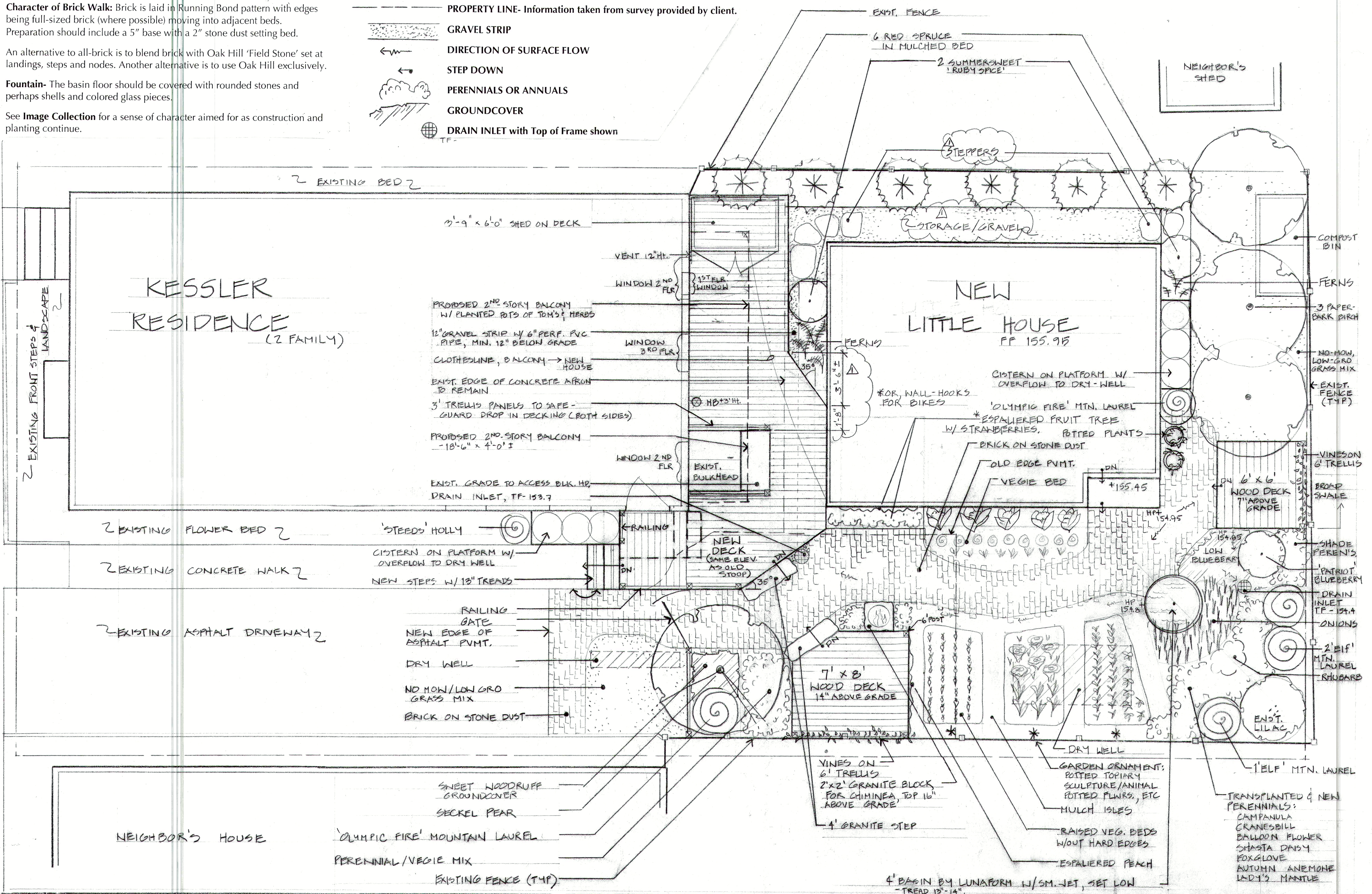

<p>TITLE: SCHEMATIC LANDSCAPE MASTER PLAN</p>	<p>PROJECT: KESSLER RESIDENCE</p>	<p>CLIENT: WILL & MARTA KESSLER 70 MELBOURNE STREET PORTLAND, MAINE 04101</p>	<p>CONTACT: LOIS A BEARDSLEY LANDSCAPE ARCHITECT 104 LIBBY ROAD POWNAW, MAINE 04069</p> <p>PHONE: 207-232-4541 e-mail: labeadsleyla@gmail.com</p>
<p>REVISIONS: House footprint change w/ affected areas. File # 10/16/16</p> <p>SCALE: 1/4" = 1'-0" DATE: DECEMBER, 16 2016 DRAWN BY: LAB</p>			