

GENERAL + PLANTING NOTES

- CALL DIG-SAFE (1-888-344-7233) PRIOR TO BEGINNING WORK. THE LANDSCAPE CONTRACTOR IS ADVISED OF THE PRESENCE OF UNDERGROUND UTILITIES AND SHALL VERIFY THE EXISTENCE AND LOCATION OF SAME BEFORE COMMENCING AND DIGGING OPERATIONS. THE LANDSCAPE CONTRACTOR SHALL REPLACE OR REPAIR UTILITIES PAVING, WALKS, CURBING, ETC. DAMAGED IN PERFORMANCE OF THIS JOB AT NO ADDITIONAL COST TO OWNER.
- CONTRACTOR SHALL THOROUGHLY FAMILIARIZE HIMSELF WITH ALL SITE CONDITIONS PRIOR TO CONSTRUCTION BIDDING.
- DO NOT SCALE FROM DRAWINGS. ANY OMISSIONS IN DIMENSIONING SHALL BE REPORTED IMMEDIATELY TO THE LANDSCAPE ARCHITECT. ANY DISCREPANCIES BETWEEN DRAWINGS, DETAILS, NOTES AND SPECIFICATIONS SHALL BE IMMEDIATELY REPORTED TO THE LANDSCAPE ARCHITECT FOR FURTHER DIRECTION AND RESOLUTION BEFORE ANY ADDITIONAL WORK PROCEEDS.
- PROVIDE SMOOTH TRANSITION WHERE NEW WORK MEETS EXISTING CONDITIONS.
- CONTRACTOR SHALL FURNISH AND PLACE 12 INCHES OF LOAM IN ALL SHRUB BEDS, 30 INCHES IN ALL TREE PITS, AND 6 INCHES UNDER ALL TURF AREAS. THE LANDSCAPE CONTRACTOR SHALL COORDINATE SUBGRADE PREPARATION WITH THE GENERAL CONTRACTOR PRIOR TO PLACING LOAM.
- ALL PLANT MATERIAL INSTALLED SHALL MEET THE SPECIFICATIONS OF "AMERICAN STANDARDS FOR NURSERY STOCK BY THE AMERICAN ASSOCIATION OF NURSERYMEN" LATEST EDITION.
- ALL PLANT MATERIAL SHALL BE FREE FROM INSECTS AND DISEASE.
- ALL PLANTING SHALL BE DONE IN ACCORDANCE WITH ACCEPTABLE HORTICULTURAL PRACTICES. THIS IS TO INCLUDE PROPER PLANTING MIX, PLANT BED AND TREE PIT PREPARATION, PRUNING STAKING OR GUYING WRAPPING, SPRAYING, FERTILIZATION, PLANTING AND ADEQUATE MAINTENANCE UNTIL ACCEPTANCE FROM THE OWNER.
- ALL GRASS, OTHER VEGETATION AND DEBRIS SHALL BE REMOVED FROM ALL PLANTING AREAS PRIOR TO PLANTING.
- EXISTING TREES TO BE PRESERVED SHALL BE PROTECTED DURING CONSTRUCTION AND SHALL BE THE RESPONSIBILITY OF THE GENERAL CONTRACTOR.
- ALL SHRUB BEDS AND TREE PITS SHALL BE MULCHED WITH 3" CLEAN SHREDDED BLACK MULCH.
- ANY DEVIATION FROM THE LANDSCAPE PLAN, INCLUDING PLANT LOCATION, SELECTION, SIZE, QUANTITY, OR CONDITION SHALL BE REVIEWED AND APPROVED BY THE OWNER AND/OR LANDSCAPE ARCHITECT PRIOR TO INSTALLATION ON SITE.
- WHERE INDICATED ON PLAN, PLANTING SOIL MIXTURE FOR GROUND COVER AND PERENNIAL BED AREAS SHALL CONSIST OF FOUR PARTS TOPSOIL, TWO PARTS SPHAGNUM PEAT MOSS, AND ONE PART HORTICULTURAL PERLITE BY VOLUME. PEAT MOSS MAY BE SUBSTITUTED WITH WELL-ROTTED OR DEHYDRATED MANURE OR COMPOST. ROTOTILL BEDS TO A DEPTH OF 8 INCHES.
- DAMAGE TO EXISTING SITE IMPROVEMENTS DURING INSTALLATION OF LANDSCAPE MATERIAL SHALL BE THE RESPONSIBILITY OF THE LANDSCAPE CONTRACTOR.
- ALL LAWNS AND PLANT MATERIALS SHALL BE GUARANTEED FOR A PERIOD OF TWO (2) YEARS.
- ALL LAWN AREAS/ PLANTING BEDS SHALL BE ROTOTILLED TO A MINIMUM DEPTH OF 12 INCHES. SOIL SHALL BE AMENDED USING "SUPERHUMUS" AS PROVIDED BY NEW ENGLAND ORGANICS OR APPROVED EQUAL. SUPERHUMUS SHALL BE INCORPORATED AT A RATE OF 4 CUBIC FEET PER SQUARE YARD OF PLANTING BED. THOROUGHLY INCORPORATE SUPERHUMUS INTO SOIL.
- CONTRACTOR SHALL COORDINATE INSPECTION OF PLANT MATERIAL AND LOCATIONS WITH PROJECT LANDSCAPE ARCHITECT PRIOR TO INSTALLATION. A MINIMUM OF 48 HOUR NOTIFICATION SHALL BE REQUIRED.
- ALL EXISTING TREES TO REMAIN SHALL BE PROTECTED DURING CONSTRUCTION. A CERTIFIED ARBORIST SHALL BE RETAINED TO PROVIDE PROPER PRUNING OF TREES. CONTRACTOR SHALL COORDINATE WITH PROJECT LANDSCAPE ARCHITECT PRIOR TO COMPLETING WORK.
- PITCH SPLASH BLOCK AWAY FROM BUILDING TOWARD TRAVEL WAY-TYPICAL.

LEGEND

PROPERTY LINE	---	
INTERIOR PROPERTY LINE	---	
IRON PIPE	○ I.R.F./A.P.F.	
GRANITE MONUMENT	□	
EDGE OF PAVEMENT	---	
ABUTTER	---	
UTILITY POLE	○	
WATER VALVE	⊖	
HYDRANT	⊕	
UTILITY DRAIN	⊙	
POLE MOUNTED LIGHT	☆	
BUILDING MOUNTED LIGHT	□	
OVERHEAD UTILITY	—OHU—	
UNDERGROUND ELECTRIC	—UE—	
SEWER LINE	---	
WATER LINE	---	
DECIDUOUS TREE	○	
TRANSFORMER	⊞	
SHRUB	⊗	
CONTOUR	---50---	50
WATER DOWN SPOUT	⊥	
GROUNDCOVER	▨	
CATCH BASIN	○	
SILT TRAP	⊙	
FOUNDATION DRAIN	---	FD
CLEAN OUT	• (c.o.)	
CONTOUR SPOT ELEVATION	118.50	118.50
SAWCUT LINE	---	
SILT FENCE	—x—x—x—	

Prepared For:
Owner:
 Avesta Housing
 307 Cumberland Avenue
 Portland, Maine 04101

Prepared By:
MITCHELL & ASSOCIATES
 Landscape Architects
 The Staples School
 70 Center Street
 Portland, Maine 04101
 Tel: (207) 774-4427

Munjoy Commons: Emerson
 13 Emerson Street
 Portland, Maine

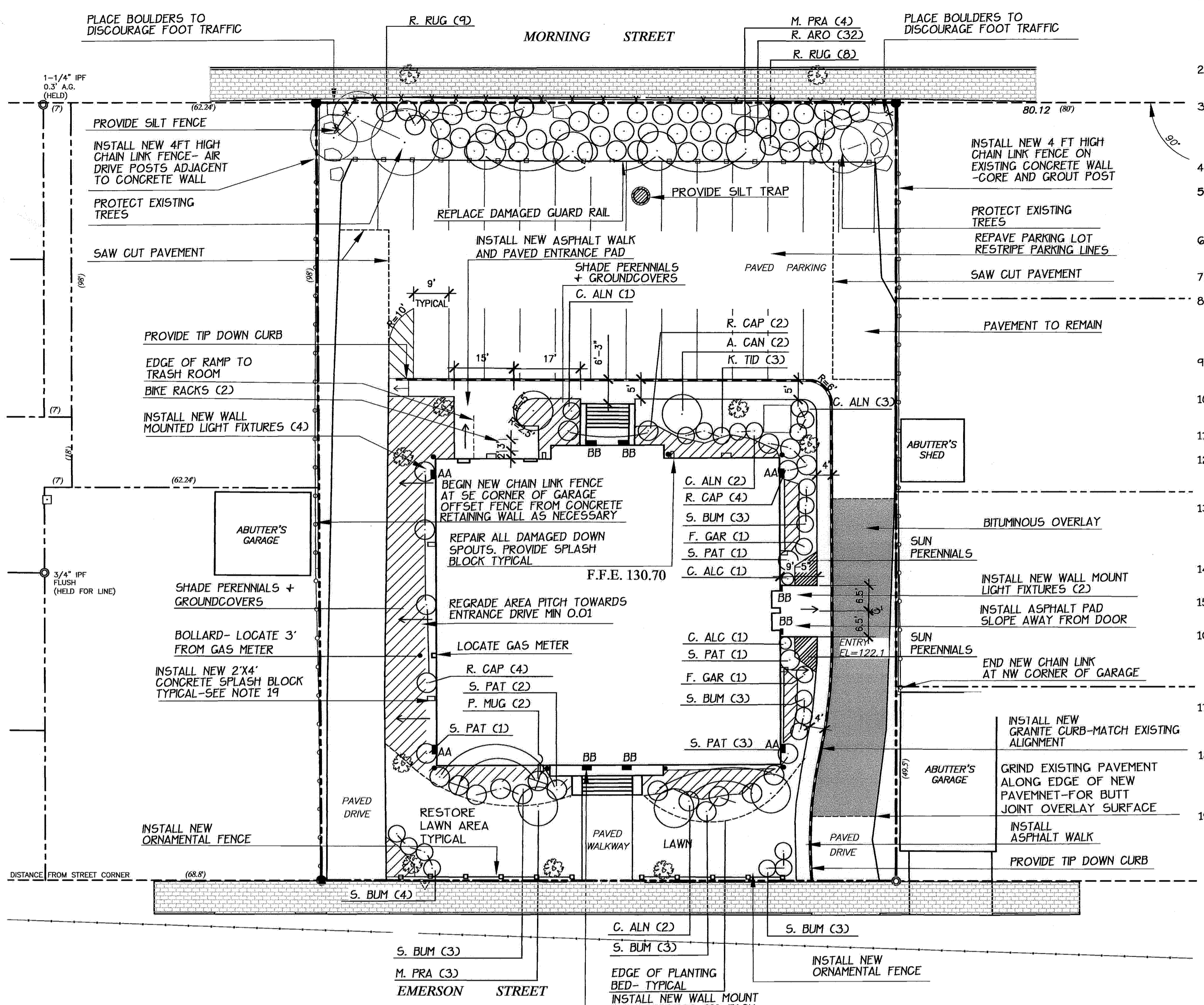

1 LAYOUT, LIGHTING + PLANTING PLAN
 2 SCALE: 1"=20'

LIGHTING SCHEDULE

KEY	QTY	DESCRIPTION	NOTES
AA	4	RA172_100MM-ED17	
BB	6	AN52_15LED	

PLANT LIST

KEY	QTY	BOTANICAL NAME	COMMON NAME	SIZE
TREES				
A. CAN	2	AMELANCHIA CANADENSIS	NATIVE SHADBUSH	2" CLUMP
M. PRA	3	MALUS 'PRAIRIE FIRE'	PRAIRIE FIRE CRAB	2" CAL
SHRUBS				
C. ALC	2	CLETHRA ALNIFOLIA 'COMPACTA'	COMPACT SWEET PEPPERBUSH	#2
C. ALN	8	CLETHRA ALNIFOLIA	SWEET PEPPERBUSH	#2
F. GAR	2	FOTHERGILLA GARDENII	BOTTLEBRUSH	#2
K. TID	3	KALPMA 'TIDDL'YINKS'	TIDDL'YINKS MT LAUREL	#3
P. MUG	2	FINLUS VAR. 'MUGO'	DWARF MUGO FINE	#2
R. CAP	10	RHODODENDRON 'CAPISTRANO'	CAPISTRANO RHODODENDRON	#3
R. ARO	32	RHUS AROMATICA 'GRO-LOW'	FRAGRANT GUMAC	#3
R. RUG	17	ROSA RUGOSA 'RUBRUM + ALBA'	SHRUB ROSE RED + WHITE MIX	#3
S. PAT	8	SYRINGA PATULA 'MISS KIM'	MISS KIM LILAC	#3
S. BUM	14	SPIREA BURNALDA 'ANTHONY WATERER'	ANTHONY WATERER SPIREA	#3
PERENNIALS SHADE				
A. ALI	40	ASTILBE 'ALIVE + KICKING'	FALSE SPIREA	1 QT
H. GRE	20	HOSTA 'GREAT ESCAPE'	GREAT ESCAPE HOSTA	1 QT
H. SUN	20	HOSTA 'SUN POWER'	SUN POWER HOSTA	1 QT
I. ENS	20	IRIS ENSATA 'STIPPLED RIPPLES'	STIPPLED RIPPLES IRIS	1 QT
PERENNIALS SUN				
I. SIB	9	IRIS SIBERICA 'CAESARS BROTHER'	CAESARS BROTHER IRIS	1 QT
M. DID	4	MONARDA DIDYMA 'GARDENVIEW SCARLET'	GARDENVIEW SCARLET BEE BALM	1 QT
S. AUT	4	SEDUM 'AUTUMN JOY'	AUTUMN JOY SEDUM	1 QT
GROUNDCOVERS				
A. UVA	50	ARCTOSTAPHYLOS UVA-URSII	BEARBERRY	#1
G. ODO	50	GALLUM ODORATUM	SWEET WOODRUFF	3" POT
P. TER	15	PACHYSANDRA TERMINALIS	JAPANESE SPURGE	50 /FLAT

* NOTE: LOCATION OF SELECTED PERENNIALS AND GROUND COVERS SHALL BE COORDINATED WITH PROJECT LANDSCAPE ARCHITECT IN THE FIELD.

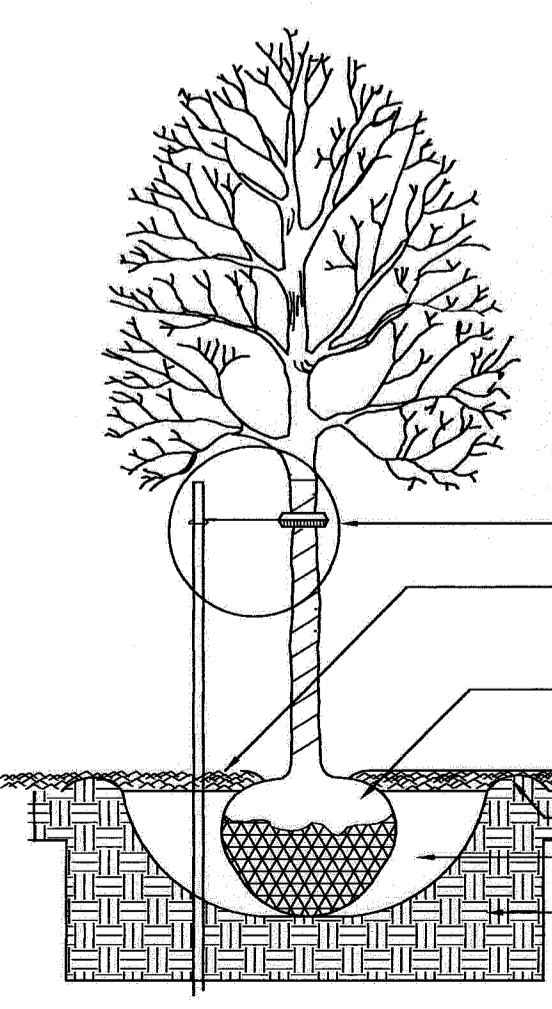

3 TREE AND SHRUB INSTALLATION
 2 NOT TO SCALE

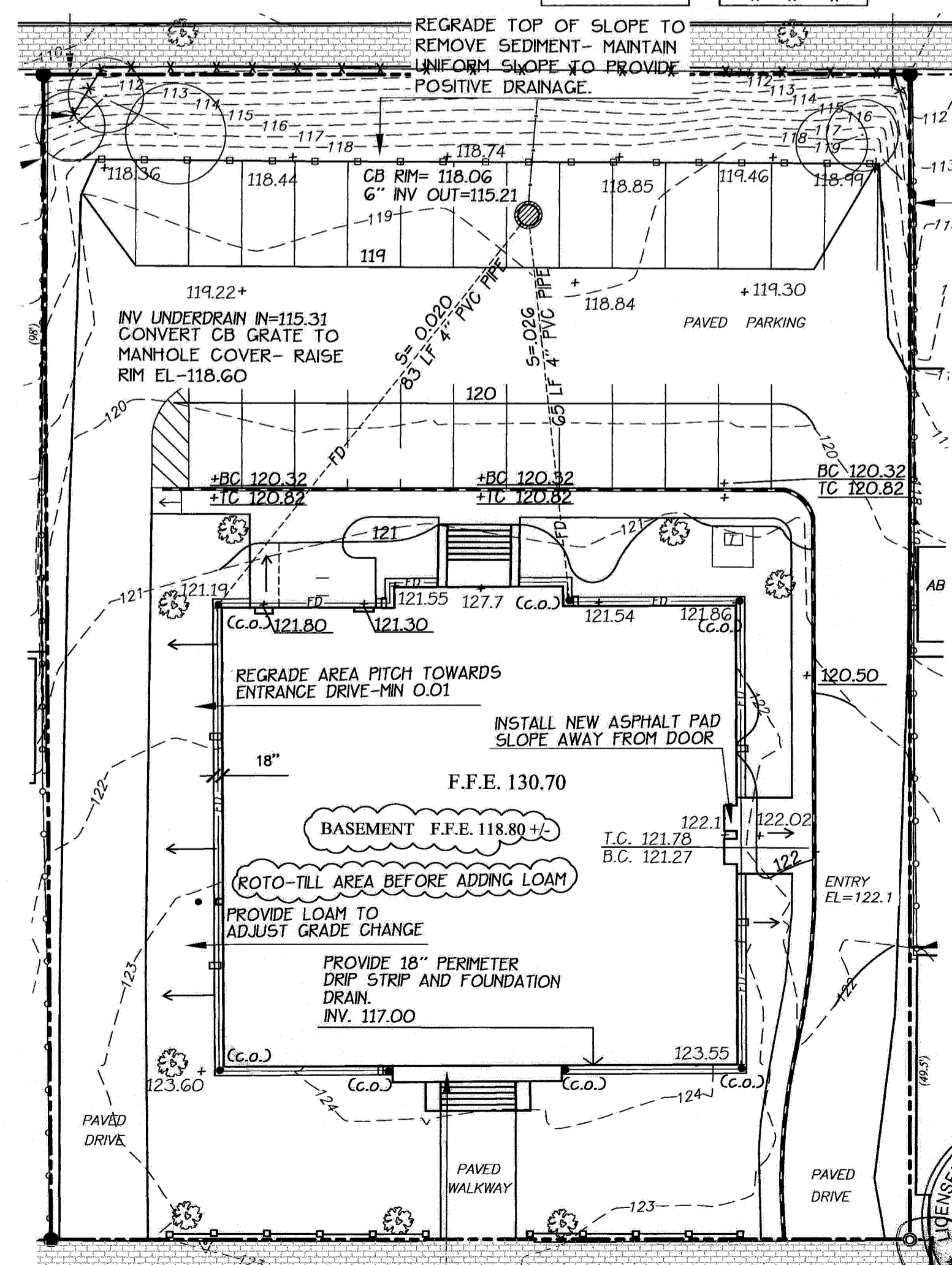

4 GRADING + DRAINAGE PLAN
 2 SCALE: 1"=20'

Date:
 AUGUST 28, 2009

Issued For:
 BIDDING AND PERMITTING

Revisions:

Reproduction or reuse of this document without the expressed written consent of Mitchell & Associates is prohibited.

Title:
 SITE PLANS

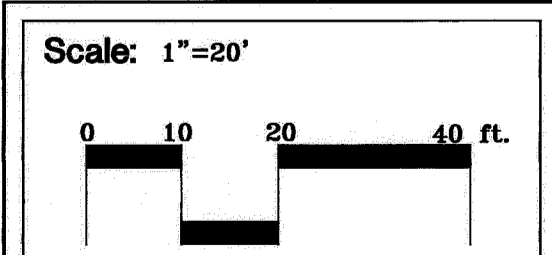

North: [North Arrow]

Sheet No.:
2

