

**EMERSON STREET RENOVATION
NEW CONSTRUCTION**
23 EMERSON STREET | PORTLAND
BRYCE AVALLONE & PETER VALCOURT



**DEXTRIOUS
CREATIVE**

PORTLAND, ME 04102
TRACIE REED, ARCHITECT
NCARB, AIA, LEED AP BD+C
traciereed@dextrouscreative.com
207.409.0459 (cell)

GENERAL CONTRACTOR/OWNER REP.

PETER VALCOURT
PETER.VALCOURT@YAHOO.COM
207.469.8494

STRUCTURAL ENGINEER

AL HODSON
RESURGENCE ENGINEERING
61 INDIA STREET, SUITE 7
PORTLAND, ME 04101
AL@RESURGENCEENGINEERING.COM
207.615.9985 (CELL)

CARPENTERS

CARL LITTLEFIELD
LITTLEFIELD & SON CONSTRUCTION
79 TOWN FARM RD
BUXTON, ME 04093
CARL.LITTLEFIELD@YAHOO.COM
207.929.6040

No.	Description	Date

Second & Third Floor LS Plan

Project number 15-16
Date 06.23.15
Drawn by TJR
Checked by TJR

LS-1.2

Scale 1/4" = 1'-0"

6/23/2015 10:56:35 AM

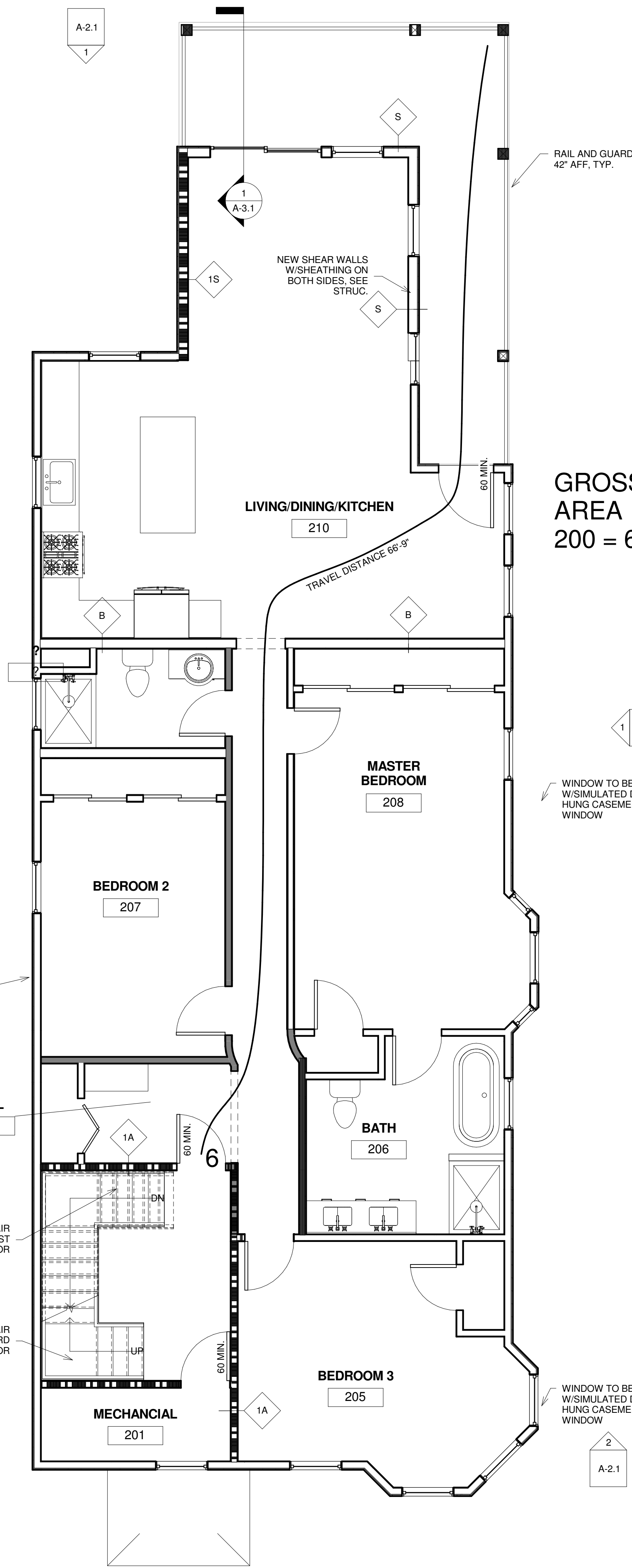

GROSS UNIT
AREA | 1,179 SF /
200 = 6 PERSONS

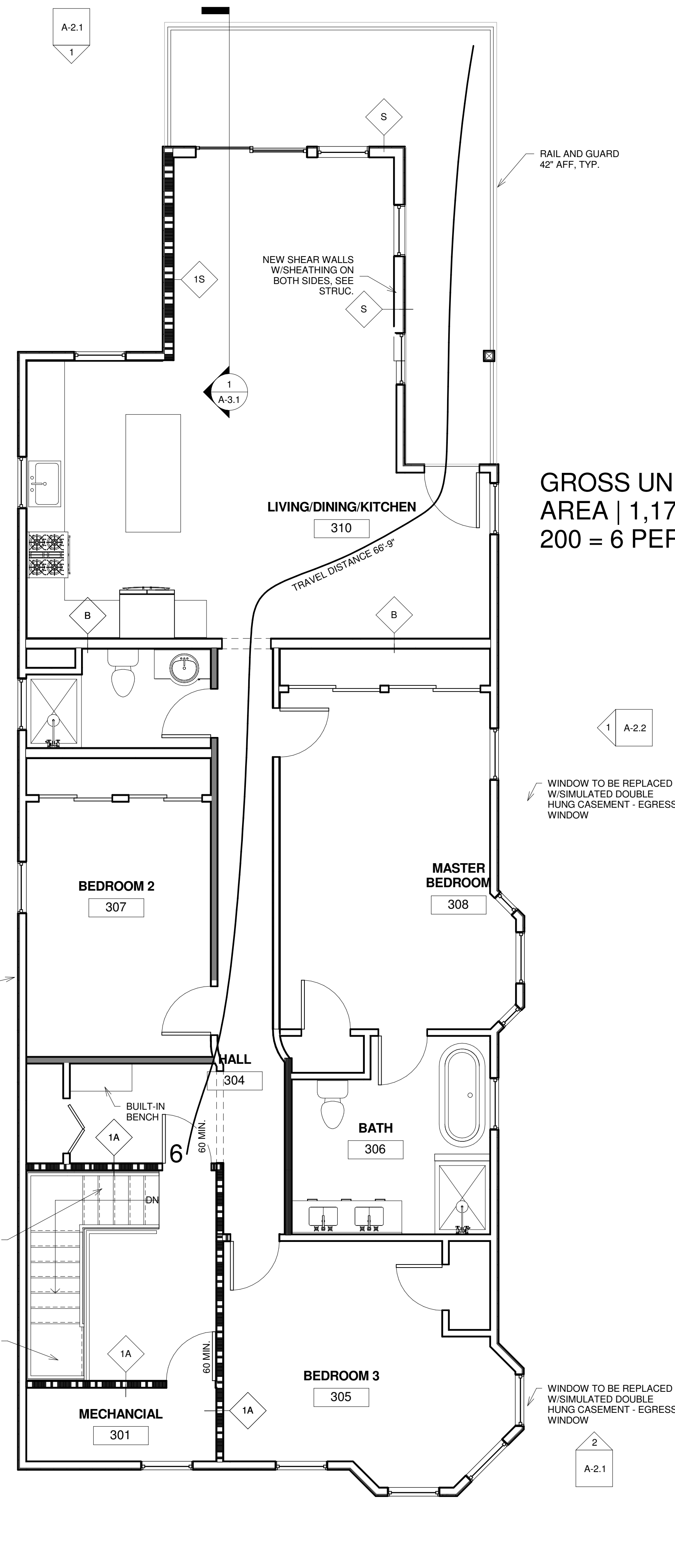

GROSS UNIT
AREA | 1,179 SF /
200 = 6 PERSONS

WINDOW TO BE REPLACED
W/SIMULATED DOUBLE
HUNG CASEMENT - EGRESS
WINDOW

WINDOW TO BE REPLACED
W/SIMULATED DOUBLE
HUNG CASEMENT - EGRESS
WINDOW

WINDOW TO BE REPLACED
W/SIMULATED DOUBLE
HUNG CASEMENT - EGRESS
WINDOW

WINDOW TO BE REPLACED
W/SIMULATED DOUBLE
HUNG CASEMENT - EGRESS
WINDOW

WINDOW TO BE REPLACED
W/SIMULATED DOUBLE
HUNG CASEMENT - EGRESS
WINDOW

- UNRATED WALL
- 30 MIN. RATED WALL
- 60 MINUTE RATED WALL
- 6 OCCUPANCY LOAD
- TRAVEL PATH
- 60 MIN. DOOR RATING

LIFE SAFETY LEGEND
1/4" = 1'-0"

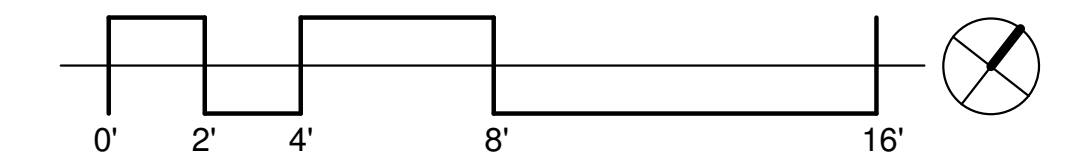

1 Second Floor Life Safety Plan
1/4" = 1'-0"

2 Third Floor Life Safety Plan
1/4" = 1'-0"