

**EMERSON STREET RENOVATION
NEW CONSTRUCTION**
23 EMERSON STREET | PORTLAND
BRYCE AVALLONE & PETER VALCOURT



**DEXTROUS
CREATIVE**
PORTLAND, ME 04102
TRACIE REED, ARCHITECT
NCARB, AIA, LEED AP BD+C
traciereed@dextrouscreative.com
207.409.0459 (cell)

GENERAL CONTRACTOR/OWNER REP.
PETER VALCOURT
PETER.VALCOURT@YAHOO.COM
207.469.8494

STRUCTURAL ENGINEER
AL HODSON
RESURGENCE ENGINEERING
61 INDIA STREET, SUITE 7
PORTLAND, ME 04101
AL@RESURGENCEENGINEERING.COM
207.615.9985 (CELL)

CARPENTERS
CARL LITTLEFIELD
LITTLEFIELD & SON CONSTRUCTION
79 TOWN FARM RD
BUXTON, ME 04093
CARL.LITTLEFIELD@YAHOO.COM
207.929.6040

No.	Description	Date

Basement & First Floor LS Plan
Project number 15-16
Date 06.23.15
Drawn by TJR
Checked by TJR
LS-1.1
Scale 1/4" = 1'-0"

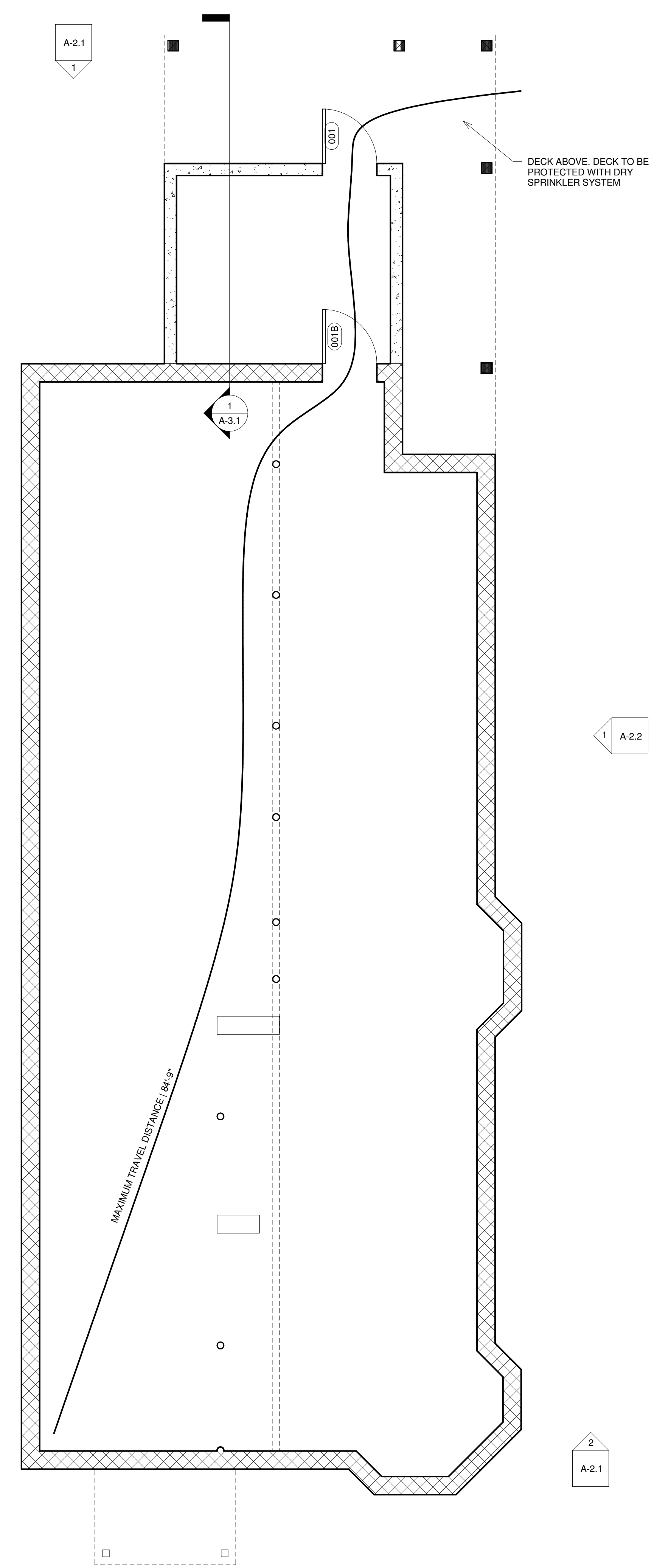

2 Basement Life Safety Plan
1/4" = 1'-0"

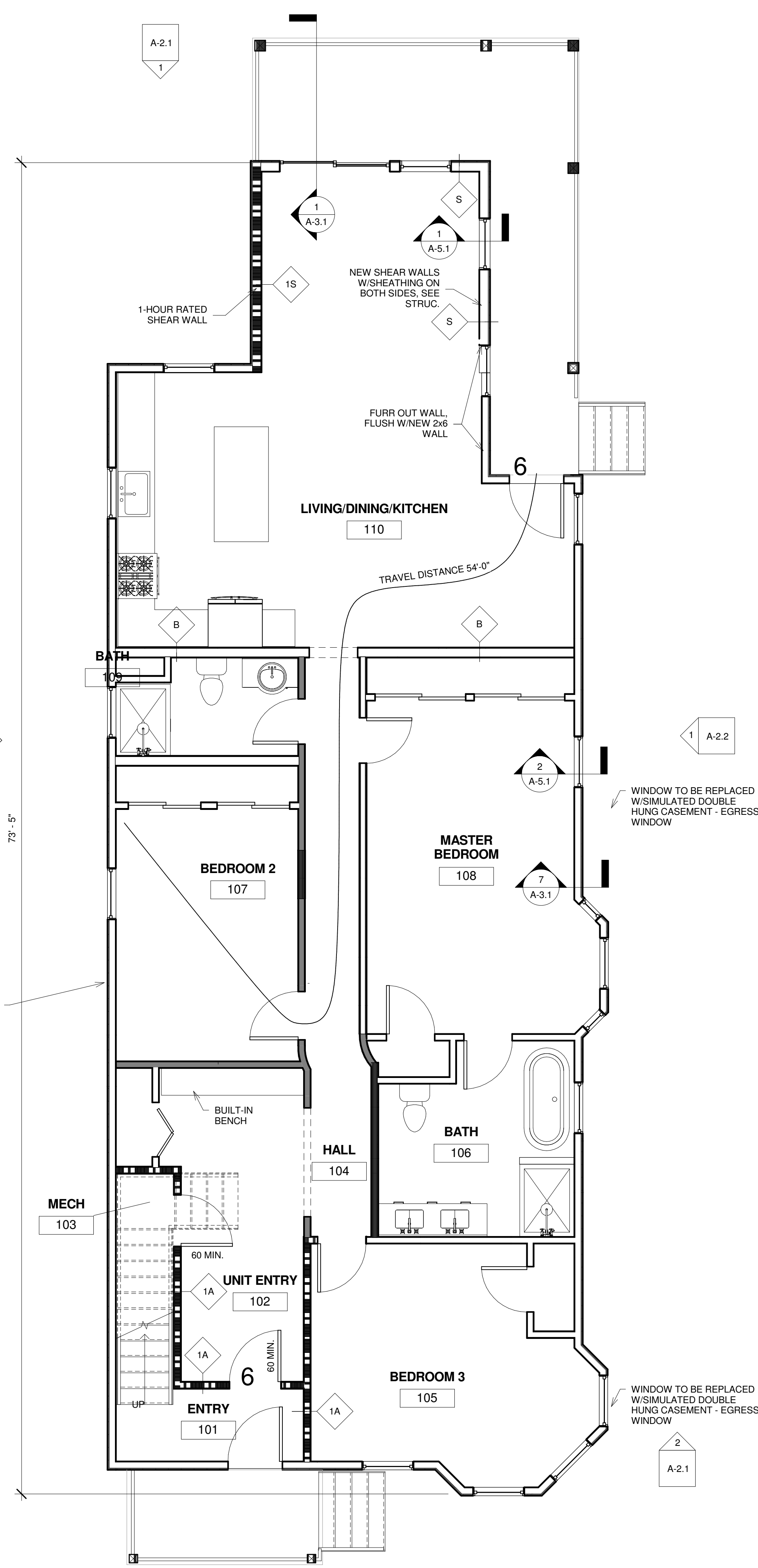

1 First Floor Life Safety Plan
1/4" = 1'-0"

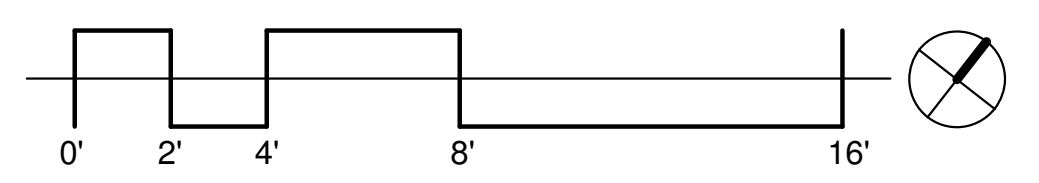

6/23/2015 10:56:33 AM