

FOR MORTGAGE LENDER USE ONLY

GENERAL NOTES: (1) DISTANCES SHOWN ARE TAKEN FROM PROVIDED TITLE REFERENCES SHOWN BELOW. (2) THE PURPOSE OF THIS INSPECTION IS TO RENDER AN OPINION AS FOLLOWS: A) DWELLING AND ACCESSORY STRUCTURE'S COMPLIANCE WITH RESPECT TO MUNICIPAL ZONING SETBACKS, AND B) FLOOD ZONE DETERMINATION BY HORIZONTAL SCALING ON BELOW REFERENCED FEMA MAP. (3) THIS INSPECTION EXCEPTS OUT ALL TECHNICAL STANDARDS CURRENTLY SET FORTH BY STATE OF MAINE BOARD OF LICENSURE FOR PROFESSIONAL LAND SURVEYORS. (4) THIS INSPECTION IS TO BE USED ONLY BY THE BELOW LISTED LENDER AND IS NOT TO BE USED BY ANOTHER PARTY FOR BOUNDARY LINE LOCATIONS OR LAND TITLE OPINIONS. (5) TITLE OR OWNERSHIP NOT DETERMINED. (6) A BOUNDARY SURVEY SHOULD BE PERFORMED TO RENDER A PROFESSIONAL OPINION PERTAINING TO BOUNDARY LINE LOCATIONS, EASEMENTS, RIGHTS OF WAY, ENCUMBRANCES, ENCROACHMENTS, AND/OR CONFLICTS WITH ABUTTER'S DEEDS. (7) LOCATION/EXISTENCE OF WETLANDS NOT DETERMINED UNLESS SHOWN ON A RECORDED SUBDIVISION PLAN. (8) THIS OFFICE DOES NOT GRANT AUTHORIZATION TO ANY THIRD PARTY FOR USE OF THIS INSPECTION IN ANY BOUNDARY LINE EVALUATION FOR PERMITTING/PLANNING/APPROVALS. (9) THIS OFFICE ACCEPTS NO LIABILITY AND/OR RESPONSIBILITY FOR THE IMPROPER USE OF THIS MORTGAGE LOAN INSPECTION.

REV. 08/01/2013

THIS SKETCH IS NOT TO BE USED FOR CONSTRUCTION PURPOSES, IMPROVEMENTS SHOWN ARE APPROXIMATE.

ADDRESS: 32 Turner Street
Portland, Maine

INSP. DATE: 10/30/2013

SCALE: 1" = 20'

Recommend Boundary Survey for accurate location.

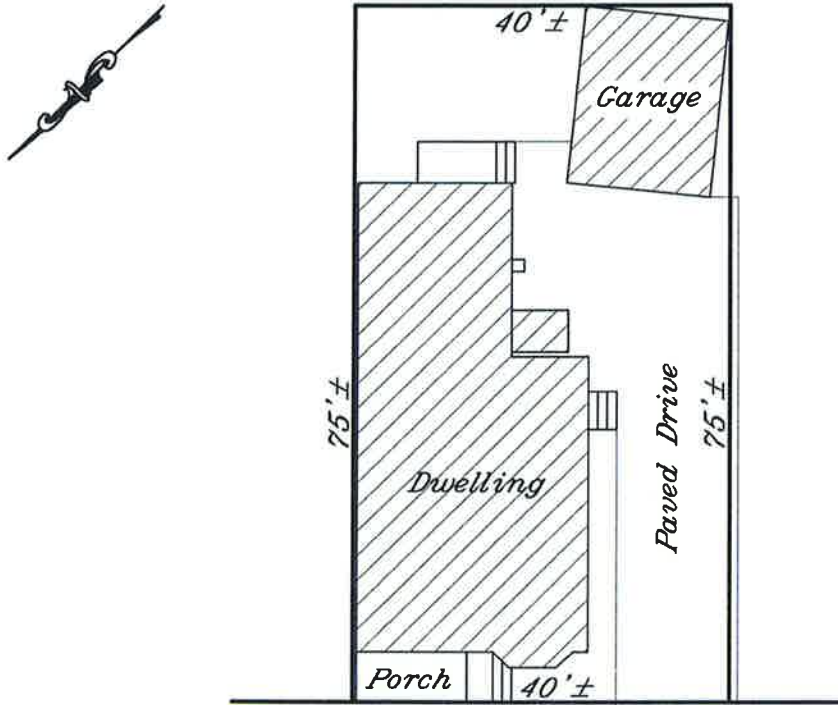

Turner Street

No apparent property corners found.

JDN

SEE PROVIDED TITLE REFERENCES FOR APPURTENANCES, IF ANY.

APPLICANT: Linda Norden FILE#: 21326404

OWNER: Estate of Babb CLIENT#: 5339-13

LENDER: _____

REQ. PARTY: Baxter Title Company

TITLE REFERENCES: COUNTY: Cumberland

DEED BOOK: 2968 PAGE: 482

PLAN BOOK: _____ PAGE: _____ LOT: _____

MUNICIPAL REFERENCE:

MAP: 14 BLOCK: K LOT: 2

THE DWELLING DOES NOT FALL WITHIN A SPECIAL FLOOD HAZARD AREA PER FEMA COMMUNITY MAP No. 230051 PANEL: 0014B ZONE: C DATE: 12/08/1998

THE DWELLING WAS IN COMPLIANCE WITH MUNICIPAL ZONING SETBACK REQUIREMENTS AT THE TIME OF CONSTRUCTION.

Nadeau Land Surveys
Professional Land Surveyors
Certified Floodplain Managers



918 BRIGHTON AVE. PH.(207)878-7870
PORTLAND, ME. 04102 F.(207)878-7871

THIS INSPECTION IS VALID ONLY WITH A SURVEYOR'S SEAL AND IS NULL & VOID 90 DAYS AFTER INSPECTION DATE.

THIS IS NOT A BOUNDARY SURVEY - NOT FOR RECORDING