

N/F
ERICK & CHRISTINE PEDERSON
16698/259
TM 14 LOT 11

N/F
BRYCE A. AUALLONE
16352/264
TM 14 LOT 13 & 19

N/F
RAYMOND & KAREN ST. PIERRE
19561/279
TM 14 LOT 16

HOWARD STREET

EMERSON STREET

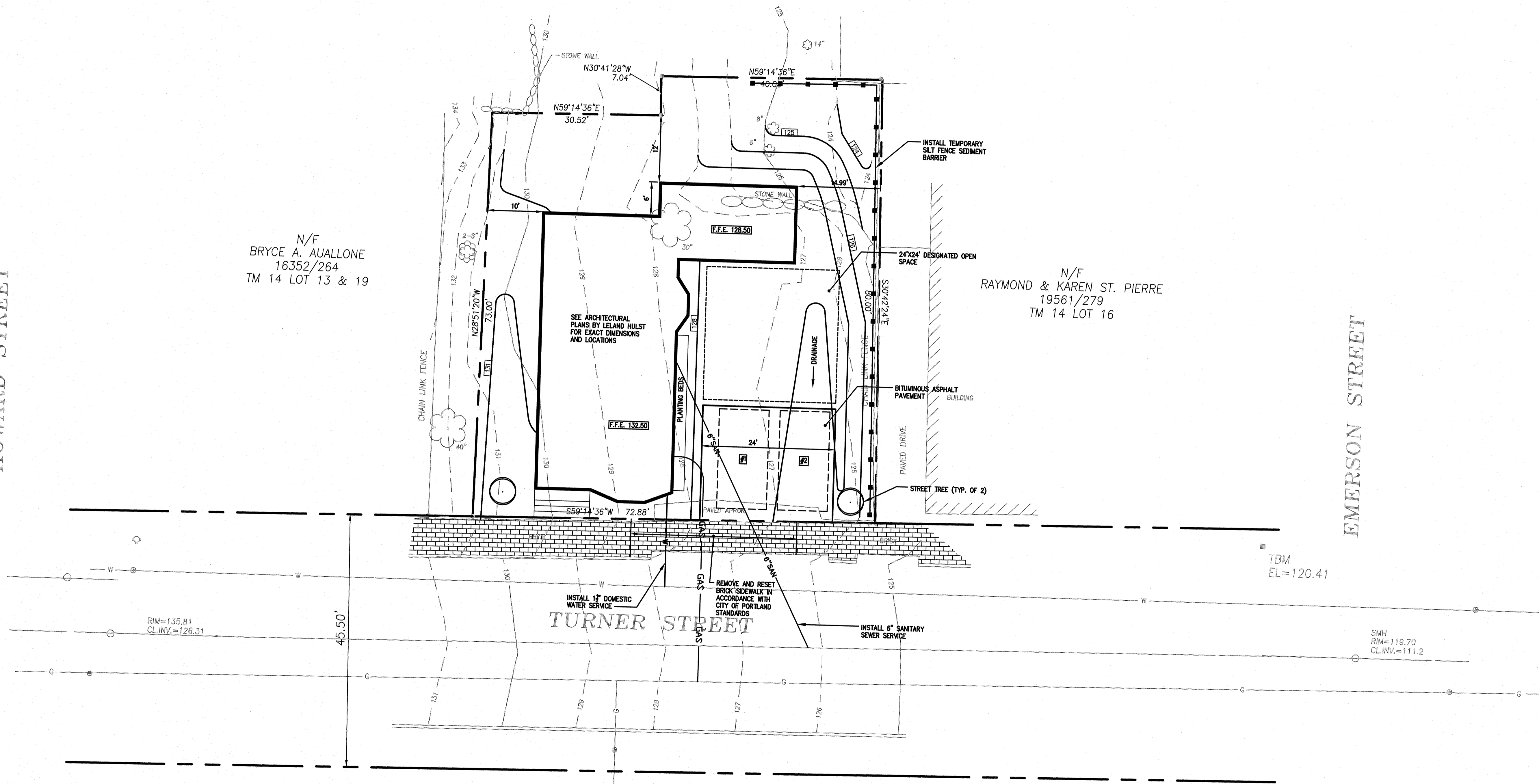

PRELIMINARY NOT FOR CONSTRUCTION

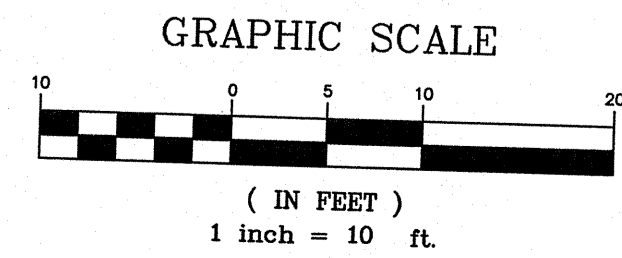

		PROJECT TWO-UNIT RESIDENTIAL HOUSE 43-45 TURNER STREET PORTLAND, MAINE	
SHEET TITLE SITE LAYOUT AND GRADING PLAN		CLIENT CYRUS HAGGE 225 COMMERCIAL STREET PORTLAND, MAINE	DRAWN: LECJ DESIGNED: SRB CHECKED: SRB FILE NAME: 2795-SP
REVISIONS		DATE 12.04.07	DATE
DESCRIPTION SUBMITTED FOR SITE PLAN REVIEW		DESCRIPTION	DATE

G:\2795\DWG\CONCEPTS\2795-SP.dwg, SITE, 12/3/2007 3:54:24 PM, ljordan