

RECEIVED

OCT 16 1987

DEPT. OF BUILDING INSPECTION
CITY OF PORTLAND

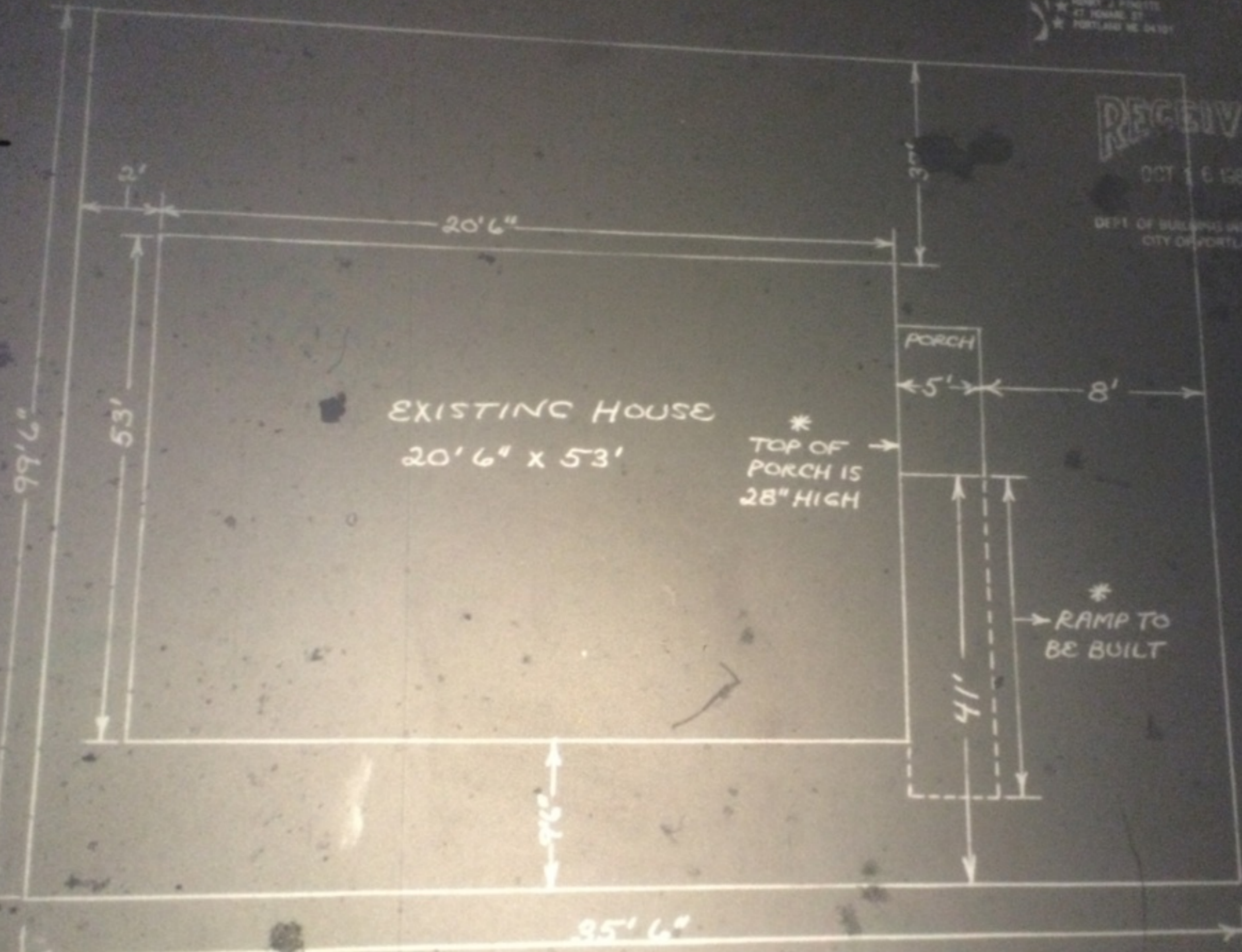

EXISTING HOUSE
20'6" x 53'

*
TOP OF
PORCH IS
28" HIGH

*
RAMP TO
BE BUILT

47 HOWARD STREET

DRAWN BY:
HAROLD A. TURNER