

**PARCEL INFORMATION**

- PROJECT ADDRESS: 44 QUEBEC STREET  
PORTLAND, MAINE  
(CBL 14-R-1)
- SITE AREA: 2,467 SQUARE FEET (0.057 ACRES)  
(PER PLAN REFERENCE 1.1)
- OWNER: THOMAS SEEKINS  
29 DERBY LANE  
NORTH YARMOUTH, MAINE
- ZONING DISTRICTS:  
R-6 RESIDENTIAL ZONE
- SPACE AND BULK STANDARDS
 

	REQUIRED	EXISTING
MINIMUM LOT SIZE	2,000 SF	2,467 SF
MINIMUM LOT AREA PER DWELLING	725 SF	1,233.5 SF
MINIMUM STREET FRONTAGE	20'	29.7'
FRONT YARD SETBACK	5'	0'
REAR YARD SETBACK	10'	10.3'
SIDE YARD SETBACK	5'	0.5'
SIDE YARD ON SIDE STREET	NONE	1.8'
MAXIMUM LOT COVERAGE	60%	65.5%
MINIMUM LOT WIDTH	20'	26.5'
MAXIMUM HEIGHT OF STRUCTURES	45'	UNKNOWN
MINIMUM LANDSCAPED OPEN SPACE	20%	27%
MAXIMUM GARAGE OPENINGS	20'	17±

**PLAN REFERENCES:**

- ON-SITE TOPOGRAPHIC AND PROPERTY BOUNDARY INFORMATION TAKEN FROM THE FOLLOWING:
  - A PLAN TITLED "CONDOMINIUM PLAN", PREPARED BY OWEN HASKELL, INC. OF FALMOUTH, MAINE, DATED NOVEMBER 22, 2016.
  - FIELD OBSERVATIONS BY WALSH ENGINEERING ASSOCIATES, INC. ON JANUARY 6, 2017.
  - UTILITY INFORMATION PROVIDED BY THE PORTLAND WATER DISTRICT, UNIL AND THE CITY OF PORTLAND.
  - ACCORDING TO THE USDA WEBSOIL SURVEY, ON-SITE SOILS CONSIST OF HINCKLEY LOAMY SAND, WHICH IS CLASSIFIED AS HYDROLOGIC SOIL GROUP A.

**GENERAL NOTES:**

- THE CONTRACTOR SHALL BE RESPONSIBLE FOR NOTIFYING "DIG SAFE" AND LOCAL UTILITY COMPANIES AT LEAST THREE (3) BUSINESS DAYS, BUT NOT MORE THAN 30 CALENDAR DAYS, PRIOR TO THE COMMENCEMENT OF ANY EXCAVATION, IN ACCORDANCE WITH MAINE STATE LAW. "DIG SAFE" TELEPHONE NUMBER IS 1-888-344-7233.
- THE CONTRACTOR SHALL BE SOLELY RESPONSIBLE FOR ANY AND ALL MEANS, METHODS, AND TECHNIQUES EMPLOYED TO PERFORM THE WORK SHOWN ON THE PLANS.
- ANY DAMAGE TO EXISTING UTILITIES AND/OR SITE FEATURES AS A RESULT OF CONTRACTOR ACTIVITIES SHALL BE REPAIRED TO THE CONDITION IMMEDIATELY BEFORE DAMAGE OCCURRED AT THE CONTRACTOR'S EXPENSE.
- ALL WORK SHALL COMPLY WITH ALL LOCAL, STATE, AND FEDERAL REGULATIONS INCLUDING ALL SAFETY REGULATIONS (OSHA).
- ALL WORK SHALL BE IN CONFORMANCE WITH THE CITY OF PORTLAND REQUIREMENTS.
- THE CONTRACTOR SHALL SECURE ALL NECESSARY PERMITS FOR THE WORK SHOWN ON THESE PLANS PRIOR TO CONSTRUCTION.
- ALL EROSION CONTROL MEASURES SHALL BE INSTALLED PRIOR TO ANY SITE EXCAVATION OR REGRADING.
- CONTRACTOR SHALL VERIFY ALL EXISTING CONDITIONS SHOWN ON THE DRAWINGS. IF ANY DISCREPANCIES ARE FOUND, THE OWNER OR OWNERS REPRESENTATIVE SHALL BE NOTIFIED IMMEDIATELY.
- THE SUBJECT PROPERTY IS NOT LOCATED WITHIN THE 100-YEAR FLOOD PLAIN AS DEPICTED ON THE FEMA FLOOD INSURANCE RATE MAPS.
- ALL WATER MAIN AND WATER SERVICE WORK SHALL COMPLY WITH PORTLAND WATER DISTRICT REQUIREMENTS. CONTRACTOR SHALL BE RESPONSIBLE FOR OBTAINING ALL REQUIRED PERMITS FROM THE PORTLAND WATER DISTRICT.
- ALL PROPOSED WORK WITHIN THE QUEBEC STREET AND HOWARD STREET RIGHT-OF-WAYS SHALL MEET THE CITY OF PORTLAND TECHNICAL MANUAL STANDARDS.
- INSTALL CATCH BASIN INLET PROTECTION IN DOWNGRADIENT CATCH BASINS IN ALL DIRECTIONS PRIOR TO EXCAVATION IN STREET.
- CONTRACTOR SHALL SUBMIT A TRAFFIC MANAGEMENT PLAN TO THE DEPARTMENT OF PUBLIC WORKS FOR APPROVAL PRIOR TO ANY STREET AND/OR SIDEWALK CLOSURES.
- EXCAVATED SOIL IS ASSUMED TO BE "SPECIAL WASTE" AND SHALL BE CHARACTERIZED BY THE CONTRACTOR PRIOR TO OFFSITE DISPOSAL.

**LEGEND**

EXISTING	LEGEND
---	PROPERTY LINE
- - -	ABUTTER LOT LINE
○	PROPERTY CORNER
—●—	SANITARY SEWER LINE
—○—	SANITARY SEWER CLEANOUT
—x—	STORMDRAIN LINE
—w—	WATERLINE
—v—	WATER SHUTOFF
—g—	GAS LINE
—ohu—	OVERHEAD UTILITY LINE
—u—	UNDERGROUND COMMUNICATIONS
○	UTILITY POLE
—x—x—	BUILDING
—o—o—	METAL FENCE
—x—x—	WOOD FENCE
—o—o—	EDGE OF PAVEMENT
—o—o—	EDGE OF CONCRETE
—g—g—	GRANITE CURB
—b—b—	BRICK SIDEWALK
—p—p—	PARKING METER

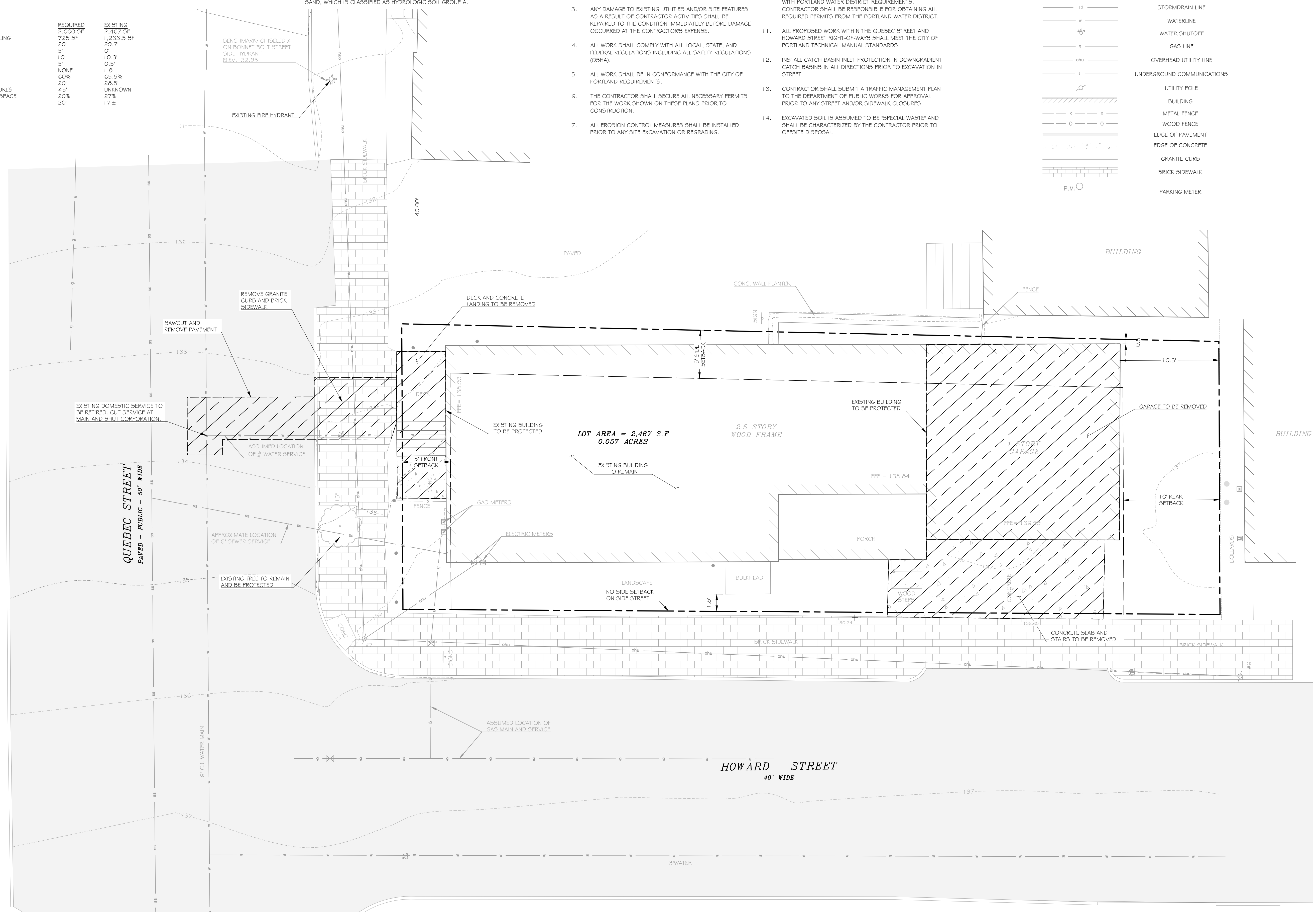

**Bild Architecture**  
 PO Box 8235  
 Portland, ME  
 04108  
 207.408.0168  
 evan@bildarchitecture.com

**WALSH ENGINEERING ASSOCIATES, INC.**  
 100 Water Street, Suite 201  
 Portland, Maine 04101  
 Tel: 207.553.8888 | www.walsh-eng.com  
 Copyright © 2017

PROJECT NO. **16035**  
 PROJECT NAME **44 QUEBEC**  
 PORTLAND, MAINE

ISSUE DATE **2/21/17**  
 SHEET SCALE **N.T.S.**

REVISIONS

NO.	DESCRIPTION
1	14.8.17 PER CITY REVIEW
2	
3	
4	
5	
6	

DRAWN BY **SWC**  
 SHEET TITLE **Existing Conditions and Removals Plan**

