

REVISIONS:

No.	Name	Date
1	REV 1	11/21/17

ISSUED FOR PERMITTING

ISSUED: 10/13/2017
 PROJECT No: 1706
 DRAWN BY: LG
 CHECKED BY: HH
 SHEET TITLE:
 FLOOR PLANS

GENERAL NOTES:

- TYPICAL EXTERIOR WALL ASSEMBLY AT DORMER:
 - 1/2" GYPSUM WALL BOARD (GWB)
 - AIR & VAPOR RETARDER MEMBRANE
 - 2X WOOD FRAMING @ 16" O.C.
 - 5 1/2" DENSE PACK CELLULOSE INSULATION
 - ZIP R3 SHEATHING
 - PAINTED WOOD CLAPBOARD TO MATCH EXISTING
- TYPICAL NEW ROOF ASSEMBLY:
 - ASPHALT SHINGLES
 - WEATHER BARRIER MEMBRANE
 - SHEATHING
 - PRE-ENGINEERED TRUSSES
 - LOOSE FILL CELLULOSE INSULATION
- TYPICAL INTERIOR WALL ASSEMBLY WHERE APPLICABLE:
 - 1/2" GWB
 - 2X4 WOOD FRAMING @ 16" O.C.
 - ACOUSTIC BATT INSULATION
 - 1/2" GWB
- TYPICAL CEILING ASSEMBLY WHERE APPLICABLE:
 - 1/2" GWB
 - WOOD STRAPPING
- PATCH AND PAINT EXISTING WALLS, BASES, TRIM, SILLS, AND CEILINGS WHERE APPLICABLE.
- REPLACE ALL EXISTING WINDOWS WITH NEW.
- 9'-4" EXISTING FLOOR TO FLOOR TO REMAIN
- EXISTING VERTICAL CIRCULATION TO REMAIN
- EXISTING WOOD FLOORING TO REMAIN. REFINISH, PATCH, AND INFILL TO MATCH WHERE REQUIRED.
- BATHROOM, KITCHEN, AND ENTRY TO HAVE TILE FLOOR AND BASE. BATHROOM TO HAVE TILE WALL BASE.
- PROVIDE PAINTED WOOD BASE TO MATCH EXISTING WHERE REQUIRED.
- KITCHEN CABINETS OF PAINTED WOOD
- KITCHEN COUNTERTOP OF QUARTZ
- STAINLESS STEEL APPLIANCES WHERE APPLICABLE.
- ALL NEW PLUMBING FIXTURES (NO EXISTING FIXTURES TO REMAIN)
- PROVIDE NEW LIGHTING THROUGHOUT.
- CONVERT SINGLE PIPE STEAM SYSTEM TO HYDRONIC.
- RETAIN VENTED NATURAL GAS RINNAI BACKUP HEATER.
- PATCH AND REPLACE SOUTH AND WEST ELEVATION WOOD SIDING. FULLY REPLACE NORTH AND EAST ELEVATION SIDING.
- FILL EXISTING EXTERIOR WALL CAVITIES WITH BLOWN-IN, DENSE PACK CELLULOSE INSULATION.
- PROVIDE INSULATION AND VAPOR BARRIER BETWEEN BASEMENT AND FIRST FLOOR.
- PROVIDE HVAC COOLING, MINI-SPLIT BASIS OF DESIGN
- SEE MECHANICAL AND STRUCTURAL ENGINEER'S REPORT. UPGRADE STRUCTURAL PER THOSE REQUIREMENTS. NOTE DOUBLE DORMERS.
- UNIT TO RECEIVE APPROXIMATE 400 SQFT PATIO WITH ADJACENT NEW PLANTINGS

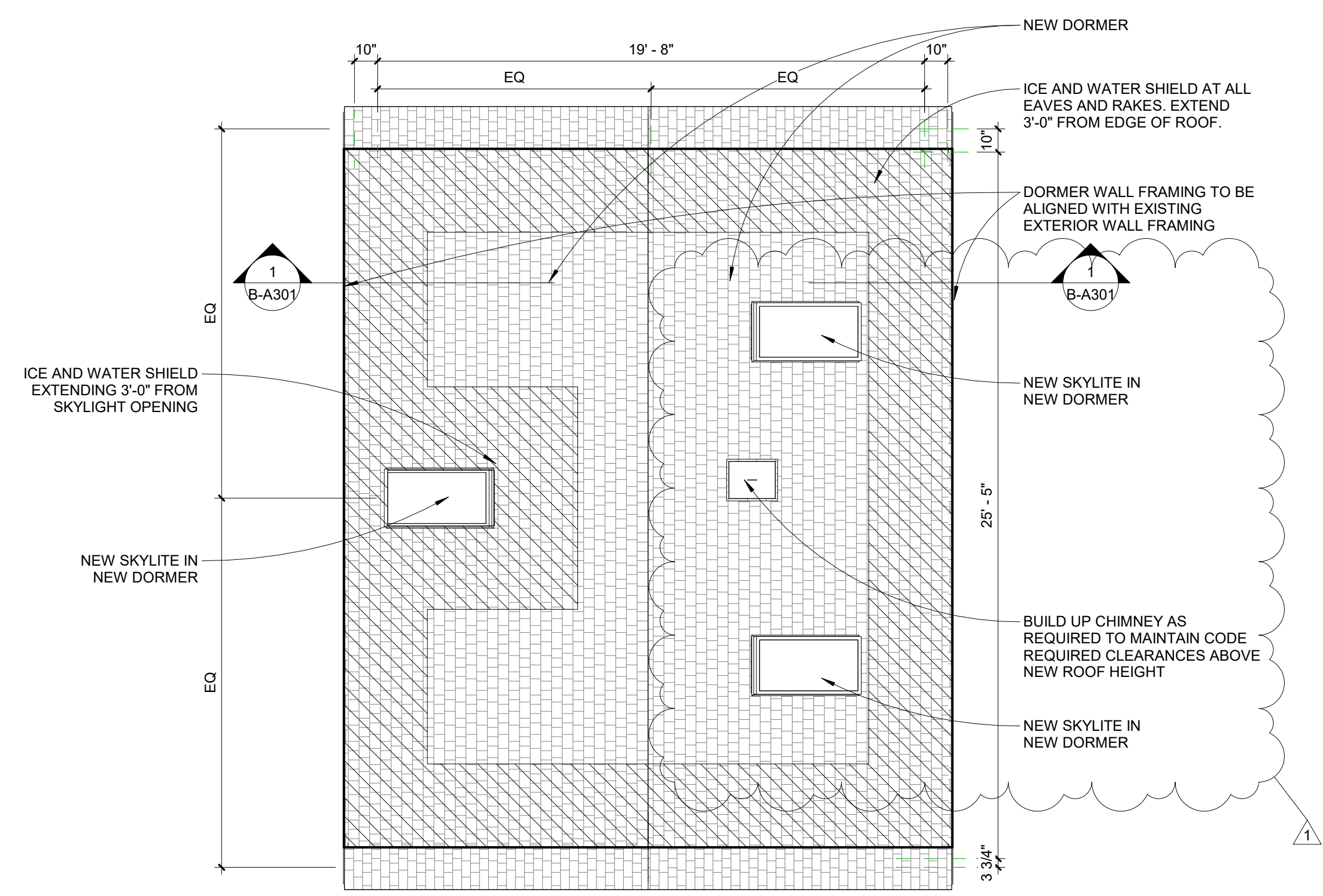
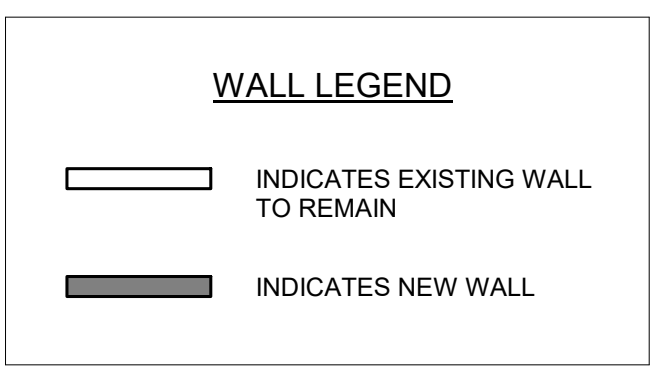

4 Roof Plan
 1/4" = 1'-0"

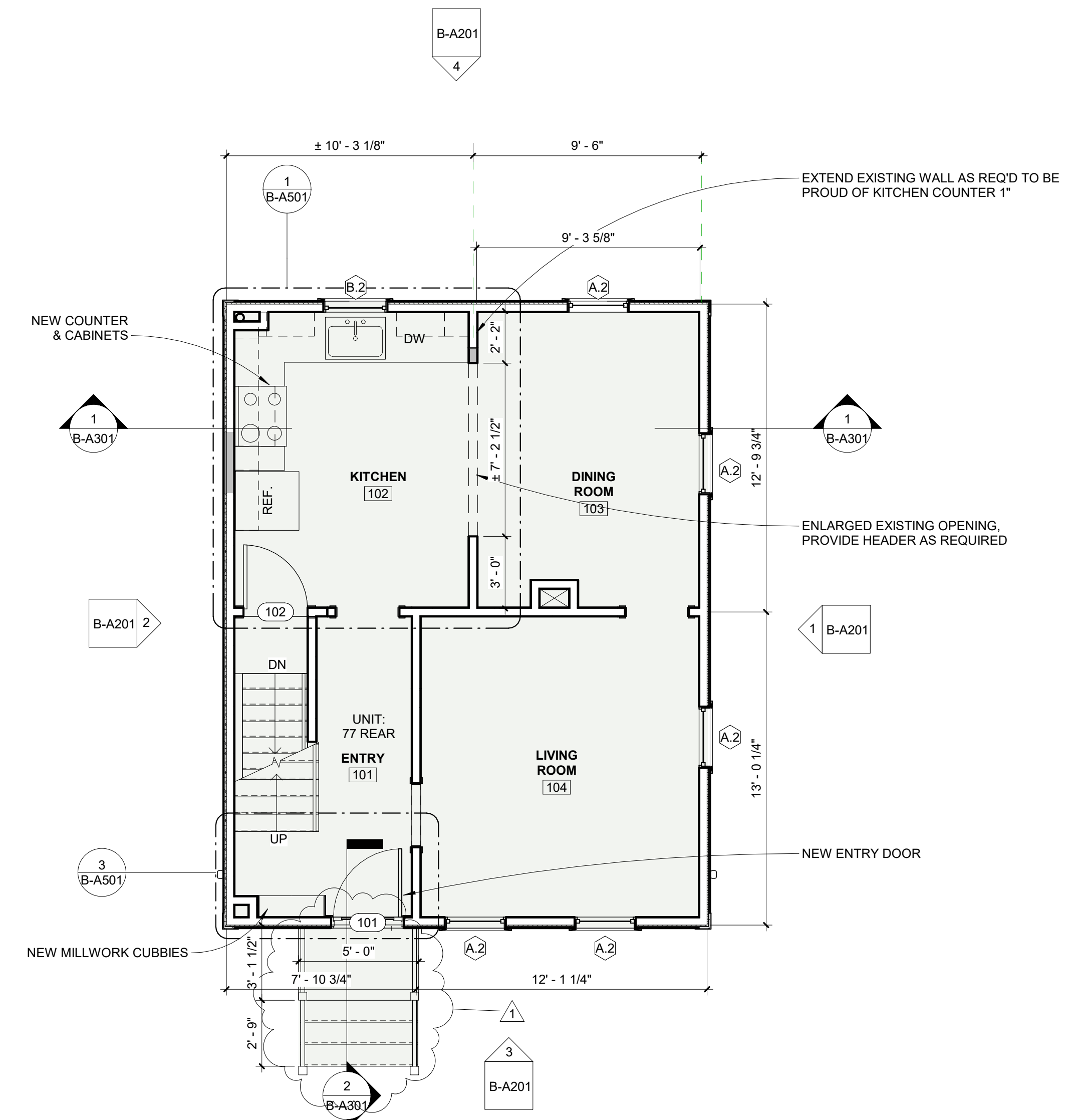

2 Level 01 Floor Plan
 1/4" = 1'-0"

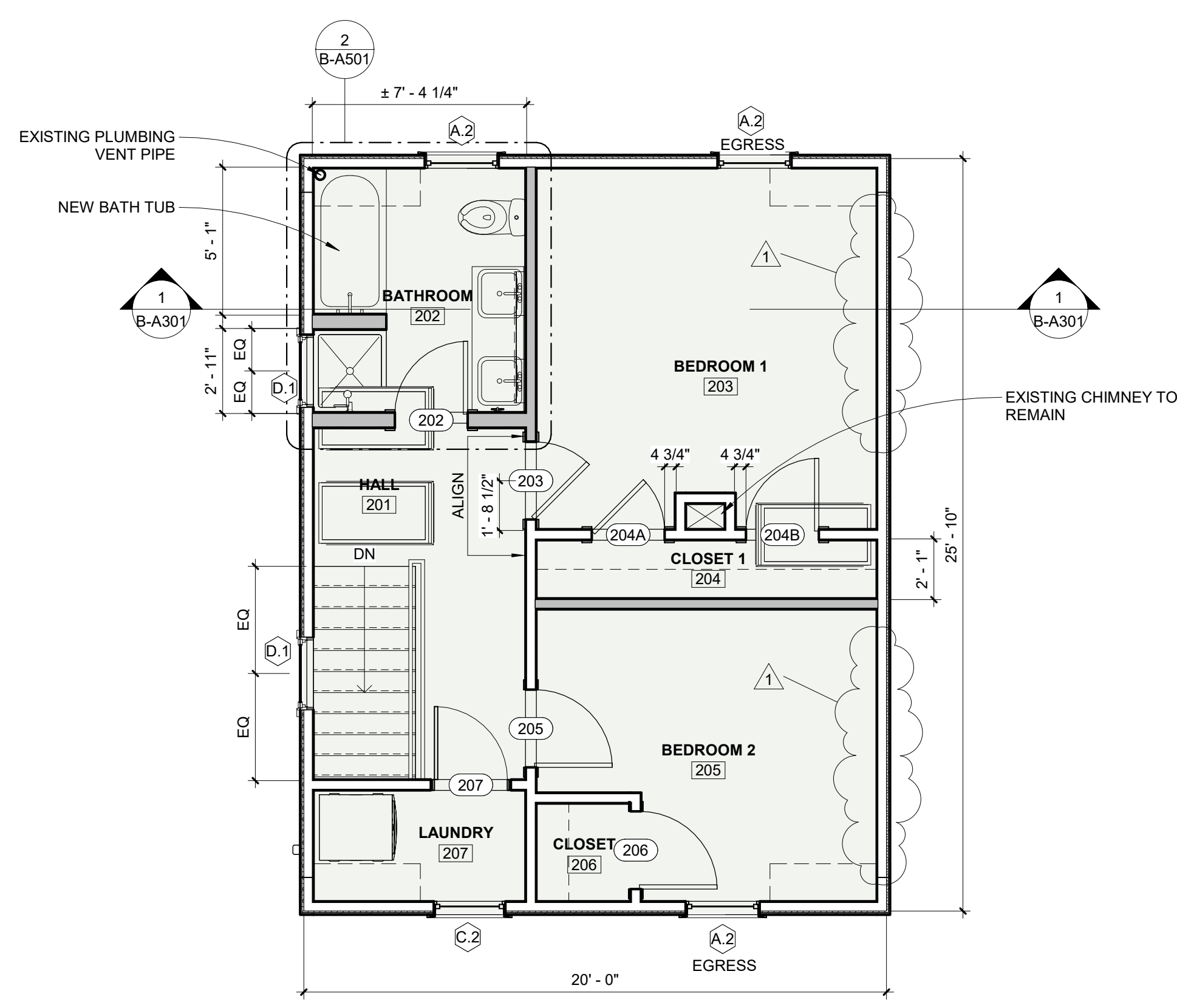

3 Level 02 Floor Plan
 1/4" = 1'-0"

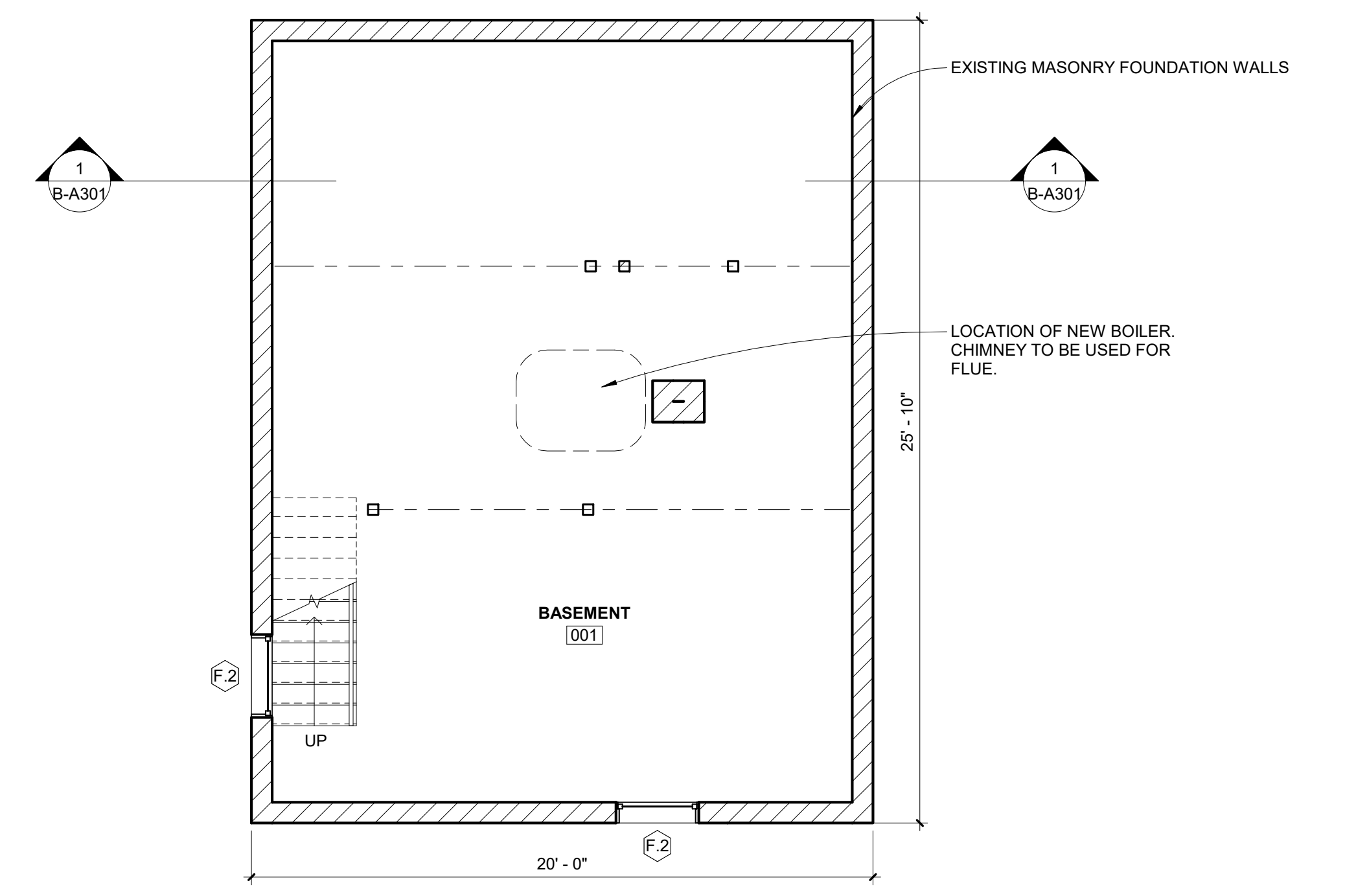

1 Basement Floor Plan
 1/4" = 1'-0"